

CORINNA TOWNSHIP RESOLUTION
NO. 2003-17
CITY OF ANNANDALE RESOLUTION
NO. 03-57

JOINT RESOLUTION AND AGREEMENT FOR
ORDERLY ANNEXATION BETWEEN
TOWNSHIP AND THE CITY OF ANNANDALE, MINNESOTA

WHEREAS, the Corinna Township Board passed a resolution on Oct. 21, 2003, approving the annexation to the City of Annandale of certain land owned by Dale R. Machovsky and Terry J. Machovsky and legally described as follows:

See attached Exhibit A.

WHEREAS, the City Council of the City of Annandale agreed to the annexation of the above described parcel of land at its November 3, 2003, meeting; and

WHEREAS, the Corinna Township Board and the City Council for the City of Annandale have both determined that the annexation of a portion of the Township with the City is of mutual benefit to both parties and the residents thereof.

NOW, THEREFORE, BE IT RESOLVED by the Corinna Township Board and the City Council of the City of Annandale as follows:

1. **Designation of Merger Area.** Corinna Township (hereinafter "Township") and the City of Annandale (hereinafter "City") desire to designate, by joint resolution and agreement, the area encompassing the territory of the Township as described herein (the "Annexed Parcel") subject to merger and orderly annexation under and pursuant to Minnesota Statutes Section 414.0325.
2. **Population of Merger Area.**
 - (a) The Township and the City state that the population of the annexed area is approximately 2 persons.
 - (b) The 2000 census results of the population of the City of Annandale was 2684 persons. Therefore, following the annexation, the estimated population of the City will increase by 2 persons.

3. **State Agency Jurisdiction.** Upon approval by the respective governing bodies of the Township and the City, this Joint Resolution and Agreement confers jurisdiction upon the office of Minnesota Planning to accomplish the orderly annexation in accordance with the terms of this Joint Resolution and Agreement.
4. **No Alterations of Boundaries.** City and Township mutually state that no alterations of the boundaries of the area designated herein for orderly annexation is appropriate.
5. **Payment In Lieu of Taxes.** The City and Township agree that this annexation is being done due to a hardship of the property owner and therefore there will be no payment in lieu of lost tax revenues to the Township as a result of this annexation.
6. **Authorization.** The appropriate officers of the City and the Township are hereby authorized to carry the terms of this Joint Resolution and Agreement into effect.
7. **Severability and Repealer.** Should any section of this Joint Resolution and Agreement be held by a court of competent jurisdiction to be unconstitutional or void, the remaining provisions will remain in full force and effect.
8. **Effective Date.** This Joint Resolution and Agreement is effective upon its adoption by the respective governing bodies of the Township and the City, as provided by law.
9. **Review and Comment by State Board.** The Township and the City mutually state that this Joint Resolution and Agreement sets forth all the conditions for the merger of the area designated herein for such merger and orderly annexation, and that no consideration by the office of Minnesota Planning is necessary. The office of Minnesota Planning may review and comment, but must, within thirty (30) days of receipt of this Joint Resolution and Agreement, order merger and orderly annexation in accordance with its terms and conditions.

REC'D BY
MMB

NOV 10 2003

Adopted by the Corinna Township Board this 21st day of October, 2003.

CORINNA TOWNSHIP

William H Leeb
Supervisor

Attest:

D. Mowatne
Town Clerk

Adopted by the City Council of the City of Annandale this 3rd day of November, 2003.

CITY OF ANNANDALE

By

David L. Manning
Mayor

Attest:

Mary Degiovanni
City Administrator/Clerk

EXHIBIT A

All that part of Northwest Quarter of Northeast Quarter of Section 31, Township 121 North, Range 27 West, described as follows: Commencing at North quarter corner of said Section 31; thence South along quarter line 20.0 feet for point of beginning of tract to be described, thence East parallel with North line of Section 31 distant 178.2 feet; thence South parallel with West line of the Northeast Quarter of said Section 31 distant 150.0 feet, thence West parallel with the North line of said Section 31 distant 178.2 feet to the West line of the Northeast Quarter of Section 31, thence North 150 feet to the point of beginning.

REC'D BY
MMB
DEC 04 2003

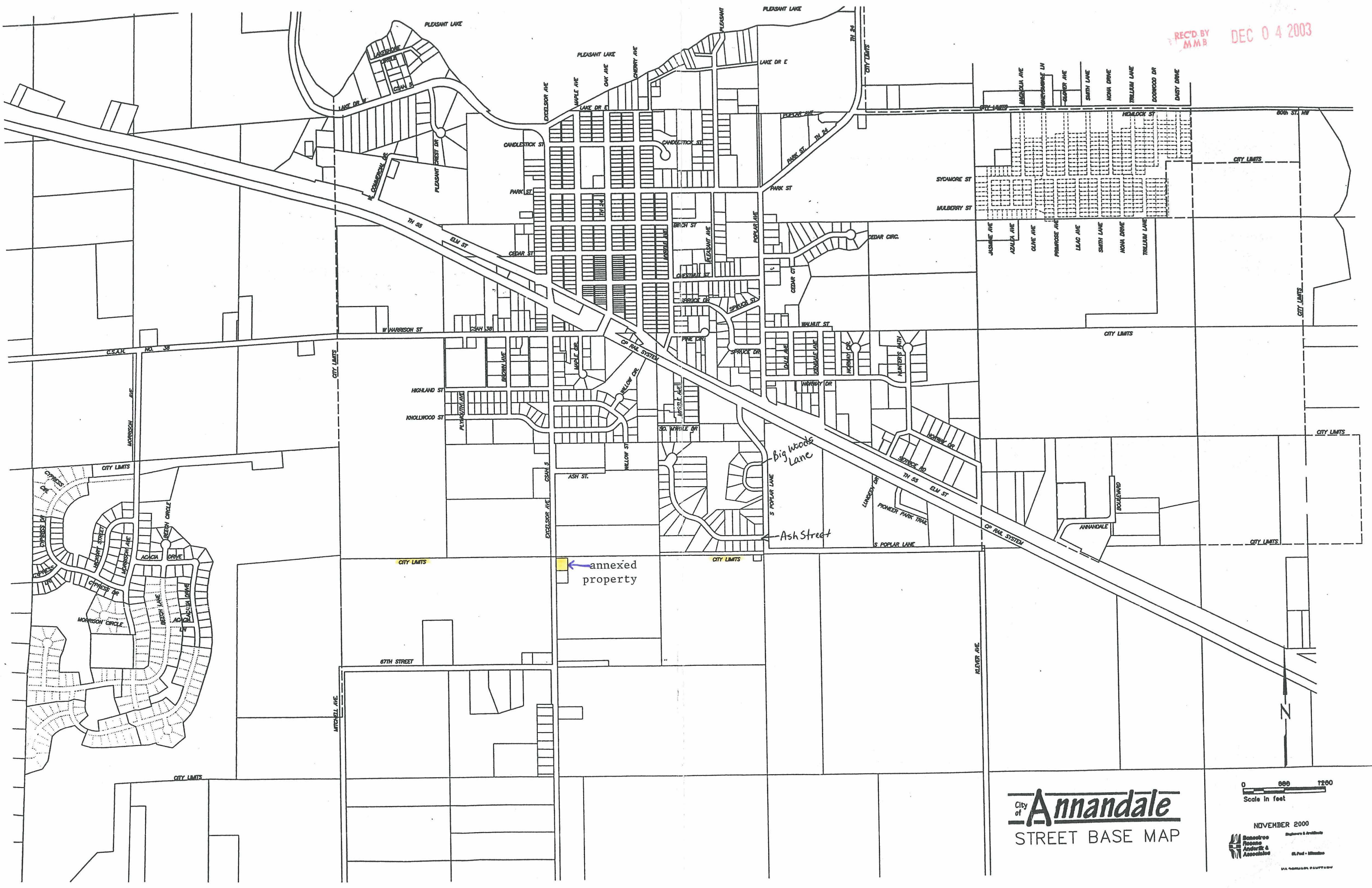

City of **Annandale**
STREET BASE MAP

0 660 1320
Scale in feet

NOVEMBER 2000
Bancroft
Rosen
Anderson &
Associates
City of Annandale
VA 22010-0000