

Resolution No. 2012-11-168

RESOLUTION ANNEXING PROPERTY IN MINDEN TOWNSHIP
TO THE CITY OF ST. CLOUD, WHICH PROPERTY IS KNOWN
AS THE JOHNSON PROPERTY,
IN ACCORDANCE WITH THE ORDERLY ANNEXATION AGREEMENT OF
FEBRUARY 12 AND 13, 2001

WHEREAS, the Town of Minden ("Town") and the City of St. Cloud ("City") are parties to a Joint Resolution as to Orderly Annexation ("Orderly Annexation Agreement") dated on or about February 13, 2001, which affects an area of the Town located south of TH 23 and west of the Elk River; and,

WHEREAS, paragraph 5 and 5.a. of the Orderly Annexation Agreement entitles the City to adopt a resolution approving annexation of property where a petition requesting annexation is signed by owners of 100% of individual parcels of record for agricultural and/or undeveloped properties in an area proposed for annexation; and,

WHEREAS, the City of St. Cloud received a written petition signed by 100% of property owners requesting annexation to the City for property referred to as the Johnson property, a copy of which was submitted to the Town on October 4, 2012; and,

WHEREAS, in accordance with paragraph 5 of the Orderly Annexation Agreement, at least 30 days have passed since submission of a copy of the annexation petition to the Town; and,

WHEREAS, the petitioning property owners have indicated a desire to have their properties annexed to facilitate development without municipal utility service; and,

WHEREAS, the subject property is located within the urban growth boundary identified in the officially adopted St. Cloud Area Joint Planning District Plan; and,

WHEREAS, annexation of the subject property will enable the City to consider extension of municipal utility services; and,

WHEREAS, the City of St. Cloud and Minden Township have agreed to all the terms and conditions for the annexation of the above-described lands; and the signatories hereto agree that no alteration of the designated area is appropriate and no consideration by the Chief Administrative Law Judge is necessary. The Chief Administrative Law Judge may review and comment, but shall within thirty (30) days, order the annexation in accordance with the terms of the resolution.

NOW, THEREFORE, BE IT RESOLVED BY THE COUNCIL OF THE CITY OF ST. CLOUD, MINNESOTA:

That the City expresses its desire and approval to cause annexation of the property legally described as the W 66 FT OF S 660 FT EXCEPT S 254 FT OF SW 1/4 NW 1/4 SECTION 31, TOWNSHIP 036, RANGE 030, Benton County, MN, containing .62 acres, more or less and depicted in map form in Exhibit A, in accordance with the Joint Resolution as to Orderly Annexation adopted by the City on February 12, 2001, and by the Town on February 13, 2001.

BE IT FURTHER RESOLVED:

Pursuant to 404.36 as provided for in paragraph 8 of the Orderly Annexation Agreement agreed to by the City and township 9-year period a portion of the property taxes collected for the subject property. In accordance with paragraph 9 of the Orderly Annexation Agreement, the subject property is not eligible for a six-year tax step-up.

REC'D BY
MBA

DEC 07 2012

That the City shall annually rebate to the Town for a 9-year period a portion of the property taxes collected for the subject property as provided for in paragraph 8 of the Orderly Annexation Agreement. In accordance with paragraph 9 of the Orderly Annexation Agreement, the subject property is not eligible for a six-year tax step-up.

Adopted this 19 day of November, 2012.



John Libert, Council President

Attest:



City Clerk

**STATE OF MINNESOTA
COUNTY OF STEARNS
CITY OF ST. CLOUD**

I Gregg A. Engdahl, City Clerk of the City of St. Cloud, Minnesota, do hereby
certify, that the above and foregoing is a true and correct copy of
Ord. # 2012-11-168 (passed-adopted) by the City
Council of the City of St. Cloud, Minnesota.

WITNESS MY HAND AND THE SEAL OF THE CITY OF ST. CLOUD,
MINNESOTA. This the 5th day of December 2012

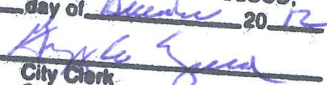

City Clerk
City of St. Cloud, MN



ENTON COUNTY
MINNESOTA

Minden Township

Benton County Minnesota

REC'D BY
MBA

DEC 07 2012

City of
St. Cloud
Minnesota



This map is neither a legally recorded map nor survey and is to be used only for reference purposes. The City of St. Cloud assumes no responsibility for actual or consequential damage incurred as a result of using this data.
Map prepared by City of St. Cloud Planning and Zoning.
Updated 11-13-12

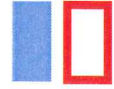

City of St. Cloud



Johnson Property - 09.00585.00

Minden Township Orderly Annexation Area Boundary



0 60 120 240 Feet

MUNICIPALITY OF
SAINT CLOUD

PREPARED BY THE
MINNESOTA DEPARTMENT OF TRANSPORTATION
OFFICE OF TRANSPORTATION DATA & ANALYSIS
IN COOPERATION WITH
U.S. DEPARTMENT OF TRANSPORTATION
FEDERAL HIGHWAY ADMINISTRATION

1600 0 1600 3200 FEET
500 0 500 1000 METERS

2011
BASIC DATA - 2010

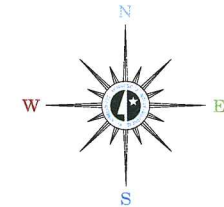

LEGEND

INTERSTATE TRUNK HIGHWAY.....
U.S. TRUNK HIGHWAY.....
STATE TRUNK HIGHWAY.....
COUNTY STATE AID HIGHWAY.....
COUNTY ROAD.....
CORPORATE LIMITS.....
PUBLIC ROAD.....
PRIVATE ROAD.....

REC'D BY
MBA

DEC 07 2012

Johnson Property
PID: 09.00585.00
.62 Acres

To request information from this document in an alternative format,
call 651-562-4718 or 1-800-527-3774 (Outside Minnesota)
711 or 1-800-527-3529 (Minnesota Relay). You may also send
an e-mail to: ADArequest@dot.state.mn.us.
(Please request at least one week in advance.)

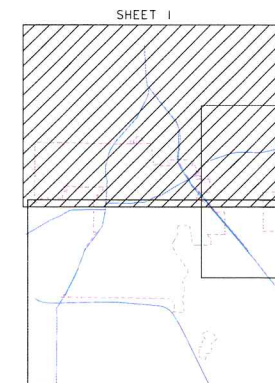

EXHIBIT A



This map is neither a legally recorded map nor survey and is to be used only for reference purposes. The City of St. Cloud assumes no responsibility for actual or consequential damage incurred as a result of using this data.

Map prepared by City of St. Cloud Planning and Zoning.
Updated 11-13-12

City of St. Cloud
Johnson Property - 09.00585.00
Minden Township Orderly Annexation Area Boundary

0 60 120 240 Feet

