

(Reserved for Recording Information)

**IN THE MATTER OF THE JOINT
RESOLUTION OF THE TOWN OF ACTON
AND THE CITY OF GROVE CITY
DESIGNATING AN UNINCORPORATED
AREA AS IN NEED OF ORDERLY
ANNEXATION AND CONFERRING
JURISDICTION OVER SAID AREA TO
THE MINNESOTA MUNICIPAL BOARD
PURSUANT TO MINN. STAT. § 414.0325**

**JOINT RESOLUTION
FOR ORDERLY ANNEXATION**

The Town of Acton and the City of Grove City hereby jointly agree to the following:

1. That the following described area in Acton Township is subject to orderly annexation pursuant to Minn. Stat. § 414.0325 and the parties hereto designate this area for orderly annexation, to-wit:

Lots U and V of Lawson's Subdivision of part of the Northeast Quarter of Northeast Quarter (NE $\frac{1}{4}$ of the NE $\frac{1}{4}$) of Section Three (3), Township One Hundred Nineteen North (119-N), Range Thirty-two West (32-W); and, that part of Lot T of Lawson's Subdivision of part of the Northeast Quarter of Northeast Quarter (NE $\frac{1}{4}$ of the NE $\frac{1}{4}$) of Section Three (3), Township One Hundred Nineteen North (119-N), Range Thirty-two West (32-W), described as follows: Beginning at the intersection of the Easterly line of Lot U of Lawson's Subdivision, a subdivision of a part of the Northeast Quarter (NE $\frac{1}{4}$) of Section Three (3), Township One Hundred Nineteen North (119-N), Range Thirty-two West (32-W), according to the recorded plat thereof now on file and of record in the Office of the County Recorder of Meeker County, Minnesota, with the South line of the Southeast Quarter (SE $\frac{1}{4}$), Section Thirty-four (34), Township One Hundred Twenty North (120-N), Range Thirty-two West (32-W); running thence East on the South line of said Southeast Quarter (SE $\frac{1}{4}$) to the intersection of the said South line with a line running parallel with and 15.00 feet Easterly from the Easterly line of said Lot U; running thence Southeasterly on and along said parallel line to its intersection with the North line of U.S. Highway No. 12; running thence Southwesterly on and along the Northerly line of said public highway to the East line of the said Lot U; running thence Northwesterly on and along the said Easterly line of the said Lot U to the point of beginning.

2. The Town Board of Acton Township and the City Council of the City of Grove City, upon passage and adoption of this resolution, and upon acceptance by the Municipal Board, confer jurisdiction upon the Municipal Board over the various provisions contained in this Agreement.
3. This property, which is essentially surrounded by and within the municipal limits of the City of Grove City, is presently urban or suburban in character. Further, the City of Grove City is capable of (or currently does) provide services to this area and the annexation is in the best interest of the area proposed for annexation. Therefore, this parcel should be immediately annexed to the City of Grove City.
4. Upon annexation, the City of Grove City shall zone all of the above-described property as "Commercial/Light Industrial". The area to be annexed is less than two (2) acres.
5. Upon annexation, the population of the City of Grove City shall increase by zero (0) persons.
6. The Township of Acton and the City of Grove City agree that no alteration of the stated boundaries of this agreement is appropriate. Furthermore, each party agrees that no consideration by the Municipal Board is necessary. The Municipal Board may review and comment, but shall, within thirty (30) days, order the annexation in accordance with the terms of this resolution.

APPROVED BY THE TOWNSHIP OF ACTON this 5 day of June, 2000.

TOWNSHIP OF ACTON

By: Donald Shishin Jr.
Town Board Chair

By: [Signature]
Town Board Clerk

APPROVED BY THE CITY OF GROVE CITY this 9th day of May, 2000.

CITY OF GROVE CITY

By: Dorothy Lindstrom
Dorothy Lindstrom, Mayor

By: Sharon Larsen
Sharon Larsen, Clerk/Treasurer

Map of Larson's Subdivision of
 Part of the NE $\frac{1}{4}$ of the NE $\frac{1}{4}$ of Section 3
 Town 19 North Range 32 West

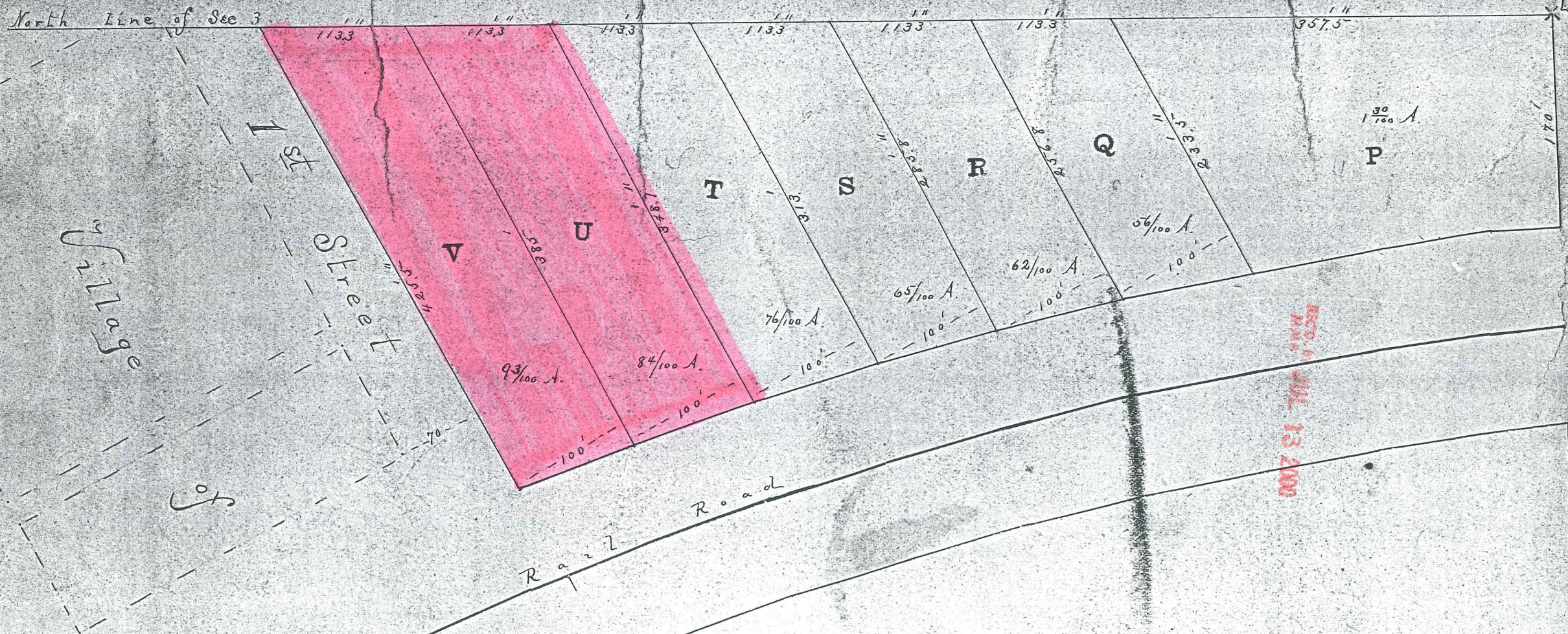

NE Corner
 119
 119

To be annexed

REC'D. BY JUL 13 2000
[MAB]