

**JOINT RESOLUTION BETWEEN THE TOWNSHIP OF MEDFORD AND
THE CITY OF MEDFORD
FOR ANNEXATION OF PART OF AREA DESIGNATED FOR
ORDERLY ANNEXATION**

WHEREAS Oakridge Bluff Properties, LLP, owner of the following described property situated in the County of Steele, State of Minnesota, to-wit:

LOTS 7, 8, 9, 10, and 11 AND THE EAST HALF OF LOT 12
IN THE EAST HALF OF SECTION 9, T 108 N, R 20 W,
STEELE COUNTY, MINNESOTA.

AND

THE WEST 5 ACRES OF THE SOUTH ONE-THIRD OF
THE SW $\frac{1}{4}$ OF THE SE $\frac{1}{4}$ OF SECTION 9, T 108 N, R 20
W, STEELE COUNTY, MINNESOTA.

CONTAINING 39.84 ACRES, MORE OR LESS.

has petitioned the Town Board for the Township of Medford and the City Council for the City of Medford for the annexation of the above-described property into the municipal limits of the City of Medford, a municipal corporation; and

WHEREAS, the above-described property is within the area designated for orderly annexation by Joint Resolution Between the Township of Medford and The City of Medford Designating an Area for Orderly Annexation on file with the Minnesota Municipal Board, said Joint Resolution dated June 8, 1999; and

WHEREAS, all conditions for the annexation of the above-described property set forth in the aforementioned Joint Resolution have been satisfied.

NOW, THEREFORE, it is hereby jointly resolved by and between the Town Board for the Township of Medford and the City Council for the City of Medford as follows:

1. The following described property situated in the County of Steele, State of Minnesota, to wit:

LOTS 7, 8, 9, 10, and 11 AND THE EAST HALF OF LOT 12
IN THE EAST HALF OF SECTION 9, T 108 N, R 20 W,
STEELE COUNTY, MINNESOTA.

AND

THE WEST 5 ACRES OF THE SOUTH ONE-THIRD OF
THE SW ¼ OF THE SE ¼ OF SECTION 9, T 108 N, R 20
W, STEELE COUNTY, MINNESOTA.

CONTAINING 39.84 ACRES, MORE OR LESS.

shall be and hereby is annexed to the City of Medford.

2. The above-described property consists of 39.84 acres, more or less. A map showing the relationship of the above-described property to the municipal limits of the City of Medford is attached hereto as Exhibit "A".
3. This Joint Resolution shall be filed with the Minnesota Municipal Board together with the appropriate filing fee.
4. No consideration by the Minnesota Municipal Board is necessary although the Board may review and comment. However, within thirty (30) days, the Board shall order the annexation in accordance with the terms of this joint resolution.

Dated this 27th day of March, 2006.

CITY OF MEDFORD:

Passed and Adopted by the City of Medford
this 27th day of March,
2006.

By: [Signature]

Its Mayor

ATTEST: [Signature]

City Clerk

TOWNSHIP OF MEDFORD:

Passed and Adopted by the Township of Medford
this 21 day of March,
2006.

By: [Signature]

Its Chairman

ATTEST: [Signature]

Town Board Clerk

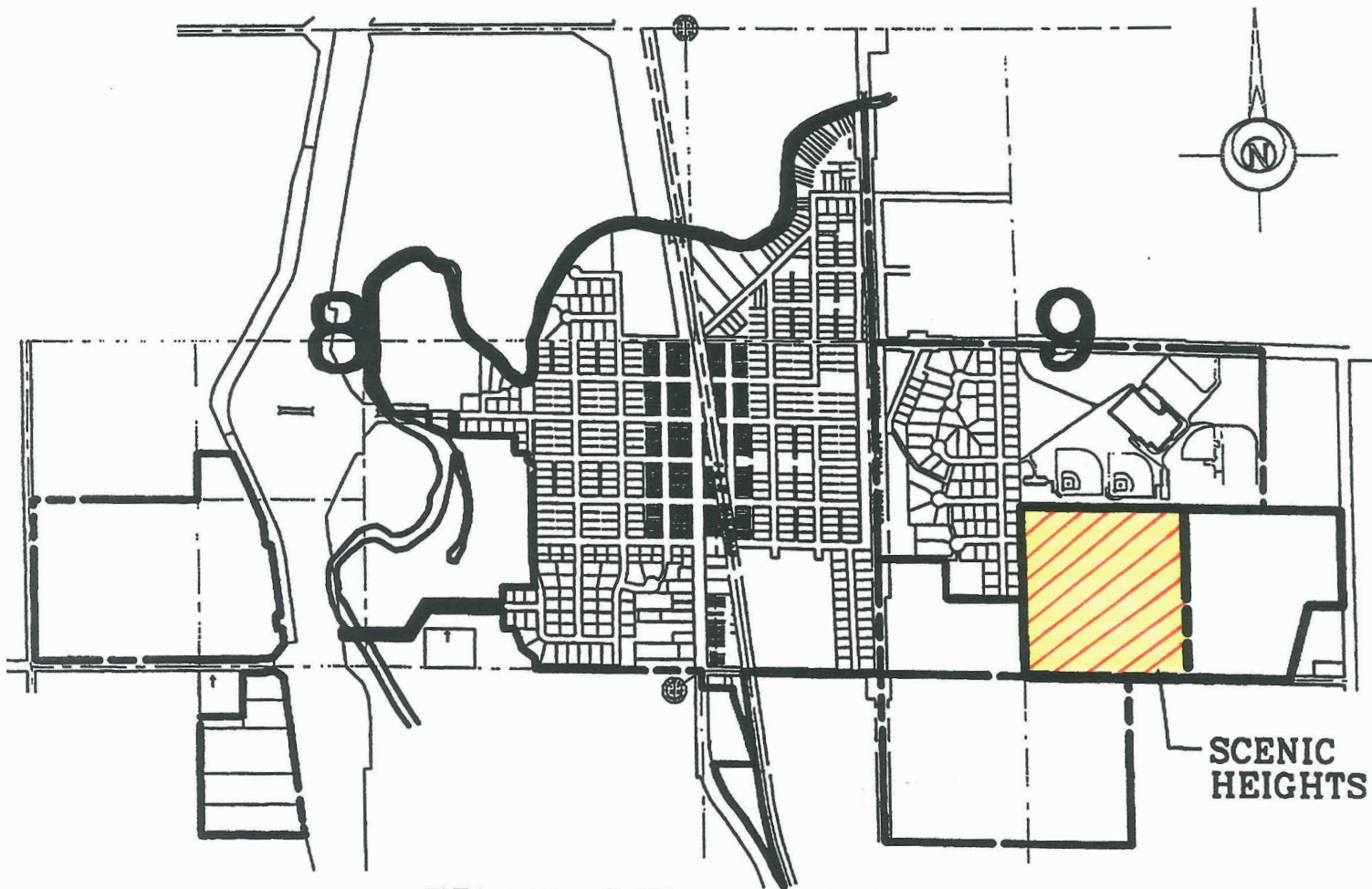

CITY OF MEDFORD

NO SCALE

SCENIC
HEIGHTS



REC'D BY
M.M.B.
MAR 29 2006