

RESOLUTION NO. 2000-9

REC'D. BY
MMB MAR 21 2000

IN THE MATTER OF THE AMENDMENT TO THE
JOINT RESOLUTION FOR ORDERLY ANNEXATION BETWEEN
THE TOWN OF MONTICELLO AND THE
CITY OF MONTICELLO, MINNESOTA
PURSUANT TO MINNESOTA STATUTES 414.0325, SUBD. 1

TO: Minnesota State Planning Agency
Municipal Boundary Adjustments
300 Centennial Building
685 Cedar Street
St. Paul, MN 55155

The Town of Monticello and the City of Monticello hereby jointly agree that the joint resolution between the Town of Monticello and the City of Monticello designating an area for orderly annexation dated March 6, 1998, be amended to include the following:

Both the Town and the City agree that no alteration of the stated boundaries of this agreement is appropriate. Furthermore, both parties agree that no consideration by the Board is necessary. Upon receipt of this resolution, the Municipal Board may review and comment but shall, within 30 days, order the annexation of the following described property in accordance with the terms of the joint resolution:

Property known as: Groveland Subdivision (Portion of Phase I)

(SEE ATTACHED LEGAL DESCRIPTION, EXHIBIT A)

And

Property known as: Hoglund parcel

(SEE ATTACHED LEGAL DESCRIPTION, EXHIBIT B)

Approved by the City of Monticello this 14th day of February, 2000.

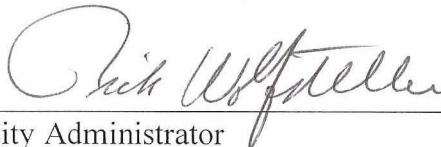
City Administrator

Mayor

Approved by the Town of Monticello this 6th day of March, 2000.

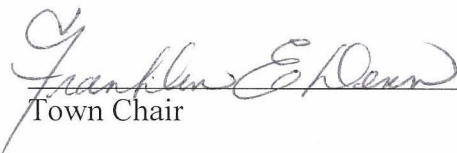
Town Chair

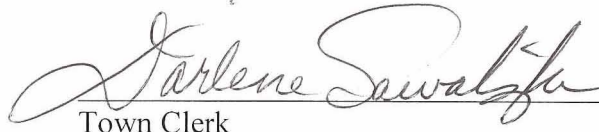
Town Clerk

LEGAL DESCRIPTION PARCEL "A"

That part of the Southeast Quarter of Section 10, and that part of the North Half of the Northeast Quarter of Section 15, all in Township 121, Range 25, Wright County, Minnesota described together as follows:

Commencing at the northeast corner of said Northeast Quarter of Section 15; thence on an assumed bearing of South 0 degrees 57 minutes 50 seconds West along the east line of said Northeast Quarter, a distance of 1300.75 feet; thence South 53 degrees 04 minutes 06 seconds West 89.99 feet; thence North 49 degrees 54 minutes 26 seconds West 157.11 feet; thence North 84 degrees 43 minutes 41 seconds West 78.81 feet; thence North 49 degrees 54 minutes 26 seconds West 240.12 feet; thence North 63 degrees 56 minutes 27 second West 128.23 feet; thence North 0 degrees 54 minutes 52 seconds East 221.02 feet; thence South 88 degrees 29 minutes 16 second West 80.07 feet; thence North 0 degrees 54 minutes 52 seconds East 158.15 feet; thence North 13 degrees 42 minutes 34 seconds West 62.01 feet; thence North 0 degrees 54 minutes 52 seconds East 145.60 feet; thence South 89 degrees 05 minutes 08 seconds East 65.62 feet; thence North 30 degrees 40 minutes 59 seconds West 96.77 feet; thence North 20 degrees 41 minutes 36 seconds West 323.56 feet; thence North 69 degrees 15 minutes 56 seconds East 60.00 feet; thence North 20 degrees 38 minutes 59 seconds West 203.00 feet to the point of beginning; thence North 69 degrees 15 minutes 56 seconds East 623.49 feet; thence North 63 degrees 33 minutes 18 seconds East 100.80 feet; thence North 64 degrees 44 minutes 47 seconds East 62.10 feet; thence North 31 degrees 40 minutes 19 seconds West 302.49 feet; thence northwesterly 381.72 feet along a tangential curve, concave to the southwest, having a radius of 500.00 feet and a central angle of 43 degrees 44 minutes 30 seconds; thence North 75 degrees 24 minutes 49 seconds West tangent to last described curve, 102.75 feet; thence North 14 degrees 35 minutes 11 seconds East 80.00 feet; thence North 75 degrees 24 minutes 49 seconds West a distance of 393.34 feet; thence northwesterly a distance of 187.94 feet along a tangential curve concave to the northeast, having a central angle of 13 degrees 27 minutes 37 seconds and a radius of 800.00 feet; thence North 61 degrees 57 minutes 12 seconds West, tangent to said curve a distance of 185.87 feet to the east line of the Southwest Quarter of the Southeast Quarter of said Section 10; thence North 0 degrees 03 minutes 41 seconds West, along said east line a distance of 89.58 feet to the north line of Lot A of the South Half of said Southeast Quarter of Section 10; thence North 88 degrees 38 minutes 27 seconds West along said north line a distance of 655.41 feet to the centerline of 90th Street Northeast according to the Monticello Township Town Road Survey thereof; thence South 45 degrees 06 minutes 16 seconds West, along said centerline, a distance of 394.94 feet; thence South 43 degrees 06 minutes 48 seconds East a distance of 179.82 feet; thence southeasterly a distance of 111.92 feet along a tangential curve, concave northeasterly having a central angle of 12 degrees 49 minutes 31 seconds and a radius of 500.00 feet; thence South 55 degrees 56 minutes 19 seconds East, tangent to said curve, a distance of 22.19 feet; thence South 58 degrees 05 minutes 44 seconds East a distance of 60.02 feet; thence South 33 degrees 13 minutes 00 seconds West a distance of 35.86 feet; thence southwesterly a distance of 62.19 feet along a tangential curve concave westerly having a central angle of 6 degrees 43 minutes 22 seconds and a radius of 530.00 feet; thence South 50 degrees 03 minutes 37 seconds East, not tangent to said curve, a distance of 125.11 feet; thence South 29 degrees 34 minutes 11 seconds West a distance of 56.65 feet; thence South 55 degrees 01 minutes 01 seconds East a distance of 458.93 feet;

REC'D. BY MAR 21 2000
MMB

thence North 40 degrees 24 minutes 48 seconds East a distance of 122.87 feet; thence South 49 degrees 35 minutes 12 seconds East a distance of 150.00 feet; thence North 86 degrees 00 minutes 18 seconds East a distance of 78.77 feet; thence South 54 degrees 46 minutes 20 seconds East a distance of 119.12 feet; thence South 75 degrees 24 minutes 32 seconds East a distance of 327.29 feet; thence North 69 degrees 15 minutes 56 seconds East a distance of 54.07 feet; thence South 20 degrees 44 minutes 04 seconds East a distance of 119.32 feet; thence North 69 degrees 15 minutes 56 seconds East a distance of 20.21 feet to the point of beginning.

LEGAL DESCRIPTION FOR PARCEL "B"

That part of the South Half of the Southeast Quarter and Lot A of the South Half of the Southeast Quarter and the North Half of the Southeast Quarter of Section 10, Township 121, Range 25, Wright County, Minnesota described as follows:

Commencing at the southeast corner of said Southeast Quarter of Section 10; thence on an assumed bearing of North 00 degrees 00 minutes 00 seconds East along the east line of said Southeast Quarter a distance of 861.29 feet; thence North 75 degrees 37 minutes 37 seconds West a distance of 1011.83 feet to the point of beginning; thence return South 75 degrees 37 minutes 37 seconds East a distance of 260.09 feet; thence South 01 degrees 03 minutes 39 seconds East a distance of 68.47 feet; thence North 75 degrees 37 minutes 37 seconds West a distance of 305.00 feet to the south line of said Lot A of the South Half of the Southeast Quarter; thence North 88 degrees 51 minutes 21 seconds West along said south line of Lot A a distance of 299.13 feet to the northerly extension of the east line of the Southwest Quarter of said Southeast Quarter; thence North 00 degrees 16 minutes 26 seconds West along said extended line a distance of 295.77 feet to the north line of said Lot A of the South Half of the Southeast Quarter; thence North 88 degrees 51 minutes 21 seconds West along said North line a distance of 655.41 feet to the centerline of 90th Street North East according to the Monticello Township Town Road survey thereof; thence northeasterly along said centerline to the former right of way line of Interstate Highway Number 94; thence southeasterly, northeasterly, easterly and southeasterly along said right of way line to a line which bears North 00 degrees 00 minutes 00 seconds East from the point of beginning; thence South 00 degrees 00 minutes 00 seconds West to the point of beginning.

REC'D. BY MAR 21 2000
M M B

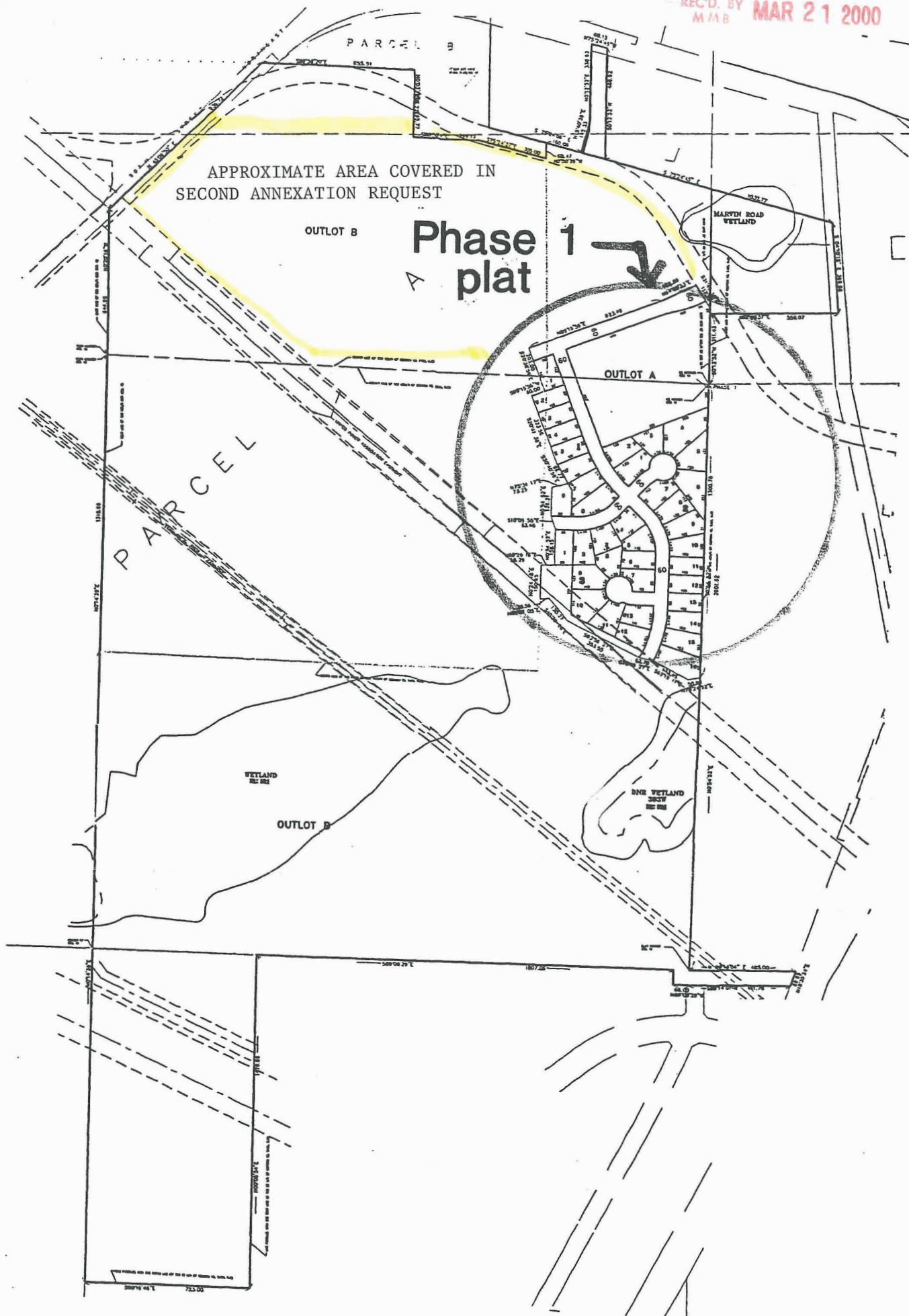



MFRA
McCombs Frank Roos
Associates, Inc.

15250 23rd Avenue North • Plymouth, Minnesota • 55447
phone 612/476-8010 • fax 612/476-8532
E-Mail: code@mfrainc.com

Ocello, LLC.
10738 Hanson Blvd., NW
Coon Rapids, MN 55433
(612) 755-8554

Groveland
Monticello, MN

Zoning and Land Use, Location, and General Development Plan

I hereby certify that this plan was prepared by
me or under my direct supervision and that
I am a duly Registered Professional Engineer
under the laws of the State of Minnesota

Name Daniel M. Jones Daniel M. Jones
Date 6/14/79
Registration Number 1E919

Designed AMF Drawn AMF
 Drawn AMF Approved AMF
 Date 12/13/24

Revisions

[illegible]

Sheet Revision

1/9 A

MEFRA FILE NO.: 11673

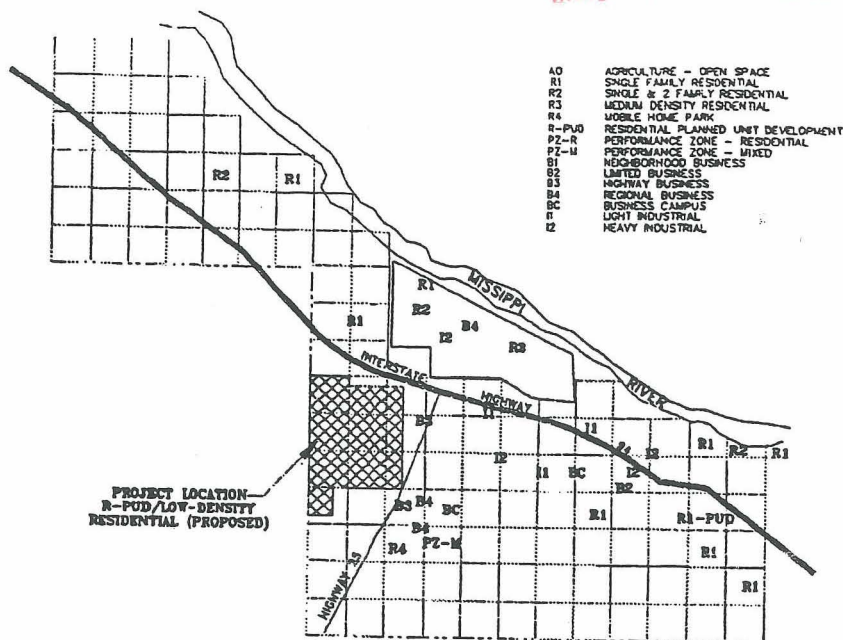

ZONING AND LAND USE MAP

NOT TO SCALE

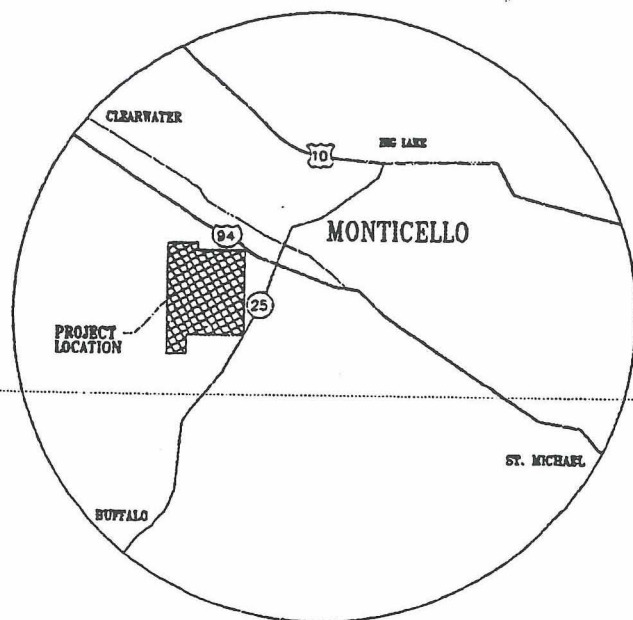

VICINITY MAP

NOT TO SCALE

INDEX OF DRAWINGS

No.	Drawing Title
1	Property Ownership, Location & Zoning
2	Existing Natural Features
3	Preliminary Plat, North Half
4	Preliminary Plat, South Half
5	Preliminary Grading Plan, North Half
6	Preliminary Grading Plan, South Half
7	Preliminary Utility Plan, North Half
8	Preliminary Utility Plan, South Half
9	Preliminary Final Plat

REC'D. BY
MMB MAR 21 2000

"Second"
ANNEXATION PARCEL

SCALE: 1" = 300'
EDM 11673
ANNEXATION SKETCH
MFRA, INC.

K:\sdskpro\j\Enr\11673\dwg\fnad.dwg 01/06/00 09:05:47 AM AM CST

PRINTED

JAN 20 2000

McCombe Frank
Rees Assoc., Inc.