

RESOLUTION NO. 2005-40**A RESOLUTION GRANTING ANNEXATION OF PROPERTY INTO THE CITY OF
SAUK RAPIDS (Windsor Estates)**

Whereas, a request was received to annex the below legal description in Benton County, Minnesota, and

Whereas, and the City Council and the Township and the property owner agree to the annexation.

NOW THEREFORE BE IT RESOLVED BY THE CITY OF SAUK RAPIDS CITY COUNCIL THAT:

1. The following described property will be annexed:

That part of the Northwest Quarter of the Southeast Quarter of Section 13, Township 13, Range 36, Benton County, Minnesota, described as follows:

Commencing at the South Quarter Corner of said Section 13; thence North 01 degrees 47 minutes 00 seconds West, assumed bearing, along the west line of the Southeast Quarter of said Section 13, a distance of 2685.25 feet, to the northwest corner of said Northwest Quarter of the Southeast Quarter, to the point of beginning of said described property; thence North 89 degrees 24 minutes 41 seconds East, along the north line of said Northwest Quarter of the Southeast Quarter, a distance of 1332.32 feet, to the northeast corner of said Northwest Quarter of the Southeast Quarter; thence South 01 degrees 43 minutes 49 seconds East, along the east line of said Northwest Quarter of the Southeast Quarter, a distance of 1034.00 feet; thence South 88 degrees 43 minutes 44 seconds West, a distance of 243.80 feet; thence North 04 degrees 20 minutes 30 seconds West, a distance of 404.23 feet; thence South 89 degrees 59 minutes 24 seconds West, a distance of 1069.86 feet, to the said west line; thence North 01 degrees 47 minutes 00 seconds West, along said west line, a distance of 622.67 feet to the point of beginning.

Less and Except

That part of the Northwest Quarter of the Southeast Quarter of Section 13, Township 36, Range 31, Benton County, Minnesota, described as follows:

Commencing at the northeast corner of said Northwest Quarter of the Southeast Quarter; thence South 01 degree 43 minutes 49 seconds East, assumed bearing along the east line of said Northwest Quarter of the Southeast Quarter, a distance of 252.46 feet to the point of beginning of the land to be described; thence continuing South 01 degree 43 minutes 49 seconds East, along said east line, a distance of 781.54 feet; thence South 88 degrees 43 minutes 44 seconds West a distance of 243.80 feet; thence North 04 degrees 20 minutes 30 seconds West distance of 404.23 feet; thence South 89 degrees 59 minutes 24

seconds West a distance of 47.00 feet; thence North 24 degrees 00 minutes 37 seconds East a distance of 134.93 feet; thence North 22 degrees 48 minutes 04 seconds East a distance of 275.09 feet to the intersection with a line bearing South 87 degrees 11 minutes 22 seconds West from the point of beginning; thence North 87 degrees 11 minutes 22 seconds East, along said line, a distance of 136.40 feet to the point of beginning.

2. That the quantity of land described above is approximately seventeen and three tenths (17.3) acres.
3. In accord with MSA 414.0325 and the existing Orderly Annexation Agreement between the City of Sauk Rapids and Sauk Rapids Township (OA-493-10), Minnesota Municipal Boundary Adjustments is asked to approve the annexation.
4. The Town and the City mutually agree that no alteration of the boundaries of the annexation area is necessary or appropriate. The Department of Administration may review and comment, but shall within 30 days, order the annexation in accordance with the terms of the resolution.

Adopted this 25th day of April, 2005.

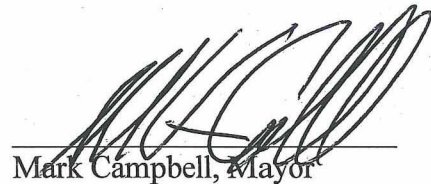
Mark Campbell, Mayor

ATTEST:

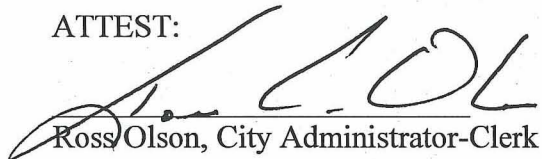
Ross Olson, City Administrator-Clerk

CITY OF SAUK RAPIDS, BENTON COUNTY, MINNESOTA
EXISTING ZONING: AGRICULTURAL PROPOSED ZONING: PUD

17.3 ACRES +/-

TOTAL LOTS = 48
CHURCH HILL EAST PLAT 2

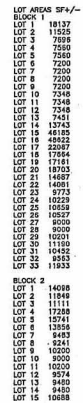

Land Description

That part of the Northwest Quarter of the Southeast Quarter of Section 13, Township 13, Range 26, Benton County, Minnesota, described as follows:

A line beginning at the NW corner of said Section 13; thence North 01 degrees 47 minutes 00 seconds West, assumed bearing, along the west line of the Southeast Quarter of said Section 13, a distance of 189.5 feet to the NW corner of said Section 13; thence North 01 degrees 47 minutes 00 seconds East, along the east line of the Southeast Quarter of said Section 13, a distance of 189.5 feet to the NE corner of said Section 13; thence North 89 degrees 24 minutes 41 seconds East, along the north line of the Southeast Quarter of said Section 13, a distance of 105.85 feet to the NE corner of said Northwest Quarter of the Southeast Quarter of Section 13; thence South 01 degree 43 minutes 40 seconds East, along the east line of the Northwest Quarter of said Section 13, a distance of 105.85 feet to the SE corner of said Northwest Quarter of the Southeast Quarter of Section 13; thence South 88 degrees 43 minutes 44 seconds West, a distance of 243.80 feet; thence North 04 degrees 20 minutes 30 seconds East, a distance of 105.85 feet to the SE corner of said Northwest Quarter of the Southeast Quarter of Section 13; thence North 01 degree 47 minutes 00 seconds West, along said west line, a distance of 632.67 feet to the point of beginning.

Loan and Except

That part of the Northwest Quarter of the Southeast Quarter of Section 13, Township 36, Range 31, Benton County, Minnesota, described as follows:

Commanding at the north corner east of North Quarter of the Southeast Quarter; thence South 01 degrees 43 minutes 49 seconds East, assumed bearing along the east line of said North Quarter of the Southeast Quarter, a distance of 252.46 feet to the point of beginning of the land to be described; thence South 01 degrees 01 minutes 01 seconds East, a distance of 48.00 feet to the point of beginning of the land to be described; thence South 88 degrees 45 minutes 44 seconds West a distance of 243.80 feet; thence North 04 degrees 20 minutes 30 seconds West a distance of 404.23 feet; thence South 89 degrees 58 minutes 24 seconds East, a distance of 20.00 feet to the point of beginning of the land to be described; thence North 89 degrees 58 minutes 24 seconds East, a distance of 14.93 feet; thence North 22 degrees 48 minutes 04 seconds East a distance of 275.09 feet to the intersection with a line bearing South 87 degrees 11 minutes 22 seconds West from the point of beginning; thence South 87 degrees 11 minutes 22 seconds East, along said line, a distance of 130.40 feet to the point of beginning.

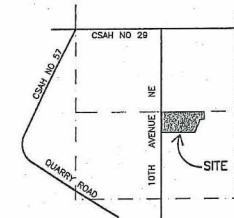

VICINITY MAP
SECTION 13, T36N, R31W

OWNER AND DEVELOPER:

CROAT LAND COMPANY
1407 33RD STREET SOUTH
ST. CLOUD, MN 56301
(320) 251-1255

Surveying & Engineering Professionals Inc.
80 10th Ave. South
Walters Park, Mn 56387
(320) 259-8888

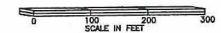

○ DENOTES IRON MONUMENT SET
● DENOTES IRON MONUMENT FOUND

DRAINAGE AND UTILITY EASEMENTS ARE SHOWN THUS:



BEING 5 FEET IN WIDTH, UNLESS OTHERWISE INDICATED, AND ADJOINING LOT LINES, AND 10 FEET IN WIDTH AND ADJOINING STREET LINES, AS SHOWN ON THE PLAT.

REVISED: 04/13/2005
03/31/2005
03/28/2005
03/25/2005
03/18/2005
03/15/2005
03/10/2005
04124

I HEREBY CERTIFY THAT THIS PLAN, SURVEY, OR REPORT
WAS PREPARED BY ME OR UNDER MY DIRECT SUPERVISION AND
THAT I AM A DULY LICENSED LAND SURVEYOR UNDER THE LAWS
OF THE STATE OF MINNESOTA.

Linda H. Brown
LINDA H. BROWN

DATE 02/15/2005 LICENSE NO. 23682

..\\survey\\2004\\04124\\preliminary\\04124pp.doc

REC'D BY
MMB
MAY 12 2005