

RESOLUTION 94-251

Introduced by Councilor Mathison

Seconded by Councilor Bachtle

A JOINT RESOLUTION OF ALBERT LEA TOWNSHIP AND THE CITY OF ALBERT LEA DESIGNATING AN UNINCORPORATED AREA AS IN NEED OF ORDERLY ANNEXATION AND CONFERRING JURISDICTION OVER SAID AREA TO THE MINNESOTA MUNICIPAL BOARD PURSUANT TO M.S. §414.0325

WHEREAS, the Township of Albert Lea and the City of Albert Lea hereby jointly agree to the following; now, therefore

THE CITY OF ALBERT LEA RESOLVES:

Sec. 1. That the following described area in Albert Lea Township is subject to orderly annexation pursuant to Minnesota Statutes 414.0325, and the parties hereto designate this area for orderly annexation:

That part of the west 1/2 of the NW 1/4 of Section 7, Township 102N, Range 21W which lies west of a line which is 729.16 feet east of and parallel to the west line of said Section and east of a line which is 400 ft east of and parallel to the west line of said Section, and extending southerly to the north right-of-way line of the Soo Line Railroad (formerly Chicago Milwaukee St. Paul and Pacific Railroad)

Containing 14.36 acres more or less.

Sec. 2. That the area described is in need of orderly annexation and no alteration of the stated boundaries is appropriate, that this resolution sets conditions for annexation and municipal board consideration is not necessary.

Sec. 3. That the Township of Albert Lea does, upon passage of this resolution and its adoption by the City Council of the City of Albert Lea, Minnesota, and upon acceptance by the Municipal Board, confer jurisdiction upon the Minnesota Municipal Board over the various provisions contained in this agreement.

Sec. 4. That certain properties abutting the City of Albert Lea are presently urban or suburban in nature or about to become so. Further, the City of Albert Lea is capable of providing services to this area within a reasonable time, or the existing township form of government is not adequate to protect the public health, safety or welfare, or the annexation would be in the best interests of the area proposed for annexation. Therefore, these properties would be immediately annexed to the City of Albert Lea. This area is described as follows:

That part of the west 1/2 of the NW 1/4 of Section 7, Township 102N, Range 21W which lies west of a line which is 729.16 feet east of and parallel to the west line of said Section and east of a line which is 400 ft east of and parallel to the west line of said Section, and extending southerly to the north right-of-way line of the Soo Line Railroad (formerly Chicago Milwaukee St. Paul and Pacific Railroad)

Containing 14.36 acres more or less.

Sec. 5. That the City agrees to investigate the possibility of sharing facilities, equipment, and personnel with the township to forestall the duplication of facilities and to reduce the overall costs of government in the area.

Sec. 6. That the effect of annexations on population shall be resolved whenever possible by agreement of parties. If there is failure to reach such agreement, the question shall be resolved by the Minnesota Municipal Board.

Sec. 7. That planning throughout the orderly annexation area shall be pursuant to Minnesota Statutes 414.0325: Planning and zoning for the area shall be provided by the City of Albert Lea.

Sec. 8. That any person owning lands annexed to the City pursuant to this agreement shall have all rights provided by statute and Resolution 94-173 of the City of Albert Lea governing special assessments. That the customary hookup charge approved for property in the City shall be used for connection to City utilities.

Sec. 9. That reading of this resolution is waived by council consent.

Sec. 10. That publication of this resolution shall be dispensed with under provisions of Section 3.08 of the Charter of the City of Albert Lea.

Introduced, read and passed November 14, 1994.

ATTEST:

CITY OF ALBERT LEA, MINNESOTA

Sandi Behrens  
City Clerk

Mavis Alvingen  
Mayor

DEC 15 1994

TOWNSHIP OF ALBERT LEA

Passed and adopted by the Township Board of the Township of  
Albert Lea this 7<sup>th</sup> day of DEC, 1994.

ATTEST:

Mark F. Koala  
Township Clerk

Robert H. Sorenson  
Township Chair

STATE OF MINNESOTA }  
COUNTY OF FREEBORN } ss  
CITY OF ALBERT LEA }

I hereby certify that I have compared the  
within instrument with the original now on file  
in my office and that it is a true and correct  
copy of the same and of the whole thereof.

Dated December 8, 1994

City Clerk Sandi Ekrem

By authorized deputy \_\_\_\_\_

H. Harry D. Neel

WHITE  
LAKE

179.82

REC'D BY  
M.M.R. DEC 15 1994

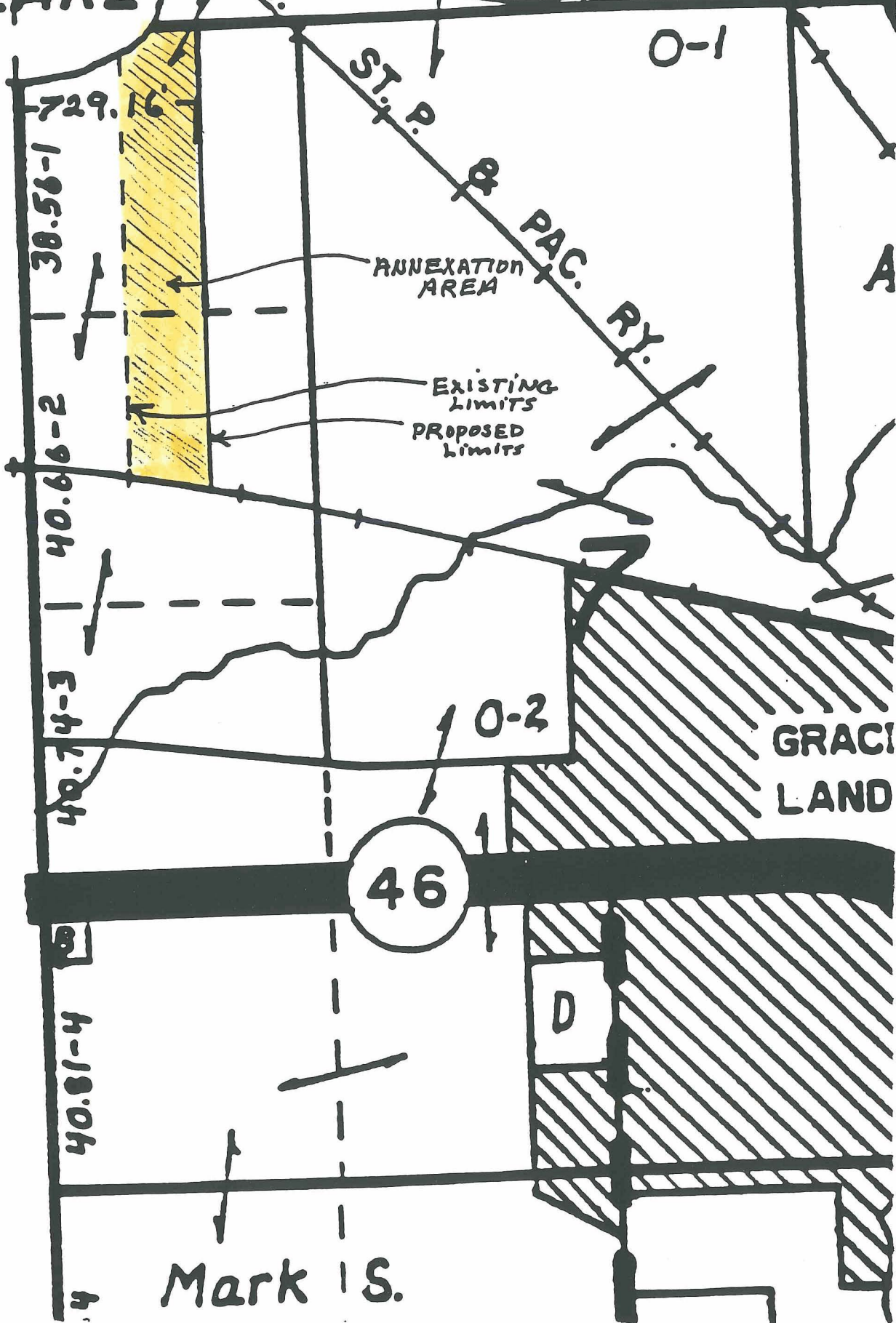



# LAKE CHAPEAU

REC'D BY  
M.M.R. DEC 15 1994

ANNEXXATION  
AREA

EDGEWATER  
BAY

EDGEWATER  
PARK

COUNTRY CLUB

SKYLINE MALL SUB  
BLOCK 1

GRACE AND  
CEMETERY

SHOFF  
PARK

LUTHERAN  
SUB

DANE BAY

WEDGEWOOD ROAD

LAKE CHAPEAU DR

LAKE CHAPEAU DR

LAKE CHAPEAU DR

LAKE CHAPEAU DR

LAKE CHAPEAU DR

LAKE CHAPEAU DR

LAKE CHAPEAU DR

LAKE CHAPEAU DR

LAKE CHAPEAU DR

LAKE CHAPEAU DR

LAKE CHAPEAU DR

LAKE CHAPEAU DR

LAKE CHAPEAU DR

LAKE CHAPEAU DR

LAKE CHAPEAU DR



DEC 15 1994

CODE LETTER AB

