

RESOLUTION R-91-48  
JOINT RESOLUTION BETWEEN THE  
TOWN OF FRANKLIN AND THE CITY OF DELANO  
DESIGNATING AN AREA FOR ORDERLY ANNEXATION

REC'D. BY  
MMB JUL 25 1991

The Town of Franklin and the City of Delano hereby jointly agree and resolve as follows:

1. Franklin and Delano hereby designate for orderly annexation that certain land lying within the Town of Franklin and legally described in Exhibit A attached hereto and made a part hereof.

2. The Town of Franklin and City of Delano do, upon their adoption and upon acceptance by the Minnesota Municipal Board, confer jurisdiction upon the Minnesota Municipal Board over the Property so as to accomplish said orderly annexation in accordance with the terms of this Resolution. No consideration by the Minnesota Municipal Board is necessary, the Board may review and comment, but shall, within thirty (30) days, order the annexation in accordance with the terms of this Joint Resolution. No alteration of the stated boundaries of the orderly annexation area is appropriate. The Property shall be annexed to the City of Delano upon the Minnesota Municipal Board's order.

3. The Property is abutting the City of Delano and is presently urban or suburban in nature or is about to become so. Further, the City of Delano is now in the process of improving the Property by constructing thereon roadways adequate to provide access to urban, residential areas.

4. Property owners who abut on the Property shall be

afforded reasonable vehicular access to the Property at all times. No party shall take actions which prevent or obstruct reasonable vehicular use of the Property.

This Agreement and Resolution shall be effective upon passage by both the City Council of the City of Delano and the Town Board of the Town of Franklin.

CITY OF DELANO

By [Signature]  
Its MAYOR

Approved by the City Council of City of Delano this 16<sup>th</sup> day of July, 1991.

Motion By: Mathisen  
Second By: Poss  
Poss: Aye  
Jaunich: Aye  
Nagel: Aye  
Mathisen: Aye  
Bartels: Aye

Marlene E. Kitchcock, Clerk  
TOWNSHIP OF FRANKLIN

By John H. Vandevliet  
Its Chairman

Approved by the Board of the Township of Franklin this 1<sup>st</sup> day of July, 1991.

Roma Chadwick Clerk

1500.102C

EXHIBIT A

REC'D BY JUL 25 1991  
MME

That part of the East 33 feet of the Northeast Quarter of Section 13, Township 118, Range 25, Wright County, Minnesota that lies North of the North line of Maplewood Drive, according to the recorded plat of Maplewood Estates.



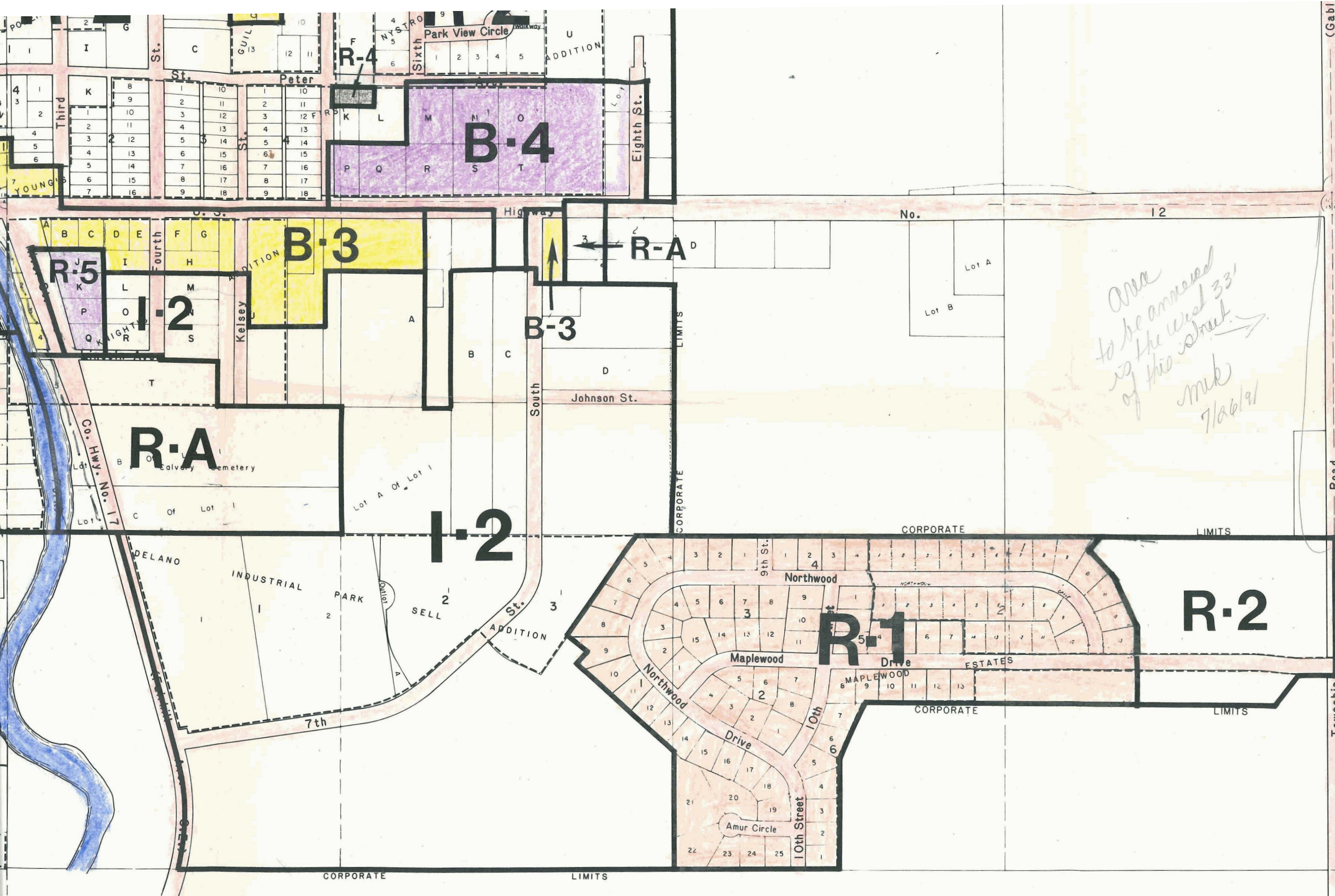

## BUSINESS DISTRICT

- B-1 NEIGHBORHOOD
- B-2 LIMITED
- B-3 AUTO-ORIENTED
- B-4 GENERAL
- B-5 CENTRAL
- B-W BUSINESS/WAREHOUSE

## INDUSTRIAL DISTRICT

- I-1 LIMITED
- I-2 GENERAL

## SPECIAL DISTRICT

- PUD PLANNED UNIT DEVELOPMENT
- [FP] FLOOD PLAIN
- S SHORELAND
- W WETLAND SYSTEM

CITY  
OF  
DELANO



MEYER-ROHLIN, INC.  
ENGINEERS-LAND SURVEYORS  
1111 Hwy. 25N., Buffalo, Minn. 55313

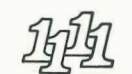

NOTE: IT IS RECOMMENDED THAT IN ADDITION TO THIS ZONING MAP, CITY FILES BE CONSULTED TO VERIFY THE DISTRICT CLASSIFICATION OF PROPERTY.  
\* EXACT BOUNDARY REQUIRES DETAILED CALCULATION BY THE ZONING ADMINISTRATOR

REVISED:	
AB	2-82
AB	12-82
AB	3-83
SS	8-87
JRL	1-88
KPA	11-88