

RESOLUTION NO. 2-06-03

RESOLUTION AMENDING JOINT RESOLUTION FOR ORDERLY ANNEXATION  
BETWEEN THE TOWN OF ST. JAMES AND THE CITY OF ST. JAMES,  
WATONWAN COUNTY, MINNESOTA, PURSUANT TO MINNESOTA  
STATUTES SECTION 414.0325, SUBD 1

WHEREAS, the Town of St. James along with the City of St. James, Minnesota, entered into a joint resolution of orderly annexation on August 15, 1989; and

WHEREAS, the City of St. James has received a Petition from the landowner of the certain described property more specifically described in Exhibit "A" attached hereto and incorporated herein by reference requesting that the City of St. James annex said property, in that the property is urban and residential in character, the City of St. James is desirous of annexing said property, it being located within the orderly annexation areas described in said Resolution.

NOW, THEREFORE, BE IT RESOLVED BY THE CITY COUNCIL OF THE CITY OF ST. JAMES AND THE TOWN BOARD OF ST. JAMES that they hereby jointly agree that the joint resolution between the Town of St. James and the City of St. James designated an area for annexation dated August 15, 1989, be amended to include the following:

Both the Town of St. James and the City of St. James agree that no resolution of the stated boundaries of

MAR 10 2006

this agreement is appropriate. Furthermore, both parties agree that no consideration by the Office of Strategic and Long Range Planning is necessary. Upon receipt of this resolution, the Office of Strategic and Long Range Planning may review and comment, but shall, within thirty (30) days, order the annexation to the City of St. James with the following described property in accordance with the terms of the joint resolution. (See attached Exhibit "A").

Adopted by the City of St. James, Minnesota, this 21  
day of February, 2006.

Gary L. Sturm  
Gary L. Sturm, Mayor

ATTEST:

Dee Ann M. Nibbe  
City ~~Manager~~/Clerk

Adopted by the Township Board of St. James, Minnesota,  
this 28 day of February, 2006.

Henry Kohn  
Chairman

ATTEST:

Mary Anderson  
Clerk

SRS/as

"ATTACHMENT A"

REC'D BY  
MMB

MAR 10 2006

**LEGAL DESCRIPTION**

Part of the Northwest Quarter of Section 24, Township 106 North, Range 32 West, Watonwan County, Minnesota, described as: Commencing at the Northwest Corner of SORENSEN'S FIFTH ADDITION to the City of St. James, according to the recorded plat thereof; thence South 00 degrees 05 minutes 39 seconds East (bearings based on SORENSEN'S FIFTH ADDITION), on a West line of SORENSEN'S FIFTH ADDITION, 540.07 feet to the Easterly extension of the South line of a parcel recorded in Book 65 of Deeds, page 437; thence North 88 degrees 04 minutes 40 seconds West, along a West line of SORENSEN'S FIFTH ADDITION and said Easterly extension, a distance of 1.49 feet to a point on the West line of the East 25 acres of the South Half of said Northwest Quarter, said point also be the point of beginning; thence continuing North 88 degrees 04 minutes 40 seconds West, along the South line of said parcel Recorded in Book 65 of Deeds, page 737, a distance of 466.80 feet; thence South 00 degrees 30 minutes 56 seconds East, 467.00 feet; thence South 88 degrees 04 minutes 40 seconds East, 466.80 feet to the West line of the East 25 acres of the South Half of said Northwest Quarter; thence North 00 degrees 30 minutes 56 seconds West on said West line and said West line of SORENSEN'S FIFTH ADDITION, 467.00 feet to the point of beginning. Contains 5.00 acres and is subject to and together with any and all easements of record.

NW CORNER  
SORENSEN'S FIFTH  
ADDITON

PARCEL RECORDED IN  
BOOK 65 OF DEEDS,  
PG. 437

PLEASANT VIEW

N 88°04'40"W  
1.49

S LINE OF PARCEL RECORDED IN  
BOOK 65 OF DEEDS PG. 437

POINT OF  
BEGINNING

ANNEXATION  
AREA

5.00 ACRES

S 00°30'56"E 467.00

W LINE OF THE E 25 ACRES OF THE S  
1/2 OF THE NW 1/4

N 00°30'56"W 467.00

S 88°04'40"E 466.80

W 1/2 OF SORENSEN'S FIFTH ADD.

SECOND STREET SOUTH

SOUTHVIEW  
DRIVE

BLOCK TWO

FIFTH

ADDITION

PRAIRIE VIEW

S LINE SORENSEN'S FIFTH ADD.

# PROPOSED LEGAL DESCRIPTION

Part of the Northwest Quarter of Section 24, Township 106 North, Range 32 West, Watonwan County, Minnesota, described as: Commencing at the Northwest Corner of SORENSEN'S FIFTH ADDITION to the City of St. James, according to the recorded plat thereof; thence South 00 degrees 05 minutes 39 seconds East (bearings based on SORENSEN'S FIFTH ADDITION), on a West line of SORENSEN'S FIFTH ADDITION, 540.07 feet to the Easterly extension of the South line of a parcel recorded in Book 65 of Deeds, page 437; thence North 88 degrees 04 minutes 40 seconds West, along a West line of SORENSEN'S FIFTH ADDITION and said Easterly extension, a distance of 1.49 feet to a point on the West line of the East 25 acres of the South Half of said Northwest Quarter, said point also be the point of beginning; thence continuing North 88 degrees 04 minutes 40 seconds West, along the South line of said parcel Recorded in Book 65 of Deeds, page 737, a distance of 466.80 feet; thence South 00 degrees 30 minutes 56 seconds East, 467.00 feet; thence South 88 degrees 04 minutes 40 seconds East, 466.80 feet to the West line of the East 25 acres of the South Half of said Northwest Quarter; thence North 00 degrees 30 minutes 56 seconds West, on said West line and said West line of SORENSEN'S FIFTH ADDITION, 467.00 feet to the point of beginning. Contains 5.00 acres and is subject to and together with any and all easements of record.

## LEGEND

- 3/4" IRON PIPE MONUMENT SET  
MARKED BY REG. NO. 19789
- MONUMENT FOUND

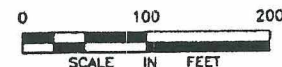

I hereby certify that this survey was prepared by me or under my direct supervision and that I am a duly licensed land surveyor under the laws of the State of Minnesota.

*Janele Fowlds*  
Janele Fowlds

Date 11-29-05 License No. 26748

CERTIFICATE OF SURVEY  
CITY OF ST. JAMES, MINNESOTA

**BOLTON & MENK, INC.**

Consulting Engineers & Surveyors

1960 PREMIER DRIVE, MANKATO, MN 56001 (507) 625-4171  
MANKATO, MN FAIRMONT, MN SLEEPY EYE, MN WILLMAR, MN  
BURNSVILLE, MN CHASKA, MN AMES, IA

PART OF THE SE 1/4-NW 1/4  
SECTION 24-106-32, CITY OF  
ST. JAMES, WATONWAN COUNTY

FOR: GOOD SAMARITAN SOCIETY

0 2006

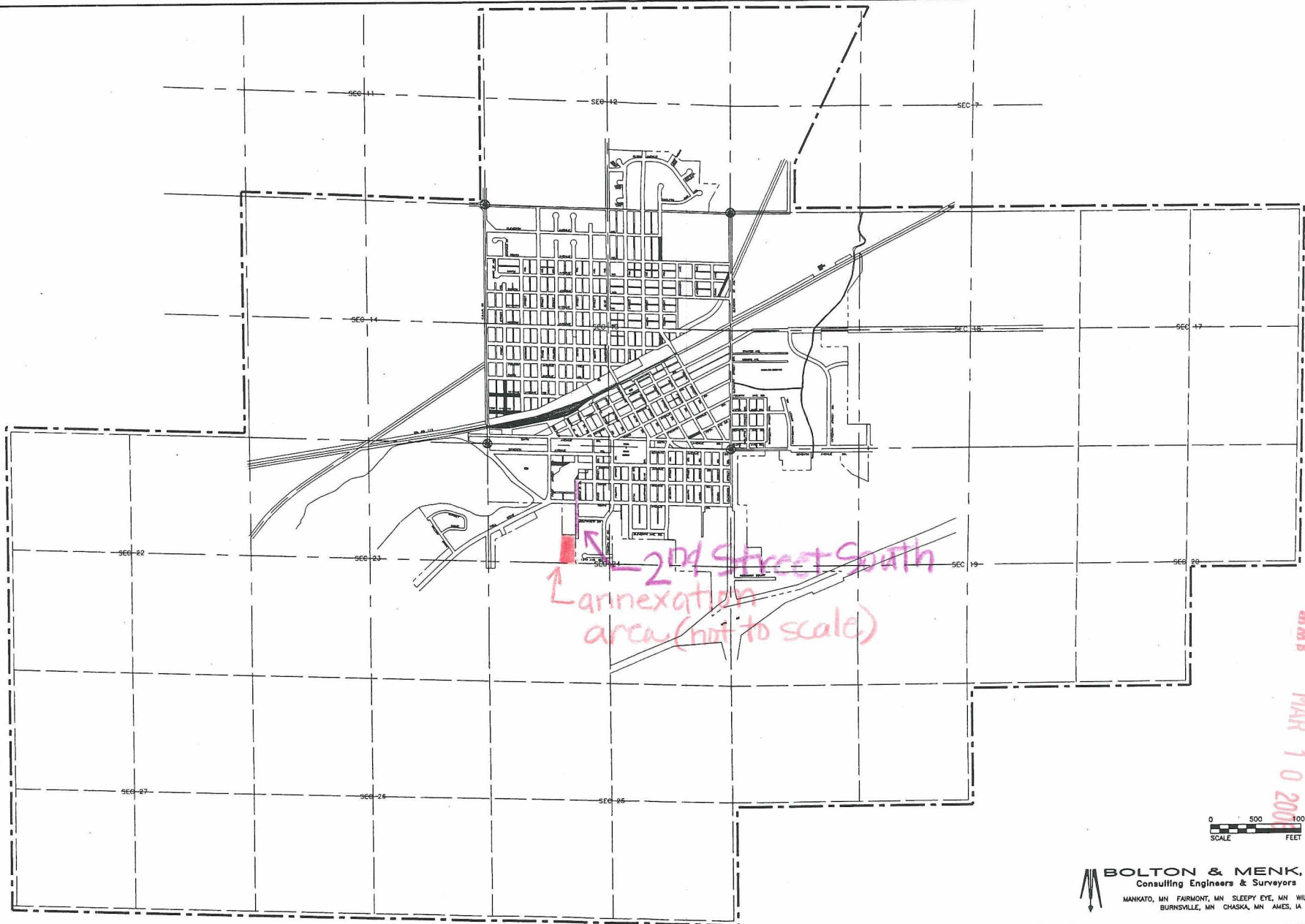

2nd Street South  
Annexation  
area (not to scale)



**BOLTON & MENK, INC.**  
Consulting Engineers & Surveyors  
MANKATO, MN FAIRMONT, MN SLEEPY EYE, MN WILLMAR, MN  
BURNSVILLE, MN CHASKA, MN AMES, IA

REC'D BY  
MAB  
MAR 10 2006