

RESOLUTION 2022-001

JOINT RESOLUTION FOR DESIGNATION OF CERTAIN LAND AND THE IMMEDIATE ANNEXATION OF ENTIRE DESIGNATED AREA.

IN THE MATTER OF THE ORDERLY ANNEXATION BETWEEN THE CITY OF DODGE CENTER AND WASIOJA TOWNSHIP PURSUANT TO MINNESOTA STATUTES § 414.0325

WHEREAS, on December 13, 2021 a Notice of Intent to include property in an orderly annexation area was published pursuant to the requirements of Minnesota Statutes § 414.0325 Subd. 1b; and

WHEREAS, the City of Dodge Center and Wasioja Township jointly agree to designate and request the immediate annexation of the following described land located within Wasioja Township to the City of Dodge Center, County of Dodge, Minnesota;

The Northeast Quarter (NE 1/4) of the Southeast Quarter (SE 1/4) of Section Thirty-five (35), Township One Hundred Seven (107) North, Range Seventeen (17) West, Dodge County, Minnesota, EXCEPTING therefrom the right-of-way of the Chicago & Northwestern Railway Company (formerly the Winona & St. Peter Railroad Company). Also excepting the right-of-way of C.S.A.H No. 34 (635th Street). Said Parcel contains 39.01 acres, more or less.

AND

The Northeast Quarter (NE 1/4) of the Southwest Quarter (SW 1/4) and the Northwest Quarter (NW 1/4) of the Southeast Quarter (SE 1/4) all in Section Thirty-five (35), Township One Hundred Seven (107) North of Range Seventeen (17) West, excepting the following:

That part of the Northeast Quarter (NE 1/4) of the Southwest Quarter (SW 1/4) and of the Northwest Quarter (NW 1/4) of the Southeast Quarter (SE 1/4) of Section 35, Township 107 North, Range 17 West, Dodge County, Minnesota, described as follows:

Beginning at the Northeast corner of the Southwest Quarter of said Section 35; for the purposes of this description the bearings are in relation to the Dodge County Coordinate System NAD83 (1996 Adjustment); thence South 89°57'56" West, along the north line of said Southwest Quarter, 607.83 feet; thence South 00°01'52" West, 574.19 feet; thence South 89°21'51" East, 607.86 feet to the east line of said Southwest Quarter; thence North 00°01'52" East, along said east line 581.30 feet to the point of beginning. And beginning at the northwest corner of the Southeast Quarter of said Section 35; thence North 89°57'56" East, along the north line of said Southeast Quarter, 145.00 feet; thence South 00°01'52" West 583.00 feet; thence North 89°21'51" West, 145.01 feet to the west line of said Southeast Quarter; thence North 00°01'52" East, along said west line, 581.30 feet to the point of beginning, Being subject to an easement for the County Road No. 34 right of way over the northerly boundary thereof.

And except Railroad right of way and subject to Highway easements of record. Also excepting the right-of-way of C.S.A.H. No. 34 (635th Street);

and

WHEREAS, the City of Dodge Center and Wasioja Township are in agreement as to the orderly annexation of the unincorporated land described; and

WHEREAS, Minnesota Statutes § 414.0325 provides a procedure whereby the City of Dodge Center and Wasioja Township may agree on a process of orderly annexation of a designated area; and

WHEREAS, the City of Dodge Center and Wasioja Township have agreed to all the terms and conditions for the annexation of the above-described lands; and the signatories hereto agree that no alteration of the designated area is appropriate and no consideration by the Chief Administrative Law Judge is necessary. The Chief Administrative Law Judge may review and comment, but shall within thirty (30) days, order the annexation in accordance with the terms of the resolution.

NOW, THEREFORE, BE IT RESOLVED, jointly by the City Council of the City of Dodge Center and the Township Board of Wasioja Township as follows:

1. **(Property.)** That the following described land is subject to orderly annexation pursuant to Minnesota Statutes § 414.0325, and that the parties hereto designate the area for orderly annexation and agree that the land be immediately annexed:

The Northeast Quarter (NE 1/4) of the Southeast Quarter (SE 1/4) of Section Thirty-five (35), Township One Hundred Seven (107) North, Range Seventeen (17) West, Dodge County, Minnesota, EXCEPTING therefrom the right-of-way of the Chicago & Northwestern Railway Company (formerly the Winona & St. Peter Railroad Company). Also excepting the right-of-way of C.S.A.H. No. 34 (635th Street). Said Parcel contains 39.01 acres, more or less.

AND

The Northeast Quarter (NE 1/4) of the Southwest Quarter (SW 1/4) and the Northwest Quarter (NW 1/4) of the Southeast Quarter (SE 1/4) all in Section Thirty-five (35), Township One Hundred Seven (107) North of Range Seventeen (17) West, excepting the following:

That part of the Northeast Quarter (NE 1/4) of the Southwest Quarter (SW 1/4) and of the Northwest Quarter (NW 1/4) of the Southeast Quarter (SE 1/4) of Section 35, Township 107 North, Range 17 West, Dodge County, Minnesota, described as follows:

Beginning at the Northeast corner of the Southwest Quarter of said Section 35; for the purposes of this description the bearings are in relation to the Dodge County Coordinate System NAD83 (1996 Adjustment); thence South 89°57'56" West, along the north line of said Southwest Quarter, 607.83 feet; thence South 00°01'52" West, 574.19 feet; thence South 89°21'51" East, 607.86 feet to the east line of said Southwest Quarter; thence North 00°01'52" East, along said east line 581.30 feet to the point of beginning. And beginning at the northwest corner of the Southeast Quarter of said Section 35; thence North 89°57'56" East, along the north line of said Southeast Quarter, 145.00 feet; thence South 00°01'52" West 583.00 feet; thence North 89°21'51" West, 145.01 feet to the west line of said Southeast Quarter; thence North 00°01'52" East, along said west line, 581.30 feet to the point of beginning, Being subject to an easement for the County Road No. 34 right of way over the northerly boundary thereof.

And except Railroad right of way and subject to Highway easements of record. Also excepting the right-of-way of C.S.A.H. No. 34 (635th Street).

2. **(Acreage/Population/Usage.)** That the orderly annexation area consists of approximately 102.6 acres, the population in the area is 0, and the land use type is **agricultural, commercial, and industrial.**

3. **(Jurisdiction.)** That Wasioja Township and the City of Dodge Center, by submission of this joint resolution to the Municipal Boundary Adjustment Unit of the Office of Administrative Hearings, confer jurisdiction upon the Chief Administrative Law Judge so as to accomplish said orderly annexation in accordance with the terms of this resolution.

4. **(Municipal Reimbursement).** Minnesota Statutes § 414.036.

a. **Reimbursement to Township for lost taxes on annexed property.**

There shall be a lump sum tax reimbursement to Wasioja Township in the amount of \$10,900.12.

5. **(Review and Comment).** The City of Dodge Center and Wasioja Township agree that upon receipt of this resolution, passed and adopted by each party, the Chief Administrative Law Judge may review and comment, but shall within thirty (30) days, order the annexation in accordance with the terms of the resolution.

Adopted by affirmative vote of all the members of the Wasioja Township Board of Supervisors this

8th day of August, 2022.

WASIOJA TOWNSHIP

By: Larry Schuler
Chairperson
Board of Supervisor

ATTEST:

By: Robert Schuler
Township Clerk

Adopted by affirmative vote of the City Council of the City of Dodge Center this 28th day of March, 2022.

CITY OF DODGE CENTER

By: Bill Kuhl
Mayor

ATTEST:

By: Byron A. Lange
City Administrator

Approved this 8th day of August, 2022.

ArcGIS WebMap

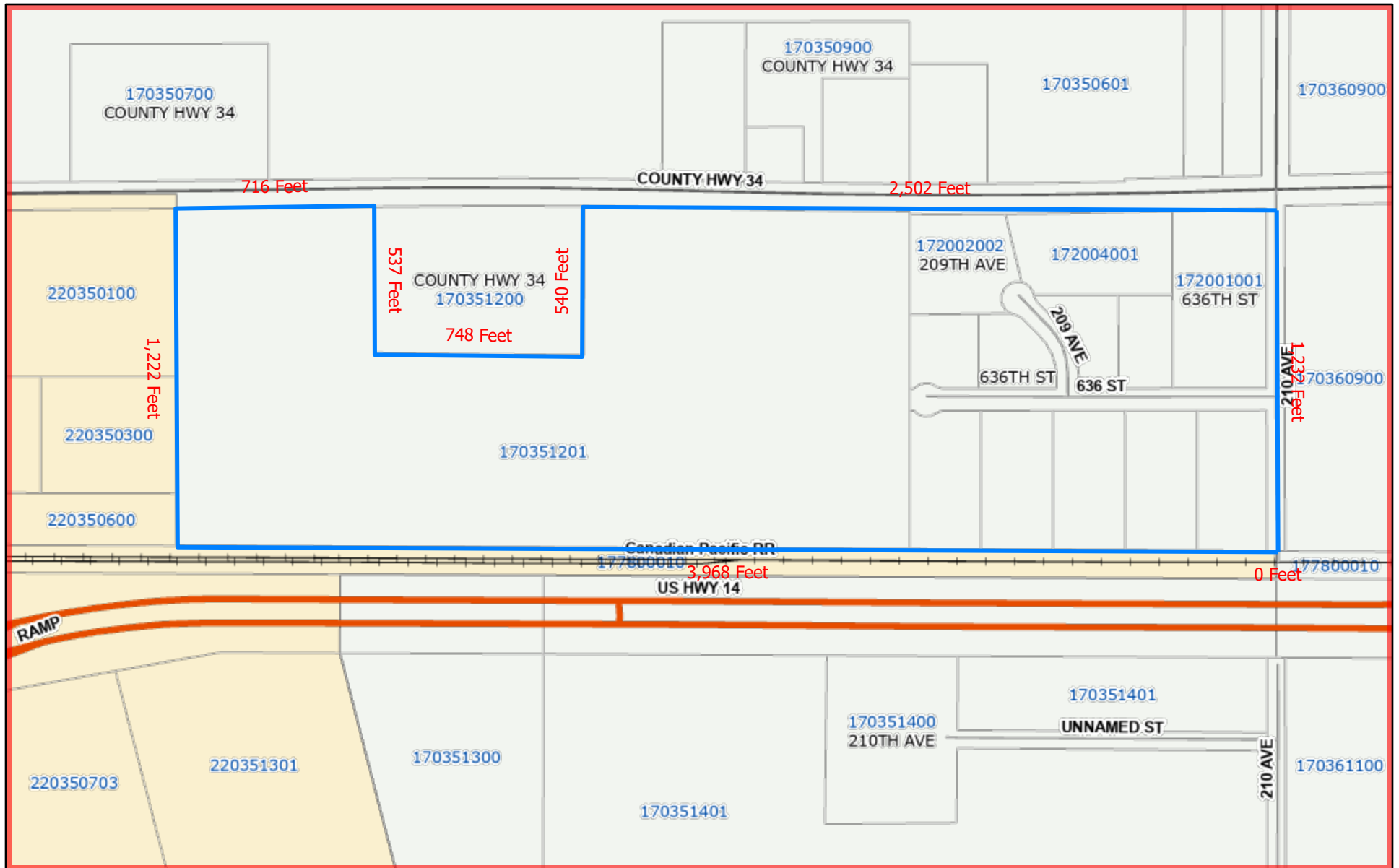

July 27, 2021

Roads

— PVT — TWP
— CSAHP — RR — USHWY

Address PIN
Parcels

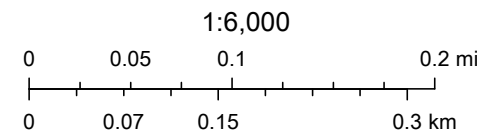

ArcGIS WebMap



July 27, 2021

Roads — CSAHG — RR — USHWY [] Unrecorded Parcels
 — CARP — CSAHP — SHWY Address [] Parcels
 — CITY — PVT — TWP PIN

