

JOINT RESOLUTION

**IN THE MATTER OF THE ORDERLY ANNEXATION BETWEEN
THE CITY OF HARMONY AND HARMONY TOWNSHIP
PURSUANT TO MINNESOTA STATUTES § 414.0325**

WHEREAS, on November 21, 2019 a Notice of Intent to include property in an orderly annexation area was published pursuant to the requirements of Minnesota Statutes § 414.0325 Subd. 1b; and

WHEREAS, the City of Harmony and Harmony Township jointly agree to designate and request the immediate annexation of the following described land located within Harmony Township to the City of Harmony, County of Fillmore, Minnesota;

The SW $\frac{1}{4}$ NW $\frac{1}{4}$ of Section 11-101-10,

EXCEPT that part of the SW $\frac{1}{4}$ NW $\frac{1}{4}$ of Section 11-101-10 within the Trunk Highway 52 right-of-way.

ALSO EXCEPTING: that part of the SW $\frac{1}{4}$ NW $\frac{1}{4}$ of Section 11-101-10, Fillmore County, Minnesota, described as follows: Commencing at the Southwest Corner of said SW $\frac{1}{4}$ NW $\frac{1}{4}$; thence North 88 degrees 50 minutes 17 seconds East (assumed bearing) along the South line of said SW $\frac{1}{4}$ NW $\frac{1}{4}$, 650.00 feet to the point of beginning of the tract of land to be herein described; thence continuing North 88 degrees 50 minutes 17 seconds East along said South line, 469.34 feet; thence North 00 degrees 05 minutes 50 seconds East, 1307.75 feet to the North line of said SW $\frac{1}{4}$ NW $\frac{1}{4}$; thence South 88 degrees 50 minutes 01 seconds West along said North line, 1062.31 feet to the Easterly Right-of-way line of Trunk Highway 52; thence South 01 degrees 34 minutes 12 seconds East along said R.O.W. line, 2.47 feet; thence Southerly 1129.95 feet along R.O.W. line and along a tangential curve, concave to the West, having a radius of 43,394.50 feet and a central angle of 01 degrees 29 minutes 31 seconds (chord bears South 00 degrees 49 minutes 26 seconds East and chord length is 1129.92 feet); thence South 45 degrees 35 minutes 16 seconds East not tangent to said curve and along said R.O.W. line, 140.00 feet; thence North 88 degrees 50 minutes 17 seconds East along said R.O.W. line, 72.89 feet; thence South 81 degrees 41 minutes 59 seconds East along said R.O.W. line, 152.07 feet; thence North 88 degrees 50 minutes 17 seconds East along said R.O.W. line, 250.00 feet; thence South 01 degrees 09 minutes 43 seconds East along said R.O.W. line, 50.00 feet to the point of beginning and containing 30.59 acres, more or less. Subject to easement for a Township Road across the Southerly line thereof.

and

WHEREAS, the City of Harmony and Harmony Township are in agreement as to the orderly annexation of the unincorporated land described; and

WHEREAS, Minnesota Statutes § 414.0325 provides a procedure whereby the City of Harmony and Harmony Township may agree on a process of orderly annexation of a designated area; and

WHEREAS, the City of Harmony and Harmony Township have agreed to all the terms and conditions for the annexation of the above-described lands; and the signatories hereto agree that no alteration of the designated area is appropriate and no consideration by the Chief Administrative

Law Judge is necessary. The Chief Administrative Law Judge may review and comment, but shall within thirty (30) days, order the annexation in accordance with the terms of the resolution.

NOW, THEREFORE, BE IT RESOLVED, jointly by the City Council of the City of Harmony and the Township Board of Harmony Township as follows:

1. **(Property.)** That the following described land is subject to orderly annexation pursuant to Minnesota Statutes § 414.0325, and that the parties hereto designate the area for orderly annexation; and agree that the land be immediately annexed:

The SW¼ NW¼ of Section 11-101-10,

EXCEPT that part of the SW¼ NW¼ of Section 11-101-10 within the Trunk Highway 52 right-of-way.

ALSO EXCEPTING: that part of the SW¼ NW¼ of Section 11-101-10, Fillmore County, Minnesota, described as follows: Commencing at the Southwest Corner of said SW¼ NW¼; thence North 88 degrees 50 minutes 17 seconds East (assumed bearing) along the South line of said SW¼ NW¼, 650.00 feet to the point of beginning of the tract of land to be herein described; thence continuing North 88 degrees 50 minutes 17 seconds East along said South line, 469.34 feet; thence North 00 degrees 05 minutes 50 seconds East, 1307.75 feet to the North line of said SW¼ NW¼; thence South 88 degrees 50 minutes 01 seconds West along said North line, 1062.31 feet to the Easterly Right-of-way line of Trunk Highway 52; thence South 01 degrees 34 minutes 12 seconds East along said R.O.W. line, 2.47 feet; thence Southerly 1129.95 feet along R.O.W. line and along a tangential curve, concave to the West, having a radius of 43,394.50 feet and a central angle of 01 degrees 29 minutes 31 seconds (chord bears South 00 degrees 49 minutes 26 seconds East and chord length is 1129.92 feet); thence South 45 degrees 35 minutes 16 seconds East not tangent to said curve and along said R/O.W. line, 140.00 feet; thence North 88 degrees 50 minutes 17 seconds East along said R.O.W. line, 72.89 feet; thence South 81 degrees 41 minutes 59 seconds East along said R.O.W. line, 152.07 feet; thence North 88 degrees 50 minutes 17 seconds East along said R.O.W. line, 250.00 feet; thence South 01 degrees 09 minutes 43 seconds East along said R.O.W. line, 50.00 feet to the point of beginning and containing 30.59 acres, more or less. Subject to easement for a Township Road across the Southerly line thereof.

2. **(Acreage/Population/Usage.)** That the orderly annexation area consists of approximately 8.2 acres, the population in the area is zero, and the land use type is agricultural.

3. **(Jurisdiction.)** That Harmony Township and the City of Harmony, by submission of this joint resolution to the Municipal Boundary Adjustment Unit of the Office of Administrative Hearings, confers jurisdiction upon the Chief Administrative Law Judge so as to accomplish said orderly annexation in accordance with the terms of this resolution.

4. **(Municipal Reimbursement).** Minnesota Statutes § 414.036. As reimbursement to Harmony Township for lost taxes on annexed property, the City of Harmony agrees to pay Harmony Township a one-time lump sum of \$750.00. This payment shall be remitted to Harmony Township within 60 days of approval of the Orderly Annexation Petition by the Administrative Law Judge.

5. **(Review and Comment).** The City of Harmony and Harmony Township agree that upon receipt of this resolution, passed and adopted by each party, the Chief Administrative Law Judge may review and comment, but shall within thirty (30) days, order the annexation in accordance with the terms of the resolution.

6. ***(Other Terms of Resolution).***

Adopted by affirmative vote of all the members of the Harmony Township Board of Supervisors this 4th day of December 2019.

HARMONY TOWNSHIP

By: 
Chairperson
Board of Supervisor

ATTEST:

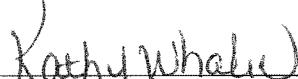
By: 
Township Clerk

Adopted by affirmative vote of the City Council of Harmony this 10th day of December 2019.

CITY OF HARMONY

By: 
Mayor

ATTEST:

By: 
City Administrator

Approved this 10th day of December 2019.

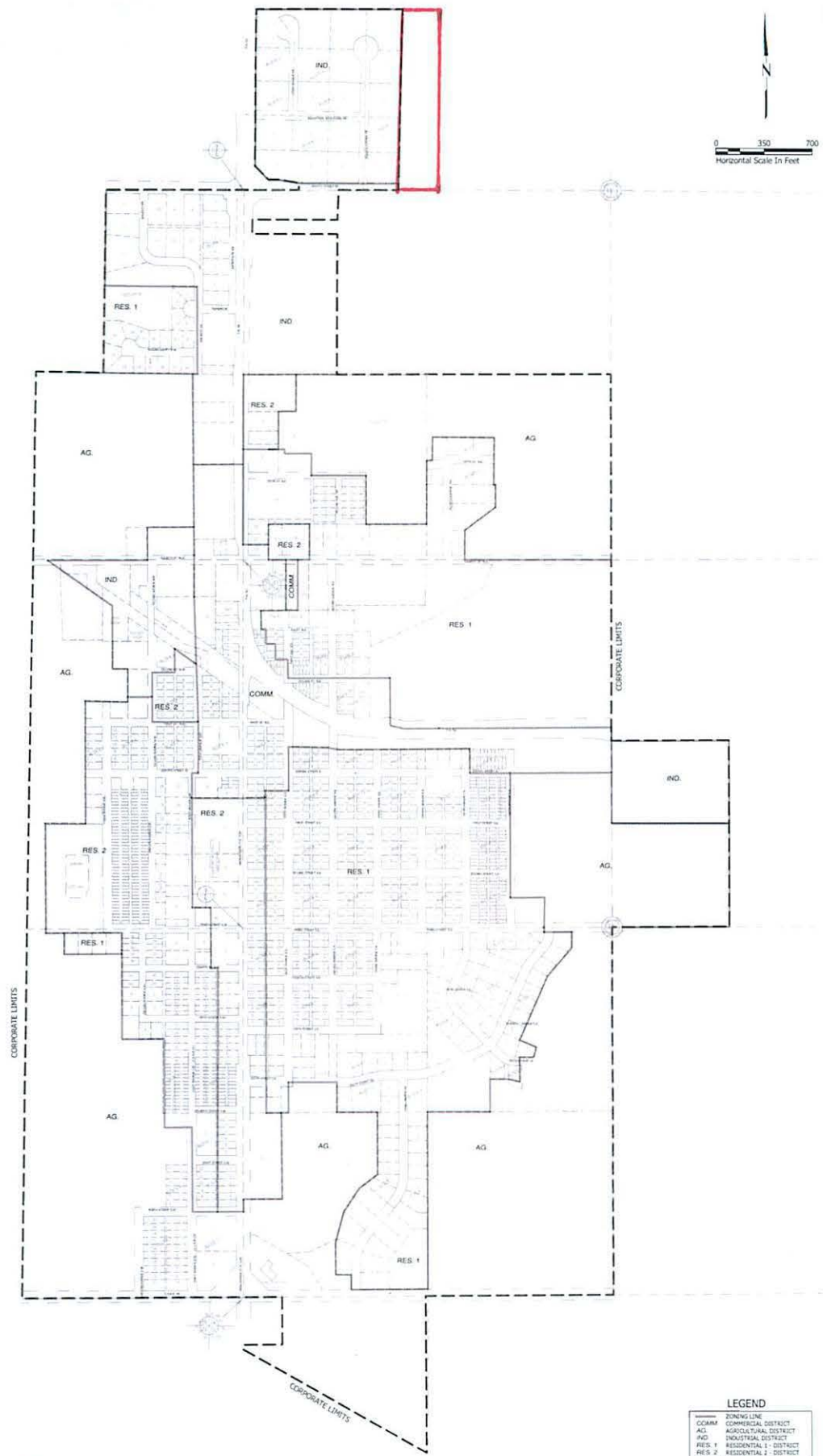

ZONING BASEMAP

CITY OF HARMONY

FIGURE 4

DATE: SPRING 2018

LEGEND	
	ZONING LINE
	COMMERCIAL DISTRICT
	AGRICULTURAL DISTRICT
	INDUSTRIAL DISTRICT
	RESIDENTIAL 1-DISTRICT
	RESIDENTIAL 2-DISTRICT
	CORPORATE LIMITS

Area for annexation