

RESOLUTION NO. 2006-035**A RESOLUTION GRANTING ANNEXATION OF PROPERTY INTO THE CITY OF
SAUK RAPIDS**

Whereas, the City of Sauk Rapids and Sauk Rapids Township entered into an Orderly Annexation agreement in 1987, and

Whereas, the agreement states that the annexation shall occur if two of the three property owners agree to the annexation, and

Whereas, on May 1st, 2006, Sauk Rapids Township authorized the annexation of certain properties into the City of Sauk Rapids with conditions (attached), and

Whereas, the City of Sauk Rapids agrees to the conditions of the Town which are also consistant with the Orderly Annexation Agreement, and

Whereas, a public hearing was held on March 27, 2006 at which time all persons where given the opportunity to be heard, and

Whereas, and the City Council and the Township agree to the annexation.

NOW THEREFORE BE IT RESOLVED BY THE CITY OF SAUK RAPIDS CITY COUNCIL THAT:

1. All Township land that is West of Highway 10, shall be annexed into the City of Sauk Rapids.
2. That the quanity of land decsribed above is approximately 89.901 acres.
3. In accord with MSA 414.0325 and the existing Orderly Annexation Agreement between the City of Sauk Rapids and Sauk Rapids Township, Minnesota Municipal Boundary Adjustments is asked to approve the annexation.
4. The Town and the City mutually agree that no alteration of the boundaries of the annexation area is necessary or appropriate. The Department of Administration may review and comment, but shall within 30 days, order the annexation in accordance with the terms of the resolution.

Adopted this 8th day of May, 2006.

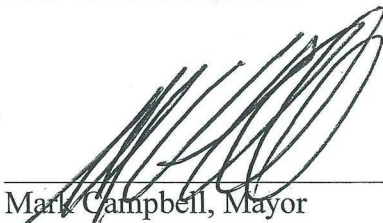

Mark Campbell, Mayor

ATTEST:



Ross Olson, City Administrator-Clerk

Sauk Rapids *Minnesota*

REC'D BY
M M B

JUL 24 2006

July 18, 2006

Department of Administration
Municipal Boundary Adjustment
658 Cedar Street, Room 300
St. Paul, MN 55155
Attention Christine Scotillo

RE: Sauk Rapids Township OA170 (Island Annexations)

Dear Star,

Pursuant to our conversation concerning the legals for the Island Annexations into the City of Sauk Rapids, I hope this helps.

All of the property that is not currently annexed into the City of Sauk Rapids that is Southwesterly of Minnesota State Highway 10, and Southeasterly of Minnesota State Highway 15 and located in the Northwest $\frac{1}{4}$ of Section 14 and the Southeast $\frac{1}{4}$ of Section 14, the Northeast $\frac{1}{4}$ of Section 15, the Southwest $\frac{1}{4}$ of Section 24, and the Northwest $\frac{1}{4}$ of Section 25 of Sauk Rapids Township will be annexed into the City consistent with the City resolution dated May 8th, 2006.

These properties are being annexed into the City of Sauk Rapids because the Township and the City agree that these properties are benefiting from City services in a number of ways while the Township is providing little or no services to these properties.

The 6-year tax rate step-up will apply to these properties.

I have attached a color map illustrating the properties that will be annexed.

If you have any questions, please feel free to contact me at your convenience.

Sincerely,

Todd Schultz
Community Development Director

CITY OF SAUK RAPIDS

115 Second Avenue North • Sauk Rapids, MN 56379 • ph: 320.258.5300 • fax: 320.258.5359 • www.ci.sauk-rapids.mn.us

The City of Sauk Rapids does not discriminate on the basis of race, color, creed, religion, national origin, sex, disability, age, marital status, status with regard to public assistance, familial status, or sexual orientation.

Attachment B

REC'D BY
MMB

JUN 01 2006

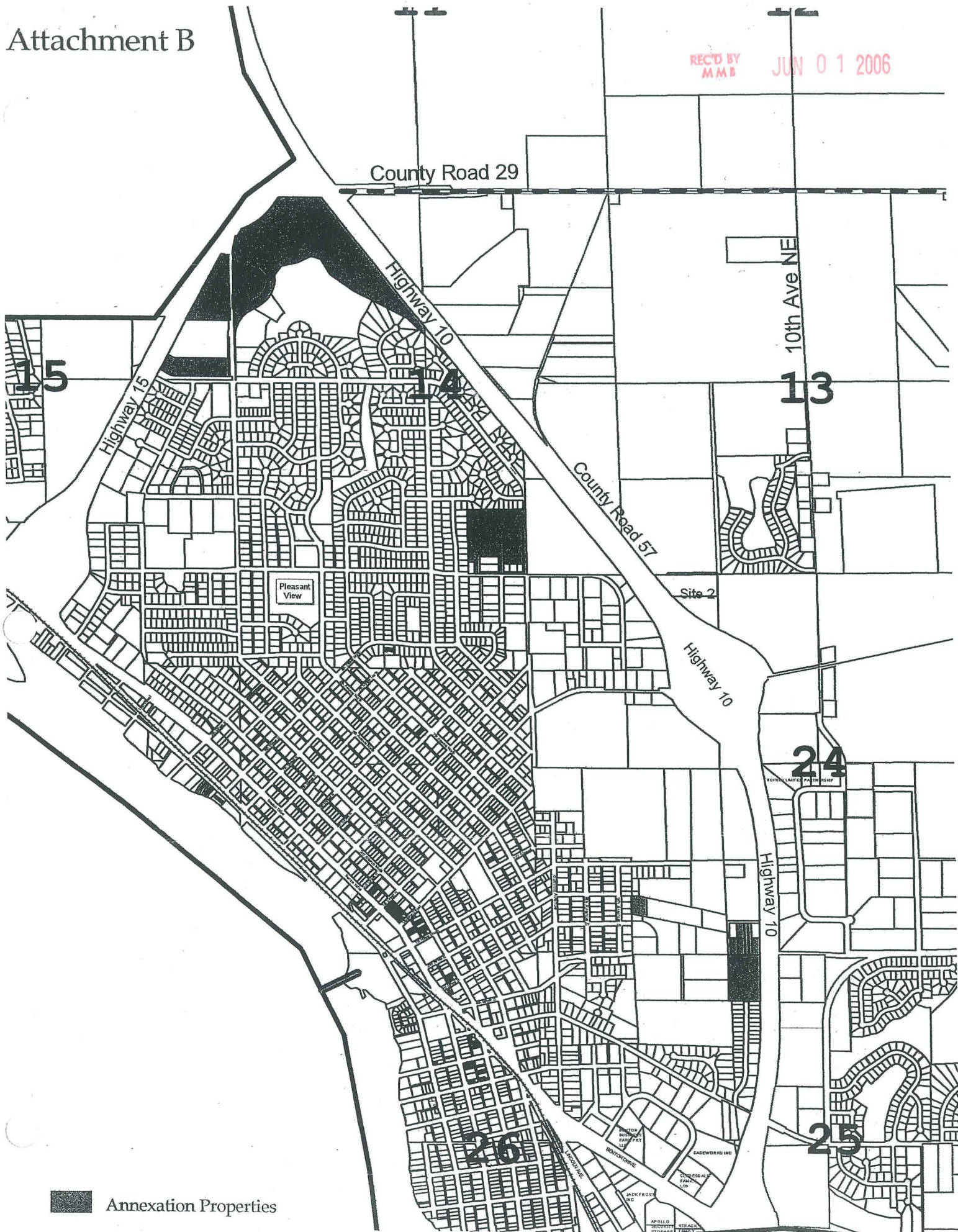

City of Sauk Rapids
Island Annexations
July, 2006

REC'D BY
M M B

JUL 24 2006

County Road 29

10th Ave NE

Highway 10

14

13

County Road 57

Site 2

Highway 10

24

Highway 10

Pleasant View



Annexation Properties

700 0 700 1400 Feet

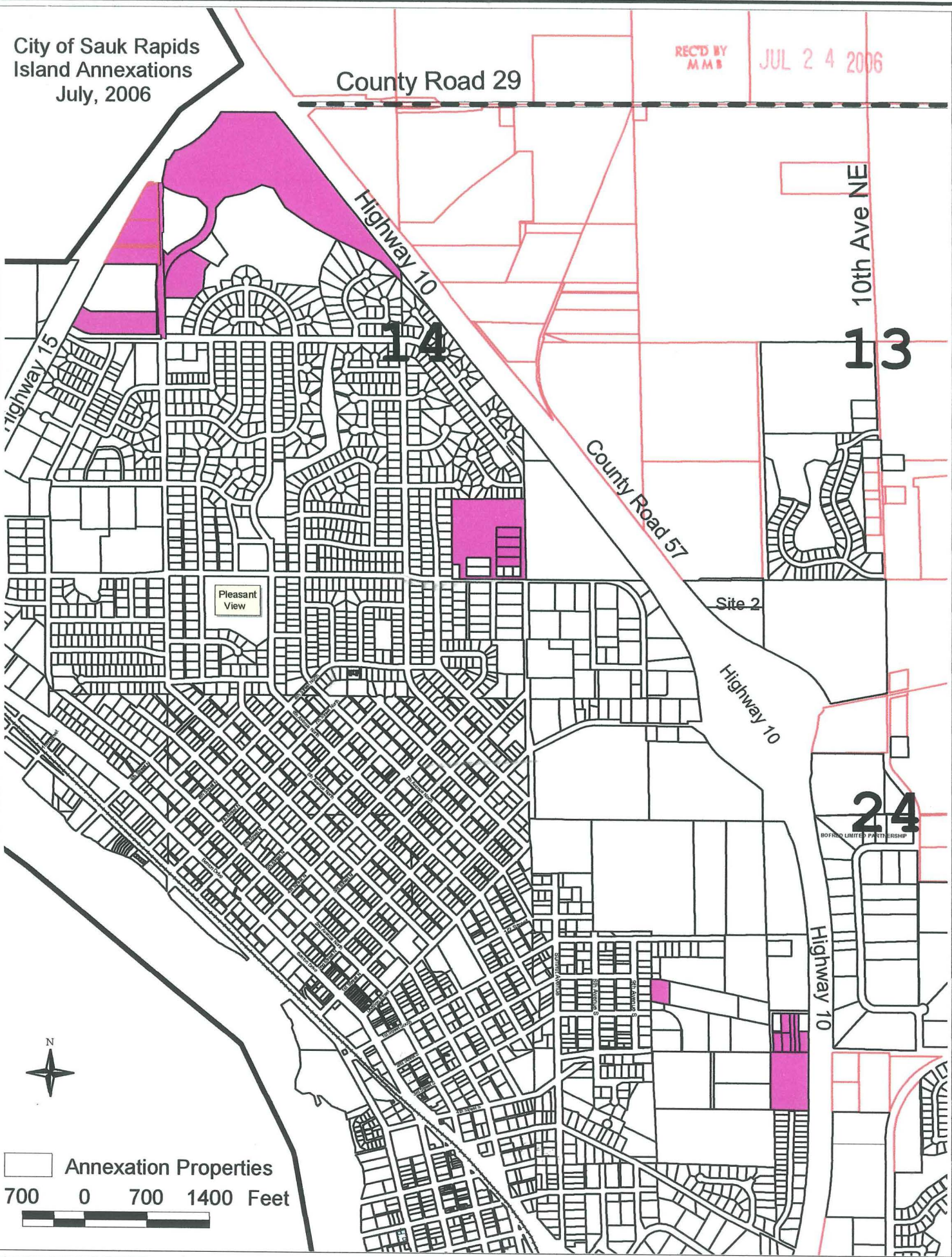

ATTACHMENT A

Owner	Address	PIN
Wollack Development, Inc.	1920 4th Ave. N.	R11.00144.00
Melvin Anthony Strang & Renee	2005 4th Ave. N.	R11.00157.02
Joni B. Philpipsek	1303 4th St. S.	R11.00193.00
Joni B. Philpipsek	1303 4th St. S.	R11.00190.00
Rose Ann Bjorklund	1240 4th St S	R11.00209.00
Teryl Tenter	916 2nd St. S.	R11.00201.00
Howard S. Sylvester & Terry M	1109 Summit Ave. N.	R11.00271.00
Margaret Smolnik	1108 11th St. N.	R11.00150.00
J Miller Property		R11.00157.03
Petron Storage LLC	4150 2nd St. S.	R11.00156.00
State of Minnesota	395 John Irlenad E. Blvd. 509	R11.00144.03
DuWayne J. Simmons	2011 4th Ave. N.	R11.00158.00
DuWayne J. Simmons	2011 4th Ave. N.	R11.00157.01
Paul H Vaughter Jr.	1243 4th St. S.	R11.00194.00
Paul H Vaughter Jr.	1243 4th St. S.	R11.00189.00
Paul H Vaughter Jr.	1243 4th St. S.	R11.00191.00
Paul H Vaughter Jr.	1243 4th St. S.	R11.00192.00
Marvin Edwin Kaeter	1117 Summit Ave. N.	R11.00269.00
John & Heather Scharnberg	1113 Summit Ave. N.	R11.00270.00
Bonita Tadych Mcdermond	1105 Summit Ave. N.	R11.00272.00
Twp of Sauk Rapids		R11.00144.05
Twp of Sauk Rapids		R11.00156.01

REC'D BY
M.M.B.

JUN 01 2006