

JOINT RESOLUTION AS TO ORDERLY ANNEXATION

The City of Northfield, Rice and Dakota County, Minnesota, and the Township of Greenville, Dakota County, Minnesota, hereby resolves as follows:

WHEREAS, the Township of Greenville, Dakota County, Minnesota, and the City of Northfield, Rice and Dakota County, Minnesota, recognize the potential for urban development from the City of Northfield into the Township of Greenville; and

WHEREAS, both the Township of Greenville and the City of Northfield desires to accommodate growth in the most orderly fashion; and

WHEREAS, there is a basis for agreement between the Township of Greenville and the City of Northfield concerning annexation and both the Township of Greenville and the City of Northfield desire to set forth such terms and agreements by means of this resolution.

NOW THEREFORE BE IT RESOLVED by the Township of Greenville, Dakota County, Minnesota, and the City of Northfield, Rice and Dakota County, Minnesota, that annexation of the land in the Township of Greenville by the City of Northfield shall be under the following conditions:

1. That the following described area in the Township of Greenville, Dakota County, Minnesota, is <sup>the property</sup> ~~is~~ properly subject to orderly annexation under and pursuant to Minnesota Statutes Annotated, Section 414.032, and the parties hereto do hereby designate this area as in need of orderly annexation as provided by law:

The south 2,092 feet of that part of the SE 1/4 of Section 25, Township 112 North, Range 20 West, Dakota County, Minnesota, lying West of Right of Way of the Minneapolis, Northfield and Southern Railway; excepting that part thereof platted as North Ridge Addition, Dakota County, Minnesota.

That this agreement shall apply to the above described real property.

2. That the Township of Greenville does upon the passage of this Resolution and its adoption by its town board and by the city council of the City of Northfield, confer jurisdiction upon the Minnesota Municipal Commission so as to accomplish said orderly annexation immediately in accordance with the terms of this Resolution.
3. All annexations within the above described land will be of contiguous properties and in agreement with the policies of the City of Northfield concerning the extension of municipal utilities.

4. Property taxes which have already been assessed for the year in which an annexation occurs and payable the following year shall be proportioned on a monthly basis between the City of Northfield and the Township of Greenvale. For example, if a parcel is annexed as of June 30, 1984, the property taxes paid in 1985 for that parcel will be divided six months to the Township and six months to the City, so that if the County collects \$5,000.00 in taxes in 1985 for this newly annexed parcel, one-half of the Township's portion for the entire year shall be paid to the Township and one-half shall be paid to the City.
5. All land annexed to the City of Northfield will be zoned according to the normal zoning designation procedure established in the Northfield Zoning Ordinance. The requested use for this property is a mixed residential use.
6. The City will consider annexation of property subject to this agreement based upon the receipt of a petition signed by 100% of the land owners of the particular parcel requesting to be annexed.

This petition has been forwarded to the City of Northfield and will be submitted to the Township of Greenvale and the Minnesota Municipal Board.

- A. Should both the Township of Greenvale and the City of Northfield agree to the annexation, the City's normal annexation process will occur.
  - B. Should the Township of Greenvale and the City of Northfield disagree with the annexation, the Minnesota Municipal Board shall conduct a public hearing and resolve the disagreement.
7. The City of Northfield and the Township of Greenvale may independently propose an annexation if the city council of the City of Northfield and the township board of the Township of Greenvale agree that a certain parcel of land is about to become urban and can be served by the City of Northfield with utilities. The affected land owners may appeal to the Minnesota Municipal Board, which will conduct a public hearing and determine if the annexation is appropriate.
  8. The Minnesota Municipal Commission shall determine the ratio of the population annexed to the total population of the Township of Greenvale on the date of its order of annexation. This ratio will be further modified by the proportion of the year remaining in which the annexation takes place. The County Auditor will apply this modified ratio to all quarterly or other subsequent payments of state per capita aids to the Township of Greenvale and divide the payments accordingly. Per capita aids received by the Township of Greenvale in the year of annexation, prior to the date of annexation, will be shared by the same modified ratio as explained above.

9. Any public utility running through the Township of Greenvale will not be actively assessed unless there is agreement with the Township of Greenvale to assess the property.
10. It is agreed to by the Township of Greenvale and the City of Northfield that the procedure will follow provisions of Section 414.0325 Subd. 1, of the Minnesota Statutes hereto attached and is made a part of this agreement.

Adopted by the Township of Greenvale, Dakota County, Minnesota, this 16  
day of April, 1984.

TOWNSHIP OF GREENVALE

By: Gene [Signature]  
Chairman  
Peter Blesener  
Supervisor  
Edith Nelson  
Clerk

Adopted by the City Council of the City of Northfield, Rice and Dakota County, Minnesota, this 2nd day of April, 1984.

CITY OF NORTHFIELD

By: William R. Hill  
Mayor  
And: Coramline Hall  
City Clerk

Subscribed and sworn  
before me this 18th day  
of April 1984

[Signature]  
NOTARY PUBLIC - MINNESOTA  
RICE COUNTY  
Commission Expires Oct. 14, 1989

PROPOSED ANNEXATION

REC'D. BY MMB APR 25 1984

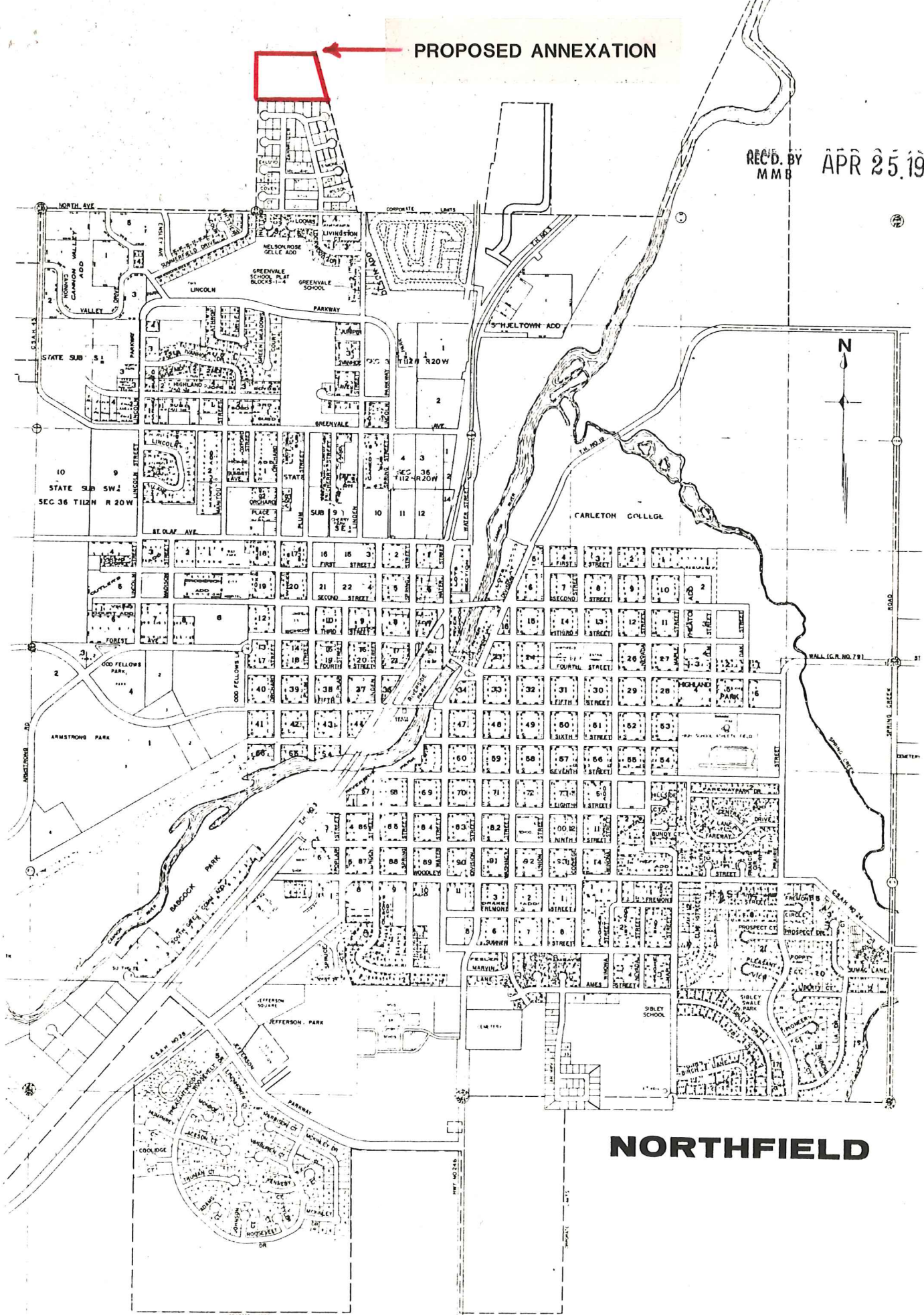

NORTHFIELD

# PROPOSED ANNEXATION

REC'D BY APR 25 1984

25

