

MAR 29 1982

RESOLUTION NO. 522, SECOND SERIES

A RESOLUTION DESIGNATING UNINCORPORATED AREAS AS IN NEED
OF ORDERLY ANNEXATION AND CONFERRING JURISDICTION OVER
SAID AREAS TO THE MINNESOTA MUNICIPAL COMMISSION

WHEREAS, Certain properties within the Township of Lake
Marshall are in need of orderly annexation to the City of Marshall;
and

WHEREAS, The properties are located in the County of Lyon
and State of Minnesota and described as follows, to-wit:.

*That part of the Southwest Quarter of Section 9, Township
111 North, Range 41 West described as follows:*

*Beginning at a point 886.95 feet South and 33 feet East
of the West one Quarter corner of Section 9, Township
111 North, Range 41 West; thence North 90°00'00" East
for a distance of 569.35 feet; thence South 00°00'00"
East for a distance of 7800 feet; thence South 90°00'00"
East for a distance of 66.00 feet; thence South 00°00'00"
East for a distance of 343.05 feet; thence North 90°
00'00" West for a distance of 625.35 feet; thence
North 00°00'00" East for a distance of 425.05 feet to
the point of beginning. (Proposed Neilsen's 9th Add.)
(containing 5.92 acres, more or less)*

*The North 124 feet of the Northeast Quarter of the
Southwest one Quarter of Section 9; Township 111 North,
Range 41 West and that part of the Southeast Quarter of
the Northwest Quarter of Section 9, Township 111 North,
Range 41 West described as follows:*

*Beginning at the Southeast corner of the Northwest
Quarter of Section 9, Township 111 North, Range 41 West;
thence North 00°16'27" West for a distance of 1,009.17
feet; thence North 89°48'00" West for a distance of
811.79 feet; thence South 00°06'00" West for a distance
of 560 feet; thence North 89°48'00" West for a distance
of 135 feet; thence South 00°06'00" West for a distance
of 48 feet; thence North 89°48'00" West for a distance
of 390 feet to the West line of the Southeast Quarter of
the Northwest Quarter of said Section 9; thence South
00°06'00" West on the West line of said Southeast Quarter
of the Northwest Quarter of Section 9 to the Southwest
corner of said Southeast Quarter of the Northwest Quarter
of Section 9; thence South 89°48'00" East on the South
line of the Southeast Quarter of the Northwest Quarter of
Section 9 to the point of beginning.
(containing 27.60 acres, more or less)*

*All of Viking Addition Plat #3
(containing 6.57 acres, more or less)*

*All that part of Trunk Highway No 23 Right of Way lying
within the Northeast Quarter of the Southeast Quarter of
Section 9, Township 111 North, Range 41 West.*

and

*All that part of the Northeast Quarter of the Northeast
Quarter of the Southeast Quarter of Section 9, Township
111 North Range 41 West lying Northeasterly of the South-
westerly Right of Way Line of the Chicago and Northwestern
Railroad and Northwesterly of the Northwesterly Right of
Way Line of Trunk Highway No. 23.*

All that part of the Northeast Quarter of the Southeast Quarter of Section 9, in Township 111 North, of Range 41 West, of the Fifth Principal Meridian, lying Southeasterly of southeasterly right-of-way line of Minnesota Trunk Highway No. 23, as said Highway right-of-way is now located,

and

That part of the Southwest Quarter of Section 10, Township 111 North, Range 41 West, Lyon County, Minnesota, described as follows:

Beginning at a Lyon County monument in place at the southwest corner of said Section 10; thence easterly along the south line of said southwest Quarter 1094.00 feet; thence northerly deflecting to the left $90^{\circ}24'00''$ parallel with the west line of said southwest Quarter 140.00 feet; thence easterly deflecting to the left $90^{\circ}24'00''$ parallel with said south line of the southwest Quarter 81.00 feet; thence northerly deflecting to the left $90^{\circ}24'00''$ parallel with said west line of the southwest Quarter 100.00 feet; thence westerly deflecting to the left $89^{\circ}36'00''$ parallel with said south line of the southwest Quarter 122.00 feet; thence northwesterly deflecting to the right $58^{\circ}30'30''$ 76.00 feet; thence southwesterly deflecting to the left $62^{\circ}25'30''$ 354.45 feet; thence northerly deflecting to the right $93^{\circ}51'00''$ 227.40 feet; thence easterly deflecting to the right $91^{\circ}56'00''$ 237.20 feet; thence easterly deflecting to the left $02^{\circ}43'00''$ 81.27 feet; thence northwesterly deflecting to the left $123^{\circ}49'25''$ 103.33 feet; thence northwesterly deflecting to the left $01^{\circ}26'50''$ 202.40 feet; thence at right angles in a southwesterly direction 120 feet; thence at right angles in a northwesterly direction 210 feet; thence at right angles in a northeasterly direction 220 feet; thence at right angles in a northwesterly direction 65 feet; thence at right angles in a northeasterly direction 160 feet, more or less, to the northeasterly right-of-way line of the abandoned Chicago and Northwestern Railroad; thence northwesterly along the northeasterly right-of-way line of said abandoned Chicago and Northwestern Railroad to its intersection with said west line of the southwest Quarter; thence deflecting to the left $140^{\circ}15'00''$ along said west line of the southwest Quarter 2280.80 feet to the point of beginning.

(containing 61.35 acres, more or less)

All of the South Half of the Southeast Quarter of Section 3, Township 111 North, Range 41 West, County of Lyon; State of Minnesota, lying east of the easterly Right-of-Way line of Minnesota Trunk Highway No. 23.

(containing 15.92 acres, more or less)

WHEREAS, Said properties were within the orderly annexation area agreement contained in Resolution No. 516, Second Series, dated January 18, 1982, between Fairview Township, Lake Marshall Township, Lyon County and the City of Marshall; and on file with the Minnesota Municipal Commission;

NOW, THEREFORE BE IT RESOLVED, That upon the adoption of this resolution by the Common Council of the City of Marshall, jurisdiction over annexation of the above described areas be conferred to the Minnesota Municipal Commission, pursuant to M.S.A. 414.032.

Passed and adopted by the Common Council of the City of Marshall this 1st day of March, 1982.

THE COMMON COUNCIL

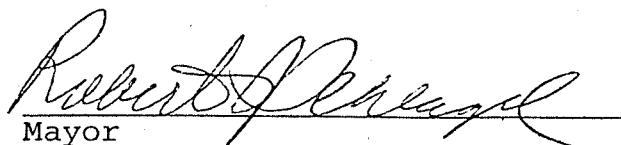
Mayor

ATTEST:

City Clerk

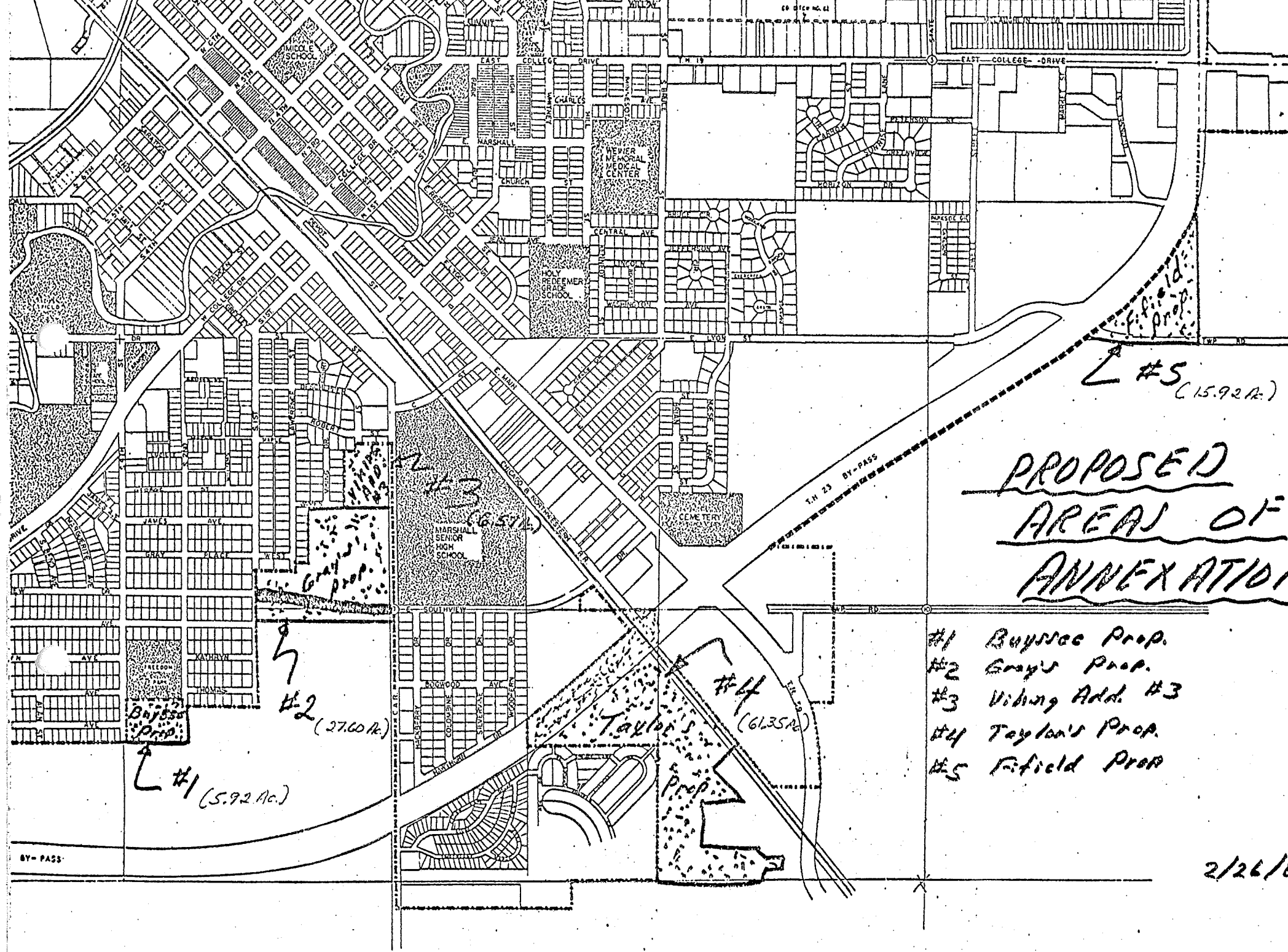

PROPOSED
AREA OF
ANNEXATION

- #1 Buysee Prop.
- #2 Gray's Prop.
- #3 Viking Add. #3
- #4 Taylor's Prop.
- #5 Fifield Prop.

2/26/6