

MUNICIPAL BOUNDARY ADJUSTMENTS
DEPARTMENT OF ADMINISTRATION
Attn: Christine M. Scotillo
Room 300
658 Cedar St.
St. Paul, MN 55155

REC'D BY
MMS

MAR 22 2007

IN THE MATTER OF THE JOINT RESOLUTION OF THE TOWN OF BECKER AND THE CITY OF BECKER DESIGNATING UNINCORPORATED AREAS AS IN NEED OF ORDERLY ANNEXATION AND CONFERRING JURISDICTION OVER SAID AREAS TO MUNICIPAL BOUNDARY ADJUSTMENTS, DEPARTMENT OF ADMINISTRATION PURSUANT TO M.S. 414.0325

The Township of Becker and City of Becker hereby jointly agree to the following:

1. That the following described areas in Becker Township are subject to orderly annexation pursuant to Minnesota Statutes 414.0325, and the parties hereto designate this area for orderly annexation:

1. The South Half of the Southeast Quarter of the Southwest Quarter, Section 24, Township 34, Range 29, Sherburne County, Minnesota.

AND

The Northeast Quarter of the Northwest Quarter and the Northwest Quarter of the Northwest Quarter, all in Section 25, Township 34, Range 29, Sherburne County, Minnesota.

2. The property within the orderly annexation area is tax exempt therefore there will be no reimbursement of taxes on the property.
 3. Both the Town of Becker and the City of Becker agree that no alteration of the stated boundaries of this agreement is appropriate. Furthermore, each party agrees that no consideration by the Department of Administration Boundary Adjustments is necessary. Upon receipt of this resolution, passed and adopted by each party, the Department of Administration may review and comment, but shall, within thirty (30) days, order the annexation in accordance with the terms of this joint resolution.

Approved by the Town of Becker this 26th day of February, 2007.

Town of Becker

By: _____

Gary Hammer, Town Board Chair

By: _____

Judy Shermak, Town Board Clerk

REC'D BY
MMB

MAR 22 2007

Approved by the City of Becker this 6th day of March, 2007.

City of Becker

By:

Ken Paulson, Mayor

Attest:



Joe Rudberg, City Administrator

Drafted By:
Kelli Neu, Community Development Director
City of Becker
PO Box 250
Becker MN 55308

City of Becker Municipal Boundary

REC'D BY
M M B

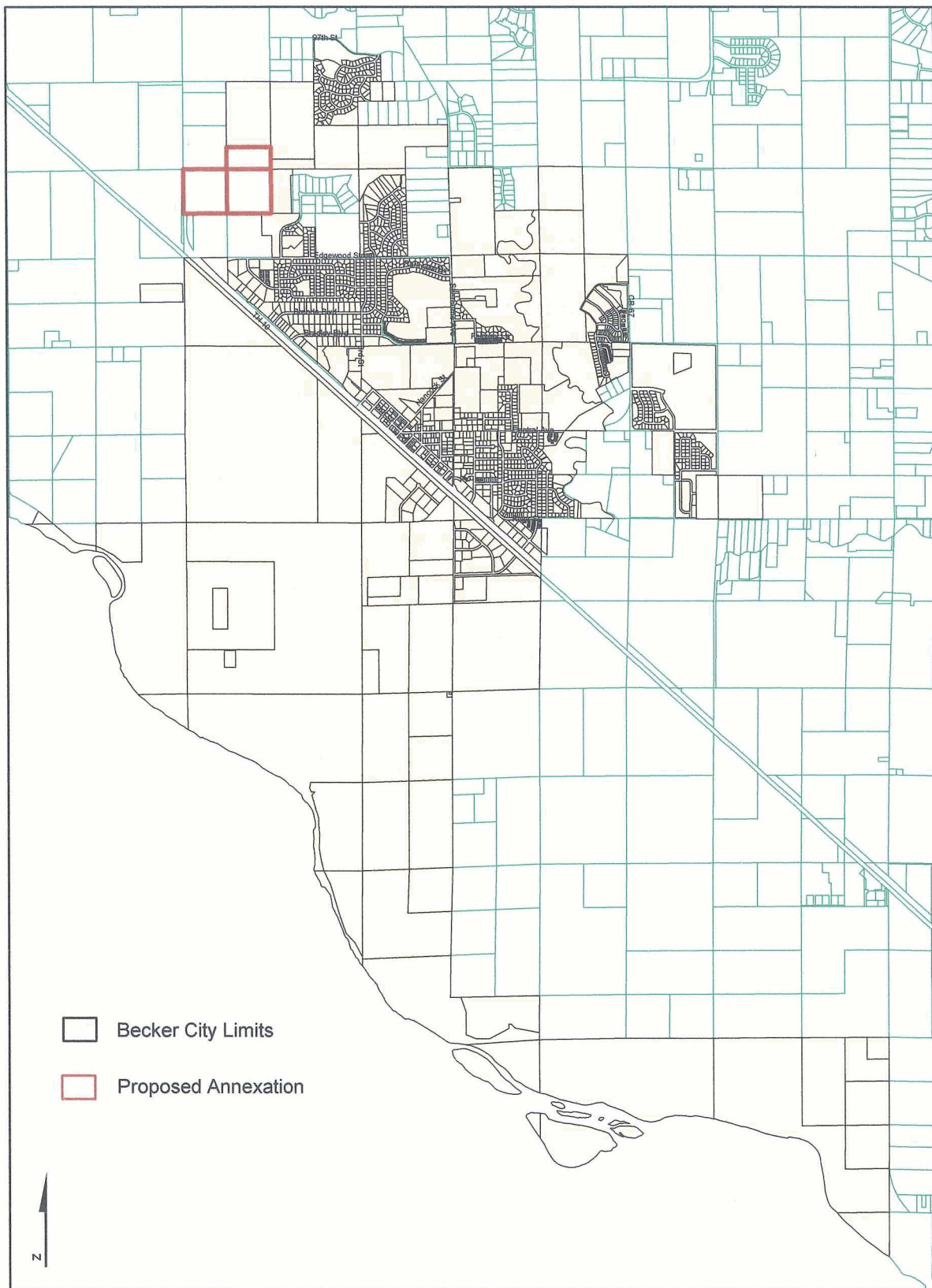
MAR 22 2007



03.20.2007. Becker Planning Department. Parcel data provided by Sherburne County.
Neither the City of Becker nor Sherburne County guarantee the accuracy of the data presented.