

REC'D. BY MAR 13 1989
MMB

AMENDMENT TO THE JOINT RESOLUTION FOR ORDERLY ANNEXATION

IN THE MATTER OF THE AMENDMENT TO THE JOINT RESOLUTION
FOR ORDERLY ANNEXATION BETWEEN THE TOWN OF DARNEN
AND THE CITY OF MORRIS, MINNESOTA
PURSUANT TO MINNESOTA STATUTES 414.0325, SUBD. 1

TO: Minnesota Municipal Board
165 Metro Square Building
St. Paul, Minnesota 55101

The Township of Darnen and the City of Morris hereby jointly agree that the area designated for orderly annexation in the Joint Resolution Between the Town of Darnen and the City of Morris Designating an Area for Orderly Annexation dated June 29, 1978 be amended to include the following:

Both the Town and the City agree that no alteration of the stated boundaries of this agreement is appropriate. Furthermore, both parties agree that no consideration by the Board is necessary. Upon receipt of this resolution, the Municipal Board may review and comment, but shall, within 30 days, order the annexation of the following-described property in accordance with the terms of the joint resolution.

Part of the Southwest Quarter of the Southwest Quarter, Section 1, Township 124 North, Range 42 West, Stevens County, Minnesota.

APPROVED BY THE CITY OF MORRIS THIS 14TH DAY OF FEBRUARY, 1989.

Leland Swanson, Mayor

Edward R. Larson, City Manager

Approved by the Town of Darnen this 15th day of February, 1989.

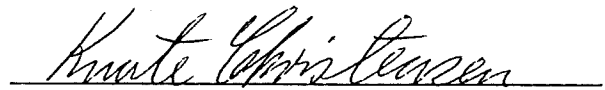
Town Board Chairman

Town Board Clerk

CITY OF MORRIS

609 Oregon Avenue
City Hall
MORRIS, MINNESOTA 56267

REC'D. BY
MMB MAR 30 1989

TO: Minnesota Municipal Board
165 Metro Square Building
St. Paul, Minnesota 55101

The Township of Darnen and the City of Morris, hereby jointly submit for consideration a correction of the description given for a parcel of land under consideration for annexation. The description in error was originally included in an Amendment To The Joint Resolution for Orderly Annexation which was jointly approved by the City of Morris on February 14, 1989 and the Township of Darnen on February 15, 1989. The corrected legal description is as follows:

A parcel of land in the SW $\frac{1}{4}$ SW $\frac{1}{4}$ of Section 1, Township 124 North, of Range 42 West, Stevens County, Minnesota, excepting the following parcel: Beginning at the NE corner of the SW $\frac{1}{4}$ SW $\frac{1}{4}$ of said Section 1, thence South along the East line of the SW $\frac{1}{4}$ SW $\frac{1}{4}$, 815 feet more or less, thence in a northwesterly direction to a point on the North line of said SW $\frac{1}{4}$ SW $\frac{1}{4}$, said point being 200 feet more or less East of the West line of said Section 1, thence East along said North line of said SW $\frac{1}{4}$ SW $\frac{1}{4}$, 1125 feet more or less to the point of beginning as shown on the location map for said Project Number 9 of the Pomme de Terre River Emergency Relief Administration, State of Minnesota, dated June 3, 1935, and revised July 11, 1935.

The correction is hereby acknowledged by the City of Morris and the Township of Darnen and it is requested that it be made part of the previously-mentioned resolution amending the Resolution For Orderly Annexation.

SIGNED THIS 28th DAY OF March, 1989.

CITY OF MORRIS

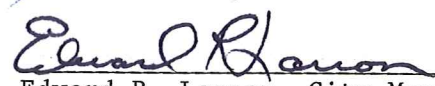

Leland Swanson, Mayor

Edward R. Larson, City Manager

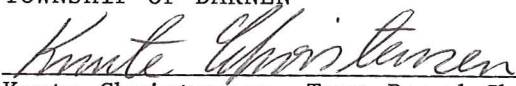
TOWNSHIP OF DARNEN

Knute Christensen, Town Board Chrm.

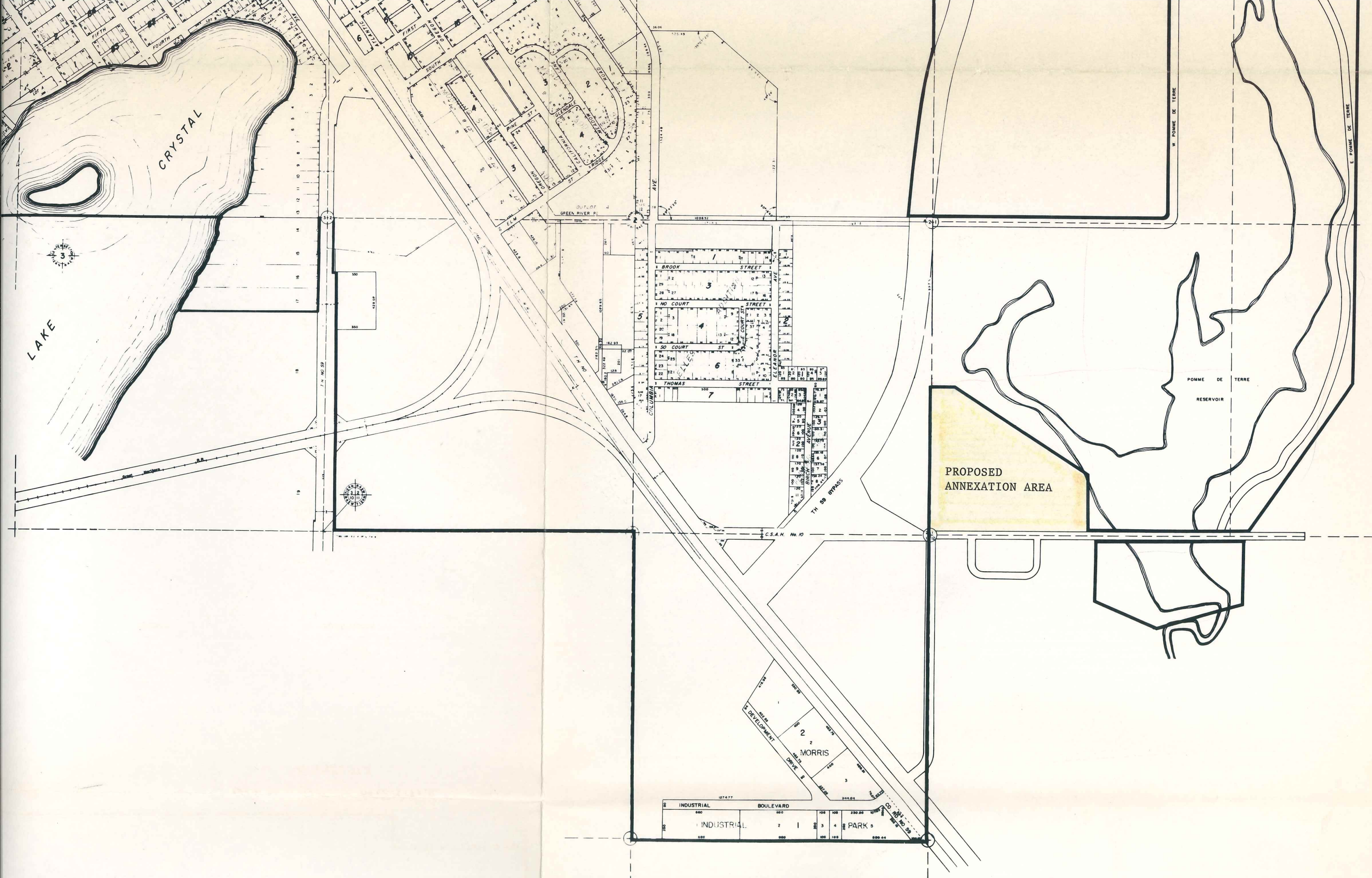
Don Mahoney, Town Board Clerk



INDUSTRIAL	BOULEVARD				
INDUSTRIAL	2	1	3	4	PARK 5

REC'D. BY
MMB MAR 13 1989