

R110-06

**TOWN OF CASTLE ROCK  
CITY OF FARMINGTON**

**IN THE MATTER OF THE JOINT  
RESOLUTION OF THE TOWN OF  
CASTLE ROCK AND THE CITY  
OF FARMINGTON, DESIGNATING  
AN UNINCORPORATED AREA AS  
IN NEED OF ORDERLY ANNEXATION  
AND CONFERRING JURISDICTION  
OVER SAID AREA TO THE DEPARTMENT  
OF ADMINISTRATION, BOUNDARY  
ADJUSTMENT OFFICE, PURSUANT TO  
M.S. §414.0325**

**JOINT RESOLUTION****(Olson Property)**

WHEREAS, by previous joint resolution and agreement entered into between the City and Township in September of 2006, attached hereto as Exhibit A, the properties legally described below were included in a designated orderly annexation area but were not made subject to immediate annexation, and;

WHEREAS, the owners of property legally described on the attached Exhibit B and depicted on the attached Exhibit C have petitioned the City for annexation to the City pursuant to the terms of the Orderly Annexation Agreement, and;

WHEREAS, all provisions of the Orderly Annexation Agreement (OAA) have been satisfied and the Township consents to the annexation.

**NOW, THEREFORE**, the Township of Castle Rock and the City of Farmington jointly agree to the following:

1. The Township and City have determined that the area of the property involved in this annexation is approximately 161.83 acres and the population of the area is currently two (2).
2. That the purpose of the annexation of the property involved in this annexation is to facilitate the development of the property to urban densities and to provide urban services, including city sewer and water services.
3. That in order to facilitate the construction and financing of the improvements necessary for development that is urban or suburban in character and the efficient delivery of governmental services, the property in question should be immediately annexed to and made part of the City of Farmington.
4. The City and Township agree that upon execution of this Joint Resolution for Orderly Annexation all planning, official controls, and governmental services for the annexed area shall become the responsibility of the City.

5. The City and Township also agree that the provisions of Minn. Stat. §§414.035 authorizing differential taxation for the annexed property will not be applied in this proceeding, and that the terms specified in the aforementioned OAA for reimbursement to the Township shall apply for this parcel to be annexed.
6. Upon approval by the respective governing bodies of the City and the Township, this joint resolution and agreement shall confer jurisdiction upon the Director of the Office of Strategic and Long-range Planning (or his or her successor designee responsible for administering Minnesota Statutes Chapter 414) so as to immediately annex the lands described in the attached Exhibit B in accordance with the terms of this joint resolution and agreement without need for any subsequent resolution(s) of the parties.
7. The City and the Township mutually state that no alteration by the director to the OAA boundaries, as illustrated on Exhibit C and described in Exhibit B, is appropriate or permitted.
8. Having designated the area illustrated on Exhibit C and described in Exhibit B as in need of orderly annexation, and having provided for all of the conditions of its annexation within this document, the parties to this agreement agree that no consideration by the director is necessary. The director may review and comment but shall within thirty (30) days order the annexation in accordance with the terms of this Resolution.

Approved and Adopted  
this 13<sup>th</sup> day of September, 2006.

Approved and Adopted  
this 15<sup>th</sup> day of Sept, 2006.

TOWN OF CASTLE ROCK

BY: Russell Hyellier  
Its Town Board Chair

AND Maralyn Rother  
Its Town Board Clerk

CITY OF FARMINGTON

BY: Kevin A. Adenberg  
Its Mayor

AND Steve H. Hylke  
Its City Administrator



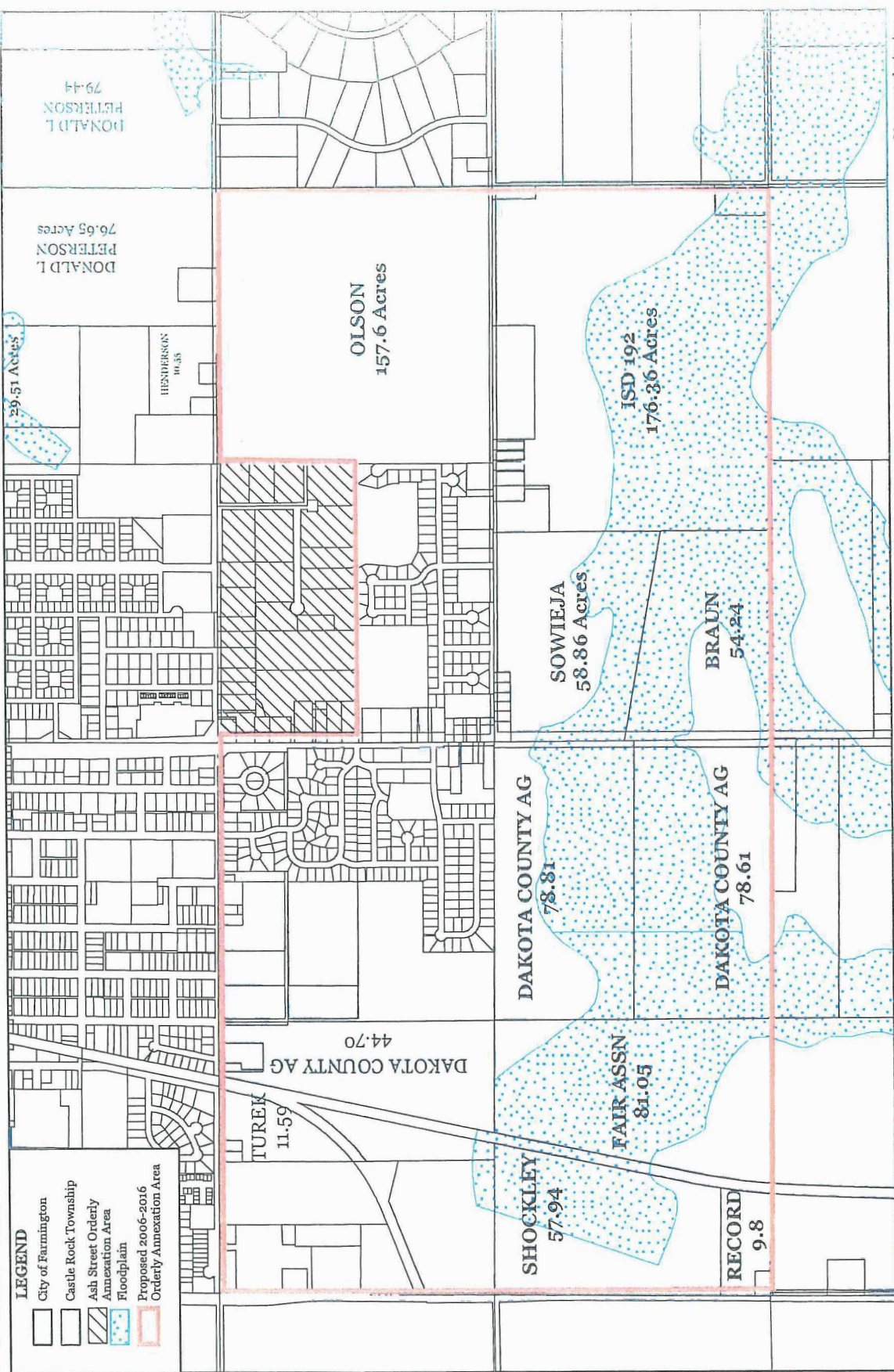

Map created 9/22/05  
Map revised 5/2/06

TIN/GIS Project Map/2006 City-Orderly Annexation Agreement

# EXHIBIT A

# EXHIBIT A

RECD BY  
MAB  
OCT 04 2006

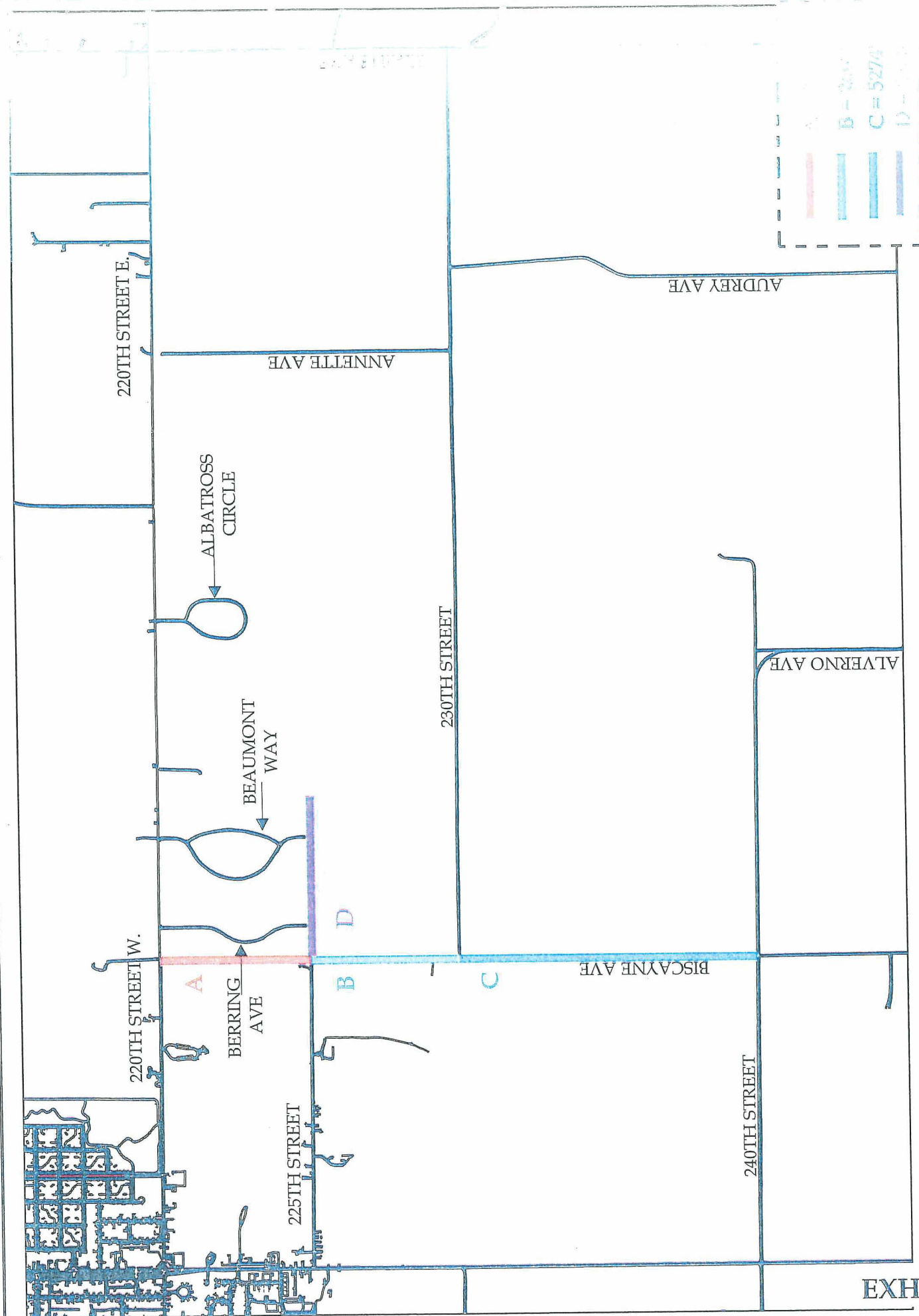

Map created 11/30/05  
 Map revised 5/2/06  
 K:\TINA\GIS Project Maps\112905 Existing C.R. Map



REC'D BY **MMB** OCT 04 2006

1,000 Feet

**EXHIBIT B**

**EXHIBIT B**

REC'D BY  
M M B

OCT 6 2006

**EXHIBIT B**  
**LEGAL DESCRIPTION**

The Northeast Quarter of Section 5, Township 113, Range 19, Dakota County,  
Minnesota, subject to public road right-of-ways. Containing 161.83 acres.



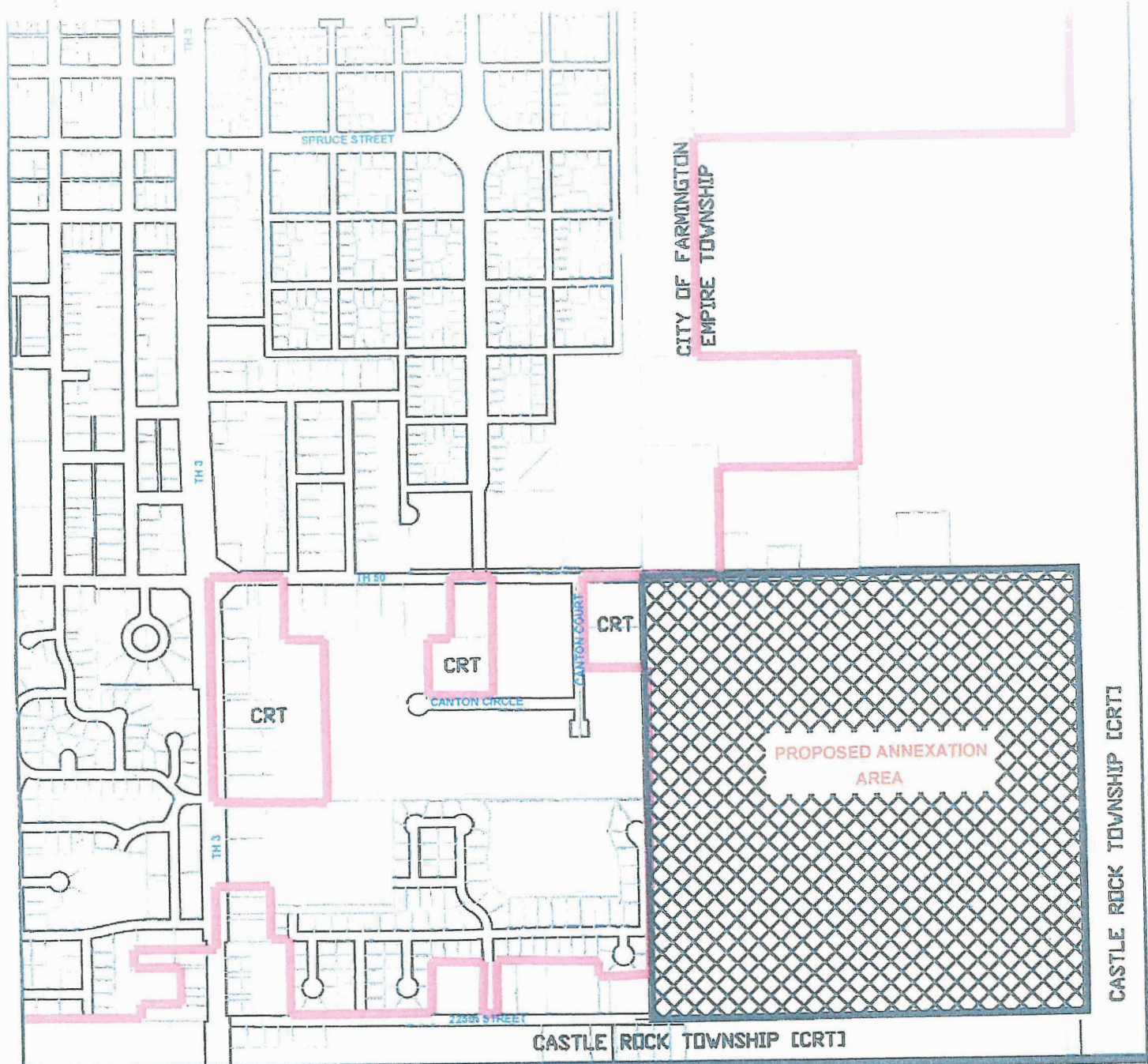

# OLSON PETITION FOR ANNEXATION

REC'D BY  
M M B  
OCT 04 2006

— MUNICIPAL BOUNDARY



OLSON PROPERTY

EXHIBIT C