

Plan
PS
J. E. E. E. E.
CL

147-84

REC'D BY APR 17 1984

RESOLUTION

WHEREAS, the Planning and Zoning Commission at the request of the owner of property located in the Town of Cascade, County of Olmsted, State of Minnesota, described as:

The triangular piece of land in the southeast corner of the Southeast Quarter of Section 33, Township 107 North, Range 14 West, lying south of County State Aid Highway No. 34 being more particularly described as follows: commencing at a point on the South line of said Section 37.6 feet west of the southeast corner of said Section for a place of beginning, running thence due west on the south line of said Section a distance of 491.4 feet, running thence due north at right angles to said south line a distance of 193.1 feet more or less to the right-of-way line of said County State Aid Highway No. 34, thence southeasterly along the South line of said right-of-way to place of beginning, together with: the easterly 15 feet of that part of the South Half of the Southeast Quarter of Section 33, Township 107 North of Range 14 West in Olmsted County, Minnesota, described as follows: commencing at the southeast corner of said Section and running thence North 89° 8' West along the South line thereof a distance of 739 feet for a place of beginning; thence North 89° 8' West along said South line a distance of 442.23 feet, thence North 14° 8' East a distance of 492.39 feet to a point in the centerline of County State Aid Highway No. 34, thence South 65° 55' East along the centerline of said Highway a distance of 357.94 feet, thence South 0° 52' West a distance of 337.53 feet to the place of beginning; together with the tract of land described by metes and bounds as follows: commencing at a point on the South line of Section Thirty-three (33), Township One Hundred Seven (107), Range Fourteen (14), 529 feet West of the southeast corner of said Section for a place of beginning, running thence due west on the South line of said Section a distance of 210 feet, running thence due north at right angles to said South line to the right-of-way of County State Aid Highway No. 34, thence southeasterly along the South line of said right-of-way to a point 193.1 feet due north of the place of beginning, thence South 193.1 feet to place of beginning; together with: that part of the right-of-way of County State Aid Highway No. 34 lying west of the East line of the Southeast Quarter of Section 33, and north of and adjacent to the lands previously described.

has recommended that the Common Council of the City of Rochester initiate proceedings for annexation of said property to the City of Rochester; and

WHEREAS, said property is subject to a joint resolution for orderly annexation adopted by the Common Council on May 17, 1976 and approved by the Board of the Town of Cascade on May 5, 1976, which resolution was subsequently amended by a resolution approved by the Common Council on February 23, 1977 and the Board of the Town of Cascade on April 4, 1977; and

WHEREAS, information has been presented to the Common Council which indicated that said property is urban or suburban in nature and that the City of Rochester is fully capable of providing municipal sewer and water and other services required by said property within a reasonable time.

NOW THEREFORE, BE IT RESOLVED by the Common Council of the City of Rochester that pursuant to said joint resolution, as amended, the Common Council hereby requests that the Minnesota Municipal Board undertake proceedings pursuant to Minnesota Statutes, §414.0325, for the annexation to the City of Rochester of the property described herefore which comprises approximately 2.18 acres and which is located in Cascade Township, County of Olmsted, State of Minnesota.

BE IT FURTHER RESOLVED that the City Clerk is hereby directed to forward a certified copy of this resolution by certified mail for service or filing as the case may be with the Secretary of the Minnesota Municipal Board, the Cascade Town Clerk, the Olmsted County Planning and Zoning Commission, and the Rochester Planning and Zoning Commission.

PASSED AND ADOPTED BY THE COMMON COUNCIL OF THE CITY OF ROCHESTER, MINNESOTA, THIS 19 DAY OF MARCH, 1984.



PRESIDENT OF SAID COMMON COUNCIL

ATTEST: 
CITY CLERK

Approved this 20 day of MARCH, 1984.

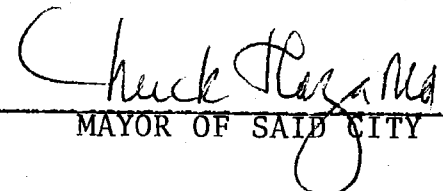

MAYOR OF SAID CITY

(Seal of the City of
Rochester, Minnesota)

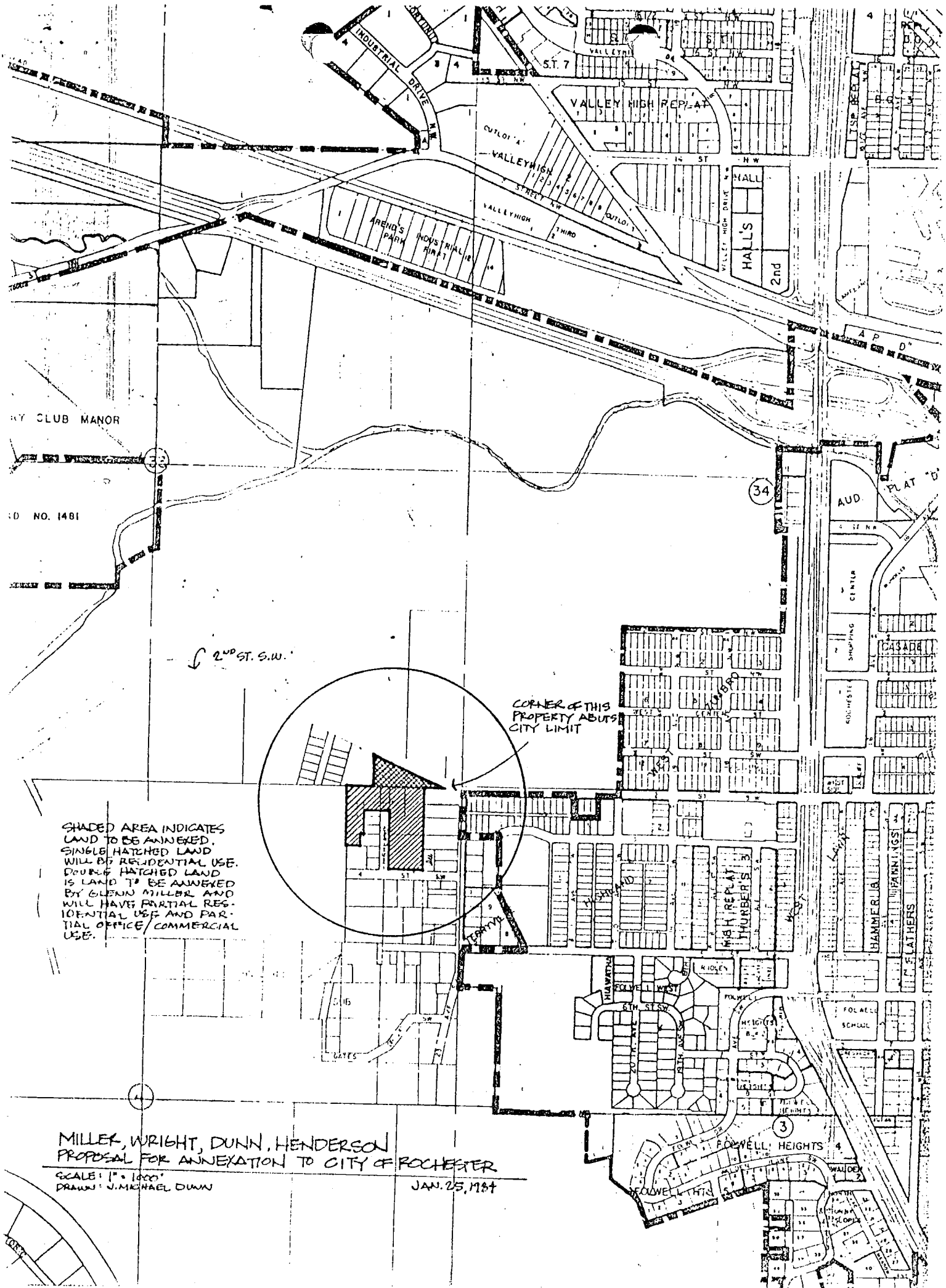

BY CLUB MANOR

NO. 1481

2ND ST. S.W.

CORNER OF THIS
PROPERTY ABUTS
CITY LIMIT

SHADED AREA INDICATES
LAND TO BE ANNEXED.
SINGLE HATCHED LAND
WILL BE RESIDENTIAL USE.
DOUBLE HATCHED LAND
IS LAND TO BE ANNEXED
BY GLENN MILLER AND
WILL HAVE PARTIAL RES-
IDENTIAL USE AND PAR-
TIAL OFFICE/COMMERCIAL
USE.

MILLET, WRIGHT, DUNN, HENDERSON
PROPOSAL FOR ANNEXATION TO CITY OF ROCHESTER

SCALE: 1" = 1000'
DRAWN: J. MICHAEL DUNN

JAN. 25, 1984

C.R. 34

STAFF RECOMMENDATION FOR ANNEXATION

(INCLUDES R.O.W FOR C.R. 34)



40302

40303

CASCADE TOWNSHIP
ROCHESTER TOWNSHIP

MILLER PROPERTY

WRIGHT, DUNN,
HENDERSON PROPERTY

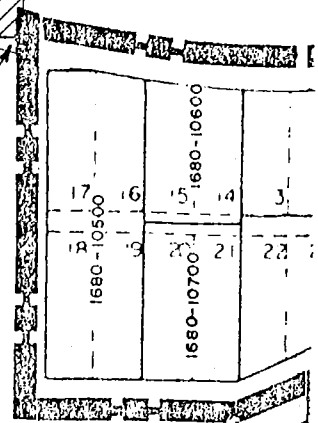
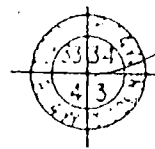

CITY LIMITS

HIGHLAND COURT SW

4 ST. SW

MILLOREST

23 AVE. S.W.

TERRYVIL

1690-100

21 22