

81-84

## RESOLUTION

WHEREAS, the Planning and Zoning Commission at the request of the owner of property located in the Town of Cascade, County of Olmsted, State of Minnesota, described as:

A part of the West One-Half of Section 15, Township 107 North, Range 14 West, Olmsted County, Minnesota, described as follows:

Commencing at the southeast corner of said West One-Half; thence North 00 degrees 20 minutes 20 seconds West, assumed bearing, along the east line of said West One-Half, 2631.41 feet to the southeast corner of the Northwest Quarter of said Section 15 for a point of beginning; thence continue North 00 degrees 20 minutes 20 seconds West along said east line, 140.73 feet; thence South 89 degrees 57 minutes 46 seconds West, 537.34 feet; thence northerly 72.88 feet along a nontangential curve concave northwesterly, radius of 683.20 feet, central angle of 06 degrees 06 minutes 42 seconds and the chord of said curve bears North 28 degrees 33 minutes 13 seconds East, 72.84 feet; thence North 64 degrees 30 minutes 08 seconds West, 114.21 feet; thence South 39 degrees 13 minutes 22 seconds West, 160.00 feet; thence South 45 degrees 09 minutes 02 seconds West, 185.26 feet to the south line of the Northwest Quarter of said Section 15; thence North 89 degrees 55 minutes 34 seconds East along said south line, 838.96 feet to the point of beginning. Being subject to an existing sanitary sewer easement. Also being subject to C.S.A.H. No. 112 (18th Avenue Northwest) right-of-way across the easterly boundary thereof.

has recommended that the Common Council of the City of Rochester initiate proceedings for annexation of said property to the City of Rochester; and

WHEREAS, said property is subject to a joint resolution for orderly annexation adopted by the Common Council on May 17, 1976 and approved by the Board of the Town of Cascade on May 5, 1976, which resolution was subsequently amended by a resolution approved by the Common Council on February 23, 1977 and the Board of the Town of Cascade on April 4, 1977; and

WHEREAS, information has been presented to the Common Council which indicated that said property is urban or suburban in nature and that the City of Rochester is fully capable of providing

municipal sewer and water and other services required by said property within a reasonable time.

NOW THEREFORE, BE IT RESOLVED by the Common Council of the City of Rochester that pursuant to said joint resolution, as amended, the Common Council hereby requests that the Minnesota Municipal Board undertake proceedings pursuant to Minnesota Statutes, §414.0325, for the annexation to the City of Rochester of the property described herefore which comprises approximately 2.79 acres and which is located in Cascade Township, County of Olmsted, State of Minnesota.

BE IT FURTHER RESOLVED that the City Clerk is hereby directed to forward a certified copy of this resolution by certified mail for service or filing as the case may be with the Secretary of the Minnesota Municipal Board, the Cascade Town Clerk, the Olmsted County Planning and Zoning Commission, and the Rochester Planning and Zoning Commission.

PASSED AND ADOPTED BY THE COMMON COUNCIL OF THE CITY OF ROCHESTER, MINNESOTA, THIS 21 DAY OF January, 1984.

  
\_\_\_\_\_  
PRESIDENT OF SAID COMMON COUNCIL

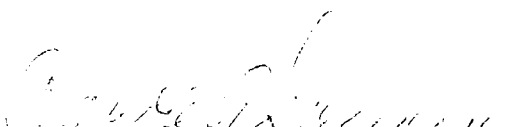
ATTEST:   
\_\_\_\_\_  
CITY CLERK

Approved this 22 day of January, 1984.

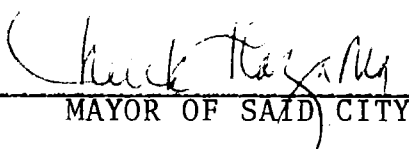
  
\_\_\_\_\_  
MAYOR OF SAID CITY

(Seal of the City of  
Rochester, Minnesota)

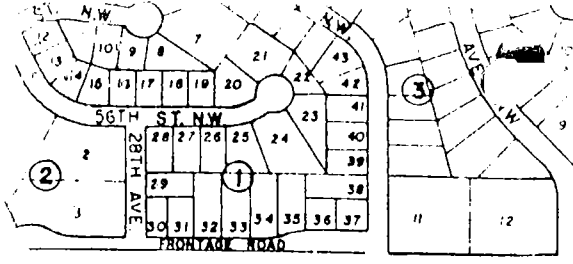

REC'D BY MAR 16 1984

PREPARED BY:  
McGHIE & BETTS, INC.

SCALE: 1" = 600'

AREA TO  
BE ANNEXED

