

JOINT RESOLUTION FOR ORDERLY ANNEXATION

IN THE MATTER OF THE JOINT RESOLUTION OF THE TOWN OF RUSHSEBA AND
THE CITY OF RUSH CITY DESIGNATING AN UNINCORPORATED AREA AS IN NEED
OF ORDERLY ANNEXATION

The Township of Rushseba and the City of Rush City hereby jointly agree to the following:

1. That the parties hereto designate the following described area in Rushseba Township for orderly annexation pursuant to Minnesota Statutes 414.0325:

Part of the Northeast 1/4 and Part of the Northwest 1/4, Section 22, Town 37 North, Range 21 West, Chisago County, Minnesota, lying outside of the present corporate limits of the City of Rush City as fully described in Exhibit A attached hereto and made a part hereof.

2. That the land area described in 1. hereinabove is 98 acres, more or less, and abuts the corporate limits of Rush City.

3. That the City of Rush City is capable of providing municipal services to this area upon the effective date of this resolution or within a reasonable time thereafter and, therefore, the parties desire that the entire described area be immediately annexed to the City of Rush City.

4. That the population of the described area is zero (0) persons.

5. That the zoning classification to be applied by the City of Rush City will be A-1 Agricultural consistent with the present land use in this area.

6. That no consideration by the Minnesota Municipal Board is necessary.

7. That there are no further conditions to this agreement beyond those stated herein.

8. The director of Municipal Boundary Adjustments may review and comment, but shall, within 30 days, order the annexation in accordance with the terms of the resolution.

City of Rush City

Passed and adopted by the City Council of the City of Rush City this 15th day of December, 2004.

Attest:

By:



Daniel P. Hoffman
Clerk



Mike Skalsky
Mayor

Town of Rushseba

Passed and adopted by the Town Board of the Town of Rushseba this 6th day of Dec, 2004.

Attest:

By:

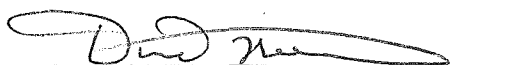

David Nelson
Clerk



Peter Johnson
Chairman

EXHIBIT A

All that part of the E $\frac{1}{2}$ of the NW $\frac{1}{4}$ of Section 22, Township 37, Range 21, Chisago County, MN lying north of the Grantsburg Branch of the Northern Pacific Railway Company right-of-way, except as follows:

1. The W 20 rods of the NE $\frac{1}{4}$ of the NW $\frac{1}{4}$ of said Section 22.
2. That portion or part of said NE $\frac{1}{4}$ of NW $\frac{1}{4}$ of said Section 22 lying north of the so-called "Rush City-St. Croix Road" containing $4 \frac{1}{3}$ acres more or less, heretofore deeded to Alex Vaughn.
3. Beginning at a point in the center line of the so-called "Rush City-St. Croix Road" as now located and which runs in a southwesterly and northwesterly direction through said NE $\frac{1}{4}$ of the NW $\frac{1}{4}$, 330 feet east of the west line of said NE $\frac{1}{4}$ of the NW $\frac{1}{4}$, thence in a northeasterly direction along the center line of said road 100 feet; thence south parallel with the west line of said NE $\frac{1}{4}$ of the NW $\frac{1}{4}$ to the center of Rush Creek as now located; thence in a westerly direction following the center line of Rush Creek to a point 330 feet east of the west line of said NE $\frac{1}{4}$ of the NW $\frac{1}{4}$; thence North parallel with the west line of said NE $\frac{1}{4}$ of the NW $\frac{1}{4}$ to the point of beginning.
4. That part of the NE $\frac{1}{4}$ of the NW $\frac{1}{4}$ of Section 22, Township 37 North, Range 21 West, Chisago County, Minnesota, described as follows:

Commencing at the north quarter corner of said Section 22; thence South 00 degrees 22 minutes 47 seconds East, assumed bearing along the east line of said NE $\frac{1}{4}$ of the NW $\frac{1}{4}$, a distance of 500.30 feet; thence North 88 degrees 23 minutes 41 seconds West, 262.28 feet; thence North 30 degrees 44 minutes 49 seconds West, 213.26 feet, to the point of beginning; thence South 30 degrees 44 minutes 49 seconds East, 213.26 feet; thence South 88 degrees 23 minutes 41 seconds East, 262.28 feet to the east line of said NE $\frac{1}{4}$ of the NW $\frac{1}{4}$; thence South 00 degrees 22 minutes 47 seconds East, along said east line, 180.46 feet; thence North 59 degrees 08 minutes 40 seconds West, 99.27 feet; thence South 50 degrees 49 minutes 30 seconds West, 129.32 feet; thence South 73 degrees 45 minutes 36 seconds West, 83.84 feet; thence South 27 degrees 25 minutes 12 seconds West, 51.55 feet; thence North 58 degrees 46 minutes 03 seconds West, 118.79 feet; thence South 55 degrees 00 minutes 37 seconds West, 121.09 feet; thence South 26 degrees 46 minutes 43 seconds East, 35.73 feet; thence South 50 degrees 00 minutes 32 seconds West, 148.56 feet; thence South 38 degrees 09 minutes 04 seconds West, 122.97 feet; thence South 75 degrees 33 minutes 40 seconds West, 129.73 feet; thence North 38 degrees 33 minutes 49 seconds West, 114.89 feet; thence North 75 degrees 28 minutes 08 seconds West, 25.41 feet, to the east line of the west 430 feet of said NE $\frac{1}{4}$ of the NW $\frac{1}{4}$, thence North 0 degrees 01 minutes 48 seconds West, along said east line to the center line of County Road No. 55; thence northeasterly, along said center line to the intersection of a line that bears North 65 degrees 42 minutes 51 seconds West, from the point of beginning, thence South 65 degrees 42 minutes 51 seconds East, along said line to the point of beginning.

All that part of the West $\frac{1}{2}$ of the NE $\frac{1}{4}$ of Section 22, Township 37, Range 21, Chisago County, Minnesota lying north of the Grantsburg Branch of the Northern Pacific Railway company right-of-way.

That portion of the NE $\frac{1}{4}$ of the SW $\frac{1}{4}$ of Section 22, Township 37, Range 21, Chisago County, Minnesota lying north of the Grantsburg Branch of the Northern Pacific Railway Company right-of-way.

REC'D BY NOV 10 2005

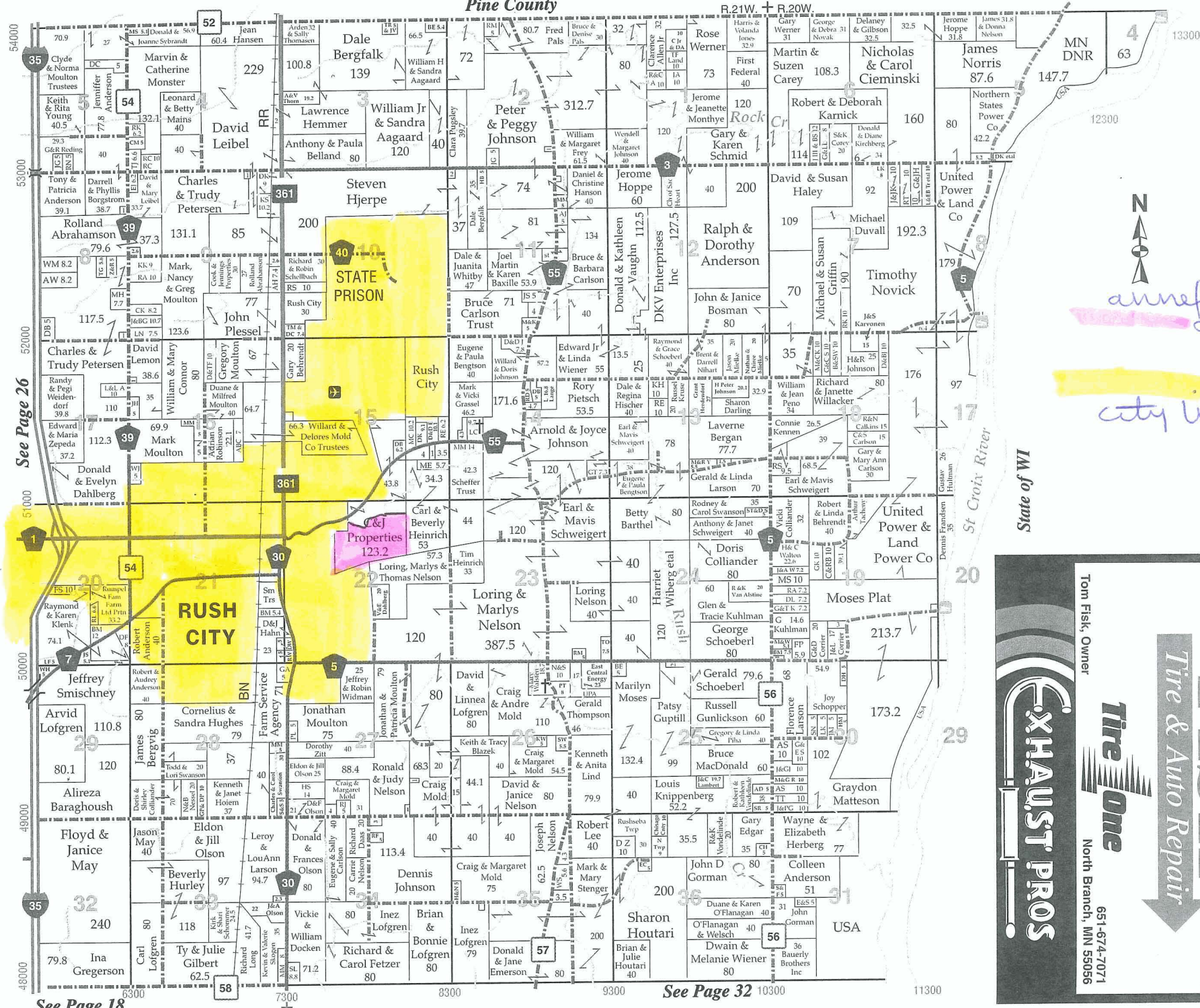

See Page 26

See Page 18

See Page 32

©2002 cloud cartographics, inc. st. cloud, mn 56301

EXHAUST PROS
Tire & Auto Repair
Tire One
Tom Fisk, Owner
651-674-7071
North Branch, MN 55056

annef
city limits

T37N R.21W

NOV 10 2005

(COUNTY ROAD NO. 55)

15	14
22	23

RUSH CITY MINNESOTA



city limits

anney
drea

NOV 10 2005

annet
area

