

**RESOLUTION No. 13**  
**A Joint Resolution of the City of Willmar and of**  
**St. John's Township and of Willmar Township**  
**Relating to Orderly Annexation of WILLMAR MUNICIPAL**  
**AIRPORT RIGHT OF WAY NO. 1-3**

WHEREAS, the City of Willmar (hereinafter the "City") and Township of St. John's (hereinafter "St. John's") and the Township of Willmar (hereinafter "Willmar") (and the two Townships Collectively referred to as "Townships") deem it necessary and appropriate that they work together to develop and implement a process for the orderly and controlled growth of the City and of their respective Township; and,

WHEREAS, the City and Townships agree that orderly development with municipal services and the orderly annexation of certain unincorporated areas located in the Townships is in the best interests of the community and of all affected political subdivisions; and,

WHEREAS, the land to be included in this plan for Orderly Annexation consists of the following Lands located in Kandiyohi County, Minnesota, described as follows, to-wit:

Willmar Municipal Airport Right of Way No. 1-3 as described below:

<i><b>Parcel Number</b></i>	<i><b>Sub- Letter</b></i>	<i><b>Acres</b></i>	<i><b>Total Acres</b></i>
Parcel 1	1-A	0.99	
	1-B	12.95	
	1-C	3.60	
	1-D	21.19	
	1-E	1.18	
	1-F	0.19	
	1-G	0.38	
			40.48
Parcel 2	2-A	13.08	13.08
Parcel 3	3-A	12.06	
	3-B	0.64	
	3-C	0.54	
	3-D	2.85	
	3-E	2.71	
	3-F	0.72	
			19.52
Parcel 4	4-A	0.43	
	4-B	1.14	

	4-C	5.09	
	4-D	0.20	
	4-E	2.40	
	4-F	4.84	
	4-I	0.17	
	4-J	0.73	
			15.00
Parcel 6	6-A	16.32	
	6-B	65.51	
	6-C	38.08	
	6-D	0.89	
	6-E	1.12	
			121.92
Parcel 7	7-A	0.28	
	7-B	0.11	
	7-C	0.21	
	7-D	1.54	
	7-E1	43.49	
	7-E2	47.11	
	7-G1	0.61	
	7-G2	1.40	
	7-H	0.85	
	7-I	10.18	
	7-J	3.06	
			108.84
Parcel 8	8-A	34.77	
	8-B	35.40	
	8-C	0.83	
	8-D	1.01	
	8-E	0.37	
	8-F	0.33	
	8-G	0.94	
	8-H	6.08	
	8-I	1.18	
	8-J	0.13	
			81.04
Parcel 9	9-A	0.85	
	9-B	1.29	
			2.14
Parcel 10	10-A	31.93	
	10-B	2.90	
			34.83
Parcel 11	11-B	10.98	10.98

Parcel 12	12-A	84.71	
	12-B	8.71	
	12-D	10.02	
			103.44
Parcel 13	13-A	2.46	
	13-B	2.54	
			5.00
Parcel 14	14-B1	0.50	
	14-B	0.28	
	14-C	0.77	
	14-D	0.98	
	14-E	37.34	
	14-F1	20.46	
			60.33
Parcel 15	15-A	39.75	
	15-B	0.86	
			40.61
Parcel 16	16-A	0.56	
	16-B	3.77	
			4.33
Parcel 18	18-A	.04	
	18-B	.87	
			.91
Parcel 19	19	4.12	
	19-B	1.39	
	19-D	0.48	
	19-E	0.35	
	19-F	0.30	
	19-G	0.53	
			7.17
Parcel 20	20-A	1.14	
	20-B	0.23	
	20-C	.77	
	20-D	0.98	
	20-E	15.79	
			18.91
Parcel 24	24-A	5.30	5.30
Parcel 25	25-A	6.08	6.08
Parcel 26	26-A	.01	.01

*Total*      *Acreage*      699.92  
more or less

And that these parcels, (hereinafter referred to as Annexation Properties) consist of areas that will best be served by the municipal services available through the City of Willmar; and,

WHEREAS, Minnesota Statutes Sections 414.0325 and following, provides a procedure whereby the City and the Townships may agree on a process of orderly annexation of a designated area; and

WHEREAS, the City and the Townships desire to accomplish orderly annexation of said area in a mutually acceptable and beneficial manner without the need for a hearing before the Minnesota Municipal Board;

WHEREAS, The City and Townships have determined that no alteration of the stated boundaries of **Annexation Properties** is appropriate, and that no consideration by the Minnesota Municipal Board is necessary.

NOW, THEREFORE, BE IT RESOLVED by the City Council of the City of Willmar and by the Town Board of supervisors of the Town of St. John's and by the Town Board of supervisors of the Town of Willmar jointly as follows:

1. **Designation of Orderly Annexation Areas.** The City and Townships hereby designate the following lands located in Kandiyohi County, Minnesota, as being in need of orderly annexation pursuant to Minnesota Statutes S 414.0325:

Willmar Municipal Airport Right of Way No. 1-3 as described below:

<i>Parcel Number</i>	<i>Sub- Letter</i>	<i>Acres</i>	<i>Total Acres</i>
Parcel 1	1-A	0.99	
	1-B	12.95	
	1-C	3.60	
	1-D	21.19	
	1-E	1.18	
	1-F	0.19	
	1-G	0.38	
			40.48
Parcel 2	2-A	13.08	13.08
Parcel 3	3-A	12.06	
	3-B	0.64	
	3-C	0.54	
	3-D	2.85	
	3-E	2.71	

MAY 11 2005

	3-F	0.72	19.52
Parcel 4	4-A	0.43	
	4-B	1.14	
	4-C	5.09	
	4-D	0.20	
	4-E	2.40	
	4-F	4.84	
	4-I	0.17	
	4-J	0.73	15.00
Parcel 6	6-A	16.32	
	6-B	65.51	
	6-C	38.08	
	6-D	0.89	
	6-E	1.12	121.92
Parcel 7	7-A	0.28	
	7-B	0.11	
	7-C	0.21	
	7-D	1.54	
	7-E1	43.49	
	7-E2	47.11	
	7-G1	0.61	
	7-G2	1.40	
	7-H	0.85	
	7-I	10.18	
	7-J	3.06	108.84
Parcel 8	8-A	34.77	
	8-B	35.40	
	8-C	0.83	
	8-D	1.01	
	8-E	0.37	
	8-F	0.33	
	8-G	0.94	
	8-H	6.08	
	8-I	1.18	
	8-J	0.13	81.04
Parcel 9	9-A	0.85	
	9-B	1.29	2.14
Parcel 10	10-A	31.93	

REC'D BY  
MMB

MAY 11 2005

	10-B	2.90	34.83
Parcel 11	11-B	10.98	10.98
Parcel 12	12-A	84.71	
	12-B	8.71	
	12-D	10.02	103.44
Parcel 13	13-A	2.46	
	13-B	2.54	5.00
Parcel 14	14-B1	0.50	
	14-B	0.28	
	14-C	0.77	
	14-D	0.98	
	14-E	37.34	
	14-F1	20.46	60.33
Parcel 15	15-A	39.75	
	15-B	0.86	40.61
Parcel 16	16-A	0.56	
	16-B	3.77	4.33
Parcel 18	18-A	.04	
		.87	.91
Parcel 19	19	4.12	
	19-B	1.39	
	19-D	0.48	
	19-E	0.35	
	19-F	0.30	
	19-G	0.53	7.17
Parcel 20	20-A	1.14	
	20-B	0.23	
	20-C	.77	
	20-D	0.98	
	20-E	15.79	18.91
Parcel 24	24-A	5.30	5.30

REC'D BY  
MMB

MAY 11 2005

Parcel 25	25-A	6.08	6.08
Parcel 26	26-A	.01	.01
		<b>Total</b>	<b>Acreage</b>
			699.92 more or less

2. **No Minnesota Municipal Board Hearing is Required.** Subject to the terms and conditions of this Resolution, the City and Townships hereby agree that **Annexation Properties** is in need of orderly annexation pursuant to Minnesota Statutes § 414.0325. No alteration of the stated boundaries is appropriate. No consideration by the Minnesota Municipal Board is necessary. All terms and conditions for annexation of said areas are provided for in this Resolution. The Minnesota Municipal Board may review and comment only. Within 30 days of receipt of this Joint Resolution, the Municipal Board shall order the annexation of **Annexation Properties**, in accordance with this Joint Resolution.
3. Governing Law. This Resolution is subject to the laws of the State of Minnesota.

Passed and adopted by the City Council of the **City of Willmar** this 2nd day of May, 2005

Lester J. Keith  
Mayor

ATTEST:

J. Halliday  
City Clerk

Passed and adopted by the Town Board of Supervisors of the **Town of St. John's** this 19th day of April, 2005.

Diane Y. Huttgen  
Chairperson

ATTEST:

Bernon Hardebeck  
Town Clerk

Passed and adopted by the Town Board of Supervisors of the **Town of Willmar** this 11 day of April, 2005.

Donna C. Mowen  
Chairperson

ATTEST:

Ron Klein  
Town Clerk



Proposed  
Annexation

REC'D BY  
MMB MAY 11 2005

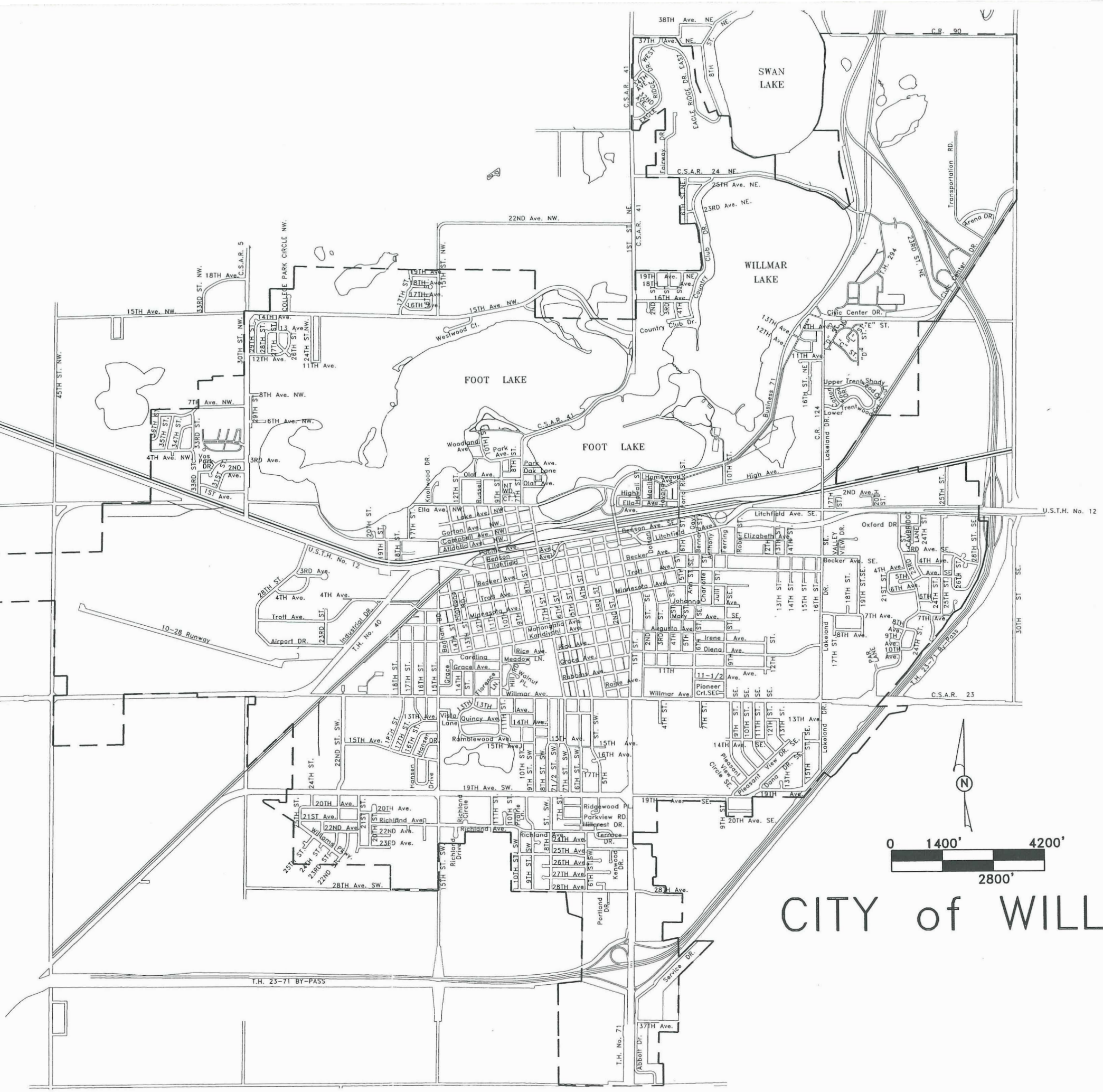

CITY of WILLMAR