

IN THE MATTER OF THE JOINT
RESOLUTION OF THE TOWNSHIP
OF MANKATO AND THE CITY OF
EAGLE LAKE DESIGNATING AN
UNINCORPORATED AREA AS IN
NEED OF ORDERLY ANNEXATION
AND CONFERRING JURISDICTION
OVER SAID AREA TO THE
MINNESOTA MUNICIPAL BOARD
PURSUANT TO M.S. 414.0325

The Township of Mankato and the City of Eagle Lake hereby jointly agree to the following:

1. That the following described area in Mankato Township is subject to orderly annexation pursuant to Minnesota Statutes 414.0325 and the parties hereto designate this area for orderly annexation, to wit:

The North Half of the Northwest Quarter of the Northeast Quarter of Section 13 Township 108 North Range 26 West, Blue Earth County, Minnesota,
EXCEPTION THEREFROM the following two parcels:

The West ¹⁶8 acres of the east North Half of the Northwest Quarter of the Northeast Quarter of said Section 13 and

The South 2 acres of the east 4 acres of the Northeast Quarter of the Northwest Quarter of the Northeast Quarter of said Section 13

2. That this property which abuts the City of Eagle Lake is presently urban or suburban in nature or is about to become so. Further, the City of Eagle Lake is capable of providing services to this area within a reasonable time and the annexation is in the best interest of the area proposed for annexation. Therefore, the aforementioned property will be immediately annexed to the City of Eagle Lake.
3. When the parcel is annexed, the City of Eagle Lake will reimburse Mankato Township for the loss of taxes generated from the property annexed. If the annexation becomes effective on or before August 1st of the levy year, the City may levy on the annexed area beginning the same levy year. If the annexation becomes effective after August 1st of the levy year, the Township may continue to collect property taxes on the property for that levy year and the City may not levy on the annexed area until the following year. For the year following the tax year in which the Township last collects a levy, the

City will reimburse the Township ninety percent (90%) of the amount of taxes that were collected by the Township in the previous year. For each year after, the City will reimburse a declining amount adjusted by ten percent (10%) of the original property taxes up until and including the year that the reimbursement equals ten percent (10%) of the original property taxes. Thereafter, the City will no longer reimburse the Township. At the City's discretion, it may make one payment equal to the total of the nine (9) annual payments.

4. The population change with this annexation shall be two (2).
5. Upon annexation, the parcel shall be zoned B-1, Community Business District.
6. Both the Township of Mankato and the City of Eagle Lake agree that no alteration of the stated boundaries of this agreement is appropriate. Furthermore, each party agrees that no consideration by the Municipal Board is necessary. Upon receipt of this resolution, passed and adopted by each party, the Municipal Board may review and comment, but shall, within thirty (30) days, order the annexation in accordance with the terms of this joint resolution.

Adopted by the City of Eagle Lake this 1st day of November, 2004.

City of Eagle Lake

By: Jamie Beal
Its: Mayor

ATTEST:

By: [Signature]
Its: City Administrator

(SEAL)

Adopted by the Township of Mankato this 16 day of November, 2004.

Mankato Township

By: Daniel C. Rothwell
Its: Chairman

ATTEST:

By: [Signature]
Its: Clerk

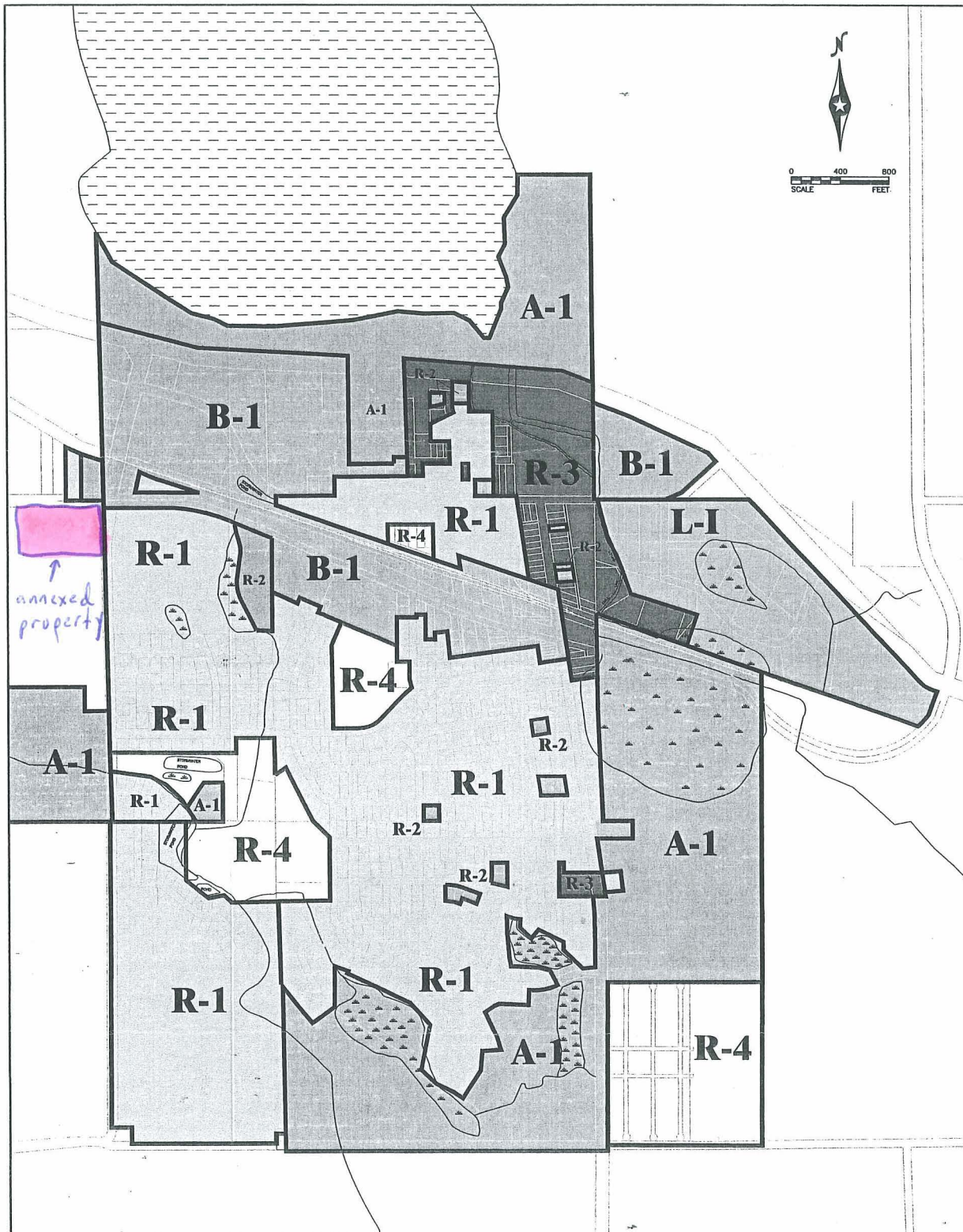

- A-1 AGRICULTURAL DISTRICT
- R-1 1 FAMILY RESIDENTIAL DISTRICT
- R-2 1 & 2 FAMILY RESIDENTIAL DISTRICT
- R-3 LIMITED MULTIPLE FAMILY RESIDENTIAL DISTRICT
- R-4 MULTIPLE FAMILY RESIDENTIAL DISTRICT
- B-1 COMMUNITY BUSINESS DISTRICT
- L-1 LIGHT INDUSTRIAL DISTRICT
- H-1 HEAVY INDUSTRIAL DISTRICT

EAGLE
LAKE 

BOLTON & MENK, INC

CONSULTING ENGINEERS & SURVEYORS

MANKATO, MN FAIRMONT, MN SLEEPY EYE, MN WILLMAR, MN
BURNSVILLE, MN CHASKA, MN AMES, IA

EAGLE LAKE, MINNESOTA
ZONING MAP

APRIL 2004

FIGURE NO. 1