

**BUFFALO TOWNSHIP RESOLUTION  
CITY OF BUFFALO RESOLUTION**

**JOINT RESOLUTION AND AGREEMENT FOR ORDERLY ANNEXATION  
BETWEEN BUFFALO TOWNSHIP AND THE CITY OF BUFFALO,  
MINNESOTA**

**WHEREAS**, the Buffalo Township Board passed a resolution on June 5, 2000, approving the annexation to the City of Buffalo of certain parcels of land owned by Annetta Esterly, legally described as follows:

See Attached Legal Description

**WHEREAS**, the City Council of the City of Buffalo agreed to the annexation of the above described parcel of land at its June 5, 2000 meeting; and

**WHEREAS**, the Buffalo Township board and the City Council for the City of Buffalo have both determined that the annexation of a portion of the Township with the City is of mutual benefit to both parties and the residents thereof.

**NOW, THEREFORE, BE IT RESOLVED** by the Buffalo Township Board and the City Council of the City of Buffalo as follows:

1. **Designation of Merger Area:** Buffalo Township ("Township") and the City of Buffalo ("City") desire to designate, by joint resolution and agreement, the area encompassing the territory of the Township as described herein (the "Annexed Parcel") subject to merger and orderly annexation under and pursuant to Minnesota Statutes SS 414.0325.
2. **Population of Merger Area:**
  - a.) The Township and the City state that the population of the annexed area is approximately 1 person.
  - b.) The 1999 State Demographer's estimate of the population of the City of Buffalo was 9,950 persons. Therefore, following the annexation, the estimated population of the City will increase by 1 person.
3. **State Agency Jurisdiction:** That upon approval by the respective governing bodies of the Township and the City, this Joint Resolution and Agreement confers jurisdiction upon the Minnesota Municipal Board to accomplish the orderly annexation in accordance with the terms of this Joint Resolution and Agreement.
4. **No alterations of Boundaries:** City and Township mutually state that no alterations by the Municipal Board of the boundaries of the area designated herein for orderly annexation is appropriate.

REC'D. BY JUL 19 2000  
MMB

5. **Authorization:** The appropriate officers of the City and the Township are hereby authorized to carry the terms of this Joint Resolution and Agreement into effect.
6. **Severability and Repealer:** Should any section of this Joint Resolution and Agreement be held by a court of competent jurisdiction to be unconstitutional or void, the remaining provisions will remain in full force and effect.
7. **Effective Date:** This Joint Resolution and Agreement is effective upon its adoption by the respective governing bodies of the Township and the City, as provided by law.

Adopted by the Buffalo Township Board the 11<sup>th</sup> day of July, 2000.

Attest:

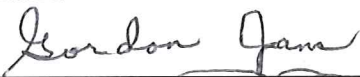
  
\_\_\_\_\_  
Chairperson of Town Clerk

Adopted by the City Council for the City of Buffalo the 5th day of June, 2000.

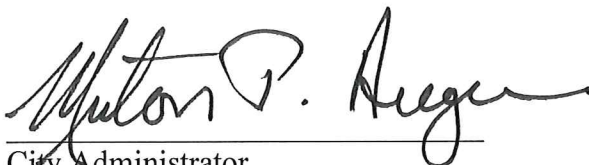
  
\_\_\_\_\_  
City Administrator

*Annette Esterly lot a horse*

# CERTIFICATE OF SURVEY

FOR

## JACOB ESTERLY

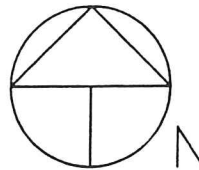

REC'D. BY JUL 19 2000  
MMB



GRAPHIC SCALE IN FEET

○ DENOTES IRON MONUMENT

### DESCRIPTION

That part of Lot 1 and Lot 4 of Block E of the West Half of the Southwest Quarter of Section 20, Township 120, Range 25, Wright County, Minnesota, according to the plat thereof on file and of record in the office of the County Recorder, Wright County, Minnesota, described as follows: Commencing at the southwest corner of the said West Half of the Southwest Quarter; thence North 89 degrees 26 minutes 38 seconds East, along the south line of the said West Half of the Southwest Quarter, a distance of 284.42 feet to the actual point of beginning; thence North 0 degrees 03 minutes 29 seconds West, a distance of 170.40 feet; thence North 89 degrees 26 minutes 38 seconds East, a distance of 110.00 feet; thence South 0 degrees 03 minutes 29 seconds East, a distance of 170.40 feet to the south line of the said West Half of the Southwest Quarter; thence South 89 degrees 26 minutes 38 seconds West along the said south line, a distance of 110.00 feet to the point of beginning. Containing 0.43 of an acre and subject to the right of way of C.S.A.H. No. 35 over the south 33.00 feet thereof.

We hereby certify that this is a true and correct representation of a survey of the land described above and of the location of all buildings thereon, and all visible encroachments, if any, from or on said land. As surveyed by me this 9<sup>th</sup> day of September, 1998.

By: Robert J. Rohlin  
Land Surveyor, Minnesota License No. 7439

MEYER-ROHLIN, INC  
ENGINEERS—LAND SURVEYORS  
1111 Hwy. 25N., Buffalo, MN 55313



REVISIONS \_\_\_\_\_

DATE 9-9-98

DRAWN BY  
TCM

BOOK 296  
PAGE 47-51&56

SHEET 1 OF  
1 SHEETS

FILE NO.  
98209



Buffalo which has  
even the status of Star  
has come from the  
rest...

known as the "Big  
je hardwoods - white  
ironwood, red elm,  
nut, and ash trees that  
thick no sunlight  
ground. This provided

between the warring tribes. But in  
1855 this treaty was revoked and the  
Winnebago were forced to move to  
the Blue Earth River. When the  
Winnebagos moved, the fur trading  
business run by Edmund Brissett died.  
The crooked, narrow road which was  
cut through the timbers, served as the  
track for traders and settlers to travel  
from Lake Calhoun to Buffalo Lake.  
Thus it was that Buffalo's history was  
begun.

When the railroad arrived in  
January of 1897, more people began to travel.  
Hundreds of people came to Buffalo in  
the summertime to stay in the resorts  
on Buffalo and Pulaski Lakes. But what  
was good for Buffalo, was equally  
good for towns farther away as the  
trains began providing better and  
faster transportation to further  
destinations. In January and February,  
1900 the local meat dealer shipped  
9,885 pounds of fish from Buffalo

services, commerce, education and  
housing. Just 35 minutes from  
Minneapolis or St. Cloud, Buffalo lies  
at the intersection of two major  
highways and on the shores of two  
major recreational lakes. The  
combination of a strong economic  
base, advanced technology and  
infrastructure and its beautiful  
environment have given Buffalo all the  
advantages of both small town and  
leading city.

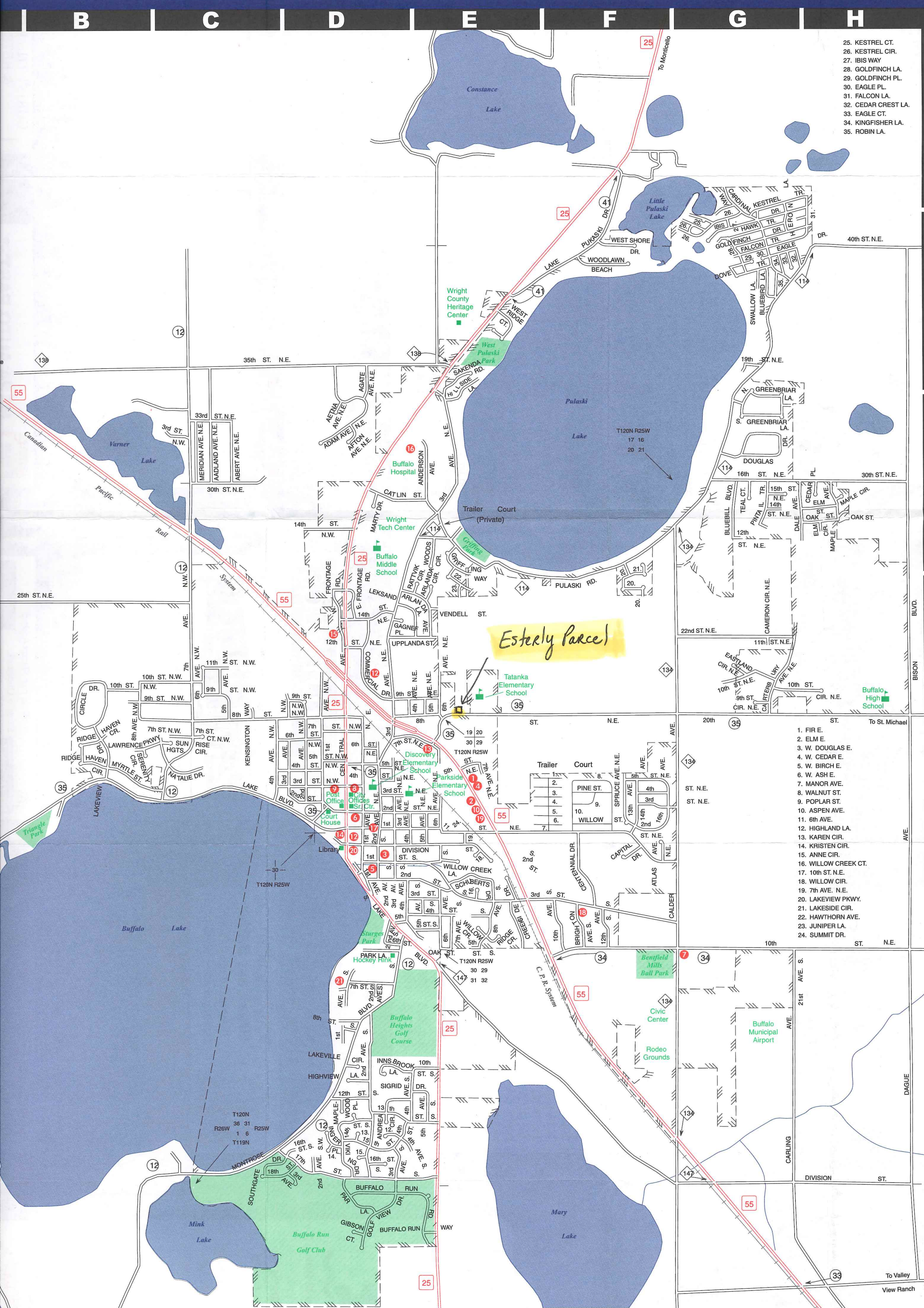

1  
2  
3  
4  
5  
6  
7