

RESOLUTION NO. 247 SECOND SERIES

A RESOLUTION DESIGNATING UNINCORPORATED AREAS AS IN NEED OF ORDERLY ANNEXATION AND CONFERRING JURISDICTION OVER SAID AREAS TO THE MINNESOTA MUNICIPAL COMMISSION

WHEREAS, Certain properties within the Township of Lake Marshall are in need of orderly annexation to the City of Marshall; and

WHEREAS, The properties are located in the County of Lyon and State of Minnesota and described as follows, to-wit:

A tract of land located in the Northwest Quarter of Section 10, Township 111 North, Range 41 West, County of Lyon, State of Minnesota, described as follows:

Beginning at the Northwest corner of said Northwest Quarter, thence North 89°52'36" East, assumed bearing along the North line of the Northwest Quarter 662.35 feet to the Northeast corner of the West Half of the Northwest Quarter of the Northwest Quarter; thence South 00°43'13" East parallel with the East line of Nuese Addition to the City of Marshall as platted and recorded in the office of the County Recorder of said Lyon County 1,473.23 feet to a point on the North line of the Holy Redeemer Cemetery thence North 89°56'39" West along said North line 342.35 feet; thence North 00°43'13" West along the East line of said Nuese Addition 956.00 feet to the Northeast corner of said Nuese Addition; thence South 89°16'47" West along the North line of said Nuese Addition 195.00 feet; thence North 00°43'13" West parallel with said East line 100.00 feet; thence South 89°16'47" West parallel with said North line 125.00 feet; thence North 00°43'13" West 419.50 feet to the Point of beginning.

Said tract of land contains 15.090 acres, more or less, comprised of the Edward and Marcella Nuese acreage to remain as currently, and 11.56 acres more or less to be developed as single family residential by Mark Nuese and Marlin Scotting.

WHEREAS, Said properties are within the orderly annexation area agreement contained in Resolution No. 1283, dated March 4, 1974, between Lake Marshall Township and the City of Marshall; and on file with the Minnesota Municipal Commission;

NOW, THEREFORE, BE IT RESOLVED, That upon the adoption of this resolution by the Common Council of the City of Marshall, jurisdiction over annexation of the above described areas be conferred to the Minnesota Municipal Commission, pursuant to M.S.A. 414.032.

Passed and adopted by the Common Council of the City of Marshall this 2nd day of January, 1979.

THE COMMON COUNCIL

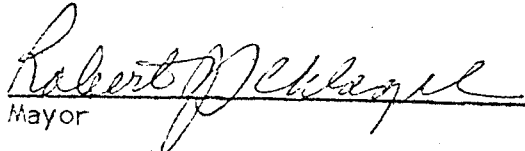
Mayor

Attest:

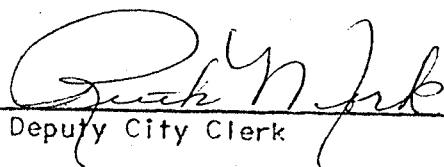
Deputy City Clerk

①

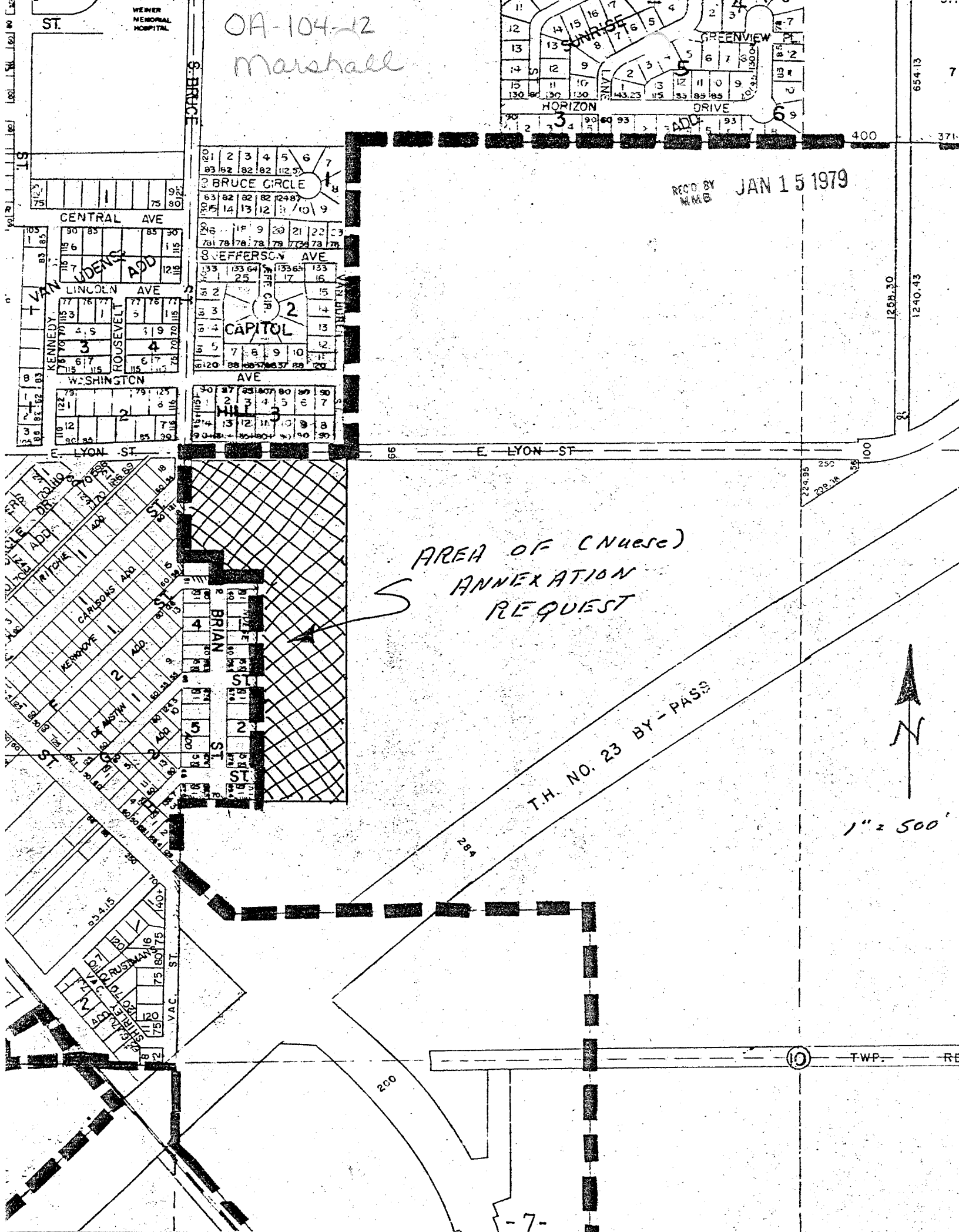

OA-104-12
Marshall

REC'D BY
MARB JAN 15 1979

AREA OF (Nuesc)
ANNEXATION
REQUEST

1" = 500'

T.H. NO. 23 BY-PASS

(10)

TWP. RE