

**ORDINANCE NO. 1138**

**AN ORDINANCE ANNEXING CERTAIN LANDS INTO THE CITY OF WASECA, MINNESOTA,  
AND ESTABLISHING ZONING THEREOF**

**WHEREAS**, the City of Waseca (the “City”) is the owner of approximately 335 acres of Waseca Municipal Airport and Wastewater Treatment Plant (WWTP) properties (Parcel ID No. 097500010, No. 090130510, No. 090130650, No. 090130560, No. 090140600, No. 090130500, and No. 090140500), which includes approximately 1.3 acres of adjacent dedicated street right-of-way (the “Properties”); and

**WHEREAS**, the Properties are legally described in “Exhibit A” and depicted in “Exhibit B” attached hereto and incorporated herein by reference; and

**WHEREAS**, the City wishes to annex the Properties and adjacent dedicated street right-of-way; and

**WHEREAS**, the Properties are contiguous to the limits of the City and are not included within any other municipality.

**NOW, THEREFORE**, the City Council of the City of Waseca, Minnesota, does hereby determine, find, and ordain the following:

- Section 1. That the Properties are contiguous to the City.
- Section 2. That the Properties are owned by the City or are adjacent dedicated street right-of-way.
- Section 3. The corporate limits of the City are extended to include the Properties.
- Section 4. Certified copies of this Ordinance shall be filed with the Municipal Boundary Adjustments Office, the Minnesota Secretary of State, the Waseca County Auditor, the Waseca County Recorder, and the Clerk of the St. Mary Township Board.
- Section 5. This Ordinance shall be effective upon passage, legal publication, the filing of the certified copies as described in Section 4, and upon approval of the Ordinance by the Municipal Boundary Adjustments Office.
- Section 6. Upon annexation the Properties will be zoned RR-S (Rural Service District).
- Section 7. The City and St. Mary Township (the “Township”) have mutually agreed, pursuant to Minnesota Statutes 414.036, that reimbursements from the City to the Township shall occur for the taxes collected on land annexed into the City according to the following conditions:
  - a. All reimbursements will be based on the valuation of the tax capacity of the land as it exists in the Township at the time of annexation.

- b. The reimbursement of said land shall be based on a four (4) year schedule with the percentage of taxes reimbursed to the Township as follows:  
Year 1 - 100%  
Year 2 - 75%  
Year 3 - 50%  
Year 4 - 25%
- c. After the fourth year, and every year thereafter, all pertinent tax revenues will be the property of the City.

Adopted by the City Council of the City of Waseca, Minnesota, this 7<sup>th</sup> day of April 2026.



---

RANDY L. ZIMMERMAN  
MAYOR

ATTEST:



---

JULIA ZUEHLKE  
CITY CLERK

Introduced: March 17, 2026  
Adopted: April 7, 2026  
Published: April 16, 2026  
Effective: April 26, 2026

## EXHIBIT A: Annexation Legal Descriptions

### City of Waseca Municipal Airport Properties:

Commencing at the SW corner of the SE  $\frac{1}{4}$  of Section 14, Township 107 North, Range 23 West, Waseca County, Minnesota; thence north along the west line of the east half of Section 14 to a point 848.1 feet south of the NW corner of the NE  $\frac{1}{4}$  of Section 14; thence northwesterly a distance of 998.4 feet to a point 525.9 feet west of the NW corner of the NE  $\frac{1}{4}$  of Section 14; thence east along the north line of Section 14 to a point 263.8 feet east of the NW corner of the NE  $\frac{1}{4}$  of Section 14; thence south parallel to the west line of the NE  $\frac{1}{4}$  of Section 14 a distance of 330 feet; thence east parallel to the north line of Section 14 a distance of 2,310 feet to the east line of Section 14; thence south along the east line of Section 14 to the SE corner of Section 14; thence west along the south line of Section 14 to the point of beginning; and including adjacent dedicated 110<sup>th</sup> Street right-of-way;

AND

Beginning at a point 263.8 feet east and 94.1 feet south of the NW corner of the NE  $\frac{1}{4}$  of Section 14, Township 107 North, Range 23 West, Waseca County, Minnesota; thence continuing south parallel to the west line of said NE  $\frac{1}{4}$  a distance of 235.9 feet; thence east parallel to the north line of said NE  $\frac{1}{4}$  a distance of 87.6 feet; thence northwesterly a distance of 253.8 feet to the point of beginning;

AND

Commencing at the SW corner of Section 13, Township 107 North, Range 23 West, Waseca County, Minnesota; thence north along the west line of Section 13 a distance of 399.2 feet; thence southeasterly 467.9 feet to a point on the south line of Section 13, said point being 246.5 feet east of the SW corner of Section 13; thence west along the south line of Section 13 a distance of 246.5 feet to the point of beginning.

AND

### City of Waseca Wastewater Treatment Plant (WWTP) Properties:

That part of the NW  $\frac{1}{4}$  of the SW  $\frac{1}{4}$  of Section 13, Township 107 North, Range 23 West, Waseca County, Minnesota, described as follows: Beginning at the Southwesterly corner of Lot 1, Block 1, Waseca Wastewater Treatment Facilities First Addition, according to the plat thereof on file at the Waseca County Recorder's Office; thence North 48°08'30" East (all bearings are referenced to the Waseca County Coordinate System NAD83 1996Adj HARN) along the South line of said Lot 1, Block 1 a distance of 301.47 feet; thence North 77° 25'11" East along said South line 394.43 feet; thence North 80°51'18" East along said South line 228.99 feet; thence South 83°52' 50" East along said South line 73.59 feet; thence South 61°06'42" East along said South line 49.96 feet; thence South 48°23'57" East along said South line 308.27 feet; thence South 19°16'35" East 150.00 feet to the South line of Document No. 309452 as recorded at the Waseca County Recorder's Office; thence South 70°43'25" West along said South line 88.14 feet; thence North 48°23'57" West along said South line 390.04 feet; thence South 78°45'14" West along said South line 573.22 feet; thence South 48°08'30" West along said South line 399.75 feet to the Easterly right-of-way line of 110<sup>th</sup> Street; thence North 00°38'39" East along said Easterly right-of-way line 203.46 feet to the point of beginning.

## EXHIBIT A: Annexation Legal Descriptions

AND

That part of the NW  $\frac{1}{4}$  of the SW  $\frac{1}{4}$  of Section 13, Township 107 North, Range 23 West, Waseca County, Minnesota, described as follows: Commencing at the Southwesterly corner of Lot 1, Block 1, Waseca Wastewater Treatment Facilities First Addition, according to the plat thereof on file at the Waseca County Recorder's Office, thence South 00°38'39" West (all bearings are referenced to the Waseca County Coordinate System NAD83 1996Adj HARN) along the Easterly right-of-way line of 110<sup>th</sup> Street 203.46 feet to the SW corner of Document No. 309452 as recorded at the Waseca County Recorder's Office and the point of beginning; thence North 84°04'19" East 1157.80 feet to the Southerly corner of said Document No. 309452; thence North 48°23'57" West along the South line of said Document No. 309452 a distance of 390.04 feet; thence South 78°45'14" West along said South line 573.22 feet; thence South 48°08'30" West along said South line 399.75 feet to the point of beginning.

AND

Lot 1 of Block 1 of Waseca Wastewater Treatment Facilities First Addition, Waseca County, Minnesota, as shown on the recorded plat thereof;

AND

### 110<sup>th</sup> Street Right-of-Way Properties:

The dedicated 110<sup>th</sup> Street right-of-way adjacent to Lot 1, Block 1, Waseca Wastewater Treatment Facilities First Addition, Waseca County, Minnesota, as shown on the recorded plat thereof and described as follows:

Commencing at the Northwest corner of the NW  $\frac{1}{4}$  of the SW  $\frac{1}{4}$  of Section 13, Township 107 North, Range 23 West, thence South 00°38'39" West along the West line of said NW  $\frac{1}{4}$  of the SW  $\frac{1}{4}$  55.00 feet to the point of beginning; thence continuing South 00°38'39" West 1121.33 feet; thence South 89°21'21" East 49.50 feet; thence North 00°38'39" East 1121.33 feet; thence North 89°39'40" West 49.50 feet to the point of beginning.

AND

That part of the SW  $\frac{1}{4}$  of Section 13, Township 107 North, Range 23 West, Waseca County, Minnesota, described as follows:

Commencing at the Southwest corner of the SW  $\frac{1}{4}$  of Section 13, Township 107 North, Range 23 West; thence north along the West line of said SW  $\frac{1}{4}$  a distance of 900.00 feet to the point of beginning; thence continuing north along said West line 584.22 feet; thence east 49.50 feet; thence south parallel to the West line of said SW  $\frac{1}{4}$  a distance of 584.22 feet; thence west 49.50 feet to the point of beginning;

EXCEPT

Land already within the City of Waseca.

# EXHIBIT B



**ALL AREAS OUTLINED  
IN YELLOW ARE  
PROPOSED TO BE  
ANNEXED INTO THE  
CITY OF WASECA.**

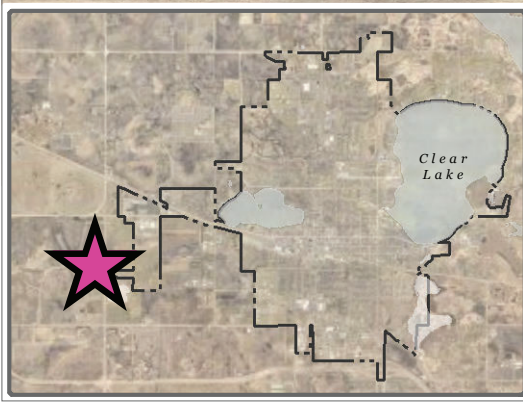

*This document is not a survey and should be used for reference purposes only!*

## ANNEXATION SITE MAP

Owners: City of Waseca  
Total Area: 334.94 Acres M/L  
Parcels: R09.013.0500, R09.013.0510, R09.013.0560,  
R09.013.0650, R09.014.0500, R09.014.0600,  
R09.750.0010, Section of Dedicated Right of Way

**ANNEXATION REQUEST  
BETWEEN THE  
CITY OF WASECA  
AND  
ST. MARY TOWNSHIP**

