

**RECEIVED**

By: OAH on June 27, 2022

**ORDINANCE NO. 20220519-01**

**AN ORDINANCE OF THE CITY OF LINDSTROM, MINNESOTA ANNEXING  
LAND LOCATED IN CHISAGO LAKE TOWNSHIP, CHISAGO COUNTY,  
MINNESOTA, PURSUANT TO MINNESOTA STATUTES § 414.033 SUBDIVISION 2(3),  
PERMITTING ANNEXATION BY ORDINANCE**

**WHEREAS**, a petition signed by the all of the property owners requesting that property, Parcel Identification Number: 02.00084.15, legally described as:

That part of Government Lot 5, Section 10, Township 33, Range 20 lying northerly of the centerline of Glader Boulevard, westerly of the southerly extension of the East line of said Lot 4, GERUB BEACH and easterly of the southerly extension of the West line of said Lot 5, GERUB BEACH.

Chisago County, Minnesota.

("Land") be annexed to the City of Lindstrom, Minnesota, was duly presented to the Lindstrom City Council on the 19th day of May, 2022; and

**WHEREAS**, said Land is unincorporated and abuts the City of Lindstrom on its eastern boundary; is less than 120 acres; is not presently served by public sewer facilities or public sewer facilities are not otherwise available; and

**WHEREAS**, said Land is located within a shoreland and/or floodplain area, the City has previously adopted or amended its land use controls to conform with Minnesota Statutes Chapter 103F, and new development of the Land shall be subject to Minnesota Statutes Chapter 103F in accordance with Minn. Stat. § 414.033, subd. 11; and

**WHEREAS**, said Land is currently zoned as residential, and annexation is requested to facilitate the development of the Land and connect to the City's sewer system; and

**WHEREAS**, the City of Lindstrom held a public hearing pursuant to Minn. Stat. § 414.033, subd. 2b, on May 19, 2022, following thirty (30) days' written notice by certified mail to Chisago Lake Township and to all landowners within and contiguous to the area legally described herein to be annexed; and

**WHEREAS**, pursuant to Minn. Stat. § 414.033, subd. 13, the sole property owner acknowledged that the City has notified the petitioner at least 30 days before the adoption of this ordinance that the cost of electric utility service may change if the Land is annexed to the City;

**NOW, THEREFORE, THE CITY COUNCIL OF THE CITY OF LINDSTROM HEREBY ORDAINS AS FOLLOWS:**

1. The City Council hereby determines that the Land as described herein abuts the city limits and is or is about to become urban or suburban in nature in that the annexation will facilitate the development of the Land.

2. None of the Land is now included within the limits of any city, or in any area that has already been designated for orderly annexation pursuant to Minn. Stat. § 414.0325.

3. The corporate limits of the City of Lindstrom, Minnesota, are hereby extended to include the following described property, said land abutting the City of Lindstrom and being 120 acres or less in area, and is not presently served by public sewer facilities or public sewer facilities are not otherwise available, and the City having received a petition for annexation from all the property owners of the land, to wit:

That part of Government Lot 5, Section 10, Township 33, Range 20 lying northerly of the centerline of Glader Boulevard, westerly of the southerly extension of the East line of said Lot 4, GERUB BEACH and easterly of the southerly extension of the West line of said Lot 5, GERUB BEACH.

Chisago County, Minnesota.

(“Land”);

The above-described property consists of a total of 0.06 acres, more or less. Copies of the corporate boundary map showing the property to be annexed and its relationship to the corporate boundaries and all appropriate plat maps are attached hereto and marked as **Exhibit A**.

4. That the population of the area legally described herein and hereby annexed is one (1).

5. Taxes/Reimbursement to Township. Pursuant to the requirements of Minn. Stat. § 414.036, the City shall provide a reimbursement to the town to compensate the town for the loss of taxable property in the amount of Ninety-Eight and 16/100 Dollars (\$98.16), which represents four years of township taxes on the property, payable in four annual payments in accordance with the following schedule:

1. In 2022, an amount equal to Twenty-Four and 54/100 Dollars (\$24.54).  
(1/4 total amount)
2. In 2023, an amount equal to Twenty-Four and 54/100 Dollars (\$24.54).  
(1/4 total amount)
3. In 2024, an amount equal to Twenty-Four and 54/100 Dollars (\$24.54).  
(1/4 total amount)
4. In 2025, an amount equal to Twenty-Four and 54/100 Dollars (\$24.54).  
(1/4 total amount)

There are no outstanding assessments against the Land assigned by the township.

6. That the City Clerk of the City of Lindstrom is hereby authorized and directed to file a copy of this Ordinance with the Municipal Boundary Adjustment Unit of the Office of Administrative Hearings, the Minnesota Secretary of State, the Chisago County Auditor, and the Chisago Lake Township Clerk.

7. That this Ordinance shall be in full force and effect and final upon the date this Ordinance is approved by the Office of Administrative Hearings.

PASSED AND ADOPTED by the City Council of the City of Lindstrom, Minnesota, this 19<sup>th</sup> day of May, 2022.

  
\_\_\_\_\_  
Kevin Stenson, Mayor

ATTEST:  
  
\_\_\_\_\_  
John Olinger, City Administrator  
(City Seal)



# Exhibit A

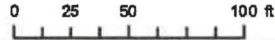

Date: 3/25/2022  
Time: 4:17:17 PM

These data are provided on as "AS-IS" basis, without warranty of any type, expressed or implied, including but not limited to any warranty as to their performance, merchantability, or fitness for any particular purpose.



# City of Lindstrom Official Map - February 28, 2022

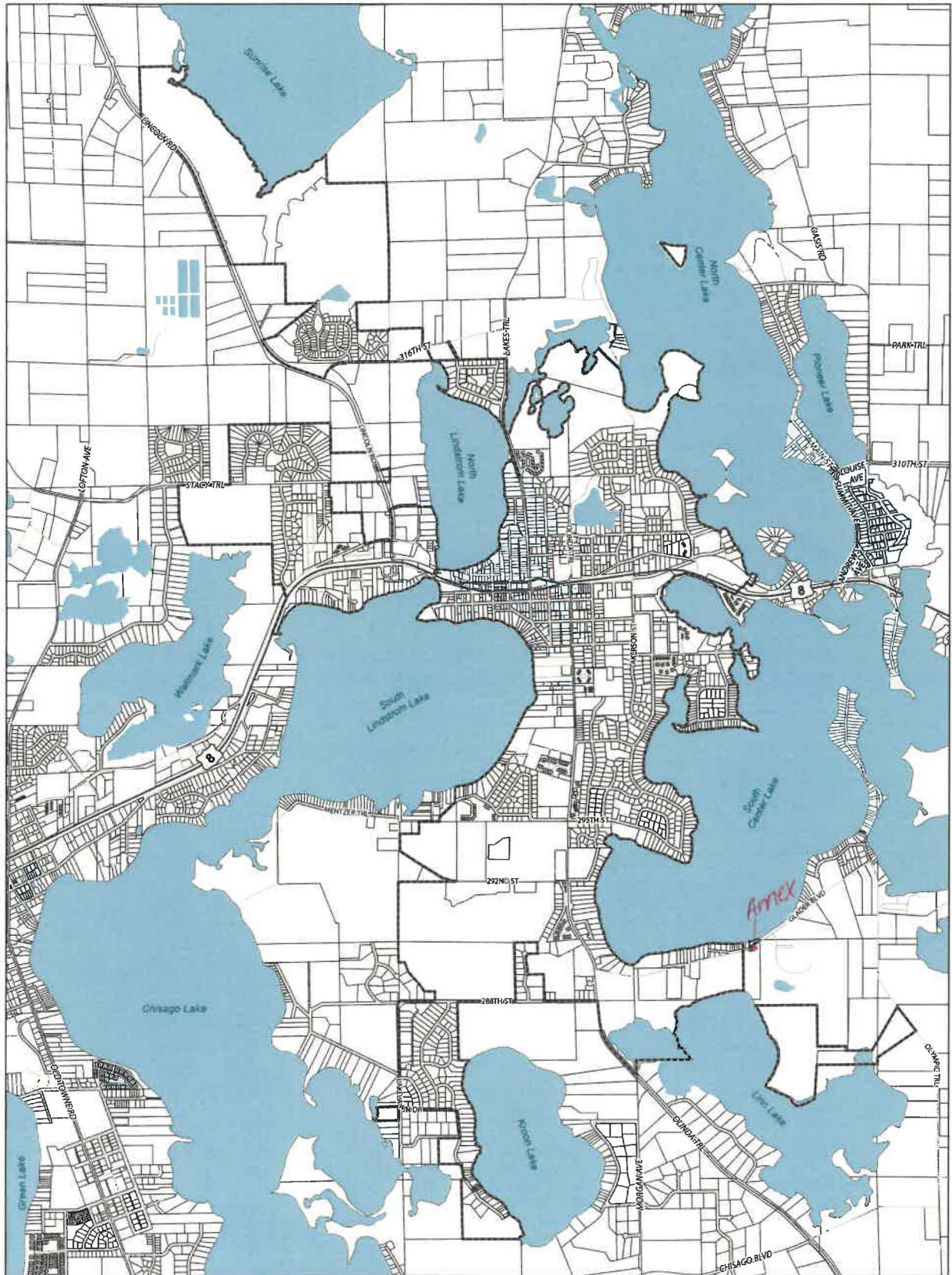

- Parcels
- City Boundary
- Lakes

