

**CITY OF WILTON
STATE OF MINNESOTA**

RECEIVED

By: OAH on June 16, 2022

ORDINANCE NO. 2022-002

**AN ORDINANCE OF THE CITY OF WILTON, MINNESOTA ANNEXING
LAND LOCATED IN ECKLES TOWNSHIP, BELTRAMI COUNTY, MINNESOTA
PURSUANT TO MINNESOTA STATUTES § 414.033 SUBDIVISION 2(3),
PERMITTING ANNEXATION BY ORDINANCE**

WHEREAS, a petition signed by all the property owners, requesting that property legally described herein be annexed to the City of Wilton Minnesota, was duly presented to the Council of the City of Wilton, on the, 26rd day of April, 2022; and

WHEREAS, said property is unincorporated and abuts the City of Wilton, on its Western boundary; is less than 120 acres; is not presently served by public sewer facilities or public sewer facilities are not otherwise available; and

WHEREAS, said property is not located within a shoreland area; any new development of annexed area is not subject to City of Wilton Zoning Ordinance No. 24A, Appendix V, Shoreland Management; and, chapter 103F Minnesota Statutes 414.033 Subd. 11; and

WHEREAS, said property is currently Rural / Residential and annexation is requested to facilitate the extension of future city services for the residential/urban/commercial/industrial development of the property; and

WHEREAS, the City of Wilton held a public hearing pursuant to Minnesota Statutes § 414.033 Subd. 2b, on the 13th day of June, 2022, following thirty (30) days written notice by certified mail to the Town of Eckles, and to all landowners within and contiguous to the area legally described herein to be annexed; and

WHEREAS, provisions of Minnesota Statutes § 414.033 Subd. 13 are not applicable in that there will be no change in the electric utility service provider resulting from the annexation of the territory to the municipality.

**NOW, THEREFORE, THE CITY COUNCIL OF THE CITY OF WILTON, MINNESOTA
HEREBY ORDAINS AS FOLLOWS:**

1. The City Council hereby determines that the property as hereinafter described abuts the city limits and is or is about to become urban or suburban in nature in that residential / urban / commercial / industrial development use is being proposed for said property the construction of which requires or will need future city services.
2. None of the property is now included within the limits of any city, or in any area that has already been designated for orderly annexation pursuant to Minnesota Statute § 414.0325.

3. The Corporate limits of the City of Wilton, Minnesota, are hereby extended to include the following described property, said land abutting the City of Wilton, and being 120 acres or less in area, and is not presently served by public sewer facilities or public sewer facilities are not otherwise available, and the City having received a petition for annexation from all the property owners of the land, to wit:

Parcel Number: 12.00338.00... **Legal Description:** The WEST 1/2 of the Southeast ¼ of the Southeast ¼, Section 27, Township 147, Range 34.

The above-described property consists of a total of 19.78 acres, more or less. Copies of the corporate boundary map showing the property to be annexed and its relationship to the corporate boundaries and all appropriate plat maps are attached hereto.

4. That the population of the area legally described (herein or attached exhibit) and hereby annexed is 1.

5. The City of Wilton, pursuant to Minnesota Statutes § 414.036, that with respect to the property taxes payable on the area legally described herein, hereby annexed, shall make a cash payment to the Town of Eckles in accordance with the following schedule:

OPTION A:

- a. In the first year following the year in which the City of Wilton could first levy on the annexed area, an amount equal to \$523.81; and
- b. In the second and final year, an amount equal to \$523.81.

6. That pursuant to Minnesota Statutes § 414.036 with respect to any special assessments assigned by the Town to the annexed property and any portion of debt incurred by the Town prior to the annexation and attributable to the property to be annexed, but for which no special assessments are outstanding, for the area legally described herein, there are no special assessments or debt incurred by the Town on the subject are for which reimbursement is required.

7. That the City Clerk of the City of Wilton, is hereby authorized and directed to file a copy of this Ordinance with the Municipal Boundary Adjustment Unit of the Office of Administrative Hearings, the Minnesota Secretary of State, the Beltrami County Auditor, and the Eckles Township Clerk.

8. That this Ordinance shall be in full force and effect and final upon the date this Ordinance is approved by the Office of Administrative Hearings.

PASSED AND ADOPTED by the City Council of the City of Wilton, Minnesota , this 13th day of June, 2022.

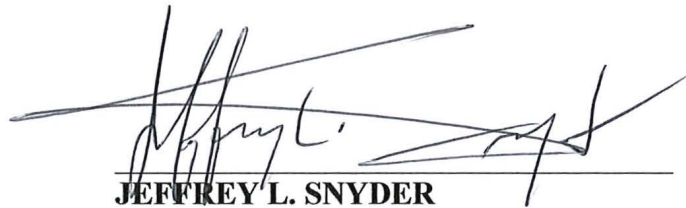

JEFFREY L. SNYDER

Mayor
City of Wilton

ATTEST:

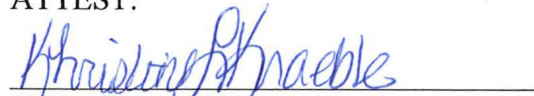

KHRISTINE L. KNAEBLE

Clerk-Administrator
City of Wilton

(Seal)

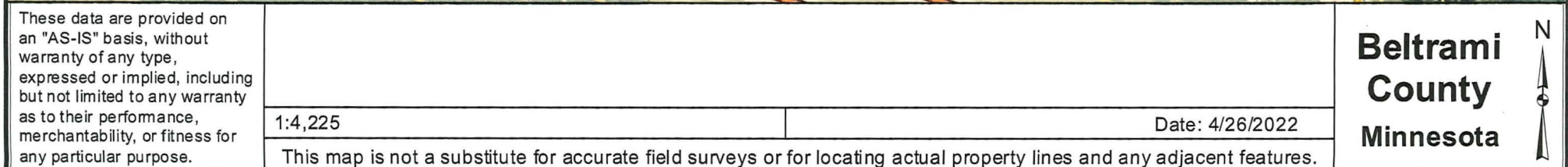

**Beltrami
County
Minnesota**



IN COOPERATION WITH
U.S. DEPARTMENT OF TRANSPORTATION
FEDERAL HIGHWAY ADMINISTRATION

SCALE

0.15 0.3 0.45 0.6 Miles

1 in = 800 ft
2020

North American Datum
of 1986



Population (U.S. Census 2010):	204
--------------------------------	-----

LAST EDITED ON 12-14-2020

To request information from this document in an alternative format, call 651-364-4718 or 1-800-657-3774 (Greater Minnesota); 711 or 1-800-627-3529 (Minnesota Relay). You may also send an e-mail to ADRequest.dot@state.mn.us. (Please request at least one week in advance.)