

(Reserved for recording purposes)

ORDINANCE NO. 796

AN ORDINANCE OF THE CITY OF PRINCETON, MINNESOTA ANNEXING LAND LOCATED IN PRINCETON TOWNSHIP, MILLE LACS COUNTY, MINNESOTA PURSUANT TO MINNESOTA STATUTES § 414.033 SUBDIVISION 2(3), PERMITTING ANNEXATION BY ORDINANCE

WHEREAS, a petition signed by all the property owners, requesting that property legally described (herein or attached exhibit) be annexed to the City of Princeton, Minnesota, was duly presented to the Council of the City of Princeton on the 16th day of June, 2020; and

WHEREAS, said property is unincorporated and abuts the City of Princeton on its southern boundary; is less than 120 acres; is not presently served by public sewer facilities or public sewer facilities are not otherwise available; and

WHEREAS, said property is open space owned by Cardinal Land Company and annexation is requested to facilitate a sale to the City for a Public Safety Storage Building; and

WHEREAS, the City of Princeton held a public hearing pursuant to Minnesota Statutes § 414.033 Subd. 2b, on Thursday, July 23, 2020, following thirty (30) days written notice by certified mail to the Township of Princeton and to all landowners within and contiguous to the area legally described herein, to be annexed; and

NOW, THEREFORE, THE CITY COUNCIL OF THE CITY OF PRINCETON HEREBY ORDAINS AS FOLLOWS:

1. The City Council hereby determines that the property as hereinafter described abuts the city limits and is or is about to become urban or suburban in nature in that the industrial use is being proposed for said property the construction of which requires or will need city services, including public sewer facilities.
2. None of the property is now included within the limits of any city, or in any area that has already been designated for orderly annexation pursuant to Minnesota Statute § 414.0325.
3. The corporate limits of the City of Princeton, Minnesota, are hereby extended to include the following described property, said land abutting the City of Princeton and being 120 acres or less in area, and is not presently served by public sewer facilities or public sewer facilities are not otherwise available, and the City having received a petition for annexation from all the property owners of the land, to wit:

That part of the West 150.00 feet of the East 450.00 of the north 500.00 feet of the Northeast quarter of the southwest quarter, and that part of the West

150.00 feet of the East 450.00 feet of the Southeast Quarter of the Northwest Quarter, both being in Section 32, Township 36, Range 26, Mille Lacs County, Minnesota, which lies South of the Westerly extension of the North line of Lot 8, block 1, Aero business Park First addition, said Mille Lacs County

The above described property consists of a total of 1.907 acres, more or less. Copies of the corporate boundary map showing the property to be annexed and its relationship to the corporate boundaries and all appropriate plat maps are attached hereto.

4. That the population of the area legally described herein and hereby annexed is zero ("0").

5. That pursuant to Minnesota Statutes § 414.036 there are no special assessments assigned by the City to the annexed for which reimbursement is required.

6. The City of Princeton, pursuant to Minnesota Statutes § 414.036 that with respect to the property taxes payable on the area legally described (herein or attached exhibit), hereby annexed, shall make a cash payment to the Township of Princeton in accordance with the following schedule:

a. In the first year following the year in which the City of Princeton could first levy on the annexed area, an amount equal to \$ 14.11; and

b. In the second and final year, an amount equal to \$ 14.11

7. That the City Clerk of the City of Princeton is hereby authorized and directed to file a copy of this Ordinance with the Municipal Boundary Adjustment Unit of the Office of Administrative Hearings, the Minnesota Secretary of State, the Mille Lacs County Auditor, and the Princeton Township Clerk.

8. That this Ordinance shall be in full force and effect and final upon the date this Ordinance is approved by the Office of Administrative Hearings.

PASSED AND ADOPTED by the City Council of the City of Princeton, Minnesota on this 23rd day of July, 2020.



Brad Schumacher, Mayor

ATTEST:



Shawna Jenkins Tadych, City Clerk

(City Seal)

This instrument was drafted by:

Shawna Jenkins Tadych
City of Princeton
705 2nd Street North
Princeton MN 55371

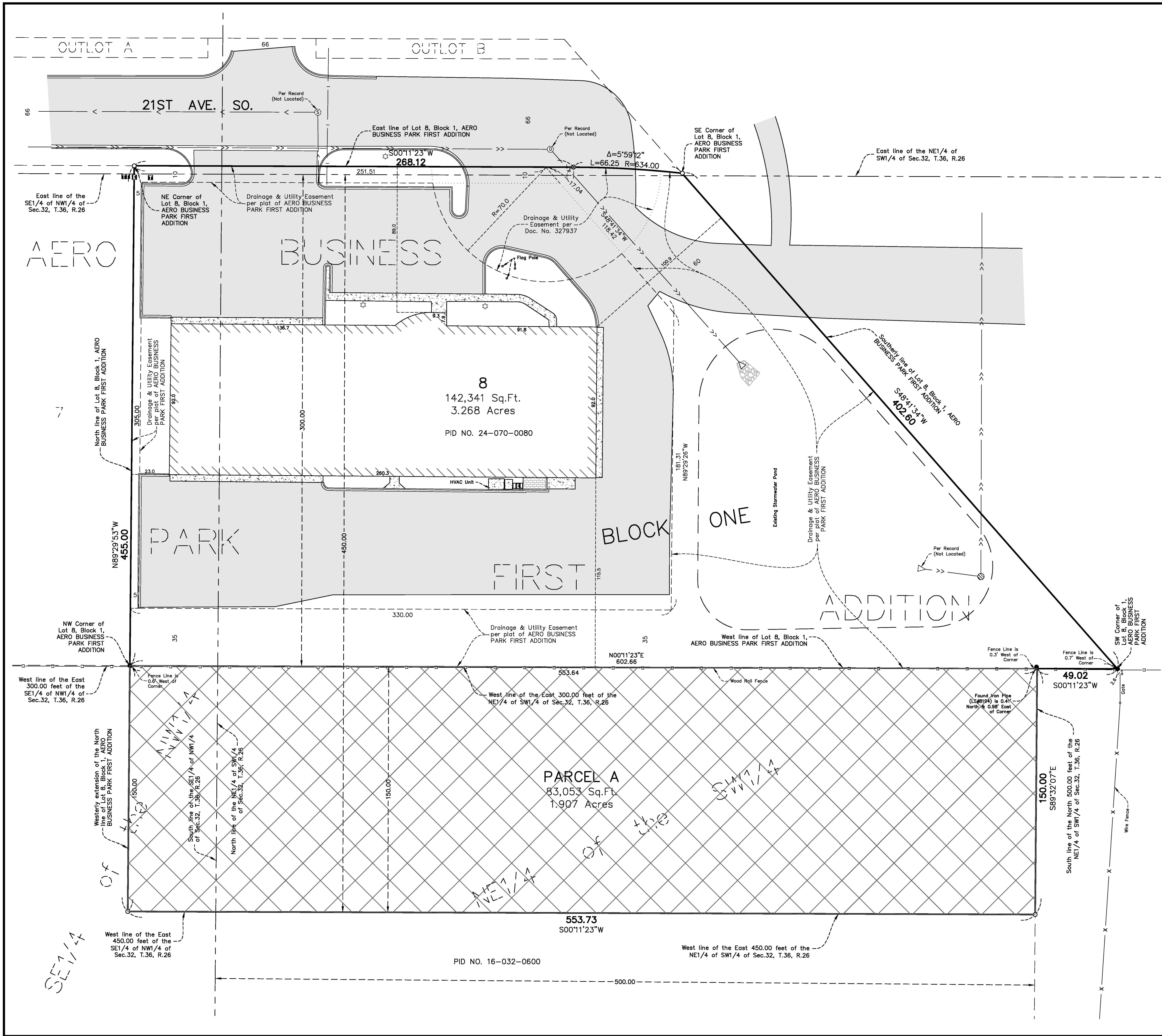

EXISTING PROPERTY DESCRIPTION: (3.268 Acres)
(PID NO. 24-070-0080)

Lot 8, Block 1, AERO BUSINESS PARK FIRST ADDITION, Mille Lacs County, Minnesota.

PARCEL A DESCRIPTION:
TO BE ANNEXED FROM PID NO. 16-032-0600

That part of the West 150.00 feet of the East 450.00 of the North 500.00 feet of the Northeast Quarter of the Southwest Quarter, and that part of the West 150.00 feet of the East 450.00 feet of the Southeast Quarter of the Northwest Quarter, both being in Section 32, Township 36, Range 26, Mille Lacs County, Minnesota, which lies South of the Westerly extension of the North line of Lot 8, Block 1, AERO BUSINESS PARK FIRST ADDITION, said Mille Lacs County.

REVISED PROPERTY DESCRIPTION: (5.175 Acres)
(PID NO. 24-070-0080)

Lot 8, Block 1, AERO BUSINESS PARK FIRST ADDITION, Mille Lacs County, Minnesota.







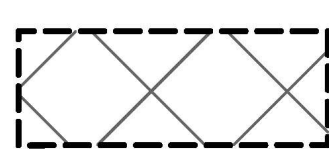

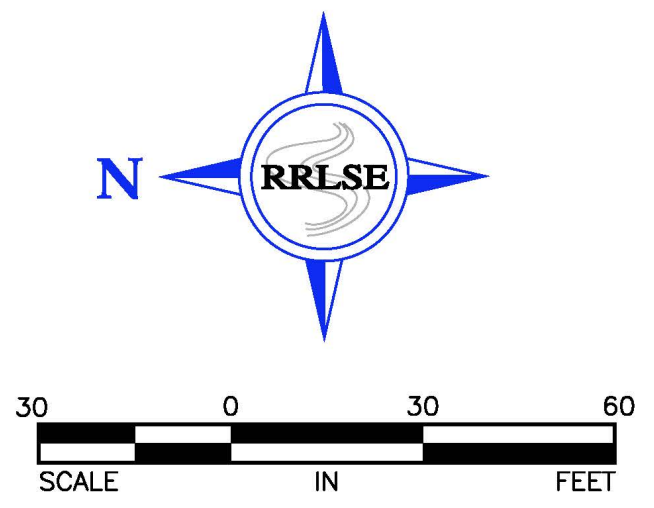





AND

That part of the West 150.00 feet of the East 450.00 of the North 500.00 feet of the Northeast Quarter of the Southwest Quarter, and that part of the West 150.00 feet of the East 450.00 feet of the Southeast Quarter of the Northwest Quarter, both being in Section 32, Township 36, Range 26, said Mille Lacs County, which lies South of the Westerly extension of the North line of said Lot 8, Block 1, AERO BUSINESS PARK FIRST ADDITION.

- NOTES:**
- The professional surveyor has made no investigation or independent search for easements of record, encumbrance, restrictive covenants, ownership title evidence, or any other facts that an accurate and current title search may disclose.
 - In providing this survey no attempt has been made to obtain or show data concerning existence, size, depth, condition, capacity or location of any utility existing on the site, whether private, municipal or public owned.
 - Bearings are based on the Mille Lacs County Coordinate System (NAD83 1996 Adjustment).
 - Interior fences exist on Parcel A that were not located.

 Denotes Proposed Area to be Annexed



- LEGEND**
-  = DENOTES 1/2" IRON PIPE SET AND MARKED WITH LICENSE NO. 49138
 -  = DENOTES FOUND IRON MONUMENT
 -  = DENOTES FOUND CONCRETE NAIL
 -  = DENOTES WATER LINE
 -  = DENOTES SANITARY SEWER MANHOLE
 -  = DENOTES SANITARY SEWER LINE
 -  = DENOTES OUTLET STRUCTURE
 -  = DENOTES FLARED END SECTION
 -  = DENOTES STORM SEWER MANHOLE
 -  = DENOTES STORM SEWER LINE
 -  = DENOTES TELEPHONE PEDESTAL
 -  = DENOTES ELECTRIC TRANSFORMER
 -  = DENOTES LIGHT POLE
 -  = DENOTES CONCRETE SURFACE
 -  = DENOTES BITUMINOUS SURFACE

DESIGNED BY	SWM	REVISION		DATE	07/21/20
DRAWN BY	SWM	added hatch			
CHECKED BY	BP				
BOOK					
PAGE					
SCALE	1"=30'				
DATE	07/16/20				
FILE NO.	P-PT101				

I hereby certify that this survey, plan or report was prepared by me or under my direct supervision and that I am a duly Licensed Professional Land Surveyor under the laws of the State of Minnesota.

Brian P. P. P.
Brian P. P. P.
MN License No. 99138 Date 07/16/20

RUM RIVER
LAND SURVEYORS & ENGINEERS
90 Box 104
Princeton, MN 55371
Telephone: (763) 399-4476
Fax: (763) 681-0876

Lot 8, Block 1, AERO BUSINESS PARK FIRST ADDITION, and Part of Sec.32, T.36, R.26, Mille Lacs County, Minnesota

Certificate of Survey
~ for ~
City of Princeton

SHEET NUMBER
1

© 2020 RUM RIVER LAND SURVEYORS & ENGINEERS

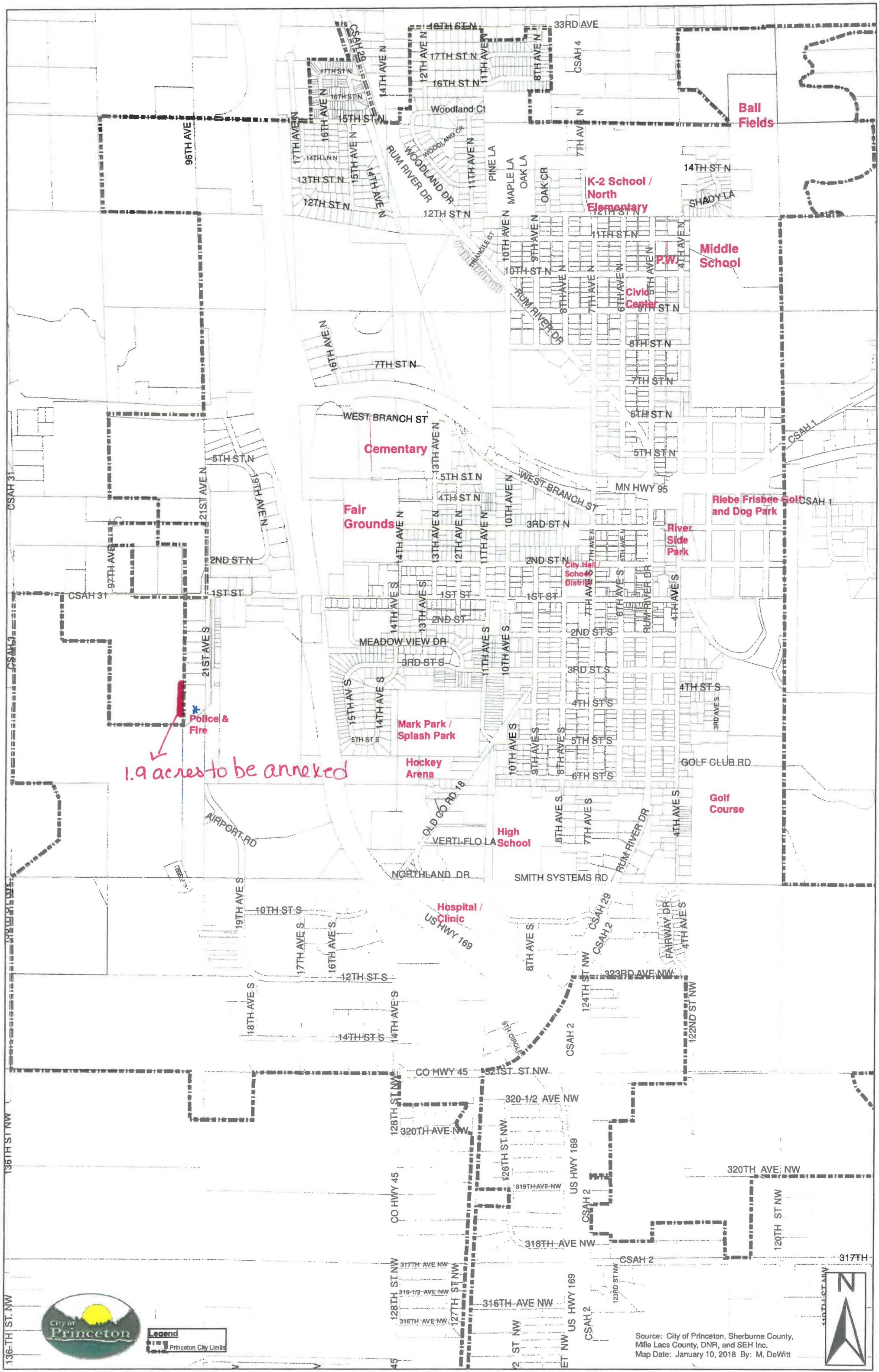

1.9 acres to be annexed



Legend
Princeton City Limits

Source: City of Princeton, Sherburne County, Mille Lacs County, DNR, and SEH Inc.
Map Date: January 10, 2018 By: M. DeWitt

