

# RECEIVED

by OAH on November 5, 2018

## ANNEXATION PETITION

### IN THE MATTER OF THE PETITION FOR ANNEXATION OF CERTAIN UNINCORPORATED LAND TO THE CITY OF SLEEPY EYE.

We, Roger G. Marti and Marsha G. Marti, 25890 US Highway 14, Sleepy Eye, MN 56085, hereby petitions for the annexation of property in Home Township, Brown County, Minnesota legally described as follows:

That part of Lot D of the Northwest Quarter of the Northeast Quarter of Section 29, Township 110 North, Range 32 West, Brown County, Minnesota described as follows:

Beginning at the Northeast corner of Lot 4, Block Three, Fairhill Second Addition; thence North 89 degrees 47 minutes 07 seconds West, bearings based on Brown County Coordinate System NAD83(11) on the north line of said Fairhill Second Addition, a distance of 33.41 feet to the west line of said Lot D; thence North 00 degrees 02 minutes 32 seconds West, on said west line, a distance of 198.69 feet; thence South 89 degrees 53 minutes 46 seconds East, a distance of 33.41 feet; thence South 00 degrees 02 minutes 32 seconds East, a distance of 198.76 feet to the point of beginning. Parcel contains 0.15 acres of land (hereinafter "Property").

The Property is to be platted as Todnem Addition, City of Sleepy Eye, Brown County, Minnesota.

I hereby respectfully state:

1. The undersigned are the sole owners of the Property.
2. The Property to be annexed abuts the City of Sleepy Eye, a municipality.
3. The Property to be annexed is 120 acres or less.
4. The Property to be annexed is not presently served by public wastewater facilities or public wastewater facilities are not otherwise available.
5. The Property is urban or suburban in character, or about to become so.
6. This proceeding is commenced pursuant to Minnesota Statute Section 414.033.

Dated: 8-16-, 2018

Roger G. Marti

Marsha G. Marti  
Marsha G. Marti

On this 16<sup>th</sup> day of Aug., 2018, before me, a Notary Public, within and for said County and State, personally appeared Roger G. Marti and Marsha G. Marti, to me known to be the same persons described in and who executed the foregoing petition, and acknowledged that they executed the same in their free act and deed.

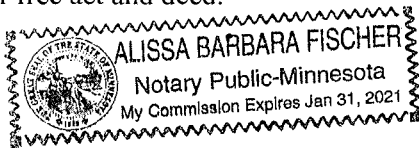

  
Notary Public

This instrument was drafted by:  
Alissa Fischer  
Attorney at Law  
128 Main St E  
PO Box 351  
Sleepy Eye, MN 56085  
(507)794-4141



# Brown County Mapping

## Map Title

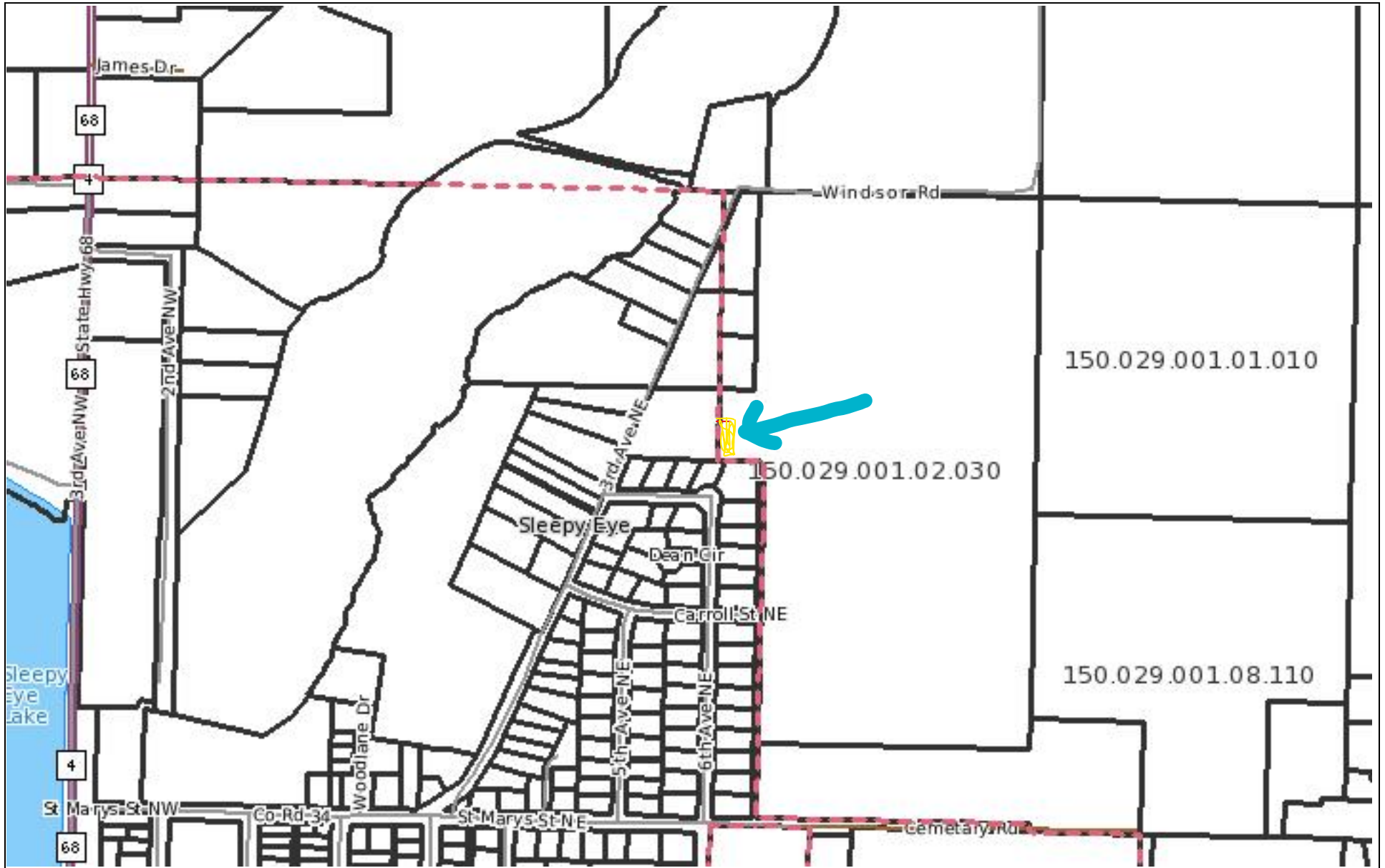

**Disclaimer:** No certification or accuracy of information is made or implied. Information may change without notice. The information and maps provided are for informational purposes only and is not legally binding. *Brown County 2010*



# Brown County Mapping

## Map Title

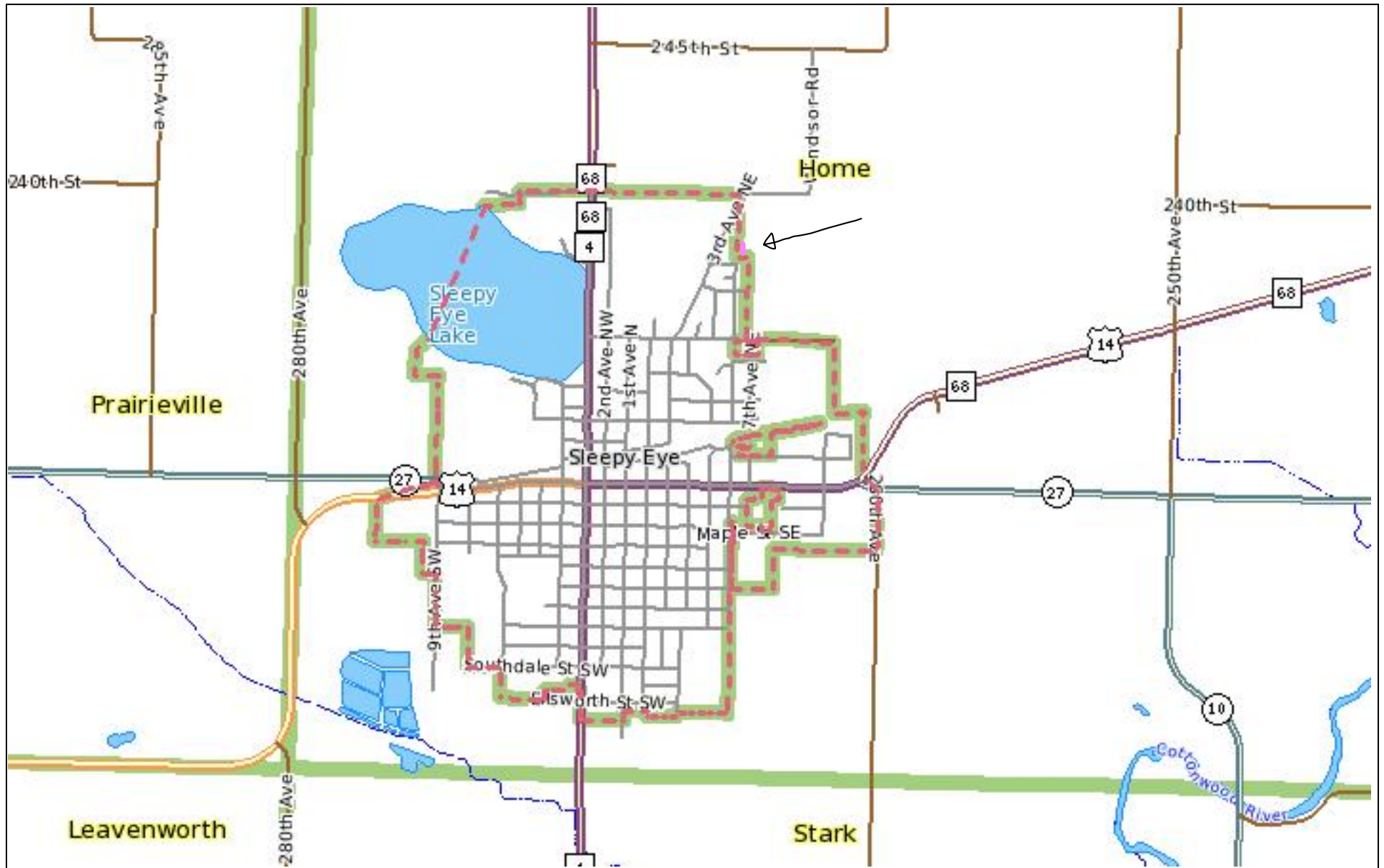

**Disclaimer:** No certification or accuracy of information is made or implied. Information may change without notice. The information and maps provided are for informational purposes only and is not legally binding. *Brown County 2010*