

NOTICE OF INTENT FOR ANNEXATION

IN THE MATTER OF THE NOTICE OF INTENT FOR THE ANNEXATION
OF CERTAIN LAND TO THE CITY OF LA CRESCENT, MINNESOTA
PURSUANT TO MINNESOTA STATUTES § 414.033, SUBD. 3

TO: La Crescent Town Board
Attn: Karen Schuldt, Township Clerk
4610 CTH 6
La Crescent, MN 55947; and

Office of Administrative Hearings
Municipal Boundary Adjustment Unit
P. O. Box 64620
St. Paul, MN 55164-0620

WHEREAS, the territory described below is not presently within the corporate limits of any incorporated city, and

WHEREAS, the area proposed for annexation is 40 acres or less in size, is 60% or more bordered by land already within the corporate limits of the City of La Crescent, and is not appropriate for annexation by ordinance pursuant to Minnesota Statutes § 414.033, Subd. 2(3); and

WHEREAS, the area proposed for annexation is described as follows:

SEE EXHIBIT A and EXHIBIT B

WHEREAS, the area proposed for annexation abuts upon the corporate limits of the City of La Crescent, Minnesota; and

WHEREAS, the area proposed for annexation is unincorporated, abuts on the city's boundaries and is not included within any other municipality; and

WHEREAS, the area proposed for annexation is approximately 5.6 acres in size; and

WHEREAS, the reason for the proposed annexation is the subject area is now suburban in character. The present population requires the City to continue to grow in an orderly and planned manner in order to continue to provide needed government services in a cost-effective and feasible manner. The properties described on Exhibit A have the ability to be served by City water and sewer. The City of La Crescent needs to annex additional property in order to expand; and

WHEREAS, the nature of the area proposed for annexation is residential; and

WHEREAS, the area proposed for annexation is not included in any area that has already been designated for orderly annexation pursuant to Minnesota Statutes § 414.0325, nor in any other proceeding currently pending before the Office of Administrative Hearings - Municipal Boundary Adjustment Unit; and

NOW THEREFORE, BE IT RESOLVED, BY THE CITY COUNCIL OF THE CITY OF LA CRESCENT, MINNESOTA that we hereby serve a Notice of Intent to annex the above-described property into the corporate limits of the City of La Crescent, Minnesota on: La Crescent Township; Houston County; and the Municipal Boundary Adjustment Unit of the Office of Administrative Hearings.

Adopted this 9th day of November, 2015.

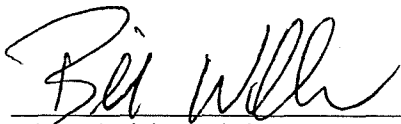

Mayor

City Clerk/Administrator

EXHIBIT A

REC'D BY
MBA

NOV 13 2015

Parcel 08.0123.001:

PART OF LOT NINE (9) OF BLOCK H, OF AUDITORS SUBDIVISION OF SECTION NINE (9), TOWNSHIP ONE HUNDRED FOUR (104) NORTH, RANGE FOUR (4) WEST, LOCATED IN THE NORTHEAST QUARTER OF THE SOUTHEAST QUARTER (NE $\frac{1}{4}$ SE $\frac{1}{4}$) OF SECTION NINE (9), TOWNSHIP ONE HUNDRED FOUR (104) NORTH, RANGE FOUR (4) WEST, LA CRESCENT TOWNSHIP, HOUSTON COUNTY, MINNESOTA, DESCRIBED AS FOLLOWS:

COMMENCING AT THE EAST QUARTER CORNER OF SECTION NINE (9), TOWNSHIP ONE HUNDRED FOUR (104) NORTH, RANGE FOUR (4) WEST; THENCE SOUTH 00°07'50" WEST, 1137.59 FEET ALONG THE EAST LINE OF THE SOUTHEAST QUARTER (SE $\frac{1}{4}$) OF SAID SECTION NINE (9), TO THE NORTHERLY RIGHT-OF-WAY LINE OF COUNTY STATE AID HIGHWAY 6; THENCE SOUTHWESTERLY ALONG SAID RIGHT-OF-WAY LINE, 345.61 FEET, ALONG THE ARC OF A 1942.86 FOOT RADIUS CURVE, CONCAVE TO THE SOUTHEAST, THE CHORD OF WHICH BEARS SOUTH 78°40'58" WEST, AND MEASURES 345.16 FEET, TO THE POINT OF BEGINNING OF THIS DESCRIPTION; THENCE CONTINUING SOUTHWESTERLY ALONG SAID RIGHT-OF-WAY LINE, 83.77 FEET ALONG THE ARC OF A 1942.86 FOOT RADIUS CURVE, CONCAVE TO THE SOUTHEAST, THE CHORD OF WHICH BEARS SOUTH 72°21'05" WEST, AND MEASURES 83.77 FEET; THENCE SOUTH 71°06'58" WEST, 47.95 FEET ALONG THE NORTHERLY RIGHT-OF-WAY LINE OF COUNTY STATE AID HIGHWAY 6, TO THE SOUTHWESTERLY LINE OF THE PARCEL OF LAND DESCRIBED IN HOUSTON COUNTY DOCUMENT NO. 197968; THENCE NORTH 14°45'52" WEST, 669.79 FEET ALONG THE SOUTHWESTERLY LINE OF THE PARCEL DESCRIBED IN DOCUMENT NO. 197968; THENCE SOUTH 89°52'10" EAST, 301.91 FEET; THENCE SOUTH 11°10'46" EAST, 265.19 FEET; THENCE SOUTHERLY, 112.58 FEET ALONG THE ARC OF A 129.87 FOOT RADIUS CURVE, CONCAVE TO THE WEST, THE CHORD OF WHICH BEARS SOUTH 13°39'18" WEST, AND MEASURES 109.09 FEET; THENCE SOUTHERLY, 216.07 FEET ALONG THE ARC OF A 229.56 FOOT RADIUS CURVE, CONCAVE TO THE EAST, THE CHORD OF WHICH BEARS SOUTH 11°31'29" WEST, AND MEASURES 208.18 FEET; THENCE SOUTH 15°26'24" EAST, 37.28 FEET TO THE NORTHERLY RIGHT-OF-WAY LINE OF COUNTY STATE AID HIGHWAY 6, AND THE POINT OF BEGINNING OF THIS DESCRIPTION.

INCLUDING ALL THAT PART OF SOUTH 7TH STREET LYING SOUTHERLY AND ADJACENT TO THE ABOVE DESCRIBED PARCEL.

Parcel 08.0419.000:

LOT TWO (2) OF CRESCENT HEIGHTS FIRST ADDITION TO THE TOWNSHIP OF LA CRESCENT, HOUSTON COUNTY, MINNESOTA.

Parcel 08.0420.000:

LOT THREE (3) OF CRESCENT HEIGHTS FIRST ADDITION, TOWNSHIP OF LA CRESCENT, HOUSTON COUNTY, MINNESOTA.

Parcel 08.0554.000

A TRACT OF PARCEL OF LAND IN THE SOUTHEAST QUARTER OF SECTION 9, IN TOWNSHIP 104 NORTH OF RANGE 4 WEST OF THE FIFTH PRINCIPAL MERIDIAN DESCRIBED AS FOLLOWS:

COMMENCING AT THE NORTHEAST CORNER OF THE SOUTHEAST QUARTER OF THE SOUTHEAST QUARTER (SE¼ SE¼) OF SECTION 9, TOWNSHIP 104 NORTH, OF RANGE 4 WEST, THENCE WEST 1024.3 FEET, THENCE NORTH 8°30' EAST 14.8 FEET TO AN IRON STAKE, THENCE NORTHWESTERLY ALONG SOUTHERLY RIGHT OF WAY LINE OF PINE CREEK HIGHWAY 129.7 FEET TO AN IRON STAKE, THENCE NORTH 8°30' EAST 34.5 FEET TO CENTER LINE OF PINE CREEK HIGHWAY, WHICH IS THE PLACE OF BEGINNING, THENCE SOUTH 8°30' WEST 439.3 FEET TO AN IRON STAKE, THENCE NORTH 81°31' WEST 96 FEET TO AN IRON STAKE, THENCE NORTH 8°30' EAST TO CENTER LINE OF PINE CREEK HIGHWAY, THENCE SOUTHEASTERLY ALONG THE CENTER LINE OF PINE CREEK HIGHWAY 100.25 FEET TO THE PLACE OF BEGINNING, EXCEPT EASEMENT FOR HIGHWAY PURPOSES.

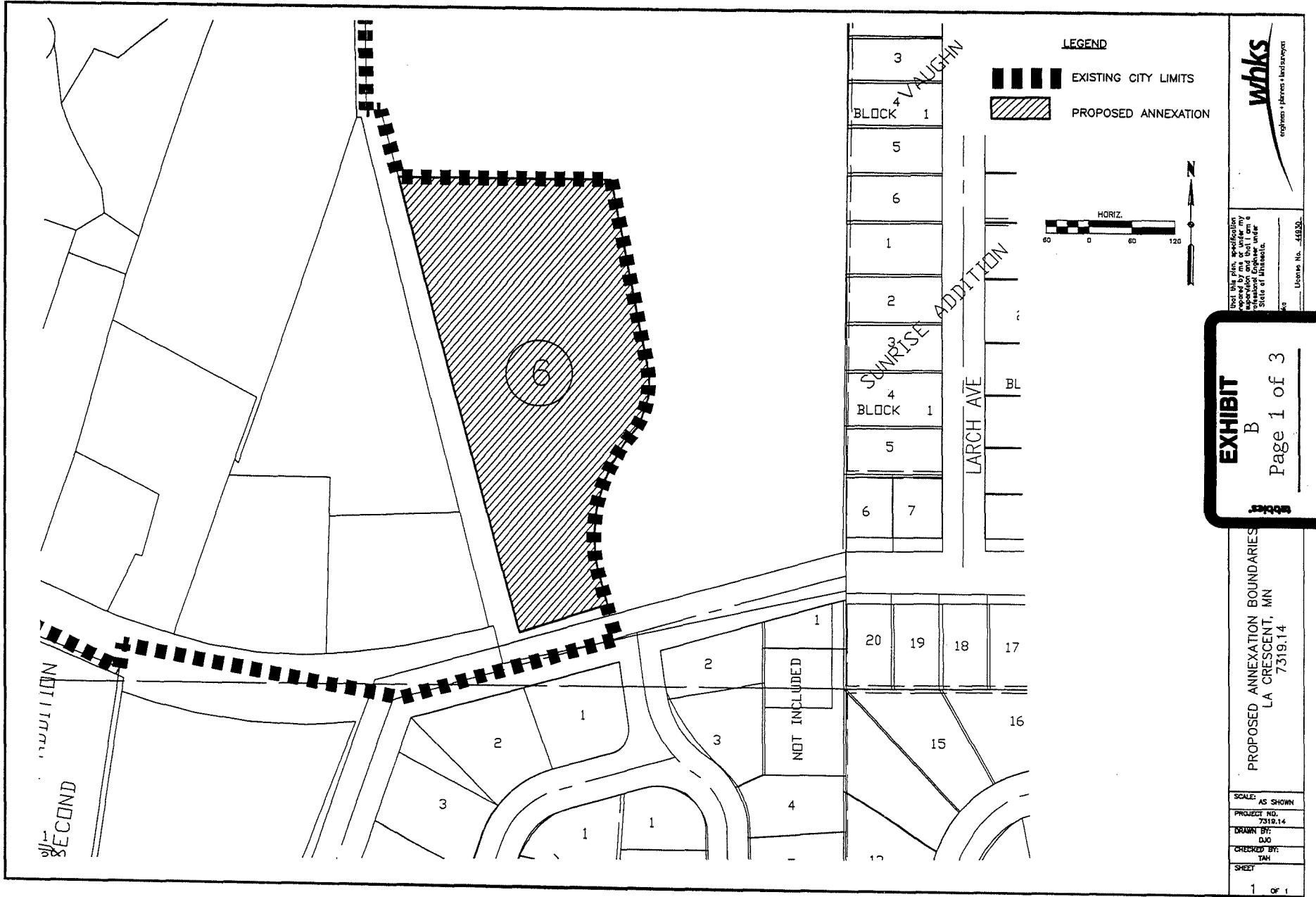

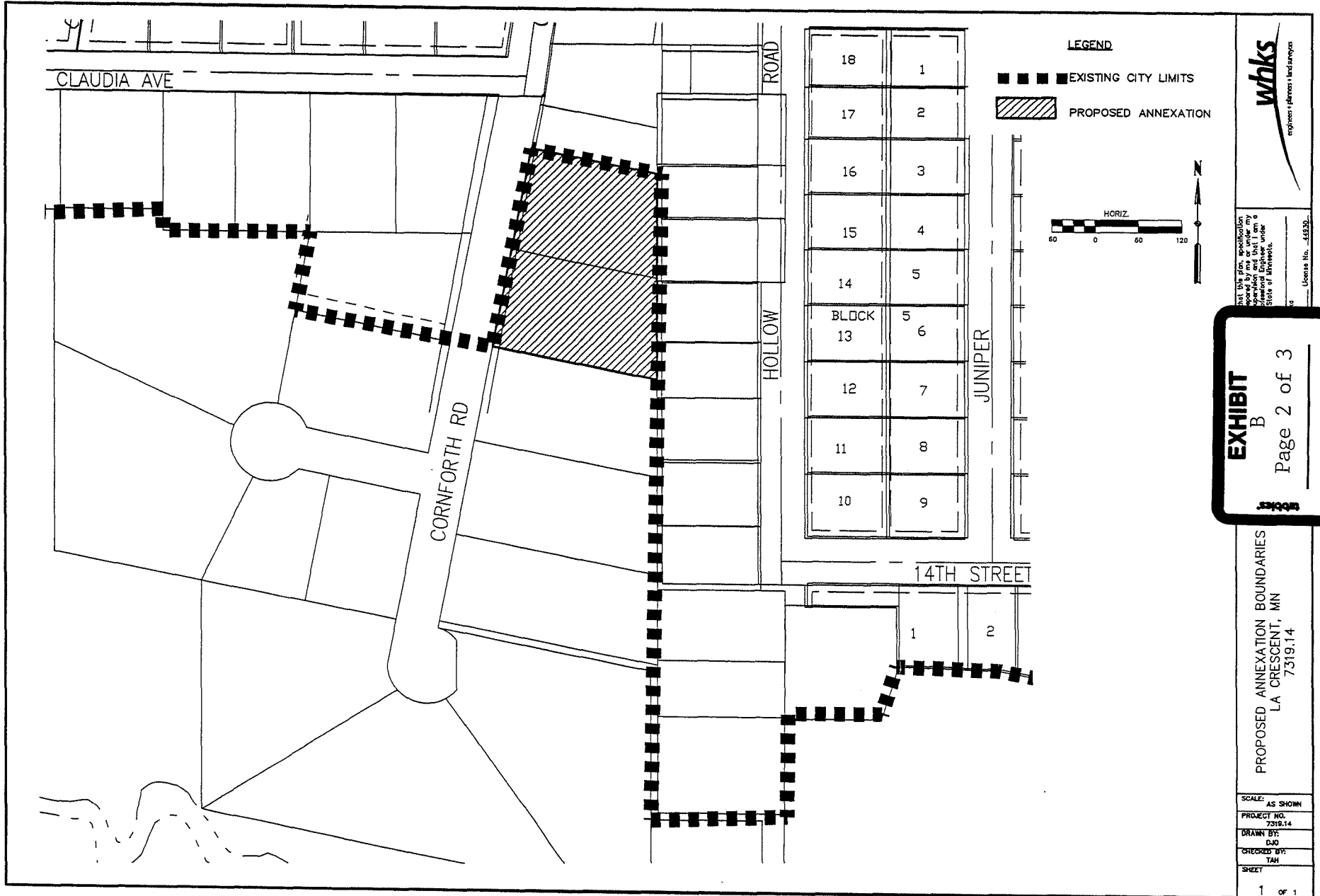

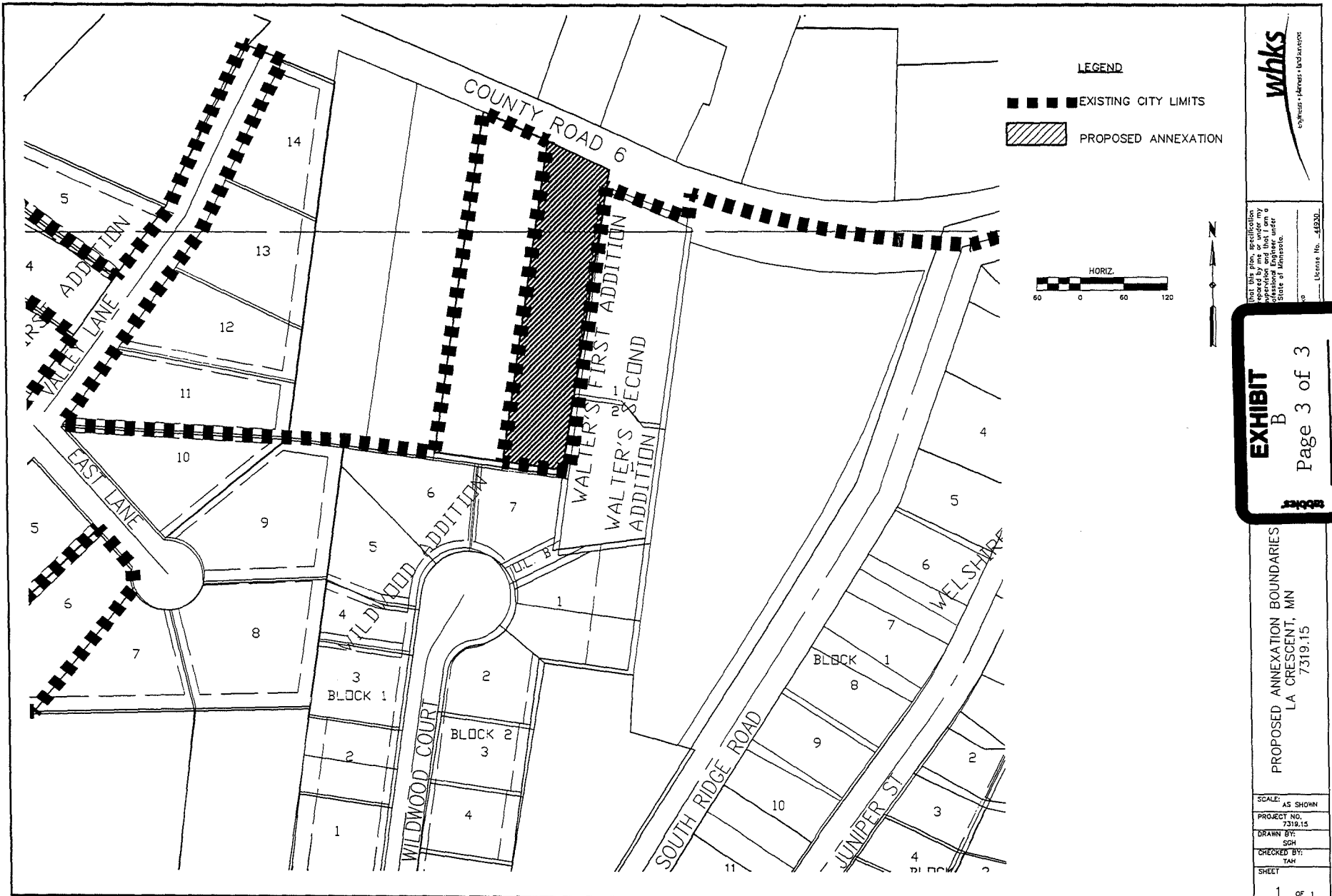

whks
engineers • planners • technicians

I hereby certify that this plan, specification, report or other document was prepared by me or under my direct supervision and that I am a duly Licensed Professional Engineer under the laws of the State of Minnesota.
 License No. 44830

EXHIBIT B
 Page 3 of 3

PROPOSED ANNEXATION BOUNDARIES
 LA CRESCENT, MN
 7319.15

SCALE: AS SHOWN
 PROJECT NO.: 7319.15
 DRAWN BY: SGH
 CHECKED BY: TAH
 SHEET