

**AN ORDINANCE OF THE CITY OF BUFFALO, MINNESOTA ANNEXING LAND
LOCATED IN BUFFALO TOWNSHIP, WRIGHT COUNTY, MINNESOTA PURSUANT
TO MINNESOTA STATUTES § 414.033 SUBDIVISION 2(1) PERMITTING
ANNEXATION BY ORDINANCE**

WHEREAS, The City of Buffalo is the fee owner of the following described parcel of real property:

PID 202-000-283303

That part of the Northwest Quarter of Section 17, Township 120, Range 25, Wright County, Minnesota, described as follows: Commencing at the Southwest corner of the Northwest Quarter of said Section 17; thence North 00 degrees 13 minutes 42 seconds East, assumed bearing, along the west line of said Section 17, a distance of 1719.60 feet to the south line of a tract recorded in Book 299 of Deeds page 7; thence South 82 degrees 34 minutes 57 seconds East, along the south line, a distance of 501.14 feet to the east line of the West 497.2 feet thereof, as measured along the North line of said Section 17; thence continue South 82 degrees 34 minutes 57 seconds East 491.12 feet to the point of beginning of the tract to be described; thence continue South 82 degrees 34 minutes 57 seconds East, along said south line, a distance of 558.22 feet to the Northwest right of way line of Minnesota State Highway 25, as occupied by the State of Minnesota in Final Certificate recorded in Book 254 of Deeds on pages 163 to 189; thence North 41 degrees 10 minutes 22 seconds East along said right of way, a distance of 327.57 feet; thence North 83 degrees 59 minutes 04 seconds West, a distance of 772.42 feet; thence South 00 degrees 13 minutes 42 seconds West, a distance of 255.45 feet to the actual point of beginning.

Contains 4.65 acres.

WHEREAS, said property is unincorporated and abuts the City of Buffalo on its northern boundary;

NOW, THEREFORE, THE CITY COUNCIL OF THE CITY OF BUFFALO HEREBY ORDAINS AS FOLLOWS:

1. The City Council hereby determines that the property as hereinafter described abuts the city limits and is owned in fee by the City of Buffalo.
2. None of the prop erty is now included within the limits of any city, or in any area that has already been designated for orderly annexation pursuant to Minnesota Statute § 414.0325.

3. The corporate limits of the City of Buffalo, Minnesota, are hereby extended to include the following described property:

That part of the Northwest Quarter of Section 17, Township 120, Range 25, Wright County, Minnesota, described as follows: Commencing at the Southwest corner of the Northwest Quarter of said Section 17; thence North 00 degrees 13 minutes 42 seconds East, assumed bearing, along the west line of said Section 17, a distance of 1719.60 feet to the south line of a tract recorded in Book 299 of Deeds page 7; thence South 82 degrees 34 minutes 57 seconds East, along the south line, a distance of 501.14 feet to the east line of the West 497.2 feet thereof, as measured along the North line of said Section 17; thence continue South 82 degrees 34 minutes 57 seconds East 491.12 feet to the point of beginning of the tract to be described; thence continue South 82 degrees 34 minutes 57 seconds East, along said south line, a distance of 558.22 feet to the Northwest right of way line of Minnesota State Highway 25, as occupied by the State of Minnesota in Final Certificate recorded in Book 254 of Deeds on pages 163 to 189; thence North 41 degrees 10 minutes 22 seconds East along said right of way, a distance of 327.57 feet; thence North 83 degrees 59 minutes 04 seconds West, a distance of 772.42 feet; thence South 00 degrees 13 minutes 42 seconds West, a distance of 255.45 feet to the actual point of beginning.

Contains 4.65 acres.

The above described property consists of a total of 4.65 acres, more or less. A copy of the corporate boundary map showing the property to be annexed and its relationship to the corporate boundaries is attached hereto.

4. That the population of the area legally described and hereby annexed is zero.
5. As there is no taxable property within the affected area, the provisions of Minnesota Statutes § 414.036 are not applicable.
6. That pursuant to Minnesota Statutes § 414.036 there are no special assessments or debt incurred by the Town on the subject are for which reimbursement is required.
7. That the City Administrator of the City of Buffalo is hereby authorized and directed to file a copy of this Ordinance with the Municipal Boundary Adjustment Unit of the Office of Administrative Hearings, the Minnesota Secretary of State, the Wright County Auditor, and the Buffalo Township Clerk.
8. That this Ordinance shall be in full force and effect and final upon the date this Ordinance is approved by the Office of Administrative Hearings.

PASSED AND ADOPTED by the City Council of the City of Buffalo, Minnesota, this 20th day of April, 2015.



Brad Nauman, Mayor

ATTEST:



City Administrator

(City Seal)

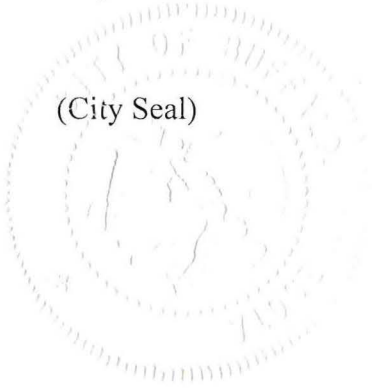

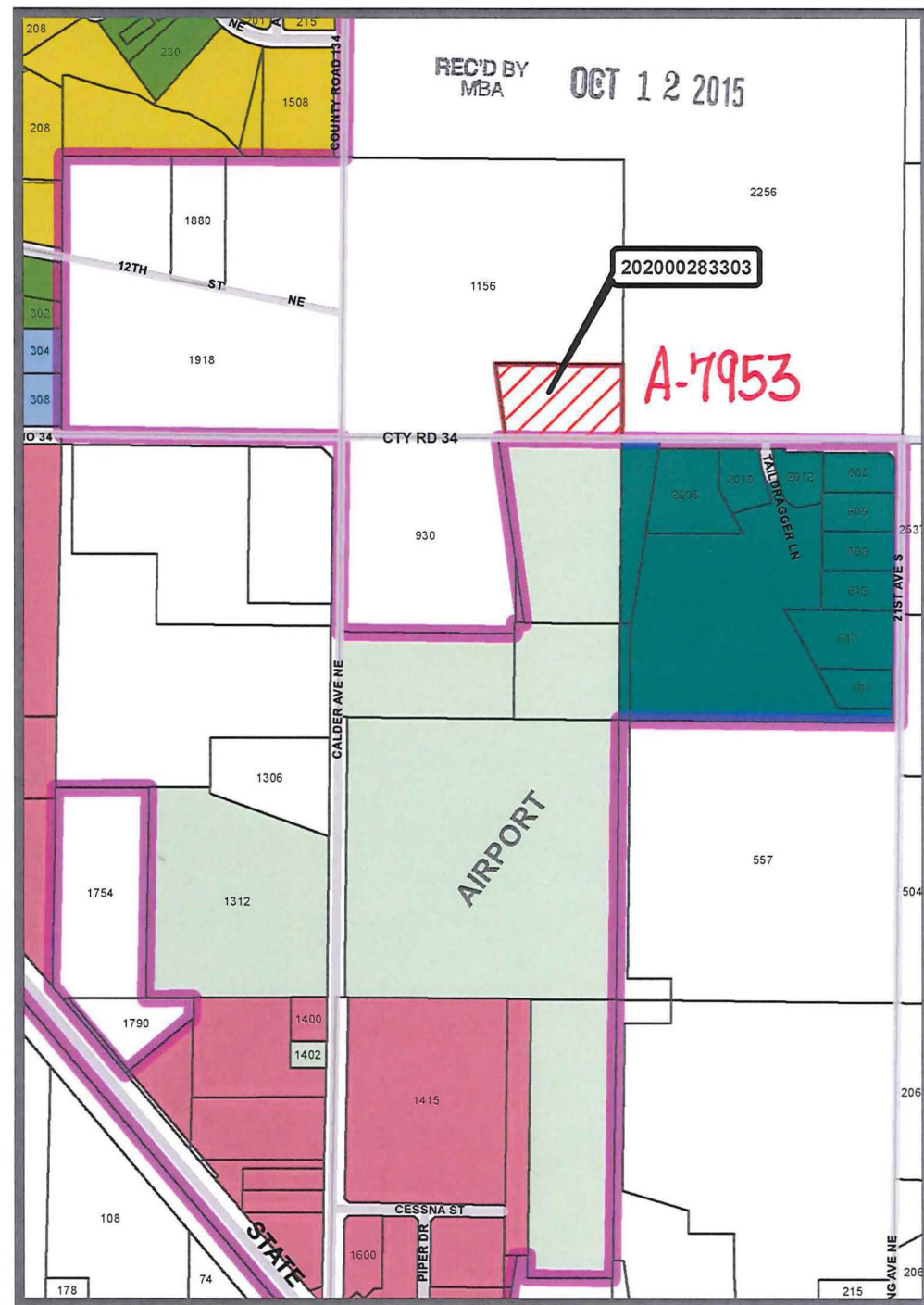
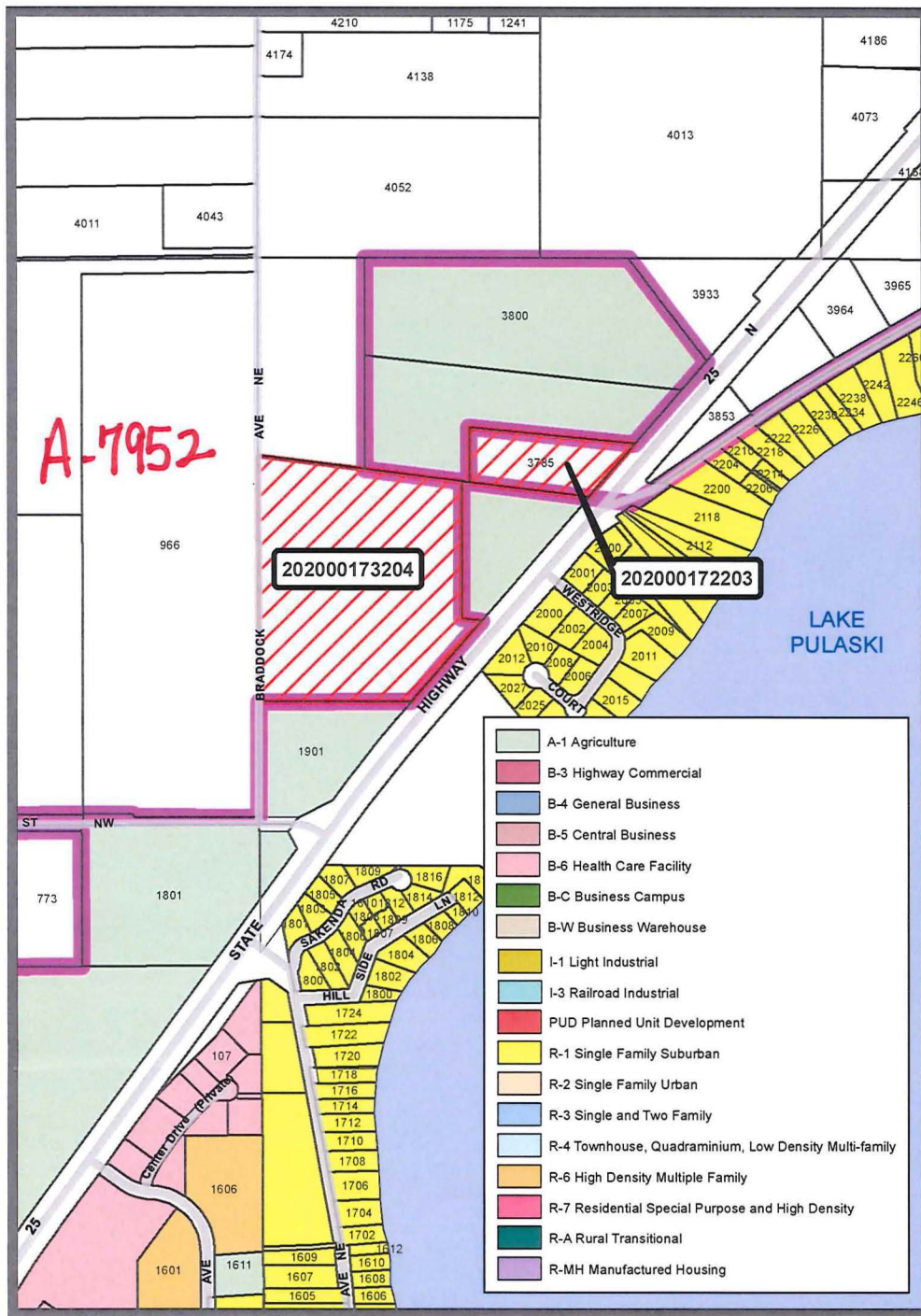

APRIL 2015
COB ANNEXATION



Subject Parcels **Buffalo Parcels**

City of Buffalo Corporate Limits

0 500 1,000 Feet

GIS data is data generated by a computer database or system that is designed to electronically capture, organize, store, update, manipulate, analyze, and display all forms of geographically referenced information that is compiled, from private or public sources, either alone or in cooperation with other public or private entities, for use by a municipality. GIS data is accurate for its intended use by a municipality and may be inaccurate for other uses.

Sheet No.
Annexation
April 15,
2015

RESOURCES:

Prepared By: CRAIG BOEVE

COORDINATE SYSTEM:
NAD 1983 HARN ADJ
MIN WRIGHT FEET
DATA SOURCE:
WRIGHT COUNTY, MN DNR

