

IN THE MATTER OF THE NOTICE OF INTENT  
FOR THE ANNEXATION OF CERTAIN LAND  
TO THE CITY OF PERHAM PURSUANT TO  
MINNESOTA STATUTES § 414.033, SUBD. 3

-----

TO: Perham Township Board; and

Office of Administrative Hearings  
Municipal Boundary Adjustments  
P. O. Box 64620  
St. Paul, MN 55164-0620  
651-361-7900

WHEREAS, the territory described below is not presently within the corporate limits of any incorporated city, and

WHEREAS, the area proposed for annexation is 40 acres or less in size, is 60% or more bordered by land already within the corporate limits of the City of Perham, and is not appropriate for annexation by ordinance pursuant to Minnesota Statutes § 414.033, Subd. 2(3); and

WHEREAS, the area proposed for annexation is described as follows:

Certain property owned by Donald B. Meyer and Donna J. Meyer located adjacent to the Perham Industrial Park and described as: All that part of the Southeast Quarter of Section 14, Township 136, Range 39, Otter Tail County, Minnesota, described as follows:

Beginning at the southeast corner of said Section 14, thence North 00 degrees, 39 minutes, 10 seconds West on an assumed bearing along the East line of said Section 14, a distance of 525 feet; thence North 89 degrees, 21 minutes, 02 seconds West a distance of 473.12 feet; thence South 00 degrees, 39 minutes, 10 seconds East a distance of 377.41 feet; thence South 50 degrees, 21 minutes, 46 seconds East a distance of 234.52 feet to the South line of said section 14, thence South 89 degrees, 21 minutes, 02 seconds East along said South line, a distance of 294.19 feet to the point of beginning, together with all hereditaments and appurtenances belonging thereto, subject to the following exceptions:

Easements, restrictions, and reservations of record, if any. Containing approximately 2.9 acres.

Certain property owned by Curtis P. Heikkinen located adjacent to the Perham Industrial Park described as: That part of the Southeast Quarter of the Southeast Quarter, Section 14, Township 136 North, Range 39 West, Otter Tail County, Minnesota described as follows:

Beginning at the southeast corner of said Southeast Quarter of the Southeast Quarter; thence North 00 degrees 39 minutes 10 seconds West, assumed bearing along the east line of said Southeast Quarter of the Southeast Quarter, a distance of 258.56 feet; thence North 89 degrees 21 minutes 02 seconds West 473.12 feet; thence South 00 degrees 39 minutes 10 seconds East 110.97 feet; thence South 50 degrees 21 minutes 46 seconds East 234.52 feet to the south line of said Southeast Quarter of the Southeast Quarter; thence South 89 degrees

21 minutes 02 seconds East 294.19 feet along the south line of said Southeast Quarter of the Southeast Quarter to the point of beginning. Containing approximately 2.5 acres.

Subject to easements, restrictions, or reservations of record, if any.

WHEREAS, the area proposed for annexation abuts upon the corporate limits of the City of Perham, Minnesota; and

WHEREAS, the area proposed for annexation is unincorporated, abuts on the city's East boundary, and is not included within any other municipality; and

WHEREAS, the area proposed for annexation is approximately 5.4 acres in size; and

WHEREAS, the reason for the proposed annexation is the property is 60 percent bordered by the City of Perham and 40 acres or less; and.

WHEREAS, the nature of the area proposed for annexation is Industrial in nature; and

WHEREAS, the area proposed for annexation is not included in any area that has already been designated for orderly annexation pursuant to Minnesota Statutes § 414.0325, nor in any other proceeding currently pending before the Office of Administrative Hearings - Municipal Boundary Adjustments.

  
\_\_\_\_\_  
Kelcey Klemm – City Manager

REC'D BY  
MBA

FEB 22 2011

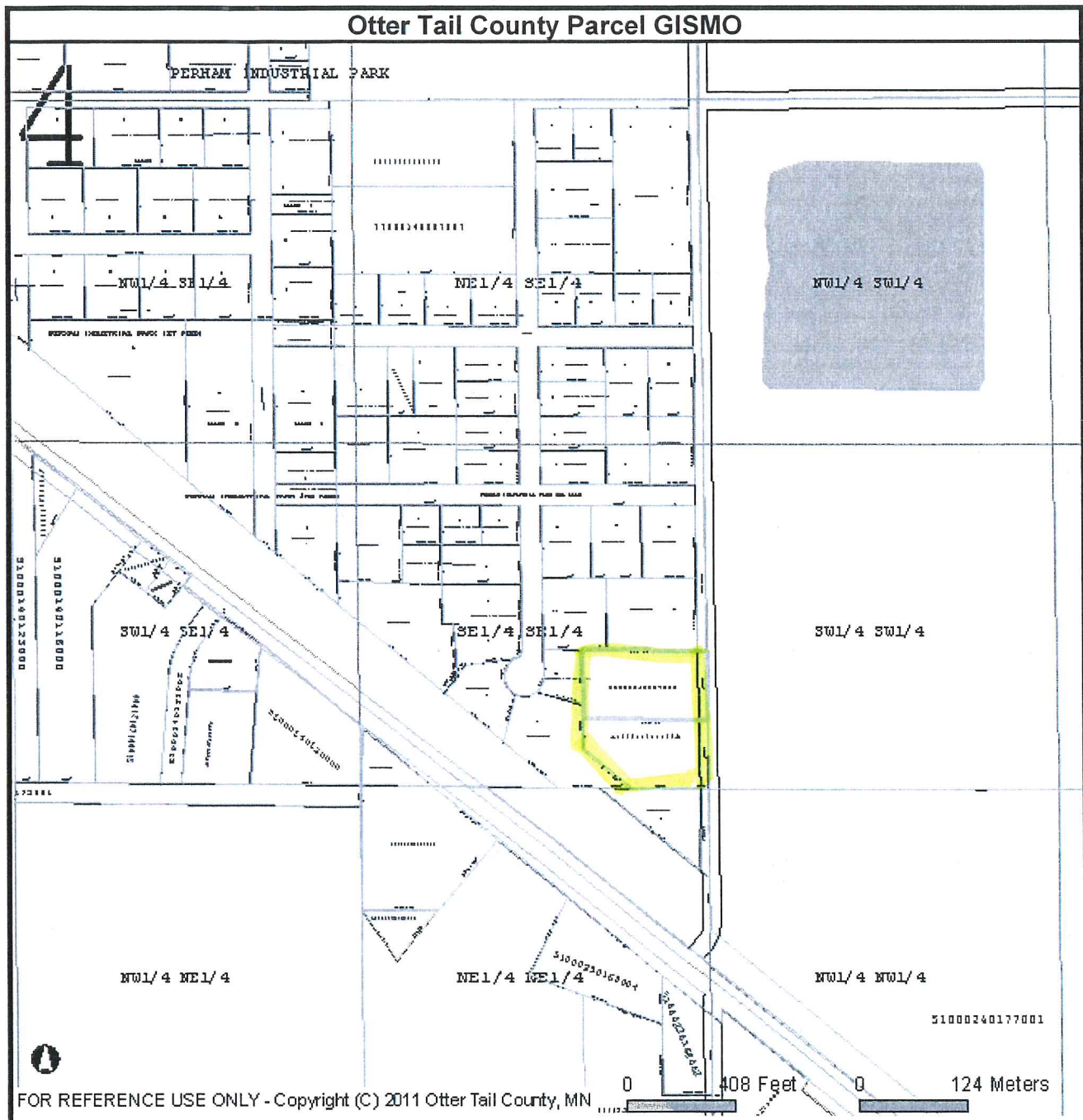

REC'D BY  
MBA

FEB 22 2011

