

A - 7754

**ORDINANCE NUMBER 320****ANNEXATION OF A PARCEL CURRENTLY OWNED BY ST. HENRY'S CHURCH  
INTO THE CITY OF PERHAM, COUNTY OF OTTER TAIL, STATE OF MINNESOTA  
AN ORDINANCE EXTENDING THE CORPORATE LIMITS OF THE CITY OF PERHAM  
TO INCLUDE CERTAIN UNINCORPORATED PROPERTIES ABUTTING THE CITY OF PERHAM**

WHEREAS, Minnesota State Statute 414.033 allows, under certain conditions, municipalities to annex by ordinance unincorporated property; and

WHEREAS, the properties described below is not presently within the corporate limits of any incorporated City, Village or Borough; and

WHEREAS, this territory is urban or about to become urban in character; and

WHEREAS, all adjoining property owners have been notified and a public hearing was held on February 14, 2011 according to Minnesota State Statute.

THE CITY COUNCIL OF PERHAM, MINNESOTA DOES HEREBY ORDAIN:

Section 1. Territory Annexed.

The corporate limits of the City of Perham, Minnesota are hereby extended to include the unplatted property described as follows:

**Certain property owned by St. Henry's Church described as:** That part of the Southwest Quarter of Section 10, Township 136 North, Range 39 West of the Fifth Principal Meridian in Otter Tail County, Minnesota and that part of the Southwest Quarter of the Southeast Quarter of said Section 10, all described as follows: Commencing at the southwest corner of said Section 10; thence on an assumed bearing of East along the south line of said Section 10 a distance of 1147.37 feet; thence North 40 degrees 17 minutes East 926.70 feet; thence North 49 degrees 42 minutes West 600.00 feet; thence North 40 degrees 17 minutes East 437.73 feet to the southwesterly right of way line of County State Aid Highway No. 80 (Old Trunk Highway Number 10), said point is the point of beginning; thence South 40 degrees 17 minutes West 437.73 feet; thence South 49 degrees 42 minutes East 600.00 feet; thence North 40 degrees 17 minutes East 145.20 feet; thence South 49 degrees 50 minutes 24 seconds East 89.19 feet; thence South 89 degrees 41 minutes 42 seconds East 319.56 feet; thence South 01 degrees 09 minutes 20 seconds West 760.56 feet, more or less, to the south line of said Section 10; thence easterly along the south line of said Section 10 to the northeasterly right of way line of the Burlington Northern and Santa Fe Railway Company's railroad; thence northwesterly along the northeasterly right of way line of said Burlington Northern and Santa Fe Railway Company's railroad to the north-south quarter line of said Section 10; thence northerly along the said north-south quarter line and along the northeasterly right of way line of said Burlington Northern and Santa Fe Railway Company's railroad; thence northwesterly continuing along said Burlington Northern and Santa Fe Railway Company's railroad to the intersection with a line which

bears North 40 degrees 17 minutes East from the point of beginning; thence South 40 degrees 17 minutes West 400.00 feet to the point of beginning; and That part of the East Half of the Southwest Quarter of said Section 10 described as follows: Commencing at the southwest corner of the Northwest Quarter of the Northwest Quarter of the Southeast Quarter of said Section 10; thence due West 400.00 feet; thence South 441.00 feet; thence southeasterly parallel with the northeasterly right of way line of the Burlington Northern and Santa Fe Railway Company's railroad a distance of 141.76 feet to the point of beginning; thence southwesterly deflecting to the right at an angle of 91 degrees 55 minutes 52 seconds for a distance of 153.21 feet to an iron monument on the northeasterly right of way line of said Burlington Northern and Santa Fe Railway Company's railroad; thence southeasterly along the northerly right of way line of said Burlington Northern and Santa Fe Railway Company's railroad 505 feet, more or less, to the north-south quarter line of said Section 10; thence northerly along said north-south quarter line to the intersection with a line which is parallel with the northeasterly right of way line of said Burlington Northern and Santa Fe Railway Company's railroad from the point of beginning; thence northwesterly parallel with the northeasterly right of way line of said Burlington Northern and Santa Fe Railway Company's railroad 380 feet, more or less, to the point of beginning.

Containing approximately 11.87 acres.

Section 2. Filing.

The City Manager is directed to file certified copies of this Ordinance with the Board of the Township in which the property is located, the Secretary of State, The County Auditor of the County in which the property is located, the Municipal Boundary Adjustment and any other parties as may be required pursuant to Minnesota Statutes 414.033, Subdivision 7.

Section 3. That with respect to the property taxes payable on the area legally described above, hereby annexed, the total Township taxes payable 2010 are at or near \$0.00. The City of Perham will make no payments to Perham Township

Section 4. Effective Date of Annexation.

This Ordinance is effective and final on the date of publication and filing pursuant to Minnesota Statutes 414.033, Subdivision 7.

Adopted this 13<sup>th</sup> day of June 2011 by the City Council of Perham, Minnesota.

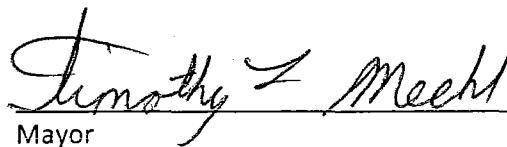
  
\_\_\_\_\_  
Mayor

ATTEST:

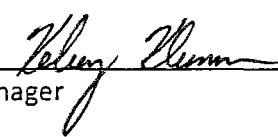
  
\_\_\_\_\_  
City Manager

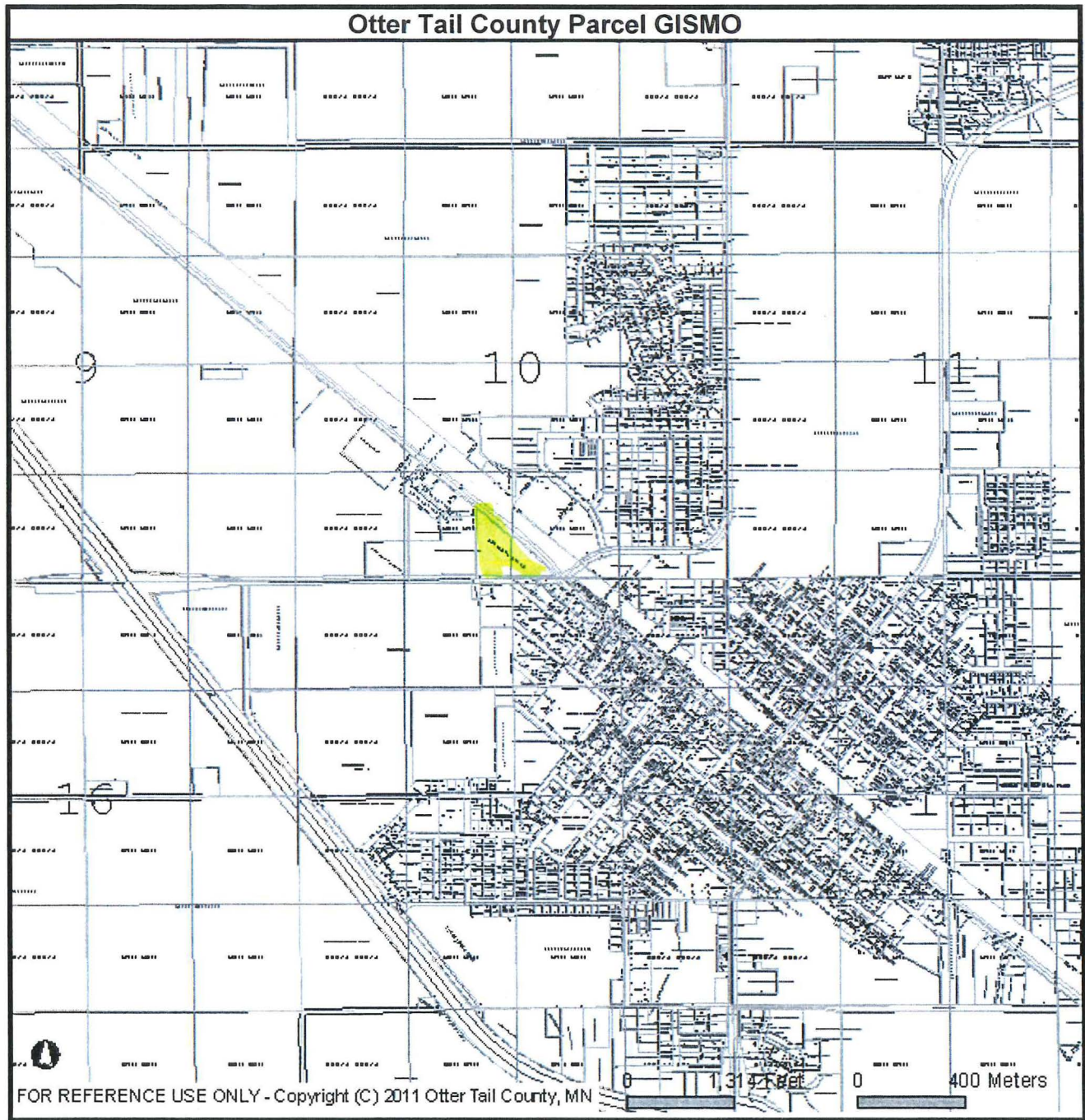



REC'D BY  
MBA

FEB 22 2011

### Otter Tail County Parcel GISMO

