

**THE NOTICE OF INTENT
FOR THE ANNEXATION OF CERTAIN LAND
TO THE CITY OF PERHAM PURSUANT TO
MINNESOTA STATUTES § 414.033, SUBD. 3**

TO: Perham Township Board; and

Office of Administrative Hearings
Municipal Boundary Adjustments
P. O. Box 64620
St. Paul, MN 55164-0620
651-361-7900

WHEREAS, the territory described below is not presently within the corporate limits of any incorporated city, and

WHEREAS, the area proposed for annexation is 40 acres or less in size, is 60% or more bordered by land already within the corporate limits of the City of Perham, and is not appropriate for annexation by ordinance pursuant to Minnesota Statutes § 414.033, Subd. 2(3); and

WHEREAS, the area proposed for annexation is described as follows:

Certain property owned by St. Henry's Church located on County Highway 34 described as: That part of the Southwest Quarter of Section 10, Township 136 North, Range 39 West of the Fifth Principal Meridian in Otter Tail County, Minnesota and that part of the Southwest Quarter of the Southeast Quarter of said Section 10, all described as follows:

Commencing at the southwest corner of said Section 10; thence on an assumed bearing of East along the south line of said Section 10 a distance of 1147.37 feet; thence North 40 degrees 17 minutes East 926.70 feet; thence North 49 degrees 42 minutes West 600.00 feet; thence North 40 degrees 17 minutes East 437.73 feet to the southwesterly right of way line of County State Aid Highway No. 80 (Old Trunk Highway Number 10), said point is the point of beginning; thence South 40 degrees 17 minutes West 437.73 feet; thence South 49 degrees 42 minutes East 600.00 feet; thence North 40 degrees 17 minutes East 145.20 feet; thence South 49 degrees 50 minutes 24 seconds East 89.19 feet; thence South 89 degrees 41 minutes 42 seconds East 319.56 feet; thence South 01 degrees 09 minutes 20 seconds West 760.56 feet, more or less, to the south line of said Section 10; thence easterly along the south line of said Section 10 to the northeasterly right of way line of the Burlington Northern and Santa Fe Railway Company's railroad; thence northwesterly along the northeasterly right of way line of said Burlington Northern and Santa Fe Railway Company's railroad to the north-south quarter line of said Section 10; thence northerly along the said north-south quarter line and along the northeasterly right of way line of said Burlington Northern and Santa Fe Railway Company's railroad; thence

northwesterly continuing along said Burlington Northern and Santa Fe Railway Company's railroad to the intersection with a line which bears North 40 degrees 17 minutes East from the point of beginning; thence South 40 degrees 17 minutes West 400.00 feet to the point of beginning;

AND

That part of the East Half of the Southwest Quarter of said Section 10 described as follows:

Commencing at the southwest corner of the Northwest Quarter of the Northwest Quarter of the Southeast Quarter of said Section 10; thence due West 400.00 feet; thence South 441.00 feet; thence southeasterly parallel with the northeasterly right of way line of the Burlington Northern and Santa Fe Railway Company's railroad a distance of 141.76 feet to the point of beginning; thence southwesterly deflecting to the right at an angle of 91 degrees 55 minutes 52 seconds for a distance of 153.21 feet to an iron monument on the northeasterly right of way line of said Burlington Northern and Santa Fe Railway Company's railroad; thence southeasterly along the northerly right of way line of said Burlington Northern and Santa Fe Railway Company's railroad 505 feet, more or less, to the north-south quarter line of said Section 10; thence northerly along said north-south quarter line to the intersection with a line which is parallel with the northeasterly right of way line of said Burlington Northern and Santa Fe Railway Company's railroad from the point of beginning; thence northwesterly parallel with the northeasterly right of way line of said Burlington Northern and Santa Fe Railway Company's railroad 380 feet, more or less, to the point of beginning.

Containing approximately 11.87 acres.

WHEREAS, the area proposed for annexation abuts upon the corporate limits of the City of Perham, Minnesota; and

WHEREAS, the area proposed for annexation is unincorporated, abuts on the city's **West** boundary, and is not included within any other municipality; and

WHEREAS, the area proposed for annexation is approximately 11.87 acres in size; and

WHEREAS, the reason for the proposed annexation is 60 percent bordered by the City of Perham and 40 acres or less; and.

WHEREAS, the nature of the area proposed for annexation is residential; and

WHEREAS, the area proposed for annexation is not included in any area that has already been designated for orderly annexation pursuant to Minnesota Statutes § 414.0325, nor in any other proceeding currently pending before the Office of Administrative Hearings - Municipal Boundary Adjustments.

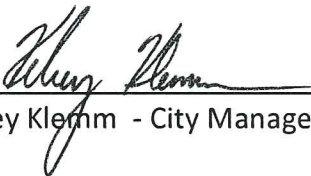

Kelcey Klemm - City Manager

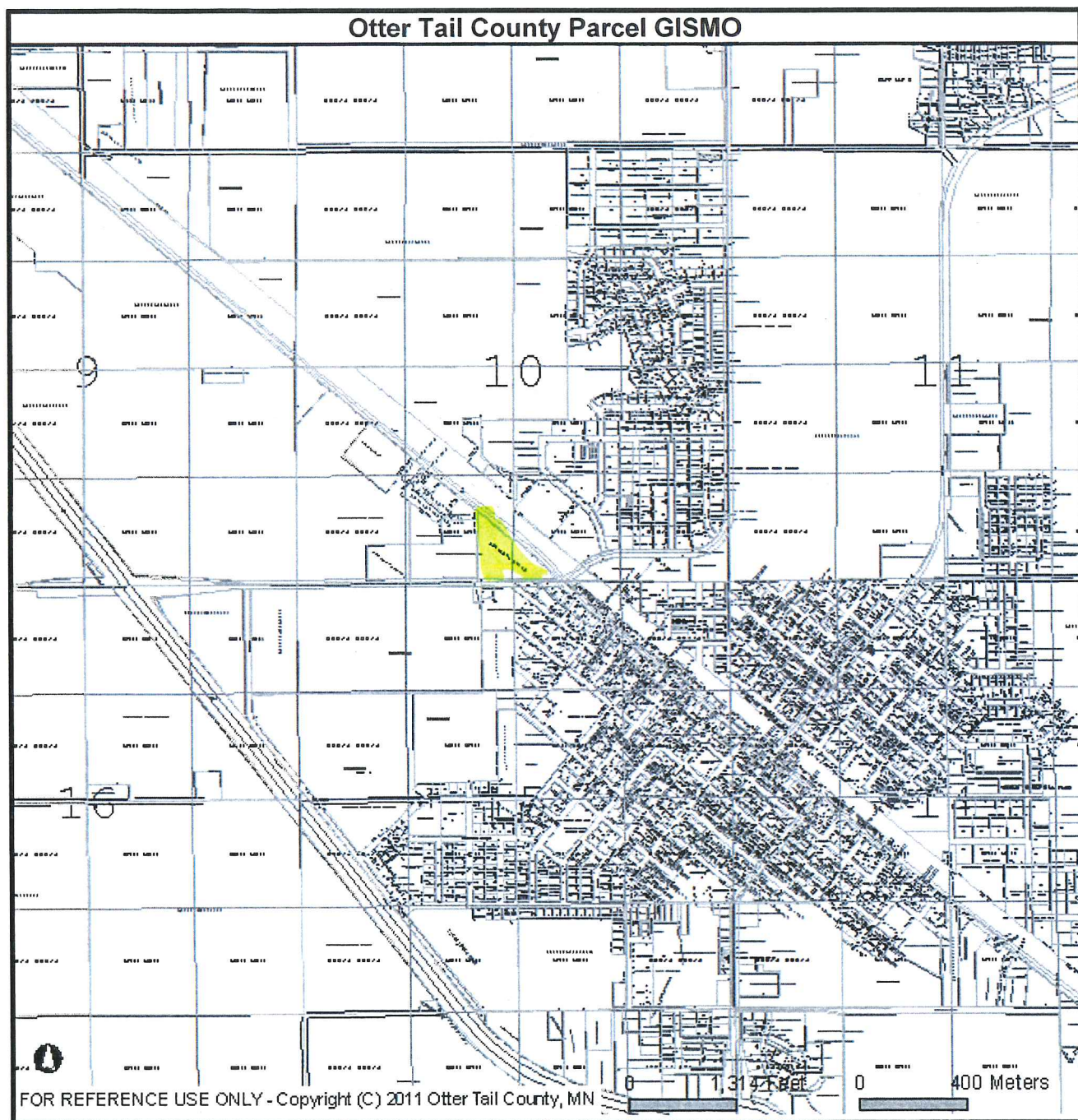

REC'D BY
MBA

FEB 22 2011

