

**AN ORDINANCE OF THE CITY OF LA CRESCENT ANNEXING LAND LOCATED IN LA CRESCENT TOWNSHIP, HOUSTON COUNTY, MINNESOTA TO THE CITY OF LA CRESCENT, HOUSTON COUNTY, MINNESOTA, PURSUANT TO MINN. STAT. § 414.033, SUBD. 2(3), PERMITTING ANNEXATION BY ORDINANCE**

(Sect-09 Twp-104 Range-004 CRESCENT VALLEY FIRST ADDITION Lot-007 Block-002)

The City Council of the City of La Crescent, Houston County, Minnesota, hereby ordains:

SECTION I. That the unincorporated land legally described in Exhibit A (the "subject area"), which is attached hereto and incorporated herein by reference, located in La Crescent Township, Houston County, Minnesota, is land that is contiguous to and abuts the municipal corporate limits of the City of La Crescent, Houston County, Minnesota; is land that is 120 acres or less in size; is land that is not presently served by public wastewater facilities, and for which public wastewater facilities are not otherwise available than through the City of La Crescent; and is land that is existing or proposed for immediate urban or suburban development.

SECTION II. That the owner of the subject area has requested annexation for purposes of immediately connecting the existing urban or suburban residential property to the City of La Crescent's public utility system(s) and has submitted a petition to the City Council of the City of La Crescent for annexation of said land.

SECTION III. That the City of La Crescent held a public hearing pursuant to Minn. Stat. § 414.033, subd. 2b, on December 13, 2010, allowing thirty (30) days written notice by certified mail to La Crescent Township and to all landowners within and contiguous to the subject area.

SECTION IV. That the corporate limits of the City of La Crescent are hereby extended to include the subject area, which is shown on the map attached hereto and incorporated herein by reference as Exhibit B, and which contains less than one (1) acre, and the same is hereby annexed to be included within the City of La Crescent, Houston County, Minnesota.

SECTION V. That the population of the subject area that is hereby annexed is five (5).

SECTION VI. That with respect to the property taxes payable on the subject area that is hereby annexed, the total Township taxes payable 2009 were \$2,174.00. The City of La Crescent recommends that it be ordered to make a cash payment to La Crescent Township for the period and in accordance with the following schedule:

- a. In the first year in which the City of La Crescent may levy property taxes on the subject area following the annexation thereof, an amount equal to one hundred percent (100%) of the property taxes distributed to La Crescent Township in regard to the subject area in the last year the property taxes from the subject area were payable to the Township (e.g. if 2011 is the first year that the City of La Crescent may levy on the subject area, in 2010 the City would pay La Crescent Township 100% of the property taxes from the subject area distributed to the Township in 2010);
- b. In each of the second and third years, an amount equal to the first year payment described in SECTION VI (a) above.

DEC 23 2010

SECTION VII. That there are no special assessments assigned by the Township to the subject area and there is no debt incurred by the Township prior to the annexation and attributable to the subject area for which reimbursement is required.

SECTION VIII. That, pursuant to Minn. Stat. § 462.355, subd. 4, upon the effective date of the annexation of the subject area as established in Section X below, the interim zoning for the entirety of the subject area shall be "R-1D, Annexation Low Density Residential District" as defined in the City's Zoning Code. This interim zoning shall remain in effect for such time period not to exceed one year or as is otherwise permitted by law until the City shall enact permanent zoning regulations for the subject area as provided for in the City's Zoning Code.

SECTION IX. That the City Administrator of the City of La Crescent is hereby authorized and directed to file a copy of this Ordinance with the Minnesota Office of Administrative Hearings Municipal Boundary Adjustments Office, the Minnesota Secretary of State, the Houston County Auditor, and the La Crescent Township Clerk.

SECTION X. That this Ordinance shall be in full force and effect and final upon the date this Ordinance is approved by the Minnesota Office of Administrative Hearings.

ADOPTED 13<sup>th</sup> day of December 2010.

SIGNED:



Mayor

ATTEST:

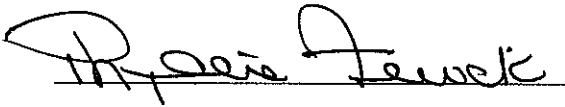

Deputy Clerk

EXHIBIT "A"  
LOT 7, BLOCK 2,  
CRESCENT VALLEY FIRST ADDITION

REC'D BY  
MBA

DEC 23 2010

# LOCATION MAP CRESCENT VALLEY SUBDIVISIONS AND ADJACENT AREAS

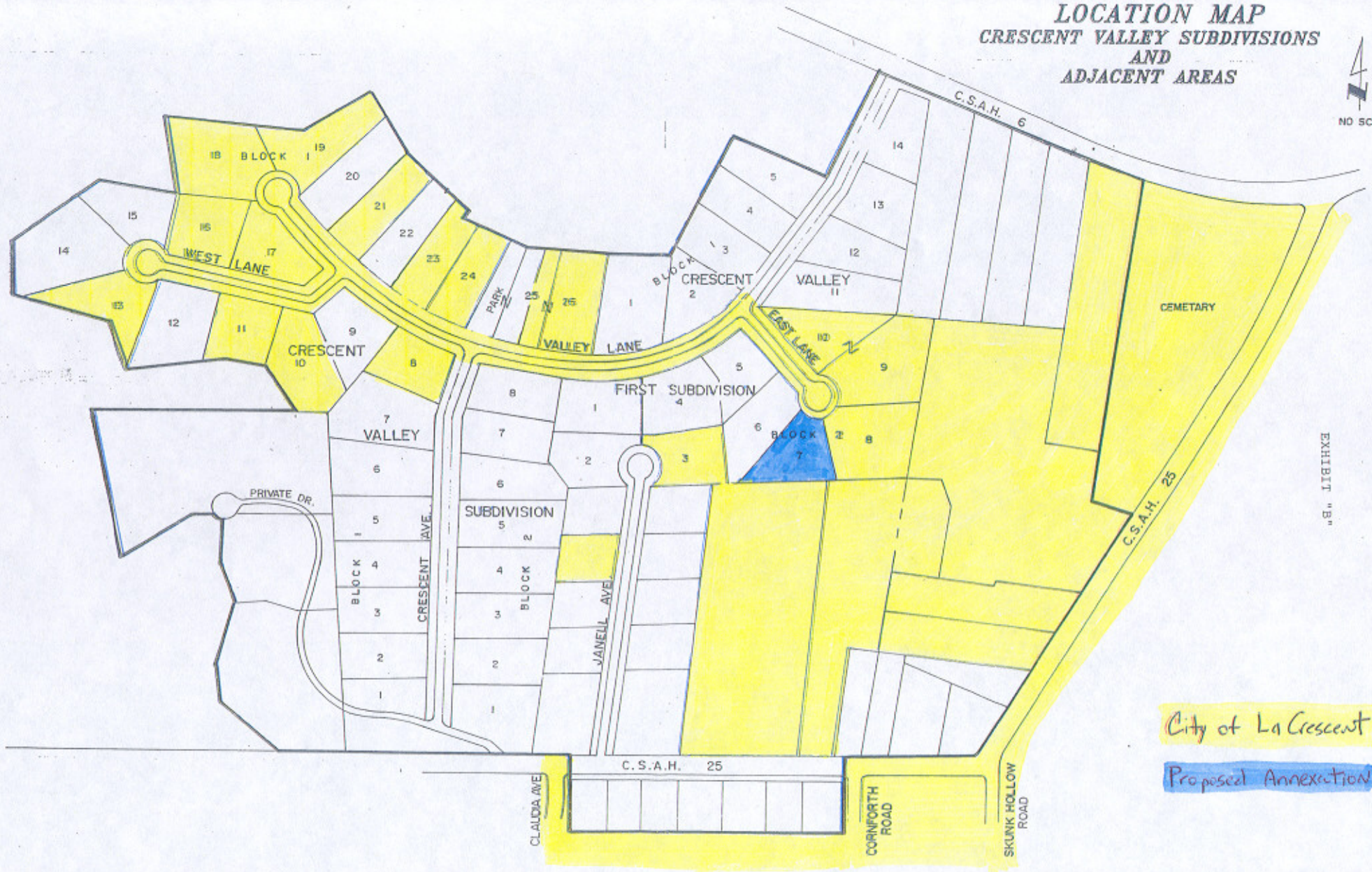

City of La Crescent

Proposed Annexation

REC'D BY  
MBA

DEC 23 2010