

ORDINANCE NUMBER 297

**ANNEXATION OF PARCEL NUMBER 51000220166004, NEW CREATIONS LUTHERAN CHURCH
CITY OF PERHAM, COUNTY OF OTTER TAIL, STATE OF MINNESOTA
AN ORDINANCE EXTENDING THE CORPORATE LIMITS OF THE CITY OF PERHAM
TO INCLUDE CERTAIN UNINCORPORATED PROPERTY ABUTTING THE LIMITS OF THE CITY**

WHEREAS, a petition has been received from New Creations Lutheran Church; and

WHEREAS, the territory described below is not presently within the corporate limits of any incorporated City, Village or Borough; and

WHEREAS, the territory to be annexed is 4.85 acres more or less; and

WHEREAS, this territory is urban or about to become urban in character; and

WHEREAS, all adjoining property owners have been notified and a public hearing has been held according to Minnesota State Statute.

THE CITY COUNCIL OF PERHAM, MINNESOTA DOES HEREBY ORDAIN:

Section 1. Territory Annexed.

The corporate limits of the City of Perham, Minnesota are hereby extended to include the unplatted property described as follows:

Parcel Number 51000220166004

That part of the Northwest Quarter of the Northeast Quarter, Section 22, Township 136 North, Range 39 West, Otter Tail County, Minnesota described as follows:

Commencing at the northeast corner of said Northeast Quarter; thence South 89 degrees 52 minutes 30 seconds West, assumed bearing along the north line of said Northeast Quarter, a distance of 1484.71 feet to the point of beginning of the tract to be described; thence South 00 degrees 07 minutes 30 seconds West 1027.19 feet to the north line of MINNESOTA HIGHWAY RIGHT OF WAY PLAT NO. 56-5; thence North 74 degrees 09 minutes 52 seconds West 358.52 feet along the north line of said MINNESOTA HIGHWAY RIGHT OF WAY PLAT NO. 56-5; thence westerly 16.39 feet along the north line of said MINNESOTA HIGHWAY RIGHT OF WAY PLAT NO. 56-5 and along a tangential curve concave to the north having a central angle of 00 degrees 21 minutes 04 seconds, a radius of 2674.79 feet and a chord bearing of North 73 degrees 59 minutes 20 seconds West to a point hereinafter designated a Point "A"; thence North 00 degrees 01 minute 30 seconds East 435.04 feet; thence North 89 degrees 52 minutes 30 seconds East 319.27 feet; thence North 00 degrees 07 minutes 30 seconds East 489.01 feet to the north line of said Northeast Quarter; thence North 89 degrees 52 minutes 30 seconds East 40.00 feet to the point of beginning.

Containing 4.47 acres.

TOGETHER WITH:

That part of the Northwest Quarter of the Northeast Quarter, Section 22, Township 136 North, Range 39 West, Otter Tail County, Minnesota described as follows:

Commencing at the point hereinbefore designated as Point "A"; thence South 00 degrees 01 minute 30 seconds West 301.46 feet to the south line of MINNESOTA HIGHWAY RIGHT OF WAY PLAT NO.56-5, the point of beginning of the tract to be described; thence South 74 degrees 09 minutes 52 seconds West 227.14 feet along the south line of said MINNESOTA HIGHWAY RIGHT OF WAY PLAT NO. 56-5; thence South 68 degrees 39 minutes 31 seconds East 101.02 feet along the south line of said MINNESOTA HIGHWAY RIGHT OF WAY PLAT NO. 56-5 to the south line of the Northwest Quarter of the Northeast Quarter; thence South 89 degrees 52 minutes 48 seconds West 312.65 feet along the south line of said Northwest Quarter of the Northeast Quarter; thence North 00 degrees 01 minute 30 seconds East 99.40 feet to the point of beginning.

Containing 0.38 acres

Section 2. Filing.

The City Manager is directed to file certified copies of this Ordinance with the Board of the Township in which the property is located, the Secretary of State, The County Auditor of the County in which the property is located, the Municipal Boundary Adjustment and any other parties as may be required pursuant to Minnesota Statutes 414.033, Subdivision 2; subpart 3.

Section 3. That with respect to the property taxes payable on the area legally described above, hereby annexed, the total Township taxes payable 2010 are at or near \$65.53. The City of Perham recommends that it be ordered to make a cash payment to Perham Township for the period and in accordance with the following schedule:

- a. The City of Perham will pay to Perham Township two payments, one on July 1, 2010 in the amount of \$196.60 and one payment January 1, 2011 in the amount of \$196.60 representing three (3) years of Perham Township property tax reimbursement for these 4.85 acres.

Section 4. Effective Date of Annexation.

This Ordinance is effective and final on the date of publication and filing pursuant to Minnesota Statutes 414.033, Subdivision 7.

Adopted this 10th day of May 2010 by the City Council of Perham, Minnesota.

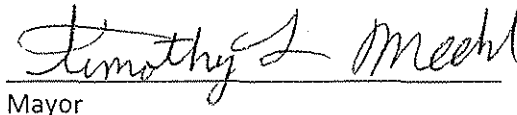
Mayor

ATTEST:

City Manager

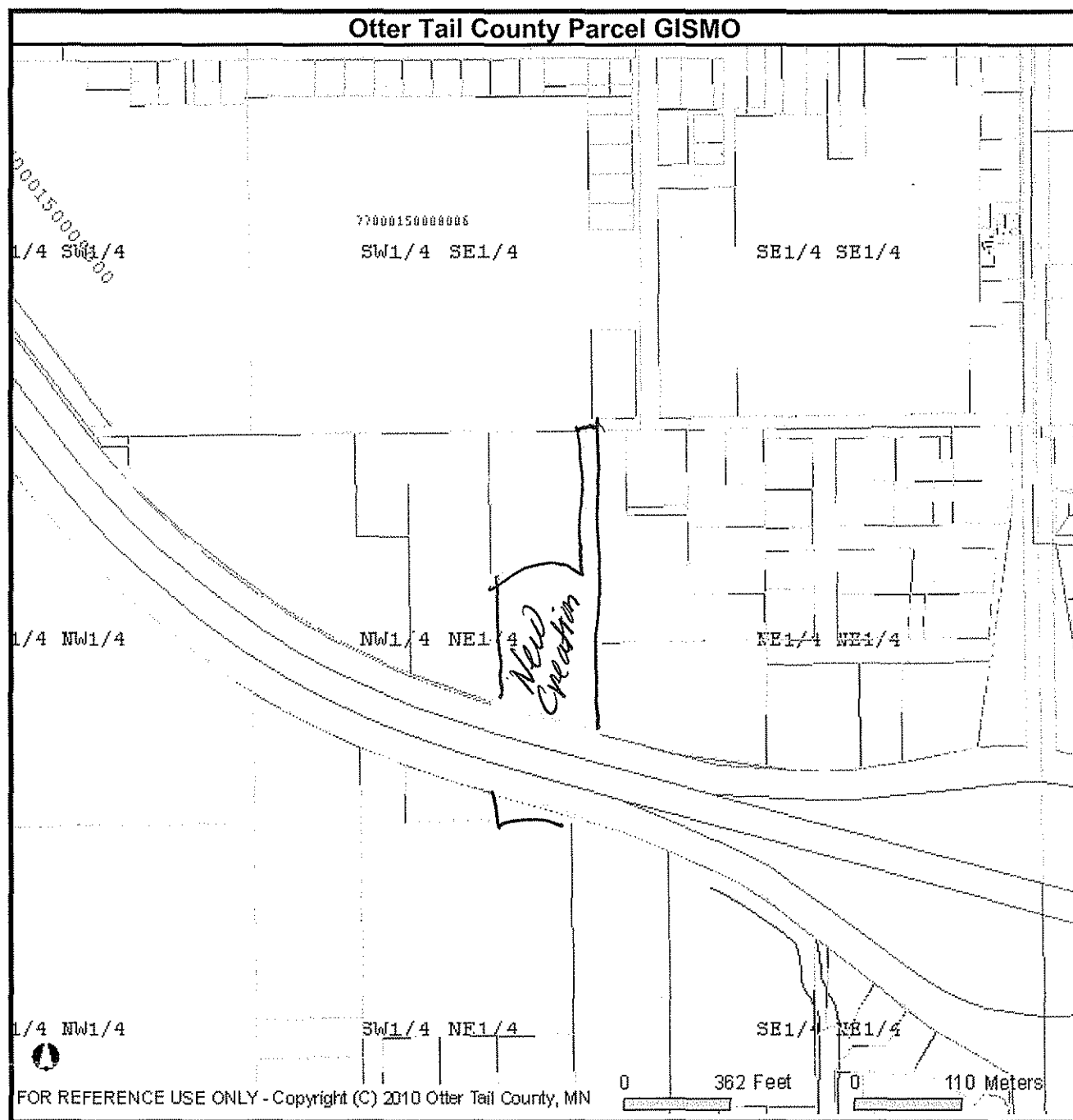

REC'D BY
MBA
MAY 20 2010

City of Perham

