

**TITLE XVII
CHAPTER 198**

**ORDINANCE NO. 130
CITY OF ISLE, MINNESOTA**

**AN ORDINANCE OF THE CITY OF ISLE, MINNESOTA ANNEXING LAND
LOCATED IN THE TOWN ISLE HARBOR, MILLE LACS COUNTY,
MINNESOTA PURSUANT TO MINNESOTA STATUTES 414.033,
SUBDIVISION 2 (1)**

WHEREAS, the territory described below is not presently located within the corporate limits of any incorporated city and abuts the corporate limits of the City of Isle, Minnesota; and

WHEREAS, the City of Isle owns all property in the territory described below; and

WHEREAS, the parcels to annexed are not currently served by public sewer facilities; and

WHEREAS, a public hearing is not required if property proposed for annexation is owned solely by the City of Isle.

NOW, THEREFORE, THE CITY COUNCIL OF THE CITY OF ISLE, MILLE LACS COUNTY, MINNESOTA DOES HEREBY ORDAIN:

Section 1. Territory annexed. Pursuant to Minnesota Statutes 414.033, the corporate limits of the City of Isle are hereby extended by annexation of the unplatted property described as follows:

Section 14, Township 42, Range 25 – NE ¼ except S ½ of SW of NE and N ¾ of E ½ of NW.

Section 2. Filing. The City Clerk is directed to file certified copies of this ordinance with the Secretary of State, the County Auditor of Mille Lacs County, the Town Clerk of Isle Harbor Township and Minnesota Planning Municipal Boundary Adjustments.

Section 3. Effective date of annexation. This ordinance takes effect upon its passage, publication and the filing of certified copies as directed in Section 2, and its approval by the Minnesota Municipal Board, now known as Minnesota Planning Municipal Boundary Adjustments.

Section 4. Official Map. The City Engineer is directed to change the Official Zoning Map to reflect the new border of the City resulting from annexation of the property and to depict its zoning classification as residential.

Adopted by the City of Isle, Mille Lacs County, Minnesota this 12th day of August, 2008.

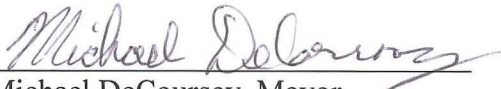
Michael DeCoursey, Mayor

ATTEST:

LuAnn Sawatzky, Clerk-Treasurer

See Page 13

REC'D BY 4541 SEP 26 2008

© 2001 Cloud Cartographics, Inc.

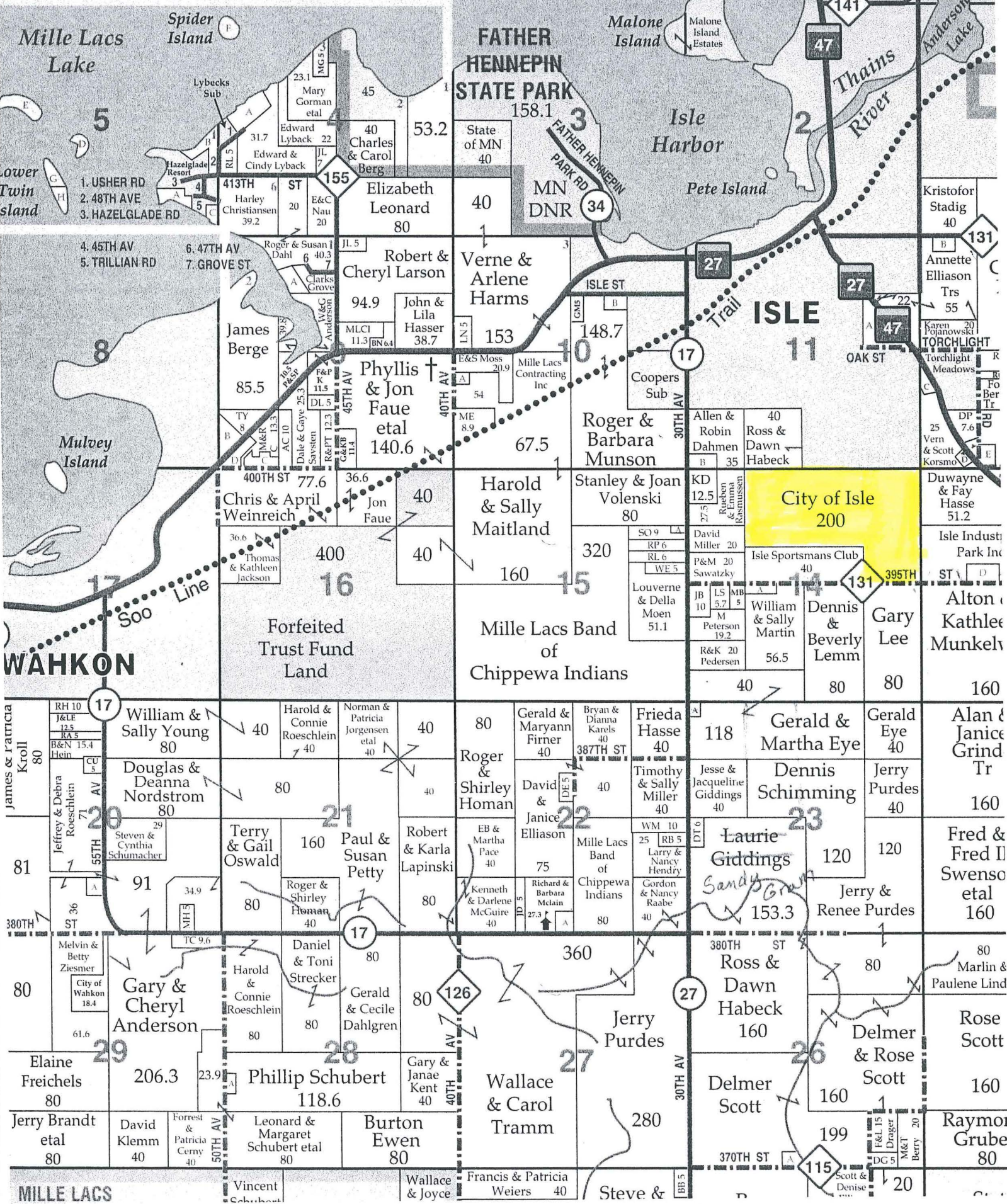

REC'D BY
M.M.B. JAN 02 2009



December 30, 2008

Office of Administrative Hearings
Municipal Boundary Adjustments
PO Box 64620
St. Paul, MN 55164-06920

RE: Annexation by Ordinance
City of Isle, Mille Lacs County, Minnesota
Ordinance No. 130

Dear Reviewer:

This is to certify that there are no taxable properties in annexation of 200 acres by Ordinance. Identified above. If you have any questions, or need further information, feel free to contact me at your convenience.

Yours truly,
CITY OF ISLE

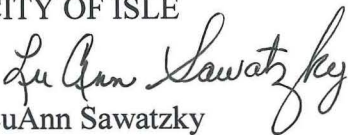
LuAnn Sawatzky
Clerk-Treasurer