

REC'D BY  
MME  
SEP 25 2007

RESOLUTION NO. 2007-921

**A RESOLUTION OF THE CITY COUNCIL OF THE CITY OF MORA, MINNESOTA  
STATING THE INTENT OF THE CITY OF MORA TO ANNEX CERTAIN PROPERTY  
UNDER MINNESOTA STATUTES SECTION 414.033, SUBDIVISION 3**

**WHEREAS**, the City of Mora, in discussion and consultation with the residents of the area described below and officials of Arthur Township, has determined that it is in the best interest of said property owners to be annexed to the City of Mora; and

**WHEREAS**, the area considered for annexation is described as follows:

*South of the centerline of Highway 23, north of the centerline of Howe Avenue, east of the centerline of Oslin Road and west of the Housing & Redevelopment Authority of Mora's development known as Eastwood, including all roadways within the described area.*

**WHEREAS**, said property is urban in character; and

**WHEREAS**, the City of Mora surrounds said property on three sides comprising approximately 78% of its perimeter and said property is approximately 15.25± acres in area; and

**WHEREAS**, the City of Mora, through its public utilities commission, will be providing water and sanitary sewer service to property owners in the area described above in the immediate future.

**NOW, THEREFORE, BE IT RESOLVED** by the City Council of the City of Mora, Kanabec County, Minnesota, that the City Council hereby states its intention and directs its staff to notify the Arthur Town Board, the Office of Municipal Boundary Adjustments, and the property owners of said property of its intention to annex the aforementioned property pursuant to Minnesota Statutes 414.033, Subd. 3.

The foregoing resolution was introduced and moved for adoption by Council Member Gravich and seconded by Council Member Johnson.

Voting for the Resolution: Ardner, Chmiel, Gravich, Hallin + Johnson  
Voting Against the Resolution: none  
Abstained from Voting: none  
Absent: none

Motion carried and resolution adopted this 18<sup>th</sup> day of September 2007.

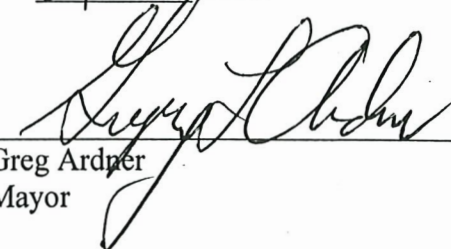
  
\_\_\_\_\_  
Greg Ardner  
Mayor

ATTEST:   
\_\_\_\_\_  
Mason Hjelle  
City Clerk

REC'D BY  
MMB  
SEP 25 2007

**CITY OF MORA  
OSLIN-MATTSON ANNEXATION  
Estimated Tax Payments to Town (shown with taxes payable 2007)**

Township portion of 2007 taxes:

02.00870.00	Harold Oslin	210 Oslin Rd. (includes vacant lot at 225 Oslin Rd.)	\$188.49
02.00885.00	Art Beckman	220 Oslin Rd.	\$156.45
02.00890.00	Dorothy Kendall	230 Oslin Rd.	\$123.79
02.00880.00	Michael Moen	260 Oslin Rd.	\$123.02
02.00875.00	Marilyn Ketter	2150 Howe Ave.	\$129.22
02.03565.00	Don Kaddatz	2156 Howe Ave.	\$142.83
02.03570.00	Hannah Casey	200 Mattson Rd.	\$152.12
02.03545.00	Jeff Akkerman	201 Mattson Rd.	\$165.16
02.03575.00	Gary Johnson	210 Mattson Rd.	\$126.27
02.03550.00	Lori Christian	211 Mattson Rd.	\$209.38
02.03550.10	Lori Christian		\$154.48
02.03585.00	Gary Oslin	230 Mattson Rd.	\$271.81
02.03590.00	Kevin Mork	250 Mattson Rd.	\$153.98
02.03560.00	Joel Tvedt	251 Mattson Rd.	\$121.48
02.03595.00	Lisa Reinke	260 Mattson Rd.	\$161.55
02.03600.00	Don Mattson	270 Mattson Rd.	\$149.49
			<u>\$2,529.52</u>

Town 2008	City 2009 50%	City 2010 50%	City 2011 50%	City 2012 50%	City 2013 50%	Total to town
\$2,529.52	\$1,264.76	\$1,264.76	\$1,264.76	\$1,264.76	\$1,264.76	\$6,323.80

NOTE: Tax payments subject to change upon certification of taxes payable 2008.

NOTE: Per State Statute 414.036, the reimbursement from the City to the Town shall be completed in substantially equal payments over not less than two years nor more than eight years from the time of annexation. This schedule reflects a five year reimbursement similar to previous annexations.

REC'D BY AMMB SEP 25 2007

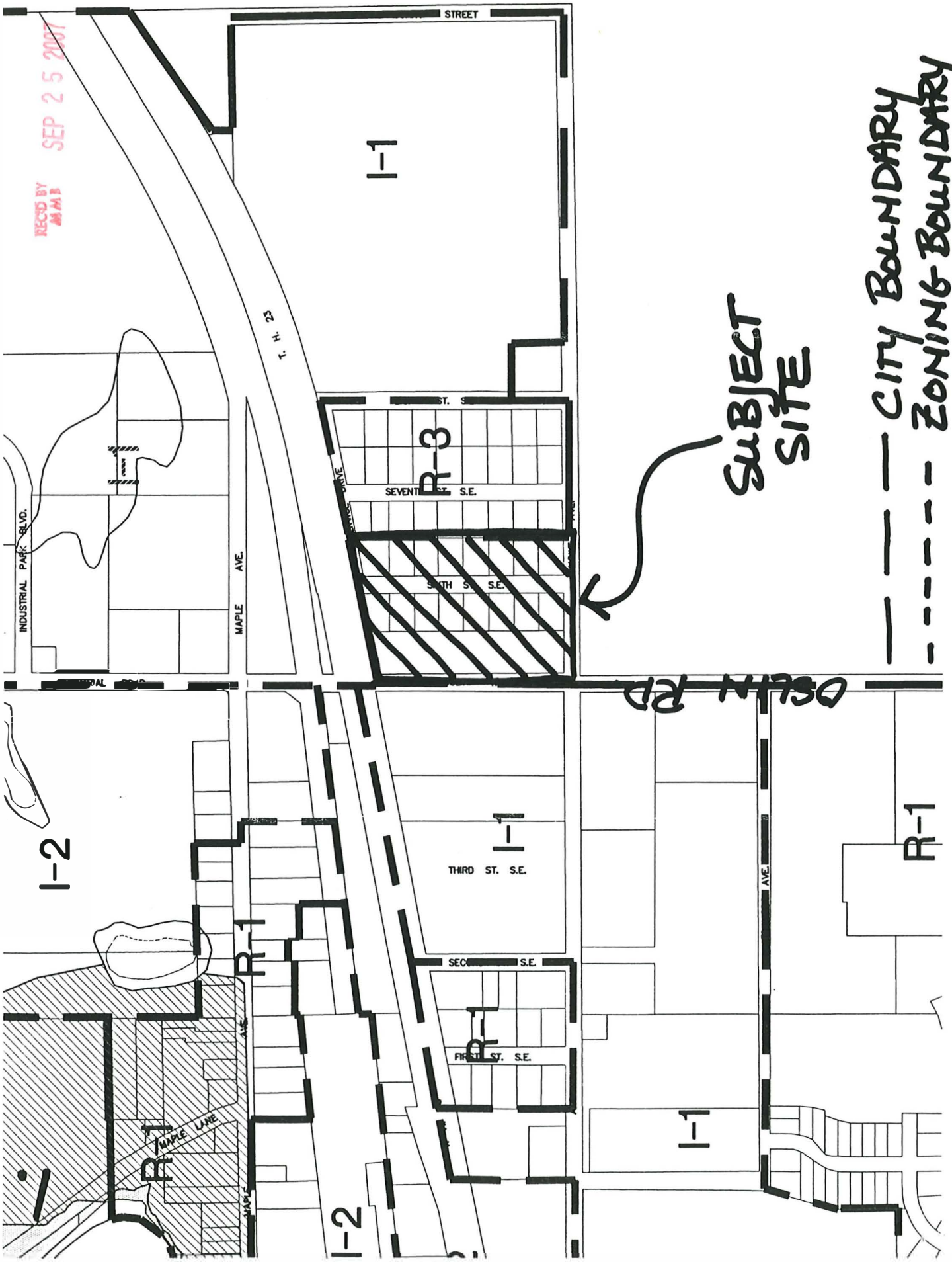

SUBJECT SITE

— — — — — CITY BOUNDARY  
 - - - - - ZONING BOUNDARY

