

REC'D BY
MMB

FEB 06 2007

PETITION FOR ANNEXATION OF PROPERTY

Now comes the undersigned, who are in the territory which is contiguous or adjacent to the City of Marshall and not embraced with the limits thereof, which is more particularly described below, and pursuant to Code, do hereby petition that the City Council of Marshall, Minnesota, by ordinance, shall annex the property defined and described below to the City of Marshall.

Legal Description of Property:

All that part of the West Half of the Southeast Quarter of Section 10, Township 111 North, Range 41 West, Lyon County, Minnesota, being more particularly described as follows:

Beginning at the northwest corner of said Southeast Quarter; thence North 89 degrees 44 minutes 53 seconds East, bearing based on Minnesota State Plane Coordinate System Lyon County Datum, along the north line of said Southeast Quarter, a distance of 987.30 feet; thence South 00 degrees 37 minutes 25 seconds East a distance of 2648.72 feet to a point on the south line of said Southeast Quarter; thence South 89 degrees 48 minutes 15 seconds West, along said south line, a distance of 987.30 feet to the southwest corner of said Southeast Quarter; thence North 00 degrees 37 minutes 25 seconds West, along the west line of said Southeast Quarter, a distance of 2647.75 feet to the point of beginning.

The undersigned furthermore requests the said area be zoned as B-3: General Business District.

Dated this 6 day of November, 2006.

Signed

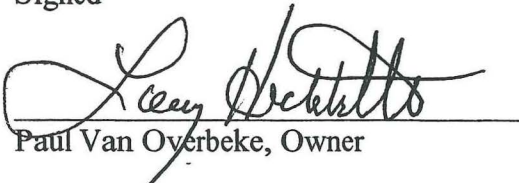
Paul Van Overbeke, Owner

Darlene Van Overbeke, Owner

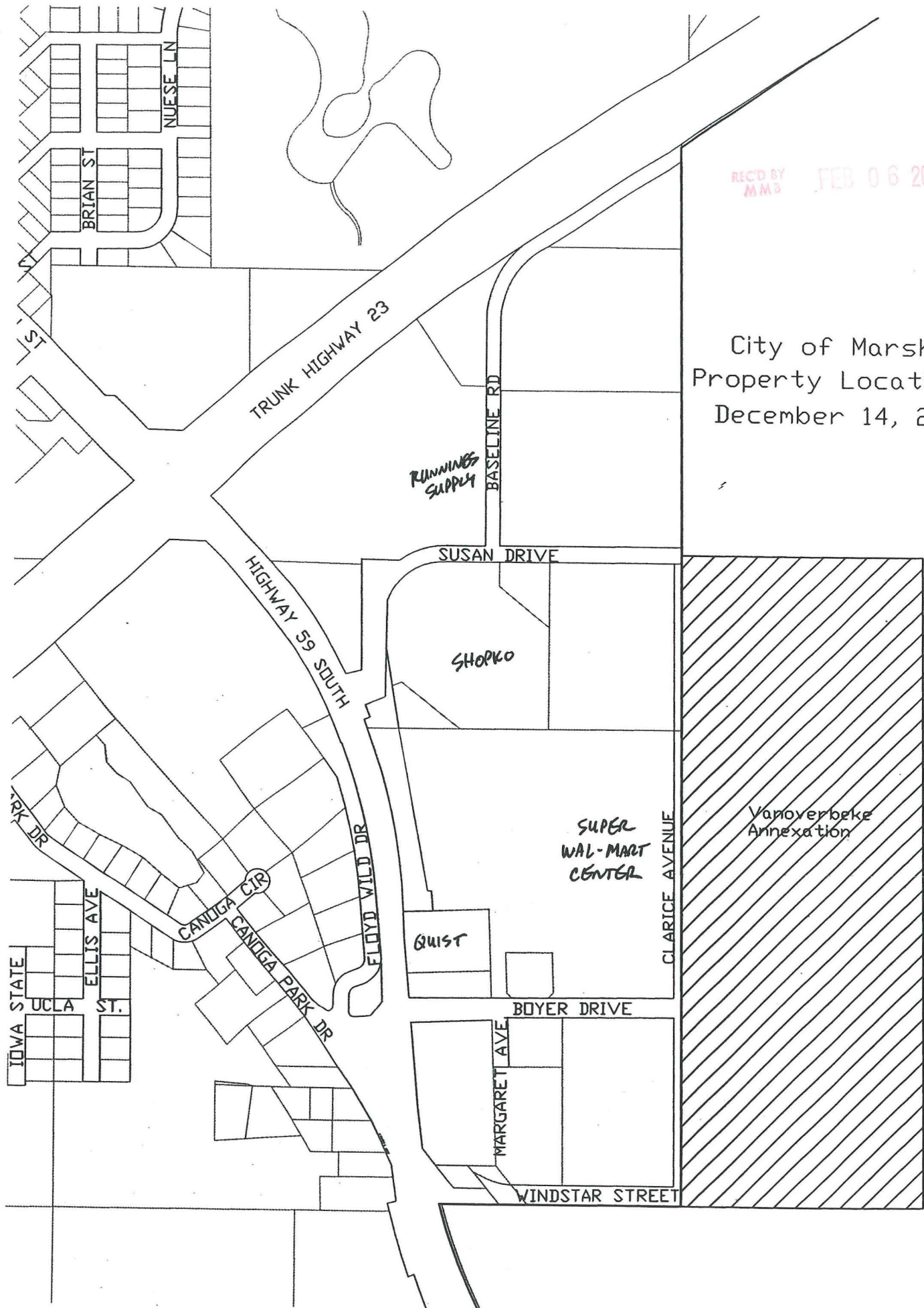

City of Marshall
Property Location Map
December 14, 2006

REC'D BY
MMB FEB 06 2007

The municipal boundary map referenced in the attached Ordinance, showing the current City of Marshall and its relation to the Subject Area to be annexed, legally described in Exhibit A, is attached hereto.

