

ORDINANCE NO. 3795

AN ORDINANCE ANNEXING TO THE CITY OF ROCHESTER A PORTION OF THE NORTHWEST QUARTER OF SECTION 18 AND A PORTION OF THE SOUTH HALF OF THE SOUTHWEST QUARTER OF SECTION 7, TOWNSHIP 107 NORTH, RANGE 13 WEST, OLMSTED COUNTY, MINNESOTA.

THE COMMON COUNCIL OF THE CITY OF ROCHESTER DO ORDAIN:

Section 1. The Common Council of the City of Rochester initiated the annexation of land owned by the City to the City of Rochester. The land is described as follows:

That part of the Northwest Quarter of Section 18 Township 107 North, Range 13 West of the 5<sup>th</sup> Principal Meridian described as follows:

Beginning at the northeast corner of Lot 1, Block 4, HAWTHORN HILL SECOND SUBDIVISION; thence North 89 degrees 17 minutes 03 seconds West 275.64 feet to the northwest corner of said Lot 1; thence North 37 degrees 49 minutes 07 seconds West 871.24 feet; thence North 00 degrees 05 minutes 55 seconds East 26.35 feet to the north line of said Northwest Quarter; thence South 88 degrees 42 minutes 56 seconds East along said north line 560.52 feet; thence South 45 degrees 08 minutes 02 seconds East 637.20 feet; thence South 01 degrees 00 minutes 44 seconds West to the north right of way line of vacated Mahon Lane NE; thence westerly along said north right of way line of vacated Mahon Lane NE to said northeast corner of Lot 1, Block 4, HAWTHORN HILL SECOND SUBDIVISION and the point of beginning; containing 9.86 acres.

AND:

That part of the South Half of the Southwest Quarter of Section 7, Township 107 North, Range 13 West of the 5<sup>th</sup> Principal Meridian described as follows:

Beginning at the southwest corner of said Southwest Quarter; thence South 88 degrees 42 minutes 56 seconds East, assumed bearing, along south line of said Southwest Quarter 1106.91 feet to the easterly line of HAWTHORN HILL ELEVENTH SUBDIVISION and the point of beginning of the land to be described; thence North 00 degrees 05 minutes 55 seconds East along said easterly line 277.98 feet; thence North 23 degrees 11 minutes 16 seconds West along said easterly line 626.32 feet to the south line of Hawthorn Hill Road NE according to the HAWTHORN HILL SECOND SUBDIVISION; thence easterly 278.02 feet along said south line and on a nontangential curve concave to the south having a radius of 217.00 feet and a central angle of 73 degrees 24 minutes 29 seconds, the chord of said curve bears South 76 degrees 29 minutes 02 seconds East; thence easterly 349.69 feet along said south line on a reverse curve concave to the north having a radius of 333.00 feet and a central angle of 60 degrees 10 minutes 02 seconds, the chord of said curve bears South 69 degrees 53 minutes 01 East; thence South 09 degrees 57 minutes 08 seconds East 447.35 feet; thence South 26 degrees 05 minutes 34 seconds East 190.00 feet; thence South 45 degrees 08 minutes 02 seconds East 112.80 feet to the south line of said Southwest Quarter; thence North 88 degrees 42 minutes 56 seconds West along said south line 560.52 feet to the point of beginning; containing 8.04 acres. Subject to easements and restrictions of record.

Total annexation Area, 17.90 acres.

Section 2. The property described in Section 1 is known as the Hawthorne Hills Golf Learning Center and is located in the Haverhill Township.

Section 3. The Common Council of the City of Rochester determined that the land is owned by the City of Rochester and, as such, the land is or will soon become urban or suburban in character.

Section 4. Therefore, pursuant to Minn. Stat. §414.033, subd. 2(1), the land described in Section 1 above is hereby annexed, added to and made a part of the City of Rochester, Minnesota, as if it had originally been a part thereof.

Section 5. The land described in Section 1 is not taxable property. Accordingly, the City of Rochester, as the annexing municipality, will not make any reimbursement to the Town pursuant to Minn. Stat. Section 414.036. Furthermore, the Town has not assigned any special assessments to the land described in Section 1.

Section 6. This ordinance shall take effect and be in force following its official publication and from and after the filing of a certified copy hereof with the Minnesota State Planning Commission, the Haverhill Town Clerk, the County Auditor, and the Secretary of State.

PASSED AND ADOPTED BY THE COMMON COUNCIL OF THE CITY OF  
ROCHESTER, MINNESOTA, THIS 11th DAY OF DECEMBER, 2006.

*James L. Larson*  
PRESIDENT OF SAID COMMON COUNCIL

ATTEST: *Judy Kay Shew*  
CITY CLERK

APPROVED THIS 12th DAY OF DECEMBER, 2006.



*Ardell F. Biede*  
MAYOR OF SAID CITY

(Seal of the City of  
Rochester, Minnesota)

Ord05Annex.HawthorneHills 3rd

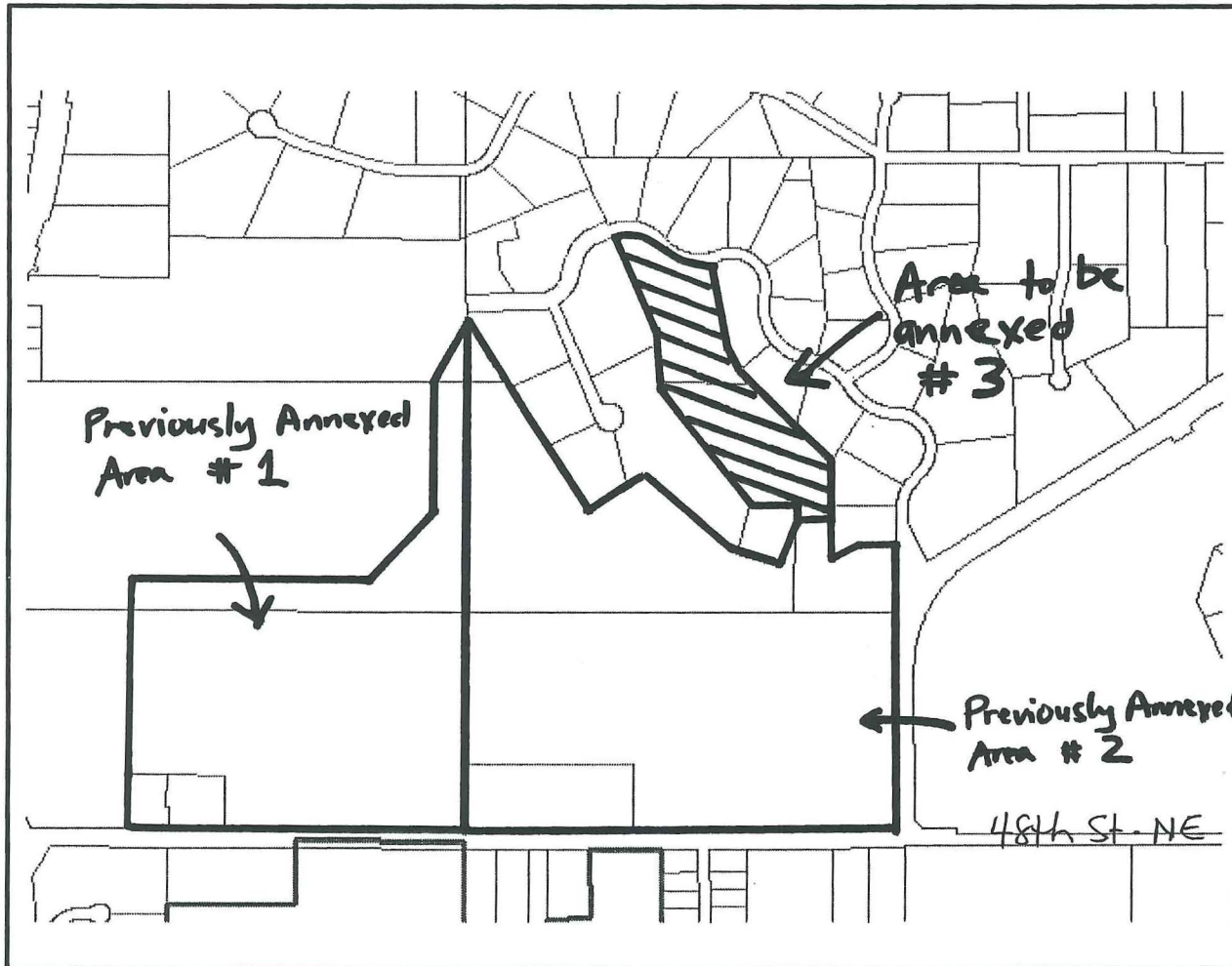
# Annexation - Final Portion of Hawthorn Hills Golf Center



-  city\_limit
-  parcel\_boundaries

REC'D BY  
M.M.B.  
DEC 26 2006