

## Ordinance No. 57/05

AN ORDINANCE EXTENDING THE CORPORATE LIMITS  
OF THE CITY OF ELYSIAN, MINNESOTA

WHEREAS, a Petition has been filed by the sole owner in the area legally described on the attached Exhibit "A" and what is identified as the Remiger Annexation area requesting annexation to the City of Elysian, Minnesota, pursuant to Minnesota Statute 414.033, Subdivision 2, and

WHEREAS, the City Council of Elysian, Minnesota, has determined that said Petition is in proper form and that the same as been signed by 100 percent of the owners in the petition area, and

WHEREAS, the land proposed to be annexed is less than 60 acres in size and is not presently served by public sewer, consisting of approximately 6.3 acres, and is not included in any area that has been designated for orderly annexation, and

WHEREAS, the described tract of unincorporated property abuts the municipal limits of the City of Elysian, Minnesota, and

WHEREAS, the described land is about to become urban or suburban in character because of development proposals being considered by the petitioning landowners, and

WHEREAS, the Town Board of Janesville Township, within which the land to be annexed lies, has been served with a copy of said Petition for Annexation and has not lodged an objection within 30 days of service, and

WHEREAS, a public hearing has been held on May 2<sup>nd</sup>, 2005 at 6:30 pm in the Elysian City Council chambers, pursuant to Minnesota Statutes 414.033, subdivision 2b,

NOW, THEREFORE, the City of Elysian, Minnesota, hereby ordains:

1. The corporate limits of the City of Elysian are hereby extended to include the property legally described on the attached Exhibit "A" and the same is hereby annexed to and included within the City of Elysian as if the property had originally been part thereof.
2. The City Clerk/Administrator is directed to file certified copies of this Ordinance with the Minnesota Municipal Board, Janesville Township, the Waseca County Auditor and the Minnesota Secretary of State pursuant to Minnesota Statutes 414.033, subdivision 7.
3. This ordinance takes effect upon its passage and publication and approval of the Ordinance by the Minnesota Municipal Board.

Adopted this 2<sup>nd</sup> day of May, 2005

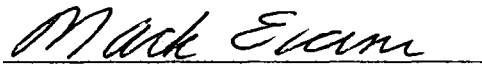
  
Mack Evans, Mayor

ATTEST:

  
Patricia Nusbaum, City Clerk/Administrator

EXHIBIT "A"

Commencing at a point twelve (12) rods south of the quarter post at the southeast (SE) corner of the southwest quarter (SW  $\frac{1}{4}$ ) of Section thirty five (35), in Township one hundred nine (109N) North, Range twenty four (24W) West, LeSueur County, Minnesota, thence running west four hundred forty five (445') feet; thence running south to Lake Elysian; thence east along said Lake to a point directly south of point of commencement; thence running north to the place of beginning and containing four (4) acres, more or less, and being in section two (2), Township one hundred eight (108N) North, Range twenty four (24W) West, Waseca County, Minnesota.  
AND

All that part of government lot one (1) in section two (2), Township one hundred eight (108) North, Range twenty four (24) West in Waseca County, Minnesota, and described as follows, to wit: Commencing at the South Quarter (S  $\frac{1}{4}$ ) corner of Section thirty five (35), Township one hundred nine (109N) North, Range twenty four (24W) West, LeSueur County, Minnesota; thence East on the Section line One and Forty Hundredths (1.40) chains; thence South four degrees twenty two minutes (4 degrees 22 minutes) West one and thirty two hundredths (1.32) chains; thence South twenty six degrees thirty minutes (26 degrees 30 minutes) East zero and ninety five hundredths (0.95) chains; thence South fifty six degrees forty five minutes (56 degrees 45 minutes) East zero and seventy eight hundredths (0.78) chains; thence South eighty eight degrees (88 degrees) East zero and seventy seven hundredths (0.77) chains; thence South three and thirty eight hundredths (3.38) chains to the shore of Lake Elysian; thence Southwesterly on shore of said Lake to a point that is eight and thirty seven hundredths (8.37) chains South of the above described point of commencement; thence North to the place of beginning, containing One and eighty four hundredths (1.84) acres.

EXCEPT

That part of the Northwest Quarter (NW  $\frac{1}{4}$ ) of Section Two (2), Township one hundred eight (108N) North, Range twenty four (24W) West, Waseca County, Minnesota, described as follows: Commencing at the South Quarter (S  $\frac{1}{4}$ ) corner of Section Thirty five, Township one hundred nine (109N) North, Range twenty four (24W) West; thence South zero degrees thirteen minutes twenty three seconds (00 degrees 13 minutes 23 seconds) East (the North line of the Northwest Quarter (NW  $\frac{1}{4}$ ) of Section two (2) is assumed to bear North ninety degrees zero minutes zero seconds (90 degrees 00 minutes 00 seconds) West one hundred ninety eight and zero hundredths (198.00') feet; thence South eighty nine degrees fifty eight minutes forty five seconds (89 degrees 58 minutes 45 seconds) West one hundred ninety five and zero hundreds (195.00') feet to the point of beginning; thence continuing South eighty nine degrees fifty eight minutes forty six seconds (89 degrees 58 minutes 46 seconds) West two hundred fifty and zero hundredths (250.00') feet; thence South zero degrees thirteen minutes twenty three seconds (00 degrees 13 minutes 23 seconds) East one hundred fifty and zero hundredths (150.00') feet; thence North eighty nine degrees fifty eight minutes forty six seconds (89 degrees 58 minutes 46 seconds) East two hundred fifty and zero hundredths (250.00') feet, thence North zero degrees thirteen minutes twenty three seconds (00 degrees 13 minutes 23 seconds) West one hundred fifty and zero hundredths (150.00') feet to the point of beginning. Said parcel contains zero and eighty six hundredths (0.86) acres of land.

STORM M...  
P. 1036.25  
1-1037.55 N  
1-1027.45 S  
1-1030.65 E  
1-1027.55 W  
1-1030.65 E

REC'D BY  
M.M.B.  
APPROX  
1-1027.45

JUL 27 2006

PROPOSED 12" S

STORM M...  
P. 1038.95  
1-1032.43 N  
1-1032.47 W

30" PROPOSED  
HYDRAULIC SUPPLY

1-1031.96  
1-1031.96

PITOMBY IS CUPR  
115.40  
115.40

MAPLE STREET

PROPOSED 8" SANITARY SEWER

PROPOSED 6" WATERMAIN

PROPOSED RETAINING WALL & FENCE

PROPOSED 18" STORM SEWER

PROPOSED 12" STORM SEWER

17

17

17

17

17

17

17

17

REMIGER COURT

1  
LFE 1045.6  
FB  
LFE 1038.2

2  
LFE 1037.6  
FB  
GFE 1046.0

3  
LFE 1037.4  
FB  
GFE 1045.8

4  
LFE 1037.2  
FB  
GFE 1045.6

9  
GFE 1045.3  
FBWO  
LFE 1036.9

8  
GFE 1045.8  
FBWO  
LFE 1037.6

7  
GFE 1045.6  
FBWO  
LFE 1037.6

11  
GFE 1046.8  
FBWO  
LFE 1037.6

10  
GFE 1045.8  
FBWO  
LFE 1037.4

12  
GFE 1046.2  
FBWO  
LFE 1037.8

13  
GFE 1046.5  
FBWO  
LFE 1038.1

14  
GFE 1046.7  
FBWO  
LFE 1038.3

15  
GFE 1046.9  
FBWO  
LFE 1038.5

16  
GFE 1047.1  
FBWO  
LFE 1038.7

WOODED AREA

WEST OF BOUNDARY LINE

SHED

SHED

PERMANENT DAMPPERS

PERMANENT DAMPPERS

WATER SP301

SHED

SHED

SHED

SHED

SHED

SHED

SHED

SHED

SHED

SHED

SHED

# CITY OF ELYSIAN

REC'D BY  
MMD

MAR 26 2005

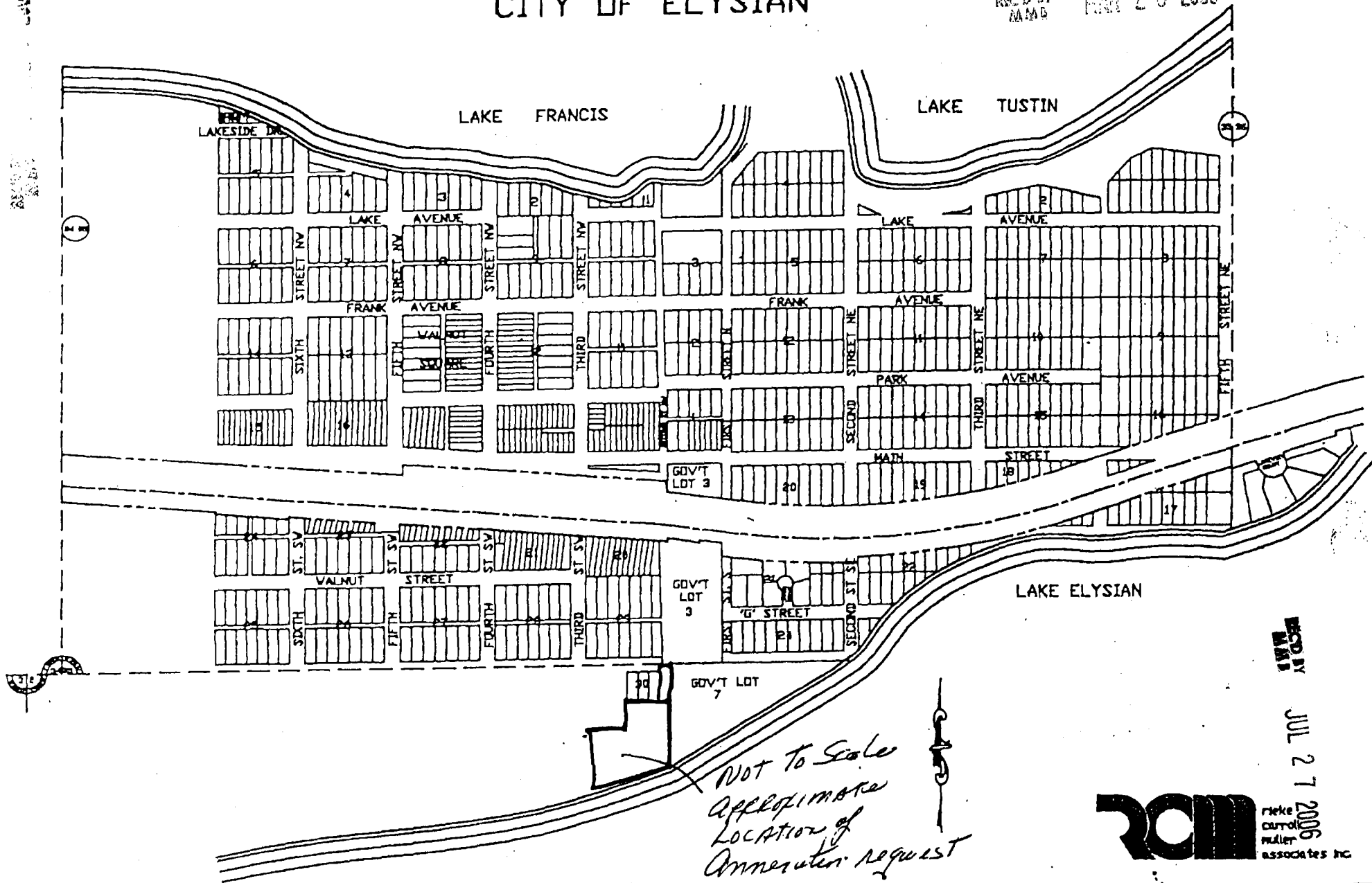

REC'D BY  
MMD

JUL 27

2006  
Rieke Carroll  
Muller  
Associates Inc

