

ORDINANCE NO. 314

AN ORDINANCE EXTENDING THE CORPORATE LIMITS OF THE CITY OF SLAYTON, MURRAY COUNTY, MINNESOTA, TO INCLUDE CERTAIN UNINCORPORATED UNPLATTED LAND NOT EXCEEDING 200 ACRES IN AREA ABUTTING UPON THE CITY LIMITS

WHEREAS, a certain Petition for Annexation requesting that certain territory described therein be annexed to the City of Slayton, Minnesota, has been duly presented to this City Council; and

WHEREAS, the quantity of land embraced within the area described in the petition and bounded as described consists of unplatted land not exceeding 200 acres in area, no part of which is included within the limits of an incorporated city, or borough, and all provisions of M.S. 414, Subd. 13, were complied with; and

WHEREAS, the petition was signed by all of the owners thereof; and

WHEREAS, no objections have been received from the Slayton Township Board or the county board and the boundaries of the land to be annexed do not abut upon the boundaries of any municipality except the City of Slayton; and

WHEREAS, the Slayton Township Board has passed a RESOLUTION OF WAIVER OF OBJECTION TO ANNEXATION stating it had no objections to the annexation and waiving the ninety (90) day period allowed it pursuant to M.S. 414.033, Subd. 5, to submit written objections to the annexation to the Municipal Boundary Adjustments Unit of the Minnesota Office of Administrative Hearings and the City of Slayton; and

WHEREAS, the south boundary of the land described in the petition abuts the City limits of the City of Slayton.

The Council of the City of Slayton, Minnesota, ordains:

Section 1. The City Council hereby determines (1) that the annexation will be in the best interests of the City and of the territory affected; (2) that the territory described herein abuts upon the City limits and is urban or suburban in character; and (3) that none of said territory is now included within the limits of any city, or borough.

Section 2. Territory Annexed. The corporate limits of the City are hereby extended to include the unplatted land described as follows and the same is hereby annexed to and included within the City as effectually as if it had originally been a part thereof:

A parcel of land in the Southeast Quarter (SE $\frac{1}{4}$) of Section Nine (9), Township One Hundred Six North (106N), Range Forty-one (41), West of the 5th P.M., described as follows: Beginning at the southeast corner of Lot One (1) of Block One (1) of Finley's Subdivision; thence west along and upon the south boundary line of said Lot 1 of Block 1 of Finley's Subdivision a distance of 187.39 feet to the southwest corner of said Lot 1 of Block 1 of Finley's Subdivision; thence continuing west along and upon the north right of way line of Engebretson Street (also being the north boundary line of Lot 1 of Block 1 of Finley's Subdivision extended) a distance of 290.40 feet; thence north and parallel to the west boundary line and west boundary line extended of Lot 1 of Block 1 of Finley's Subdivision a distance of 500.00 feet; thence east and parallel to the north right of way line of Engebretson Street (also being the north boundary line of Lot 1 of Block 1 of Finley's Subdivision extended) and the north

boundary line of said Lot 1 of Block 1 of Finley's Subdivision a distance of 477.79 feet to the east boundary line of said Lot 1 of Block 1 of Finley's Subdivision extended; thence south along and upon the east boundary line extended and the east boundary line of said Lot 1 of Block 1 of Finley's Subdivision a distance of 500.00 feet to the southeast corner of said Lot 1 of Block 1 of Finley's Subdivision, which is the point of beginning, EXCEPT the west 290.40 feet of the south 300.00 feet thereof, AND EXCEPT Lot One (1) of Block One (1) of Finley's Subdivision. Said tract contains 2.19 acres.

Section 3. Filing. The City Clerk/Administrator is hereby directed to file copies of this ordinance with the Municipal Boundary Adjustments Unit of the Minnesota Office of Administrative Hearings, the Minnesota Secretary of State, the Town Clerk of Slayton Township, and the Murray County Auditor/Treasurer.

Section 4. Effective Date. This ordinance takes effect upon its passage and publication and the filing of the certified copies as directed in Section 3, and the approval of the ordinance by the Municipal Boundary Adjustments Unit of the Minnesota Office of Administrative Hearings.

Adopted by the City Council this 17th day of July, 2006.



MAYOR

ATTEST:

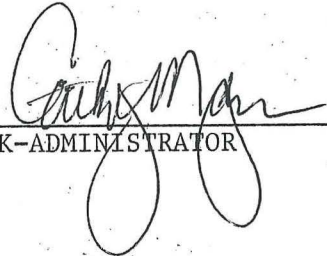

CLERK-ADMINISTRATOR

N
PROPOSED NEW ADDITION

477.79' x 200'

2.19 acres

TRACT TO BE ANNEXED

W
Previously
Annexed TO CITY OF
SLAYTON

FIRST ADDITION

290.40' x 300' deep

2.00 acres

E
LOT 1, BLOCK 1,
Finley's Subdivision
CITY OF SLAYTON

ORIGINAL LOT

187.39' wide x 300' deep

1.29 acres
S

RECTD BY
M.M.B.
JUL 17 2006

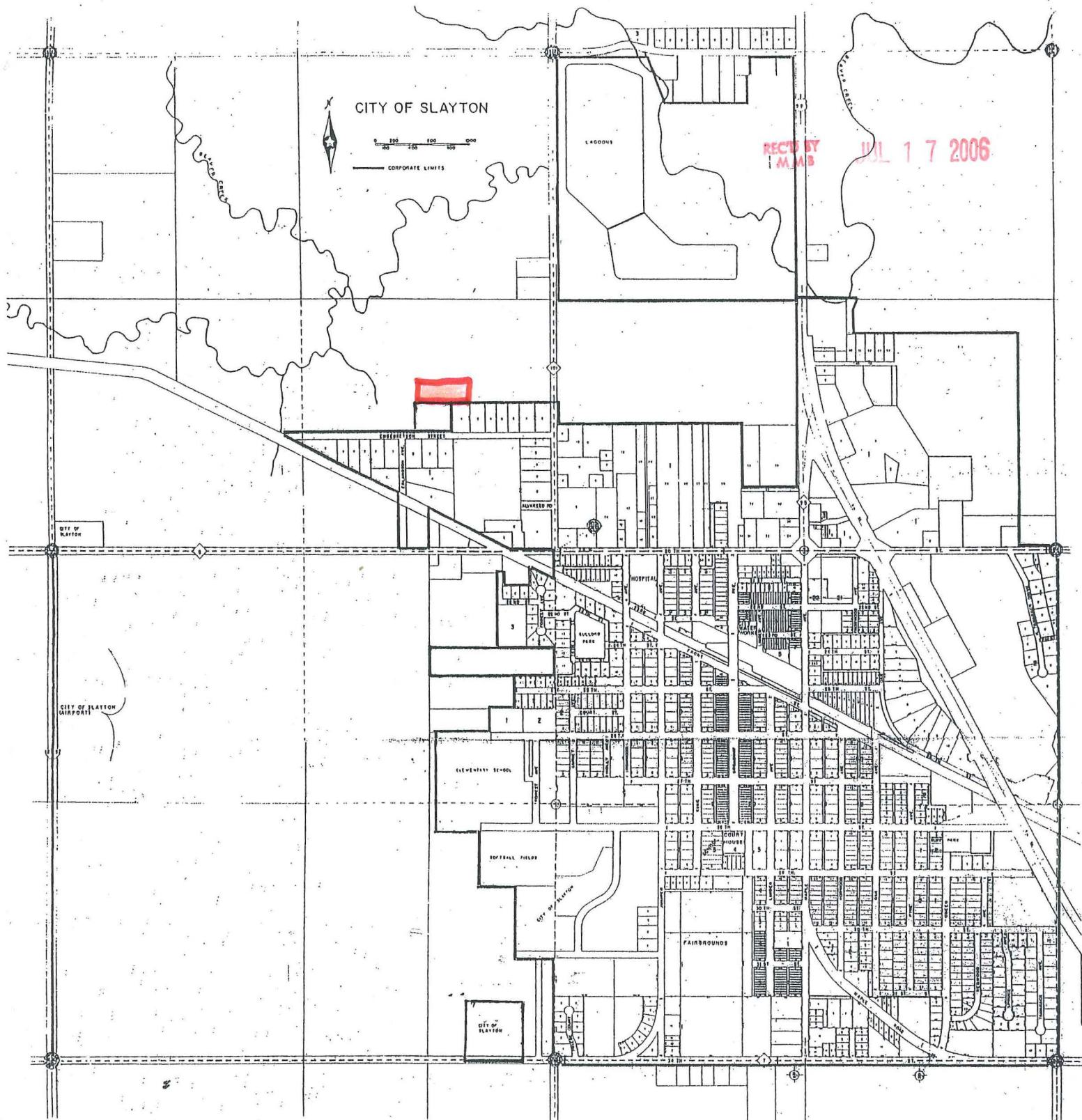

TRACT TO BE ANNEXED IS IN RED