

ORDINANCE NO. 164

**AN ORDINANCE ANNEXING UNINCORPORATED LANDS
LOCATED IN THE TOWN OF JEVNE, AITKIN COUNTY, MINNESOTA,
INTO THE CITY OF MCGREGOR, AITKIN COUNTY, MINNESOTA
PURSUANT TO MINNESOTA STATUTES 414.033, SUBD 2(3),
PERMITTING ANNEXATION BY ORDINANCE**

The City Council of the City of McGregor, Aitkin County, Minnesota, hereby ordains:

SECTION I. That all of the owners of the lands to be annexed, as hereinafter described, executed a Petition for annexation (a copy of which is attached), and that said unincorporated lands, approximating five (5) acres in size, are described in that Petition and are legally described in Section IV herein and are currently located within the Town of Jevne, Aitkin County, Minnesota.

SECTION II. That said lands are urban or suburban in character or about to become so, said lands being residential lands which are presently unoccupied, hence to that extent the annexation does result in a present change in the population of the City of McGregor.

SECTION III. That said lands abut the existing corporate limits of the City of McGregor, are un-platted, and consist of approximately 5 acres.

SECTION IV. Said lands are legally described as follows:

The East 641 feet of the North 340 feet of the Northeast Quarter of the Northeast Quarter (NE 1/4 of NE 1/4) of Section Twenty-Five (25), Township forty-eight (48), Range Twenty-four (24), all in Aitkin County, Minnesota.

SECTION V. That at least thirty (30) days before Petition for Annexation in the within matter was considered at a public hearing, written notices were sent by certified mail to the Town of Jevne and all landowners within and contiguous to the five acre parcel being annexed.

SECTION VI. That the Petition was signed, dated and filed with the City on April 30, 2006, the required notices were duly mailed, and the public hearing on the Petition was held June 9, 2006; no objections to the annexation being noted or received.

SECTION VII. That the purpose of the annexation is to extend public water and sewer services to the parcel being annexed for economic development where such services are presently not available.

SECTION VIII. That consistent with the foregoing it is the intent of the City Council that the aforesaid lands are hereby duly annexed to the City of McGregor.

SECTION IX. The City Clerk is hereby directed to forthwith file copies of this ordinance with the Office of Administrative Hearings, the Secretary of State, the Town of Jevne, Aitkin County Recorder and the Aitkin County Auditor.

SECTION X. This Ordinance shall become effective and said land duly annexed to the City of McGregor upon the due passage and enactment hereof, approval by the Office of Administrative Hearings and publication of this Ordinance according to law.

Passed and enacted this _____th day of June, 2006.

CITY OF McGREGOR

APPROVED:



Mayor

ATTEST:



City Clerk

RECT'D BY
MAB

JUN 23 2006

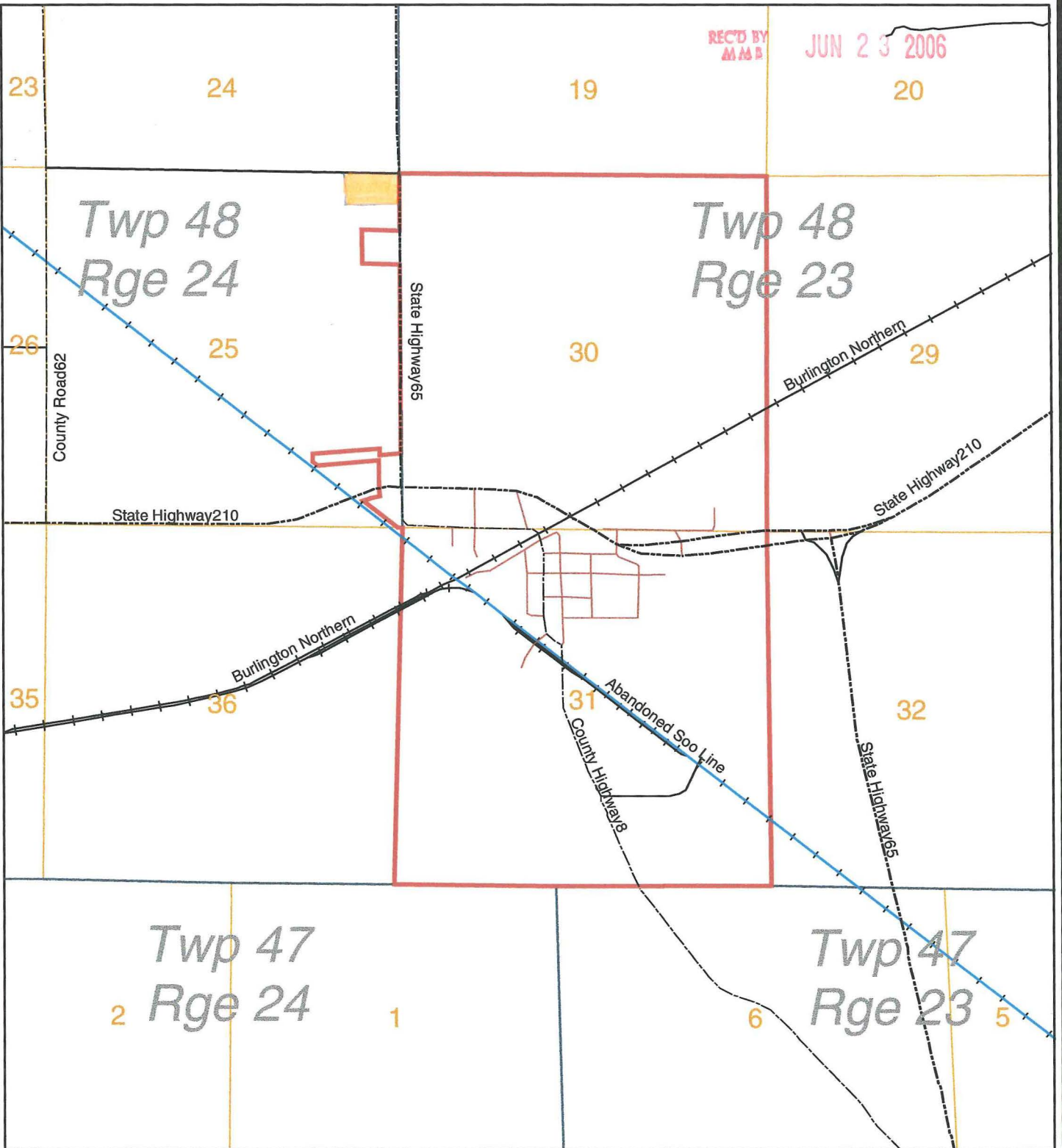

City of McGregor



- | | | |
|--------------------|---------------|-------------------|
| City Road | State Highway | City of McGregor |
| County Highway | Township Road | Township Boundary |
| Other Road | U.S. Highway | Sections |
| Recreational Trail | Railroad | |

Map prepared by the Aitkin County Land Department for graphic display purposes only. Map is not a legal survey, nor is it intended to be. Aitkin County assumes no liability for errors, omissions or inaccuracies herein contained. Liz H - 6/06

