

ORDINANCE NO. 361

AN ORDINANCE EXTENDING THE CORPORATE LIMITS OF THE CITY OF ISANTI TO INCLUDE CERTAIN UNINCORPORATED PROPERTY (60 ACRES) OWNED PAUL AND JANET BOSTROM ABUTTING UPON THE LIMITS OF THE CITY OF ISANTI IN ISANTI TOWNSHIP PURSUANT TO MINNESOTA STATUTES 414.033, subd. 2(3)

WHEREAS, a certain petition dated April 25, 2006 requesting that the property as hereinafter described be annexed to the City of Isanti, Minnesota, was duly presented to this Council on the 2nd day of May 2006; and

WHEREAS, said petition was signed by all owners of the property; and

WHEREAS, said property is unincorporated and abuts the current boundary of the City of Isanti; and

WHEREAS, said property is 60 acres or less; and

WHEREAS, said property is not presently served by public sewer and water facilities or public sewer and water facilities are not otherwise available; and

WHEREAS, said property is currently being developed for residential purposes; and

WHEREAS, to facilitate said development, the property owner has requested city services be extended to said property; and

WHEREAS, notice of public hearing was given to those parties specified in Minnesota Statutes 414.033, subd. 2b; and

WHEREAS, a public hearing was duly held by the Isanti City Council on the 6th day of June 2006; and

WHEREAS, provisions of Minn. Statute 414.033, subd. 13 are not applicable in that there will be no change in the electric utility service provider resulting from the annexation of the territory to the municipality.

JUN 12 2006

4. **Property Taxes.** Pursuant to Minnesota Statutes 414.033, subd. 12, the property taxes payable on annexed land in the year 2006 shall be paid to the Township of Isanti, Minnesota. Thereafter, the City of Isanti shall make a cash payment to the Township of Isanti in accordance with the following schedule:
 - a. 2007 – an amount equal to ninety percent (90%) of the property taxes distributed to the town in regard to the annexed area in 2006;
 - b. 2008 – An amount equal to seventy percent (70%) of the property taxes distributed to the town in regard to the annexed area in 2006;
 - c. 2009 – an amount equal to fifty percent (50%) of the property taxes distributed to the town in regard to the annexed area in 2006;
 - d. 2010 – an amount equal to thirty percent (30%) of the property taxes distributed to the town in regard to the annexed area in 2006; and
 - e. 2011 – an amount equal to ten percent (10%) of the property taxes distributed to the town in regard to the annexed area in 2006.

5. **Filing.** The City Clerk is directed to file certified copies of this ordinance with the Secretary of State, the County Auditor of the county in which the property is located, the Town Clerk of the affected township and the Minnesota Planning.

6. **Effective date of annexation.** This ordinance takes effect upon its passage and publication and the filing of certified copies as directed in paragraph 5 and approved by the Office of Administrative Hearings, Minnesota Boundary Adjustment Unit.

Passed and Adopted by the City Council of Isanti, Minnesota this 6th day of June 2006

Attest:

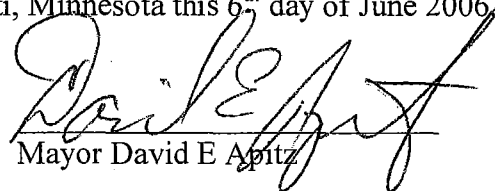
Mayor David E. Apitz

Irene J. Bauer, City Clerk

(SEAL)

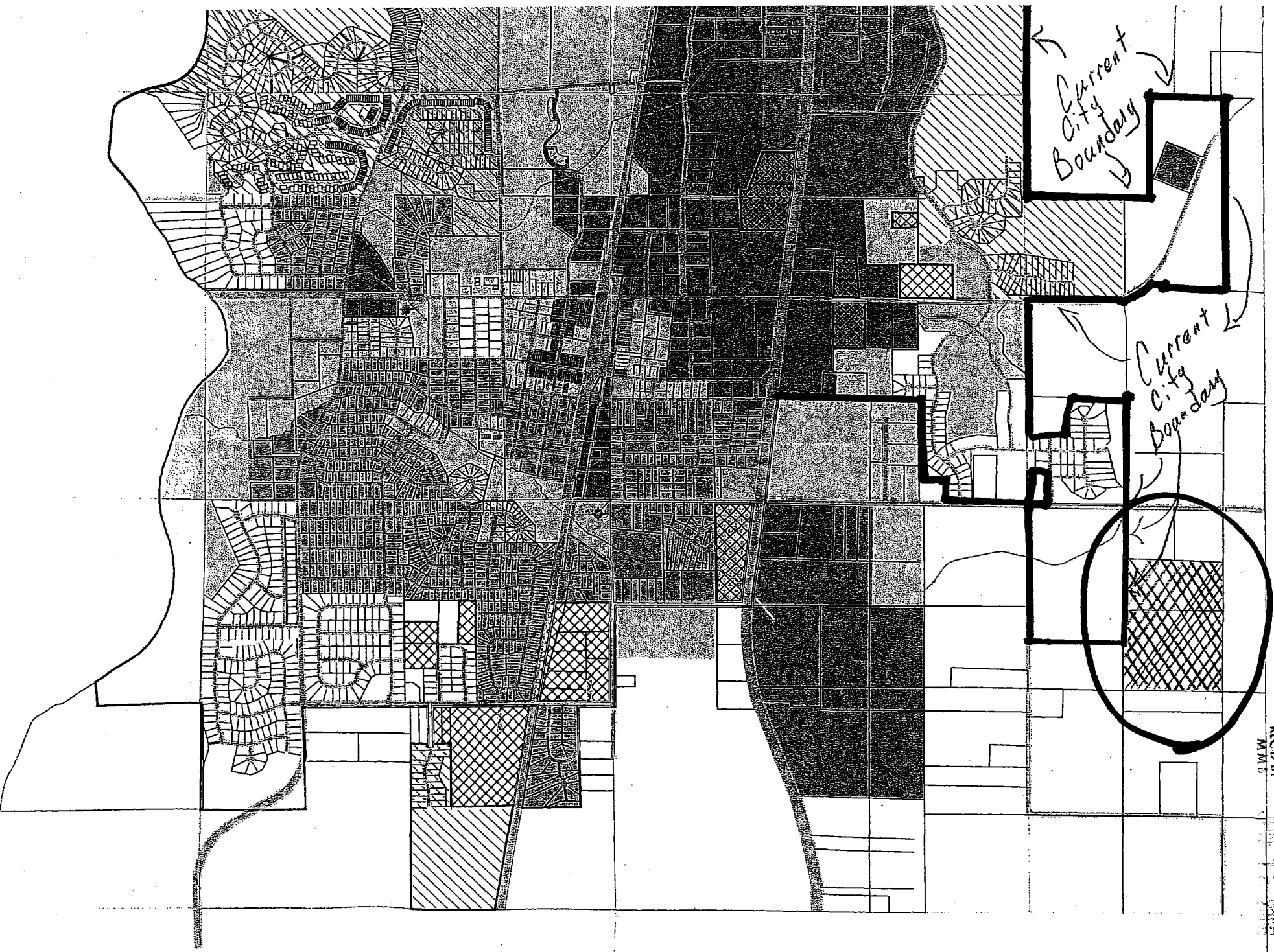

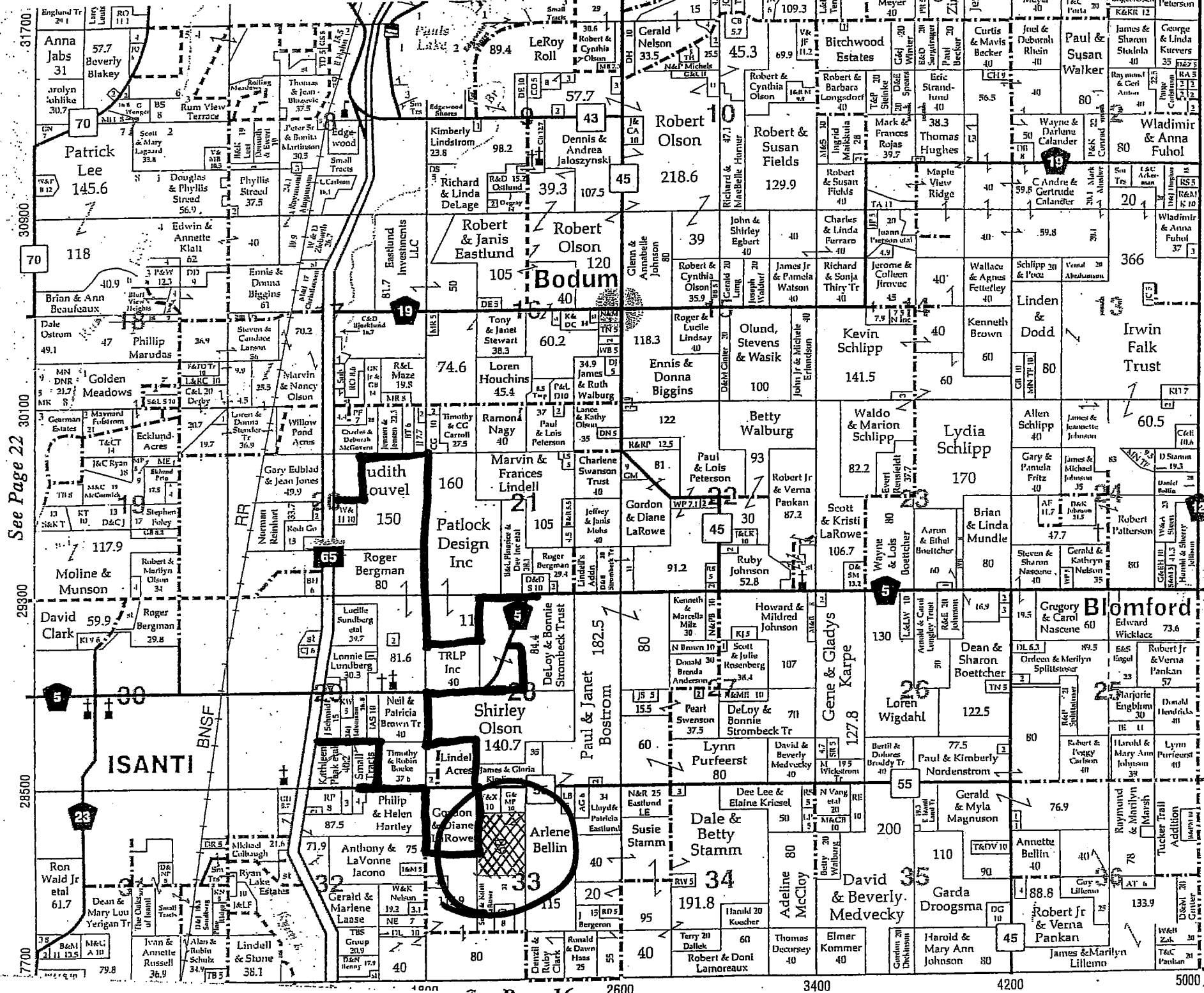

See Page 22

See Page 26

REC'D BY
M.M.B.
JUN 12 2006