

APR 27 2006

IN THE MATTER OF THE PETITION OF  
CERTAIN PERSONS FOR ANNEXATION PURSUANT  
TO MINNESOTA STATUTES 414.033, SUBD. 5

---

TO: Council of the City of Litchfield, Minnesota

AND

Department of Administration  
Municipal Boundary Adjustments  
658 Cedar Street, Room 300  
St. Paul, MN 55155  
(651) 284-3383

PETITIONER(S) STATE: The property owner or a majority of the property owners in number are required to commence a proceeding under M.S. 414.033, Subd. 5.

It is hereby requested by the sole property owner of the area proposed for annexation to annex certain property described herein lying in the Town of Litchfield to the City of Litchfield, County of Meeker, Minnesota.

The area proposed for annexation is described as follows:

The W 1/2 of the SE 1/4 of Section 1, Township 119, Range 31;

AND the SE 1/4 of SE 1/4, Section 1, Township 119, Range 31, Less and Except the following described tracts:

EXCEPTION#1;

Beginning at the SE corner of said SE 1/4; thence on an assumed bearing of North 0 degrees 01 minutes 46 seconds East, along the East line of said Section 1, a distance of 342.74 feet; thence North 89 degrees 08 minutes 23 seconds West 971.71 feet to the centerline of the Drainage Ditch; thence South 44 degrees 56 minutes 39 seconds East, along said centerline 169.38 feet; thence South 38 degrees 27 minutes 41 seconds East, along said centerline 127.35 feet; thence South 15 degrees 45 minutes 31 seconds East, along said centerline 131.61 feet to the South line of said Section 1; thence South 89 degrees 08 minutes 23 seconds East, along last said line 736.90 feet to the point of beginning.

## EXCEPTION #2

The North 313.00 feet of the East 417.47 feet of the Southeast Quarter of the Southeast Quarter of Section 1, Township 119, Range 31 Meeker County Minnesota.

## ALSO TO INCLUDE:

Parcel "A"

That part of the SW 1/4 of Section 1, Township 119, Range 31, Meeker County, Minnesota, described as follows; Commencing at the Southwest corner of said Section 1; thence on an assumed bearing of S 89° 34' 58" E, along the South line of said Section 1, a distance of 1002.50 feet to the West line of SCHOOL SUBDIVISION, as of public record, Meeker County, Minnesota; thence N 0° 35' 55" E, along last said line 890.60 feet to the Northwest corner of said SCHOOL SUBDIVISION; thence N 0° 33' 48" E, 508.43 feet; thence N 54° 25' 02" E, 205.80 feet to the point of beginning of the tract herein described; thence N 68° 11' 42" W, 256.80 feet; thence N 0° 25' 15" W, 53.45 feet; thence N 67° 50' 45" E, 68.74 feet; thence N 50° 35' 45" E, 331.80 feet; thence N 44° 18' 45" E, 294.00 feet; thence N 18° 39' 45" E, 425.67 feet to the Southerly right-of-way line of S.T.H. No. 24; thence Easterly, along last said right-of-way to the East line of said SW 1/4; thence S 0° 40' 56" W, along last said line 1240.16 feet; thence N 89° 34' 58" W, 1200.00 feet; thence N 0° 25' 02" E, 200.00 feet; thence N 89° 34' 58" W, 283.30 feet to the point of beginning.

1. There is one property owner in the area proposed for annexation and that owner has signed this Petition.
2. Said property is unincorporated, abuts on the city's North boundary, and is not included within any other municipality.
3. The area of land proposed for annexation, in acres, is:  
151.3 Unplatted 0 Platted 151.3 Total
4. The reason for the requested annexation is the residential and commercial development needs municipal sewer and water service.
5. The area proposed for annexation will be zoned residential and commercial.
6. The petitioners have waived any notice concerning M.S. 414.033, Subd. 13.
7. All of the area proposed for annexation is or is about to become urban or suburban in character.

APR 27 2006

8. The area to be annexed is not included in any other boundary adjustment proceeding pending before the Office of Administrative Hearings – Municipal Boundary Adjustments.
9. The area proposed for annexation is not included in any area that has already been designated for orderly annexation pursuant to M.S. 414.0325.

PETITIONER'S REQUEST: That pursuant to M.S. 414.033, the property described herein be annexed to and included within the City of Litchfield, Minnesota.

Dated: 4/14/06

MARICK DEVELOPMENT, INC.

Signatures: 

By: Richard Heid  
President

NOTE: Pursuant to Minnesota Statutes 414 and Minnesota Rules 6000.0800, the petition to the Office of Administrative Hearings is herewith accompanied by an affidavit showing that a copy of this petition was filed within 10 days after service on the annexing city with the Town of Litchfield on 4-26-06, the County of Meeker on 4-26-06.

REC'D BY  
MAB MAY 24 2006

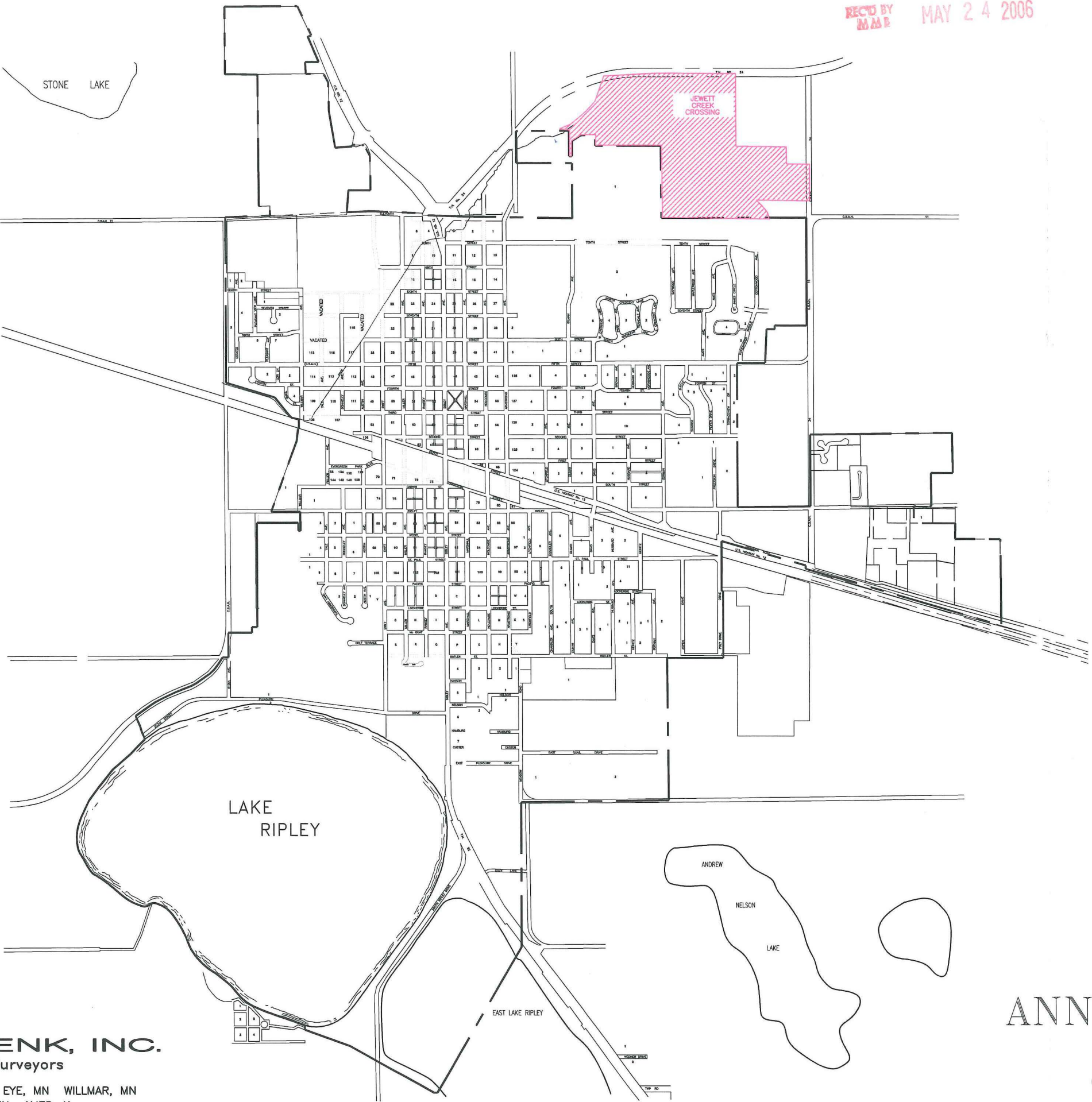

**BOLTON & MENK, INC.**  
Consulting Engineers & Surveyors

MANKATO, MN FAIRMONT, MN SLEEPY EYE, MN WILLMAR, MN  
BURNSVILLE, MN CHASKA, MN AMES, IA

# ANNEXATION EXHIBIT

MAY, 2006  
MAP OF THE  
**CITY OF LITCHFIELD**  
MEEKER COUNTY, MINNESOTA