

ORDINANCE NO. 3731

AN ORDINANCE ANNEXING TO THE CITY OF ROCHESTER APPROXIMATELY 8.65 ACRES OF LAND LOCATED IN A PART OF THE SOUTHWEST QUARTER OF SECTION 18, TOWNSHIP 107 NORTH, RANGE 14 WEST, OLMSTED COUNTY, MINNESOTA.

THE COMMON COUNCIL OF THE CITY OF ROCHESTER DO ORDAIN:

Section 1. A petition has been filed with the Common Council of the City of Rochester, signed by the owner of land described herein, requesting the Common Council to annex said land to the City of Rochester. The land described in the petition for annexation is described as follows:

A part of the Southwest Quarter of Section 18, Township 107 North, Range 14 West, Olmsted County, Minnesota, described as follows:

Beginning at the northwest corner of said Southwest Quarter; thence South 00 degrees 06 minutes 08 seconds West, assumed bearing, along the west line thereof, 851.03 feet; thence South 89 degrees 53 minutes 52 seconds East, 430.00 feet; thence North 00 degrees 06 minutes 08 seconds East, 541.27 feet; thence North 13 degrees 10 minutes 36 seconds East, 316.59 feet to the north line of said Southwest Quarter; thence North 89 degrees 44 minutes 26 seconds West, 501.62 feet to the point of beginning.

Said tract contains 8.65 acres more or less.

Section 2. The total quantity of land included in the petition is approximately 8.65 acres in size.

Section 3. On August 1, 2005, the Common Council held a public hearing to consider this annexation petition after providing written notice of the hearing, by certified mail, to the property owners, the Cascade Township officers, and the adjacent property owners.

Section 4. The City provided notification to the petitioners pursuant to Minn. Stat. §414.033, subd. 2b, 11, 12 and 13 if applicable to this petitioned annexation.

Section 5. Following the public hearing, the Common Council of the City of Rochester determined that the land abuts the municipal limits, is less than 60 acres in area, the annexation petition is signed by all property owners of the land described in Section 1, and the land is or will soon become urban or suburban in character.

Section 6. Therefore, pursuant to Minn. Stat. §414.033, subd. 2(3), the land described in Section 1 above is hereby annexed, added to and made a part of the City of Rochester, Minnesota, as if it had originally been a part thereof.

Section 7. Present and future owners of the lands annexed by this ordinance are hereby notified that in addition to the usual assessments, it is the intention of the Common Council to assess against benefited property all or a portion of the cost of any storm sewer, water tower, pumping station, and trunk line sanitary sewer construction, heretofore or hereafter undertaken to serve the area annexed.

Section 8. This ordinance shall take effect and be in force from and after its official publication and from and after the filing of a certified copy hereof with the Minnesota Department of Administration – Municipal Boundary Adjustments, the Cascade Town Clerk, the County Auditor and the Secretary of State.

PASSED AND ADOPTED BY THE COMMON COUNCIL OF THE CITY OF  
ROCHESTER, MINNESOTA, THIS 7th DAY OF SEPTEMBER, 2005.

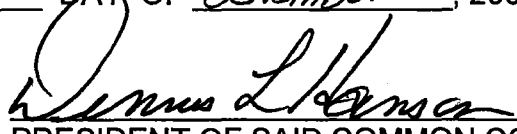
  
PRESIDENT OF SAID COMMON COUNCIL

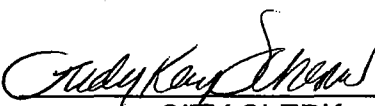
ATTEST:   
CITY CLERK

APPROVED THIS 8th DAY OF SEPTEMBER, 2005.

  
MAYOR OF SAID CITY

(Seal of the City of  
Rochester, Minnesota)

# ANNEXATION EXHIBIT

DESCRIPTION:  
SEE ATTACHED



SCALE 1" = 600'

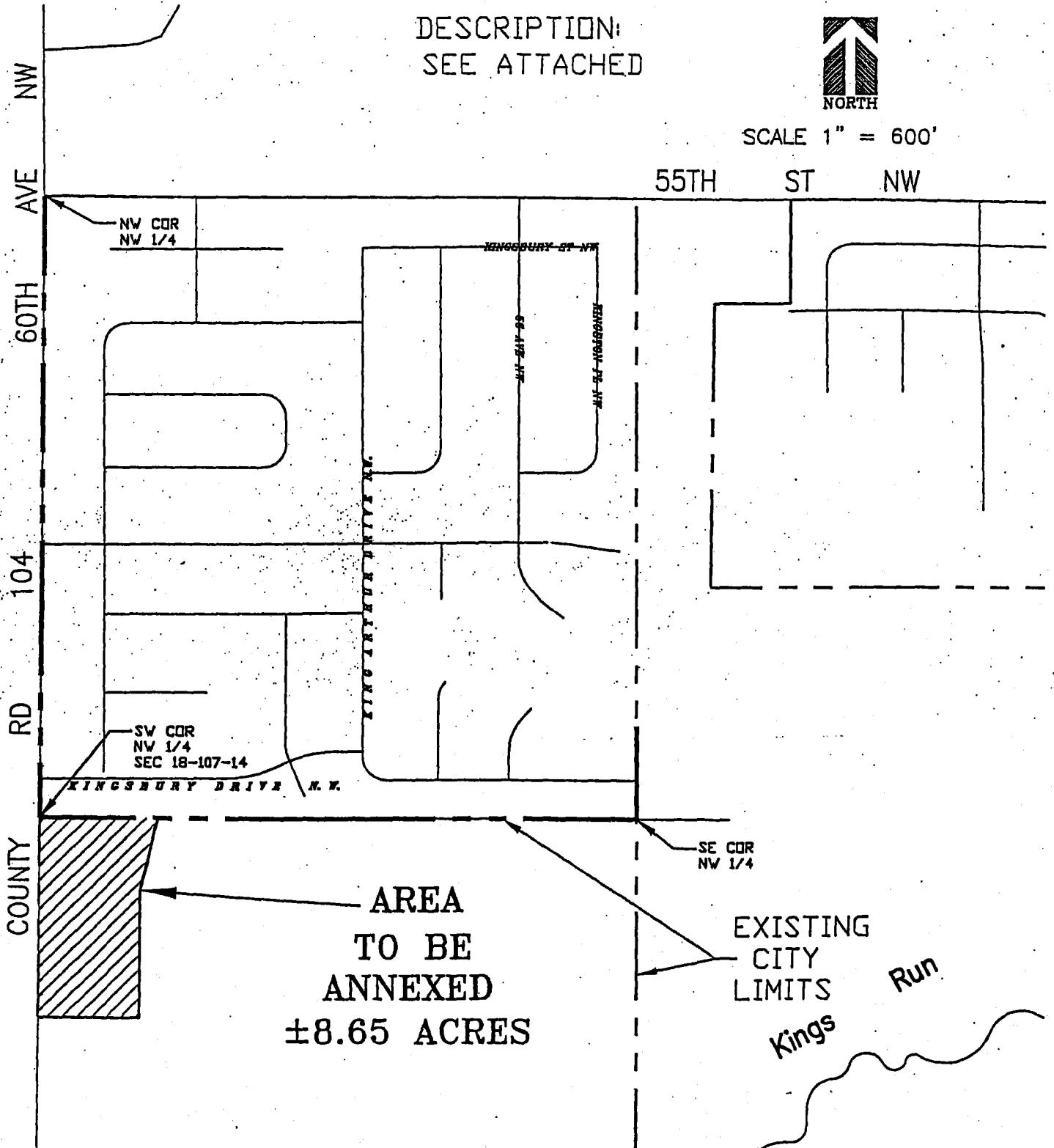

FDR :

JOEL BIGELOW  
& SONS ENTERPRISES  
706 CTY RD 3 NW  
BYRON, MN

Land Surveying  
Urban-Land  
Planning  
Consulting - Civil  
Engineering

McGhie



Geotechnical  
Engineering  
Construction Material  
Testing  
Landscape  
Architecture

SCALE: 1" = 600'

DRAWN BY: JJJ

DATE: 06/14/05

ACCT NO: 1004/5111 [unclear] [unclear]