

**CITY OF WACONIA
ORDINANCE NO. 565**

REC'D BY
M M B

AUG 04 2005

**AN ORDINANCE ANNEXING CERTAIN LANDS INTO THE CORPORATE LIMITS OF THE
CITY OF WACONIA, MINNESOTA (SUDHEIMER)**

WHEREAS, The City of Waconia received a petition submitted by U.S. Trust Company, on behalf of the Estate of Robert Sudheimer, to annex certain lands into the corporate limits of the City of Waconia, Minnesota; and

WHEREAS, Posted, published and written notice has been provided to Waconia Township and all landowners within and contiguous to the area to be annexed; and

WHEREAS, No objections have been received regarding this Petition for Annexation; and

WHEREAS, Said annexation of said lands is consistent with the City of Waconia's Comprehensive Plan.

NOW, THEREFORE, THE CITY COUNCIL OF THE CITY OF WACONIA, CARVER COUNTY, MINNESOTA, DOES HEREBY ORDAIN:

Section 1. Declaration. It is hereby determined that the annexation of lands described in Section 2 below would be in the best interest of the City of Waconia.

Section 2. Territory Annexed. The corporate limits of the City of Waconia are hereby extended to encompass and embrace all of the territory described as follows and said land is hereby annexed to and included within the City as effectually as if it had originally been a part thereof:

Tract 1:

The Northwest Quarter of the Southeast Quarter of Section 23, Township 116 North, Range 25 West, EXCEPTING therefrom the following tracts of land:

1. That part thereof platted as Sudheimer Industrial Park 2nd Addition.
2. That part thereof lying northwesterly of the former southeasterly right-of-way of the Chicago and North Western Railway Company.
3. That part thereof which lies southwesterly of the southwesterly line of the County State Aid Highway Number 32 right of way.

Tract 2:

A strip of land One Hundred (100) feet in width, the same being Fifty (50) feet in width on each side of the centerline of the main track (now removed) of the Minneapolis & St. Louis Railway Company (now the Chicago and North Western Transportation Company) as said main track centerline was originally located over and across the Northwest Quarter of the Southeast Quarter of Section Twenty-three (23), Township One Hundred Sixteen (116), Range Twenty-five (25).

Tract 3:

That part of the West Half of the Southeast Quarter of Section 23, Township 116 North, Range 25 West, which lies southwesterly of the Southwesterly line of the plat of Sudheimer Industrial Park 2nd Addition and which lies Southeasterly of the Southeasterly line of the plat of Waconia Marketplace, according to the United States Government Survey thereof and situate in Carver County, Minnesota.

Section 3. Filing. The City Clerk is hereby directed to file certified copies of this Ordinance with the Minnesota Planning Board of the State of Minnesota, the Secretary of State, and the County Auditor of Carver County as required by law.

REC'D BY
MMB

AUG 04 2005

Section 4. Effective Date of Annexation. This Ordinance takes effect upon its passage and publication and the filing of certified copies as directed in Section 3 and shall be deemed final upon approval of this Ordinance by the Minnesota Planning Board of the State of Minnesota.

Adopted by the City Council of the City of Waconia this 1st day of August, 2005

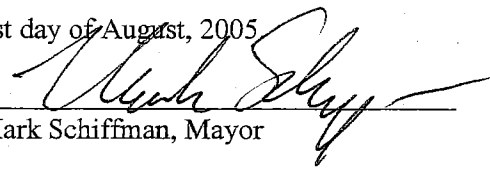
Mark Schiffman, Mayor

ATTEST:

Mary J. Johnson, CMC, City Clerk

M/ Ague

Ague

Aye

Collins

Aye

S/ Collins

DeVaun

Aye

Karki

Aye

Schiffman

Aye

F:\winappshared\mary\ord\2005ord\565ord

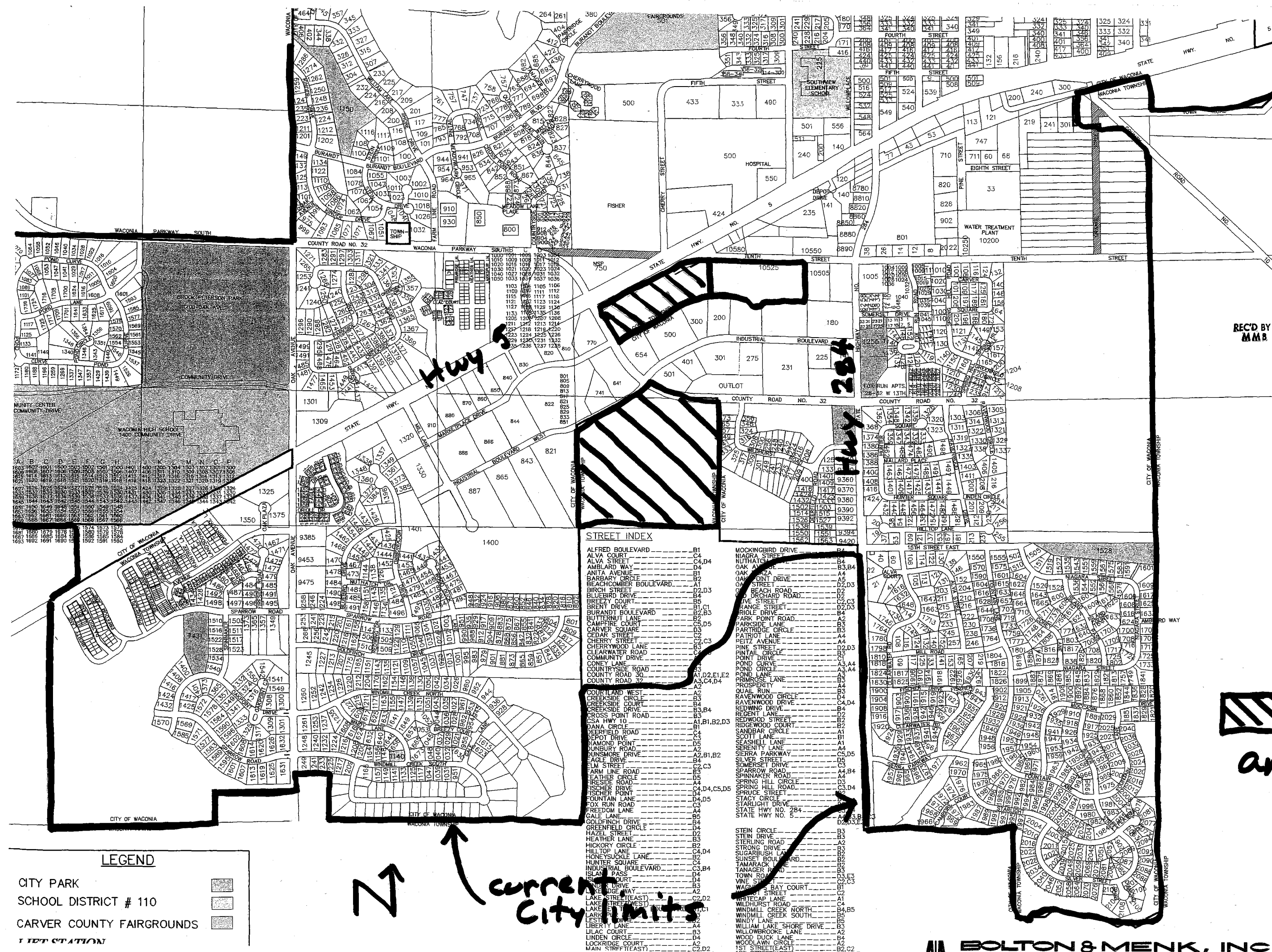

3

REC'D BY MMB AUG 4 2005

4

5

 = annexation areas