

AN ORDINANCE PROVIDING FOR THE ANNEXATION BY PROPERTY OWNER  
PETITION BY AMENDING SECTION XII, "ANNEXATION BY ORDINANCE" OF THE  
RUSH CITY CODE BY ADDING PART 13.

Section XII. Annexation By Ordinance

Part 13. Petition of Rumpel Family Farm Limited Partnership

Section 1213.01. Rumpel Family Farm Limited Partnership, fee owner and the "Petitioner", petitioned for the inclusion of the following described parcel in the city limits of Rush City under the provisions of Minnesota Statutes 414.033:

The NE1/4 of the SE1/4 of Section 20, Township 37, Range 21 except the following described parcel: Beginning at the SW corner of NE1/4 of SE1/4; then E along the S line of said NE1/4 of the SE1/4 a distance of 360 feet; then N parallel with the W line of said NE1/4 of the SE1/4 a distance of 884 feet; then SW'LY 401.77 feet to a point in the W line of said NE1/4 of the SE1/4 a distance of 714 feet N of the SW corner of said NE1/4 of the SE1/4; then S along said W line 714 feet to the point of beginning except the following described parcel: Commencing at the NE corner of the SE 1/4 of the SE 1/4; then assumed bearing N O D 31'21" W along E line of said E 1/2 of the SE 1/4 106.40 to C/L of County Highway 7; then in a generally SW'LY direction 188.77 feet to a point 153.32 feet W of beginning; then E to point of beginning. Except part of the NE1/4 of the SE1/4 commencing at the SW corner of said NE1/4 of the SE1/4; then E'LY 360 feet; then N'LY 884 feet to point of beginning; then SW'LY 401.77 feet to a point on the W line of said NE1/4 of the SE1/4 that is 714 feet N of said SW corner; then N'LY to the NW corner of said NE1/4 of the SE1/4; then E'LY to a point that is 418.10 feet W'LY of the NE corner of said NE1/4 of the SE1/4; then SW'LY to the point of beginning.

Section 1213.02. The Petitioner has declared, and it has been confirmed, that the parcel is less than sixty (60) acres in size and is not now served by public sewer facilities and public sewer facilities are not otherwise available.

Section 1213.03. The City Council of Rush City conducted a properly-noticed public hearing to consider the petition on Monday, June 14, 2004, at 7:15 p.m., recessed the public hearing and then reconvened on Monday, June 28, 2004, in the Rush City City Hall at which time and place all persons desiring to be heard were afforded the opportunity.

Section 1213.04. There are no residences on the property and the population consists of zero persons.

Section 1213.05. The property abuts the present corporate limits of Rush City.

Section 1213.06. Upon adoption of the ordinance amendment, the land described herein shall be annexed to the City of Rush City, a municipal corporation, and be included in the corporate limits thereof as per Minnesota Statutes Section 414.033.

Section 1213.07. Upon adoption, certified copies of the ordinance shall be filed as provided in Minnesota Statutes Chapter 414.

Passed by the City Council of Rush City this 28th day of June, 2004.

Daniel P. Hoff  
Administrator

Michael Skelley  
Mayor



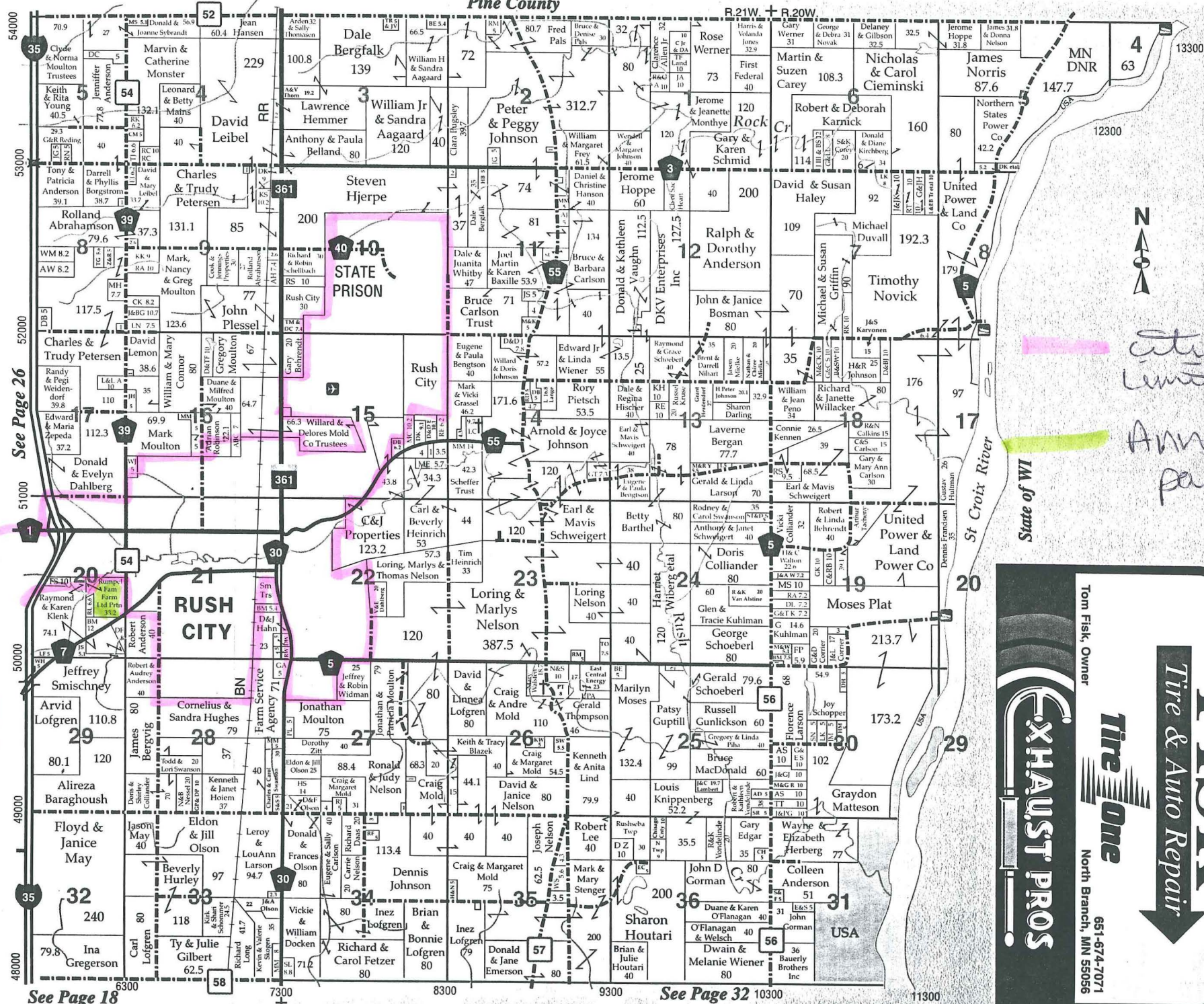

**Tom Fisk, Owner**

# Time One

Tire &amp; Auto Repair

651-674-7071  
nch, MN 55056

**EXHAUST PROS**







Anna's parcel

city limits

510TH STREET

SCHOOL GROUNDS

CEMETERY

FAIR GROUNDS

RUSH CREEK

BLK 1

JAMES PLACE

JAMES PLACE

BLK 2

REARRANGEMENT

BLK 1

OF BLOCK 36

ANDERSON BLOCK 1

W. NINTH STREET

1ST ADDITION BLOCK 2

BLOCK 1

WEST 10th ST.

2ND ADDITION BLOCK 2

BLOCK 1

WEST 11th ST.

JAY ADDITION

BLOCK 2

WEST 11 1/2th ST.

ESTATE DR

OUTLOT A

OUTLOT B

OUTLOT A

CITY INDUSTRIAL

PARK BLOCK 2

WEST 13th ST

WEST 14th ST

BLK 3

1615  
2122

1716  
2021

2122  
2827

REC'D BY  
MMB  
APR 21 2005



A-7276  
A-7277  
A-7278  
A-7279  
A-7280

City Limits

Rush City

State of WI

**Exhaust Pros**  
Tire & Auto Repair  
Tire One  
Tom Fisk, Owner  
651-674-7071  
North Branch, MN 55056

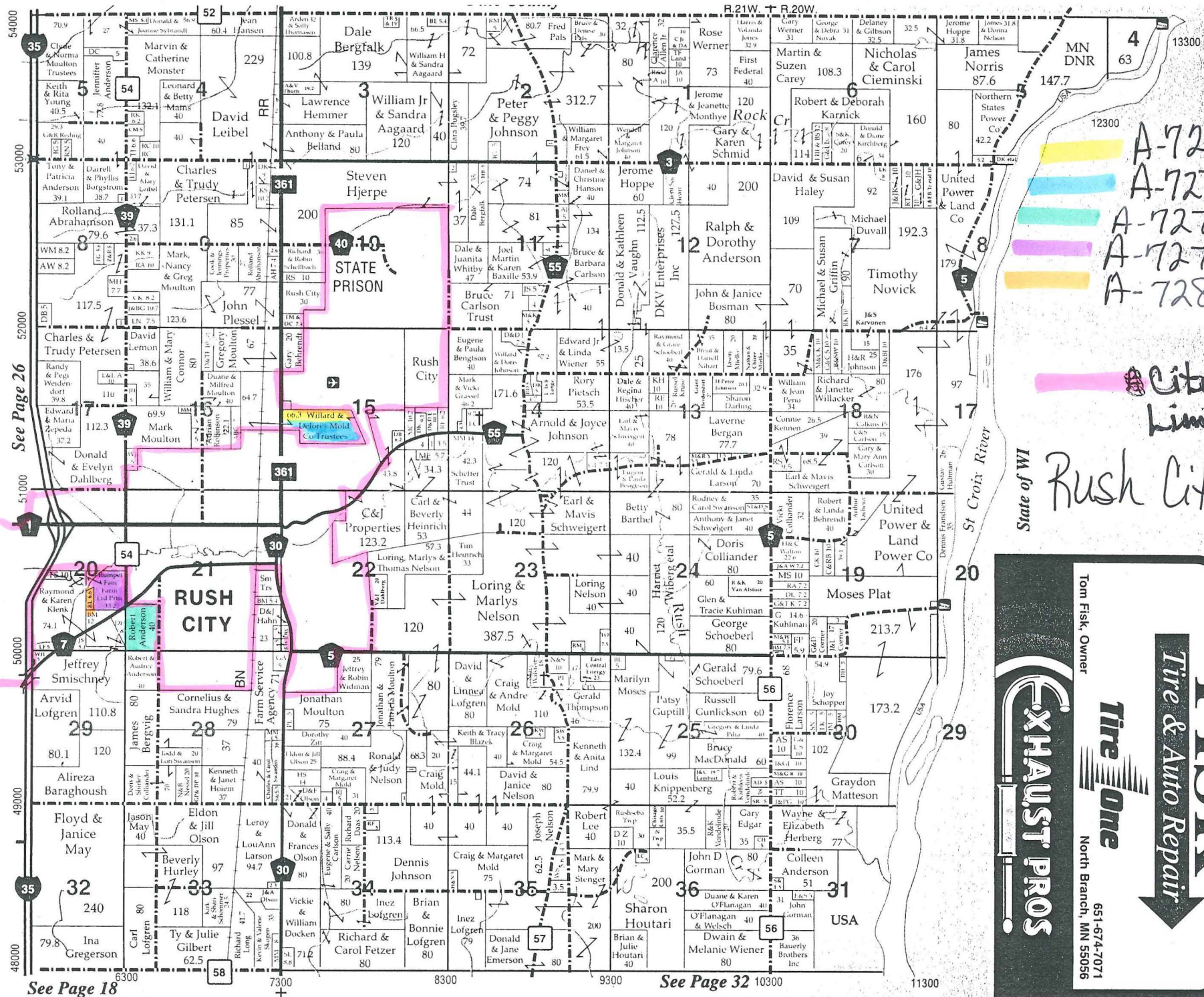

See Page 32 10300

See Page 18