

**PETITION FOR ANNEXATION**

IN THE MATTER OF THE PETITION FOR ANNEXATION OF  
UNINCORPORATED ADJOINING PROPERTY LOCATED ALONG  
COUNTY STATE AID HIGHWAY 82 (KARL),  
ALEXANDRIA, MINNESOTA

**TO THE CITY OF ALEXANDRIA AND THE STATE OF MINNESOTA**

WE, THE UNDERSIGNED, the owners of the property described below, hereby petition the Alexandria City Council to annex this territory to the City of Alexandria, Minnesota and for that purpose respectfully state:

1. The petitioners are the owners of the subject property.
2. Pursuant to Minn. Stat. Section 414.033, Subdivision 5, the petition is a majority (62.5%, five of eight) of the property owners within the annexation area.
3. The property currently abuts upon the westerly boundaries of the Alexandria City Limits along the easterly, southerly and northerly boundaries of the subject property and is not presently a part of any incorporated city.
4. The property consists of unplatted land in LaGrand Township, Douglas County, containing approximately 113.10 acres in eight (8) parcels owned by eight (8) property owners and is described as follows:

**W 30 AC of NW ¼ SW ¼ & W 30 AC of SW ¼ NW ¼, EX 0.57 AC,  
SECT - 13, TWP - 128, RANGE - 38  
(AC 59.94 - Karl)**

**and**

**N 50' OF E 50' OF S 131.87' OF W 279.58' OF NW ¼ SW ¼,  
SECT - 13, TWP - 128, RANGE - 38  
(AC 0.57 - ALASD)**

**and**

**All that land lying in the SE ¼ of the SW ¼ of Section 13, Twp. 128,  
Range 38  
(AC 10.89 - Swedberg/Primus/Karnis/Anderson/Barthle)**

**and**

**NW ¼ SE ¼ & SE 1.70 AC OF SW ¼ NE ¼, SECT - 13, TWP - 128,  
RANGE - 38  
(AC 41.7 - WILLIAMS PIPELINE)**

5. The petitioners state that this land has become or is about to become suburban in character by usage.
6. The parties affected and which may be entitled to notice are the Township of LaGrand and Douglas County.
7. The reason for requesting annexation is for the affected properties to be served with municipal water services.

Pursuant to Minnesota Statutes Section 414.033, Subdivision 13, the City of Alexandria notifies the petitioners that the cost for electric utility service is currently and will continue to be served by Alexandria Light and Power even after the territory is annexed to the City of Alexandria.

Dated at Alexandria, Minnesota this 22<sup>nd</sup> of January, 2004.

(Note: Signatures to be in blue ink only.)

**PROPERTY OWNER**

**DESCRIPTION/PIN**

**SIGNATURE**

REC'D BY  
MMB

2005

Wallace D. Karl

27-0631-000

C. West

27-0632-000

ALASD

27-0633-000

Swedberg Wood Products/  
Hardwood Gallery

27-0636-700

Anthony W. Primus

27-0637-000

Eugene K. Karnis

27-0638-000

Jerry L. Anderson

27-0639-000

Dennis L. Barthle

27-0641-000

Williams Pipeline Company 27-0642-000

"I hereby represent and state under the penalties of perjury that the signatures of all parties appearing hereon are actual signatures of the person whose name appears as signing this petition."

(Certifying Signature)

Subscribed and sworn to before me this

23<sup>rd</sup> day of January, 2004.

Lori E. Alm-West

(Notary Public)

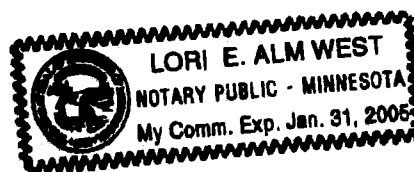

= ANNEXATION AREA  
= Existing City Limits

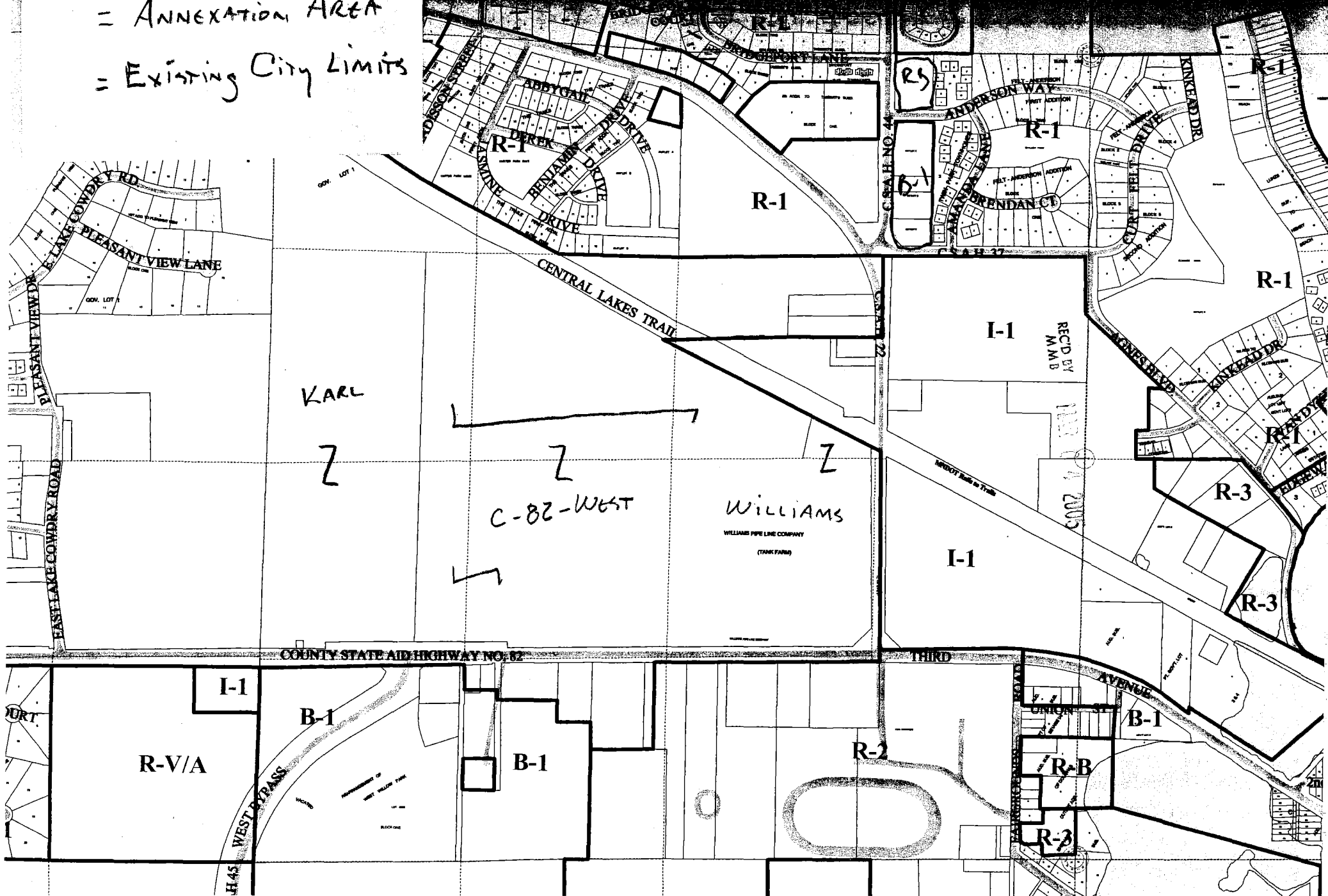



# City of Alexandria - 2002 Comprehensive Plan

## Proposed Land Use

### LEGEND

- AIRPORT FLYZONE "A"
- AIRPORT FLYZONE "B"
- LOW DENSITY RESIDENTIAL
- MEDIUM DENSITY RESIDENTIAL
- HIGH DENSITY RESIDENTIAL
- MANUFACTURED HOUSING
- COMMERCIAL
- CENTRAL BUSINESS DISTRICT COMMERCIAL
- INDUSTRIAL
- PUBLIC / GOVERNMENT
- PARKS / OPEN SPACE
- INSTITUTIONAL
- RIGHT OF WAY
- VACANT / AGRICULTURE (1 Unit/40 Acres)
- PROPOSED LOW DENSITY RESIDENTIAL (1 Unit/10 Acres)
- PROPOSED SINGLE FAMILY RESIDENTIAL
- PROPOSED MULTI FAMILY RESIDENTIAL
- PROPOSED COMMERCIAL
- PROPOSED INDUSTRIAL
- PROPOSED PUBLIC\GOVERNMENT\INSTITUTIONAL
- LAKE

