

**ORDINANCE NO. 416**

**AN ORDINANCE ANNEXING UNINCORPORATED LANDS  
IN THE TOWN OF LA CRESCENT, HOUSTON COUNTY, MINNESOTA,  
TO THE CITY OF LA CRESCENT, HOUSTON COUNTY, MINNESOTA  
PURSUANT TO MINNESOTA STATUTES 414.033, SUBD 2(3),  
PERMITTING ANNEXATION BY ORDINANCE**

The City Council of the City of La Crescent, Houston County, Minnesota, hereby ordains:

SECTION I. That all of the owners of the lands to be annexed hereinafter described executed the Petition for annexation and that said unincorporated lands described in Section IV are currently located within the Town of La Crescent, Houston County, Minnesota.

SECTION II. That said lands are urban or suburban in character or about to become so, said lands being residential land whereon 5 persons reside, hence, to that extent the annexation does result in change of the population of the City.

SECTION III. Said lands abut the existing corporate limits of the City of La Crescent, are unplatted, and consist of approximately 4.7 acres.

SECTION IV. Said lands are legally described as follows:

From the Southeast Corner of Section 9, Township 104 North of Range 4 West of the Fifth Principal Meridian West along the South line of said Section a distance of 1647.9 feet, thence North 8 degrees 30 minutes East a distance of 260.1 feet, to the place of beginning; thence North 8 degrees 30 minutes East 103.5 feet; thence South 81 degrees 30 minutes East 409.5 feet to center of road, thence South 32 degrees 45 minutes West 113.5 feet to a point in the center of the present road, thence North 81 degrees 30 minutes West 362.9 feet to the place of beginning.

Part of Block K of Auditors Subdivision of Section 9, T104N, R4W, La Crescent Township, Houston County, Minnesota, described as follows: Commencing at the South ¼ Corner of said Section 9; thence N87 degrees 59' 41" E 865.21 feet to a point on the North line of C.S.A.H. 25 and the point of beginning; thence S89 degrees 43' 11" E along said North line 41.24 feet; thence N7 degrees 29' 02" E 237.75 feet; thence S81 degrees 51' 09" E 103.60 feet; thence N8 degrees 08' 51" E 417.54 feet to the Southeast Corner of Crescent Valley First Addition to La Crescent Township; thence along said Addition S88 degrees 57' 49" W 158.12 feet; thence S6 degrees 51' 04" W 635.85 feet to the point of beginning, containing 71,632 square feet.

SECTION V. That at least 60 days before Petition for Annexation in the within matter was duly filed in the Office of the City Administrator in and for the City of

La Crescent, Petitioners duly notified said municipality of their intention to file a Petition for Annexation, and at least 30 days before the filing of said Petition said municipality notified Petitioners concerning cost of electric utility service by virtue of annexation and concerning an estimate of the cost impact of any change in such rates and assessments on account thereof.

SECTION VI. That preceded by at least 30 days written notice by certified mail to the Town of La Crescent and to all of the landowners within and contiguous to the area to be annexed, public hearing was duly held December 13, 2004.

SECTION VII. The property taxes payable on the lands hereby annexed shall continue to be paid to the Town of La Crescent for the year in which the within annexation becomes effective and thereafter: in the first succeeding year 90% of property taxes payable to said Town, second year 70%, third year 50%, fourth year 30%, and fifth year 10% of property taxes payable to said Town.

SECTION VIII. That the aforescribed lands are hereby duly annexed to the City of La Crescent.

SECTION IX. The City Administrator is hereby directed to forthwith file copies of this ordinance with the Minnesota Planning Municipal Boundary Adjustments, the Secretary of State, the Town of La Crescent, Houston County Recorder and the Houston County Auditor.

SECTION X. This ordinance shall become effective and said land duly annexed to the City of La Crescent upon the due passage and enactment hereof, approval by the Minnesota Municipal Board and publication of this Ordinance according to law.

Passed and enacted this 13<sup>th</sup> day of December 2004.

APPROVED:



Mayor

ATTEST:

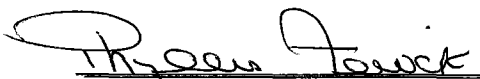
  
Deputy Clerk

# LOCATION MAP CRESCENT VALLEY SUBDIVISIONS AND ADJACENT AREAS



RECORDED  
JAN 10

DEC 27 2004

A  
S)

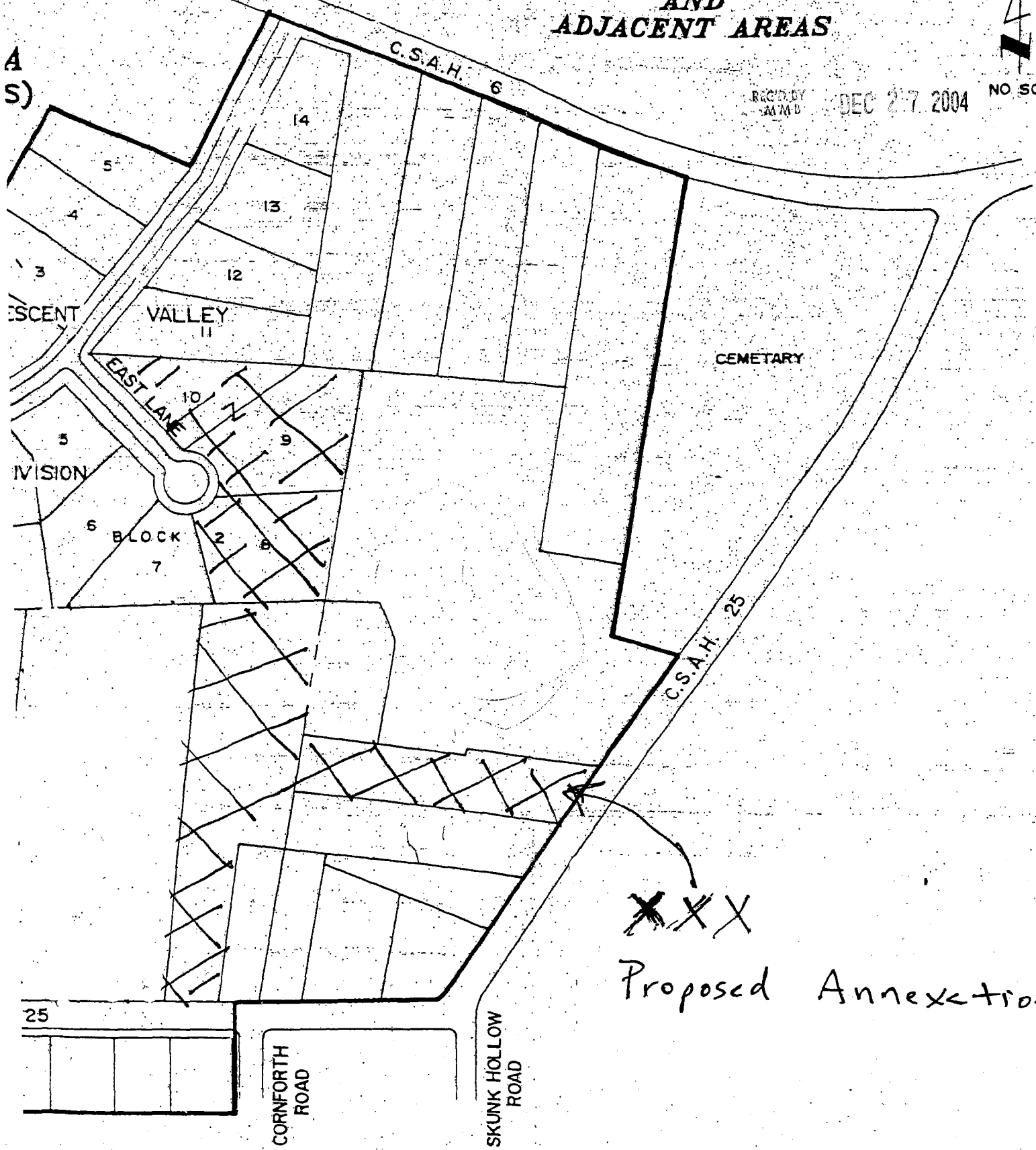

XXX

Proposed Annexation